

TOWN HWY. NO.	CLASS 3	CLASS 4	TOWN HWY. NO.	CLASS 3	CLASS 4
5	3.65		105	0.09	
6	3.72		107	0.07	
7	2.53		108	0.10	
8	1.27		109	0.05	(0.31)
9	0.16		110	0.03	
10	0.40		111		(0.07)
11	0.21		112	0.20	
12	3.38		113	0.15	
13	0.03		114		(1.41)
14	1.44		115	0.17	
15		(0.30)	300	0.09	
16	0.54		302	0.48	
17	0.27		304	0.27	
18	0.07	(0.20)	305	0.22	
18	0.70	(0.10)	306	0.24	
19	0.70		308	0.45	
20	0.81		310	0.05	
21		(0.20)	312	0.06	
22	0.89		314	0.08	
23	0.81		316	0.35	
24	0.26		318	0.09	
26	0.20		320	0.10	
27	0.79		322	0.10	
28	0.41		324	0.09	
29	0.05		326	0.19	
31	0.44		328	0.10	
32	0.70		330	0.09	
33	1.52		332	0.27	
34	0.81		334	0.06	
35	0.06		336	0.05	
36	0.45		338	0.07	
37	2.21	(1.23)	340	0.41	
38	0.30		342	0.13	
39	0.29		344	0.47	
40	0.30		346	0.10	
41	0.58		348	0.13	
42	1.07		350	0.69	
43	0.10		352	0.04	
44	0.06		354	0.21	
45		(0.16)	356	0.09	
46	2.31		358	0.09	
47	0.19		360	0.08	
48	0.14		362	0.10	
49	0.25		364	0.07	
50	1.20		366	0.09	
51	1.31		368	0.09	
52	1.33		370	0.04	
53	0.58		372	0.08	
54	0.59	(0.07)	374	0.08	
55	0.53		376	0.27	
56	0.18		378	0.09	
57	0.35		380	0.30	
58	0.44		382	0.15	
59	0.37		383	0.18	
60		(0.07)	384	0.17	
61		(0.11)	386	0.20	
62		(0.30)	388	0.04	
63	0.09		390	0.12	
64	0.53		392	0.08	
65	0.06		394	0.15	
66	0.02		396	0.04	
67	0.13		398	0.11	
68	0.19		400	0.15	
69		(1.74)	404	0.06	
70		(0.07)	406	0.22	
72	0.19		408	0.05	
73		(0.01)	410	0.05	
74	0.17		412	0.22	
75	0.63		414	0.03	
77	0.16		416	0.13	
78	0.73		418	0.21	
79	0.14		420	0.12	
80	0.08		422	0.31	
81	0.15		424	0.14	
82	0.31	(0.59)	426	0.05	
83	0.82		428	0.18	
84	0.10	(0.90)	430	0.24	
85	0.15		432	0.09	
86	0.06		434	0.06	
87	0.19		436	0.10	
88	0.22		438	0.29	
89	0.11		440	0.35	
91	0.16		442	0.20	
92	0.10		444	0.16	
93	0.07		446	0.15	
94	0.14		448	0.09	
94		(0.06)	450	0.28	
95	0.18		452	0.03	(0.33)
96	0.17		454		(0.03)
97	0.24		455		(0.03)
98	0.20		456		(0.03)
99	0.09				
100	0.14		TOTAL	61.47	8.86
102	0.26				
103		(0.07)			
104	0.02				

* This portion of town highway is Class 3, but is functionally Class 4

MILEAGE SUMMARY

CLASS 1		
TH-1	1.493	
TOTAL CLASS 1	1.493	
CLASS 2		
TH-1	5.190	
TH-2	4.670	
TH-3	1.320	
TH-4	2.740	
TH-5	1.307	
TH-6	0.249	
TH-7	0.040	
TOTAL CLASS 2	15.516	
CLASS 3		
TOTAL CLASS 3	61.470	
TOTAL TOWN	78.479	
STATE HIGHWAY		
VT-103	6.753	
TOTAL STATE HIGHWAY	6.753	
US HIGHWAY		
US-5	7.361	
TOTAL US HIGHWAY	7.361	
TOTAL STATE	14.114	
INTERSTATE		
I-91	7.896	
TOTAL INTERSTATE	7.896	
INTERSTATE - Ramp		
I-91	1.461	
TOTAL INTERSTATE - Ramp	1.461	
TOTAL INTERSTATE	9.357	

TOTAL, TRAVELED HIGHWAYS, FEB. 10, 2008: 101.950
(Excludes Class 4 and Legal Trail Mileage)

- | | | |
|-----------------|------------------------------------|--------------------------------------|
| HIGHWAYS | — INTERSTATE OR DIVIDED HIGHWAY | ▨ PUBLIC LAND |
| — INTERSTATE | — STATE - HARD SURFACE OR PAVED | ▨ POLITICAL SUBDIVISIONS |
| — U.S. ROUTE | — TOWN - HARD SURFACE OR PAVED | — STATE BOUNDARY |
| — STATE ROUTE | — GRAVEL | — COUNTY BOUNDARY |
| — CLASS 1 | — SOIL OR GRADED AND DRAINED EARTH | — TOWN BOUNDARY |
| — CLASS 2 | — UNIMPROVED OR PRIMITIVE | — VILLAGE BOUNDARY |
| — CLASS 3 | — IMPASSABLE OR UNTRAVELED | — URBAN COMPACT BOUNDARY |
| — CLASS 4 | — LEGAL TRAIL | — OPEN WATER |
| — LEGAL TRAIL | — DISCONTINUED | — STREAM OR BROOK |
| | — HIGHWAY CLASS CHANGE | — BRIDGE OR CULVERT |
| | — RAILROAD | — BRIDGE OR CULVERT GREATER THAN 20' |
| | | — BRIDGE OR CULVERT 6' - 20' |

DISCLAIMER:

The untraveled highways (laid-out town highways), discontinued highways, and legal trails shown hereon are those of which the Agency of Transportation has record; others may exist.

Highway and bridge data by the Agency of Transportation, Policy & Planning Division. All other data from the Vermont Center for Geographic Information.

STRUCTURES - SURFACE WATER NOTE:

Town short structures (bridges or culverts from 6-feet to less than 20-feet) were not represented due to inconsistencies in the data.

The surface waters are from the Vermont Hydrological Dataset (VHD). Only the named streams are shown.

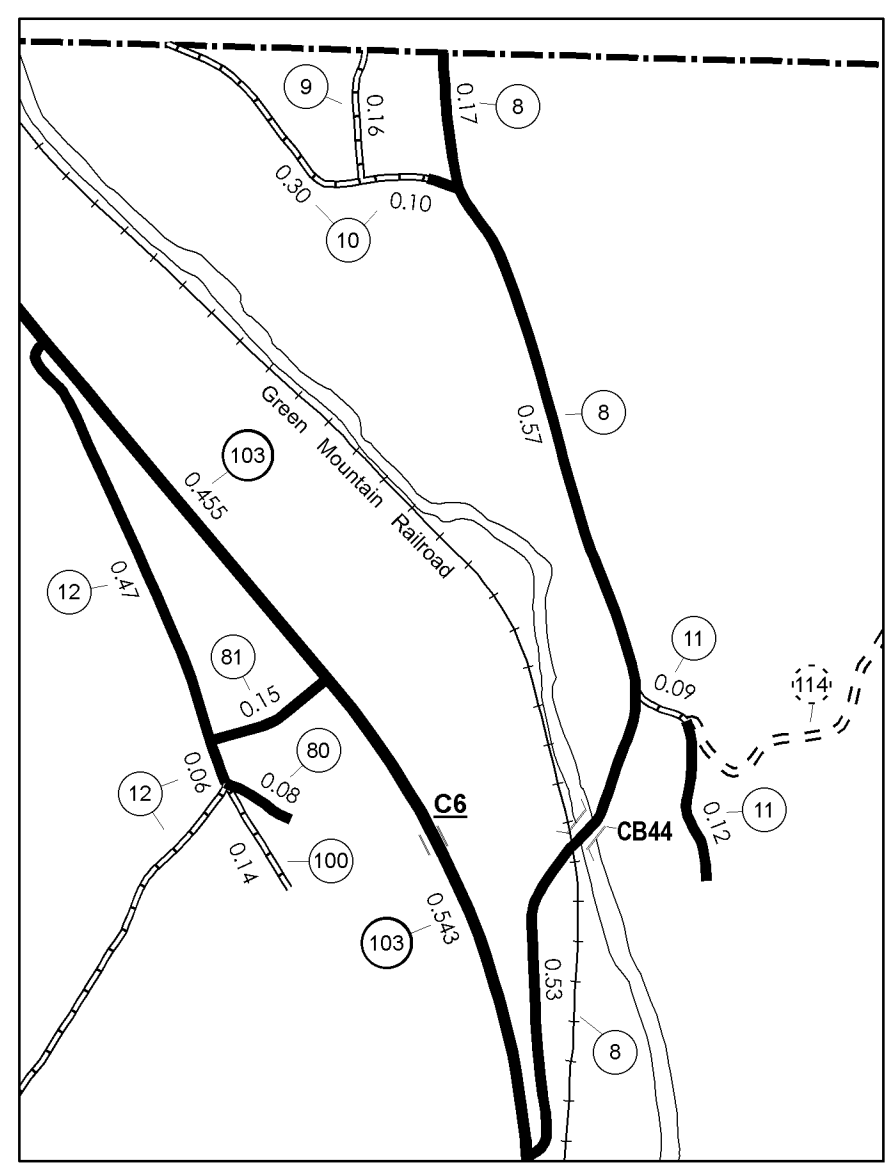

INSET 5 SCALE 1:12672

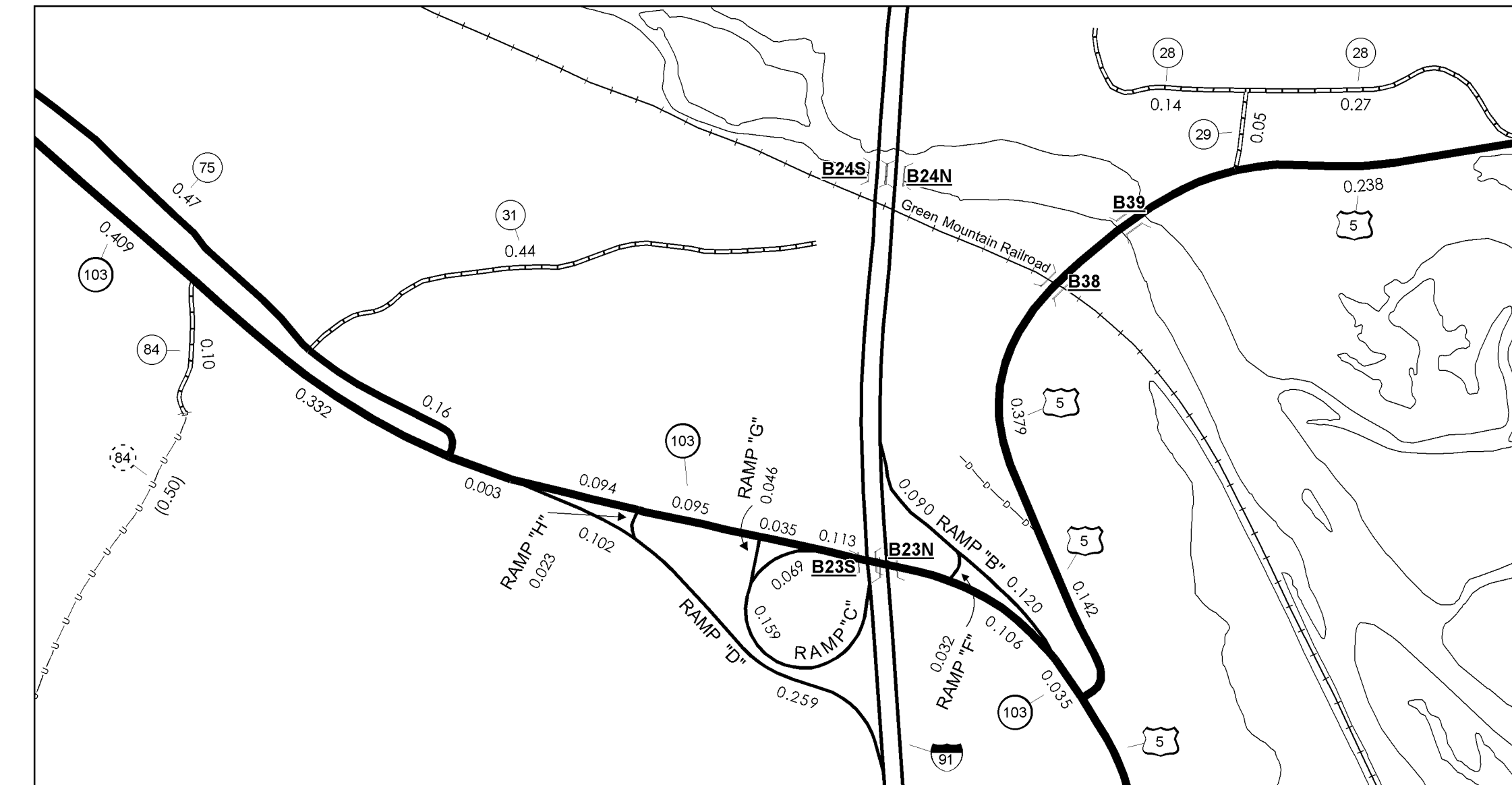

I-91 INTERCHANGE NO. 6 INSET 1 SCALE 1:6336

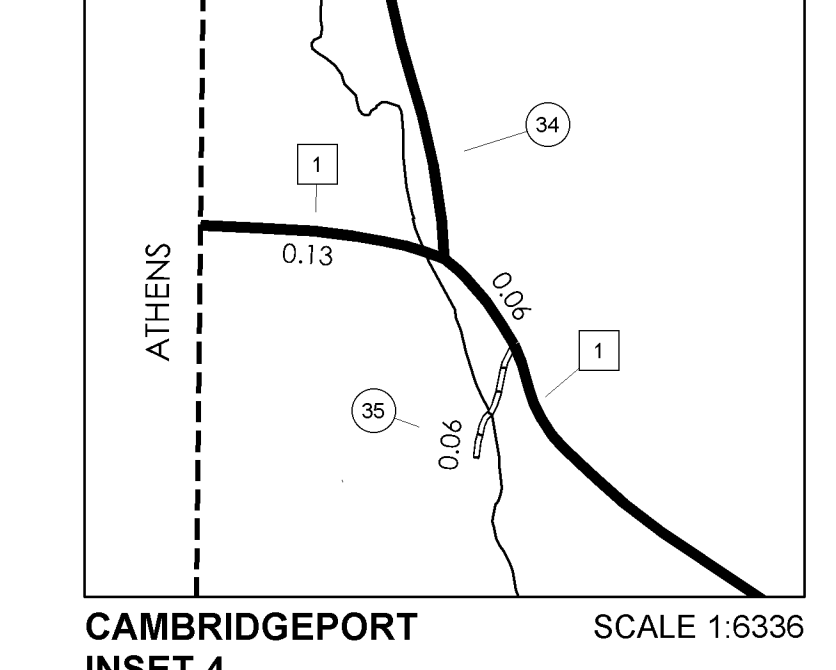
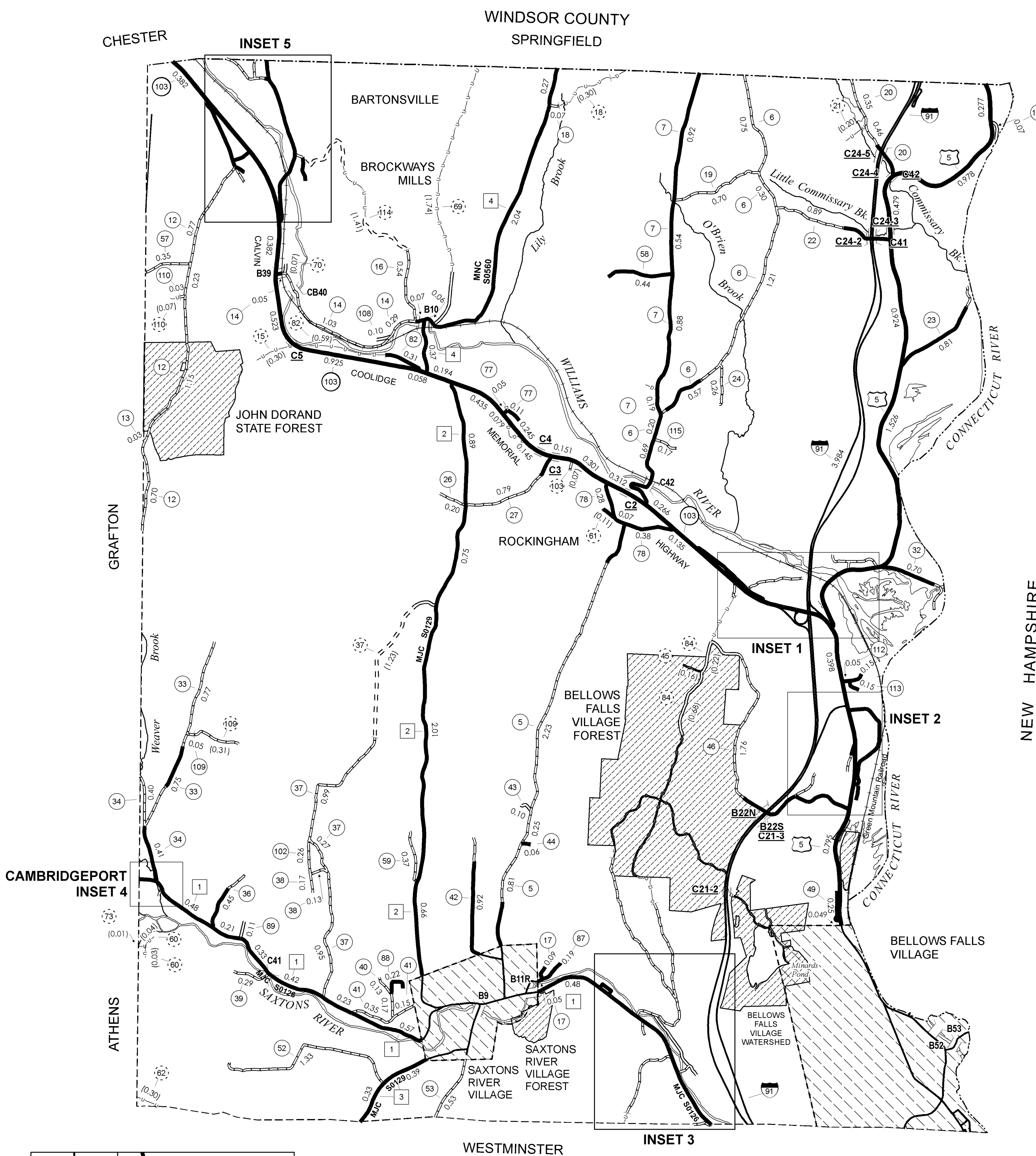

CAMBRIDGEPORT INSET 4 SCALE 1:6336

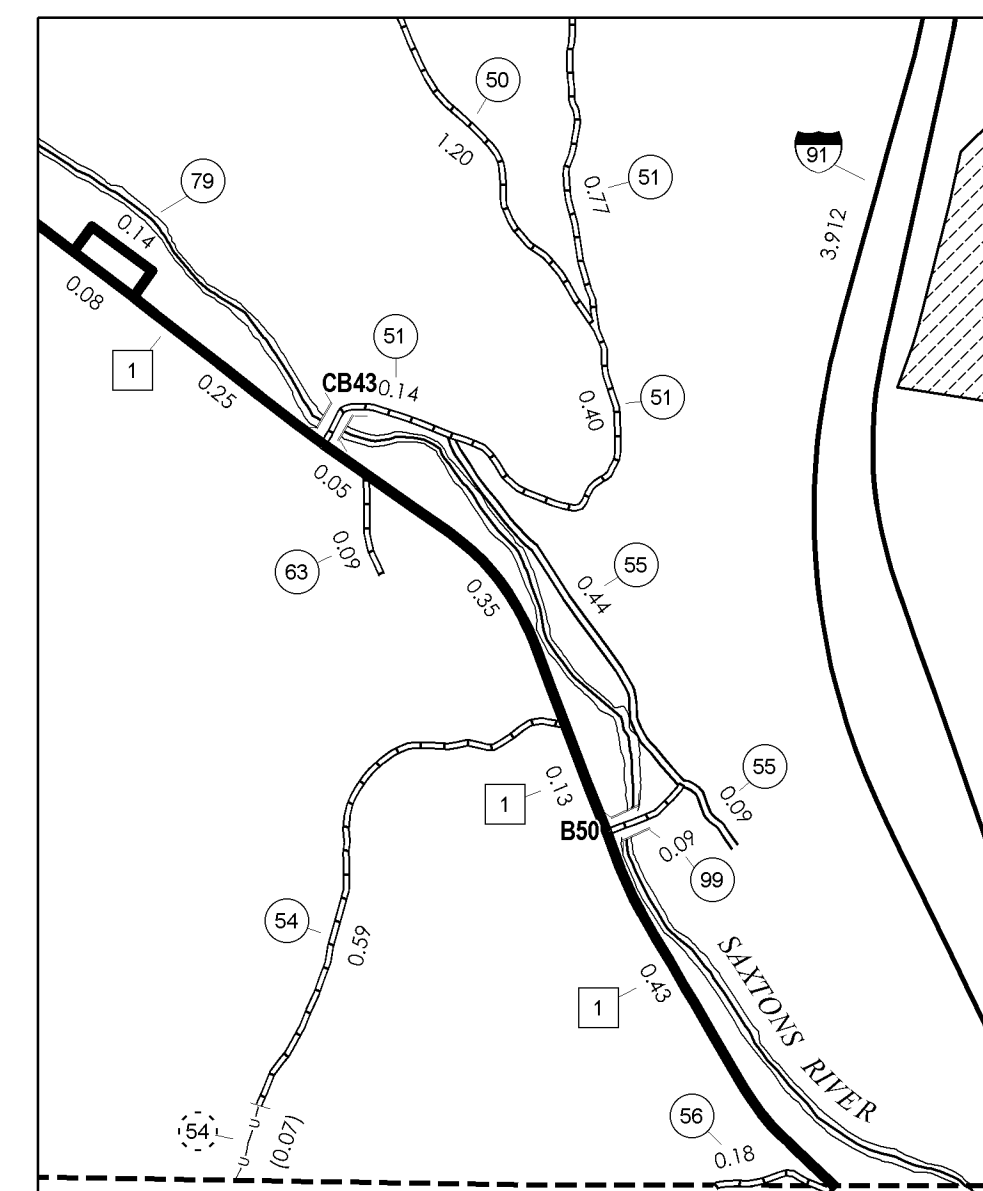

INSET 3 SCALE 1:12672

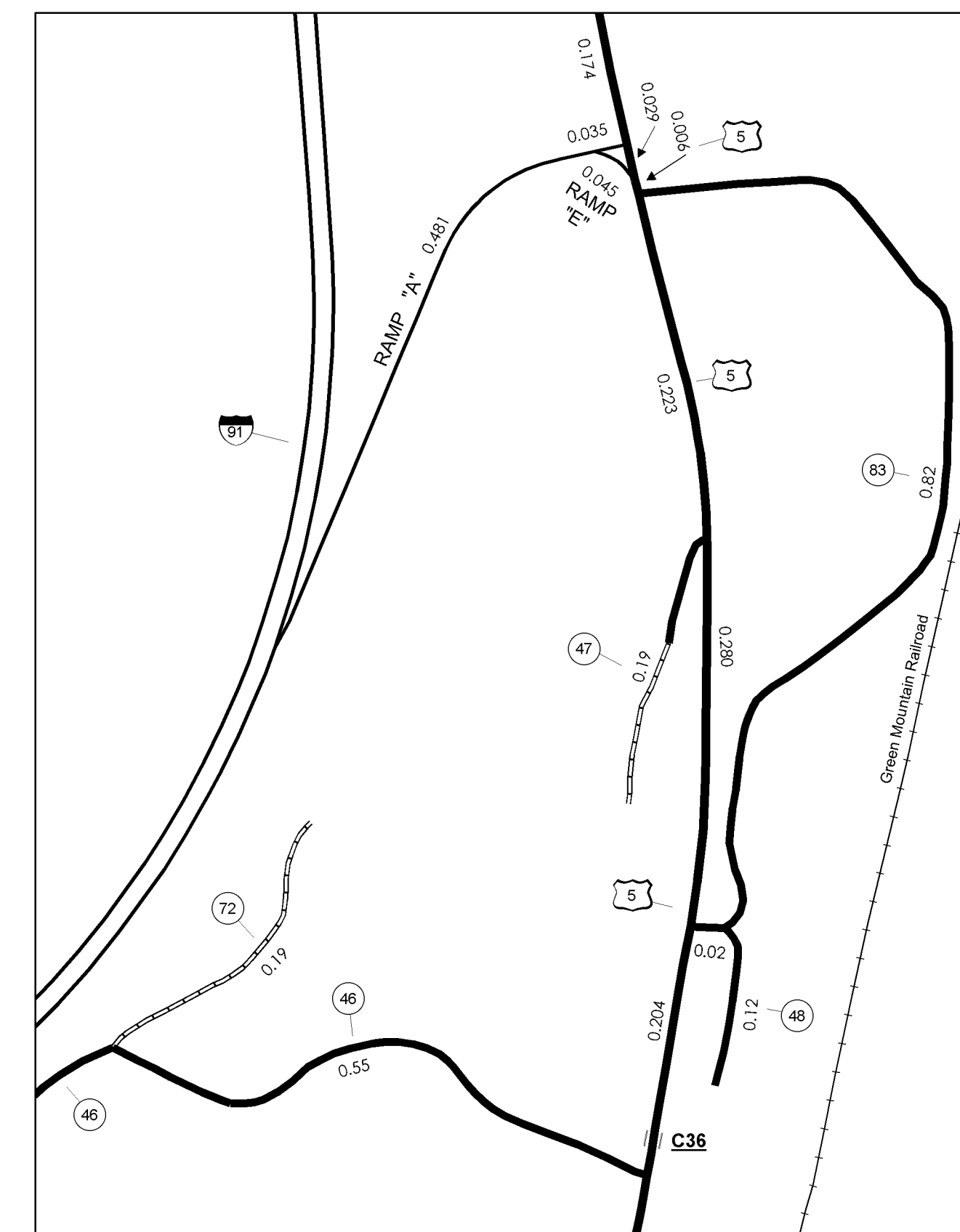

INSET 2 SCALE 1:6336

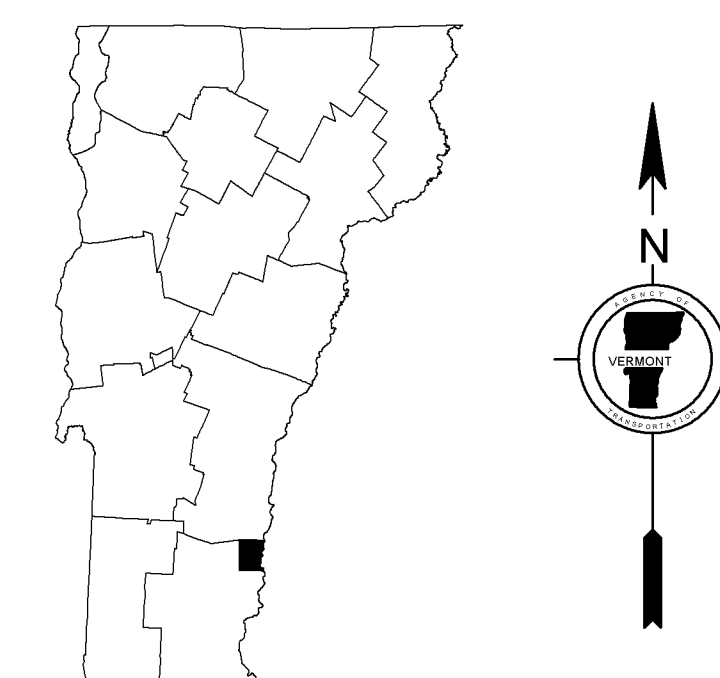

VERMONT GENERAL HIGHWAY MAP
Town of Rockingham
WINDHAM COUNTY

Transportation District #2

Prepared by the
Vermont Agency of Transportation
Policy & Planning Division
in cooperation with
U.S. Department of Transportation
Federal Highway Administration

Mileage as of: February 10, 2008
Map generated: September, 2008

SCALE: 1:31680

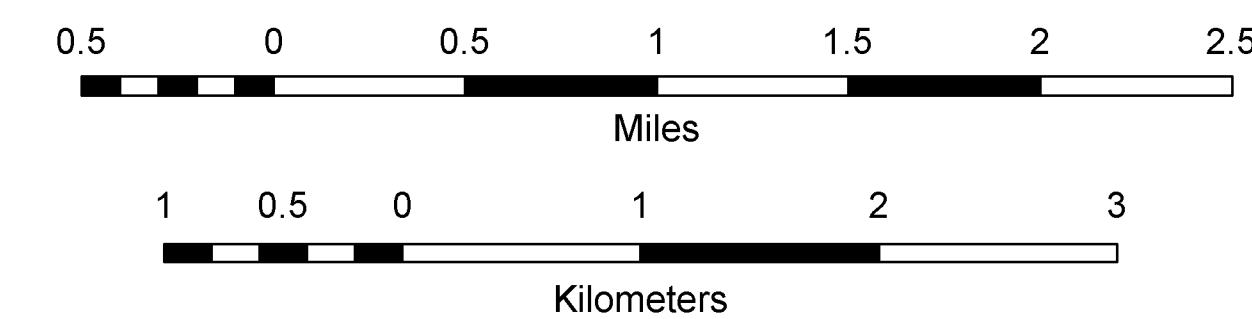

Vermont State Plane Coordinate System
North American Datum of 1983
SPCS Zone Identifier: 4400
Geodetic Reference System 80
4,000-meter grid, Easting - Northing

