

TOWN HWY. No.	LENGTH IN MILES CLASS 3	LENGTH IN MILES CLASS 4
3	2.49	
4	2.70	
5	1.75	
6	0.22	(0.07)
7	0.48	
8	0.60	
9	0.87	
10	0.45	
11	0.44	
12	2.50	
13	0.90	
14	0.36	
15	0.19	
16	1.02	
17	0.47	(0.31)
18	2.71	
19	0.32	
20	0.28	
21	1.20	(0.40)
22	2.10	(0.31)
23	0.11	(0.07)
24	4.68	
25	0.63	
26	0.30	(0.10)
27	1.10	
28	0.89	
29	0.90	
30	2.30	
32	2.19	
33	1.04	
34	1.16	
35	0.52	
36	1.10	
37	1.76	
38		(1.10)
39	1.17	
40	0.28	
41	0.29	
42	0.45	
43	1.18	
44	0.91	
45	0.02	(0.08)
46	0.40	
47	0.34	(0.02)
48		(0.05)
50	0.65	(0.89)
51	0.25	
52	0.13	(1.54)
53	0.10	
54	0.20	
55	0.31	
58	0.37	
60	0.14	
61	0.07	
62	0.04	
63		(0.06)
<b>TOTAL</b>	<b>48.03</b>	<b>5.00</b>

TOWN HWY. No.	LENGTH IN MILES "NOT UP TO STANDARD"
31	(0.15)
<b>TOTAL</b>	<b>0.15</b>

\*The sections of the town highways listed above are legally Class 3, but have been deemed "Not Up To Standard" and are functionally Class 4 Town Highways

LEGAL TRAIL No.	LENGTH IN MILES LEGAL TRAIL
1	(0.15)
2	(0.90)
3	(0.10)
4	(0.54)
5	(1.10)
6	(0.75)
7	(0.89)
8	(1.25)
11	(1.00)
12	(1.40)
13	(0.38)
14	(1.00)
15	(0.50)
<b>TOTAL</b>	<b>9.96</b>

MILEAGE SUMMARY			
CLASS 2			
TH-1	9.860		
TH-2	6.940		
	<b>TOTAL CLASS 2</b>		<b>16.800</b>
CLASS 3			
	<b>TOTAL CLASS 3</b>		<b>48.03</b>
	<b>TOTAL TOWN</b>		<b>64.830</b>
STATE HIGHWAY			
VT-112	5.846		
	<b>TOTAL STATE HIGHWAY</b>		<b>5.846</b>
	<b>TOTAL STATE</b>		<b>5.846</b>

**TOTAL, TRAVELED HIGHWAYS, FEB. 10, 2019: 70.676**  
(Excludes Class 4 and Legal Trail Mileage)

**DISCLAIMER:**  
The untraveled highways (laid-out town highways), discontinued highways, and legal trails herein are those of which the Agency of Transportation has record; others may exist.  
  
Highway and bridge data by the Agency of Transportation. Town short structures drawn from the VTCULVERTS (formerly VOBCIT) online database. All other data from the Vermont Open Geodata Portal. Only named streams shown.

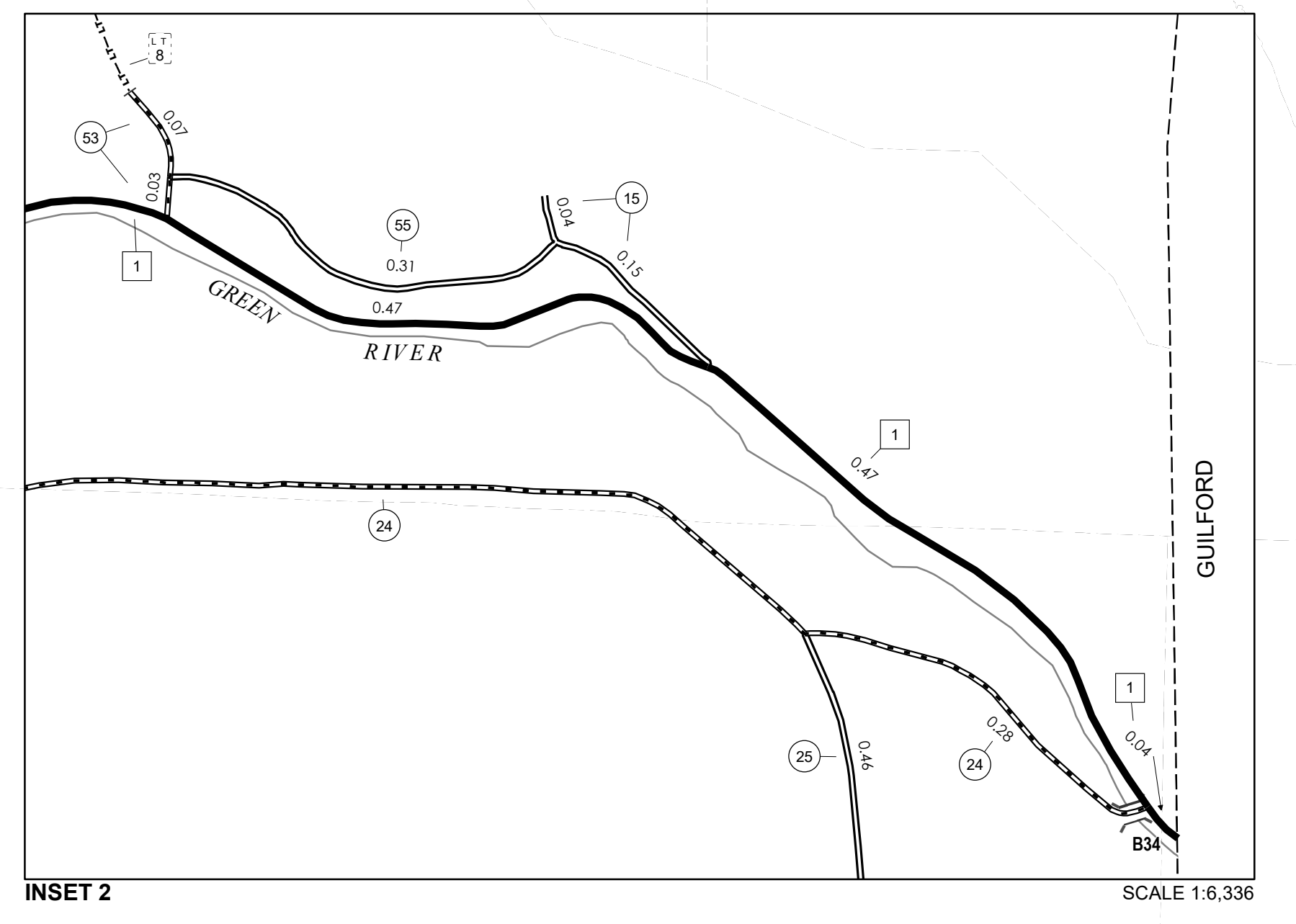
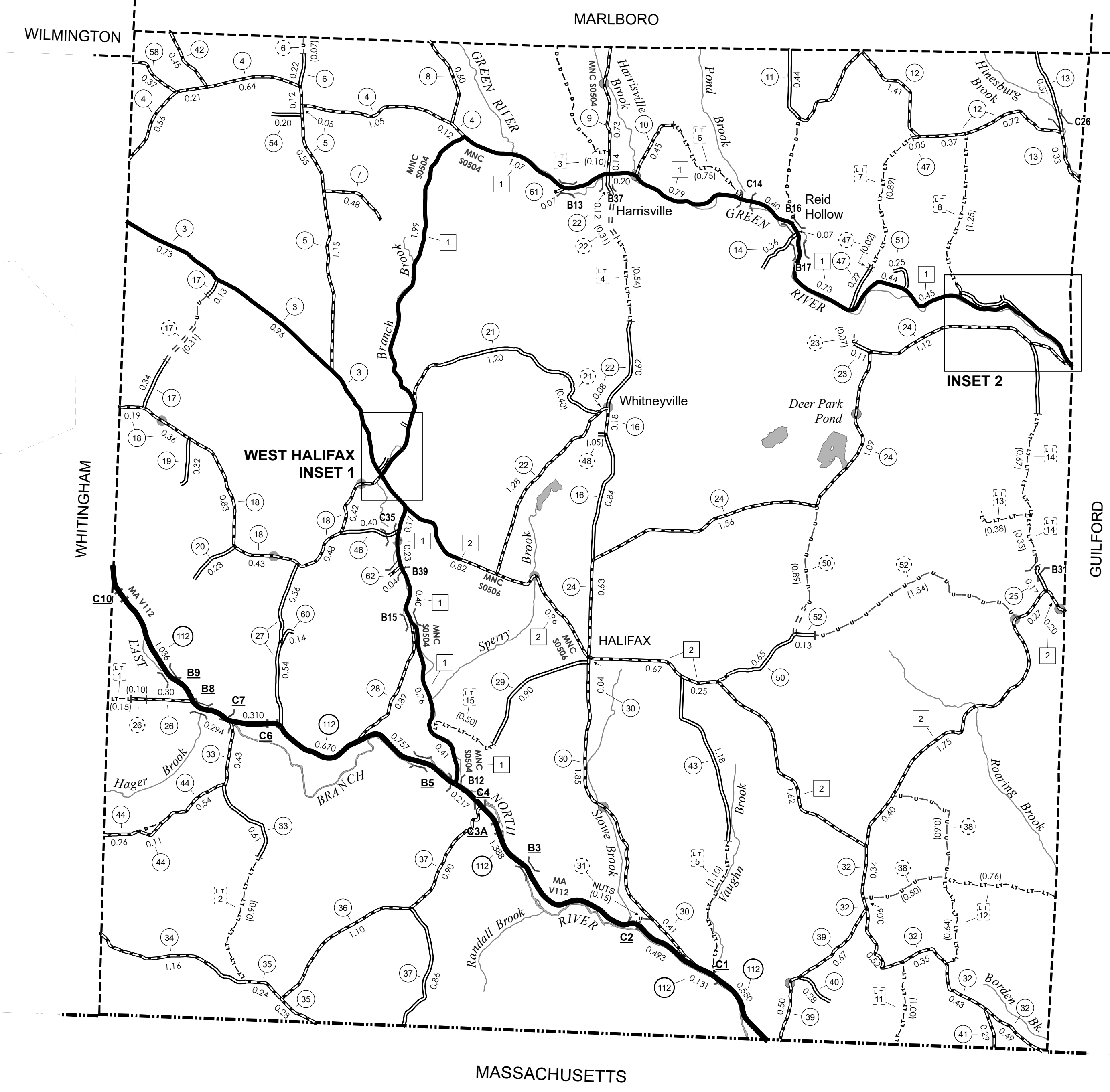

0 0.08 0.16 Miles

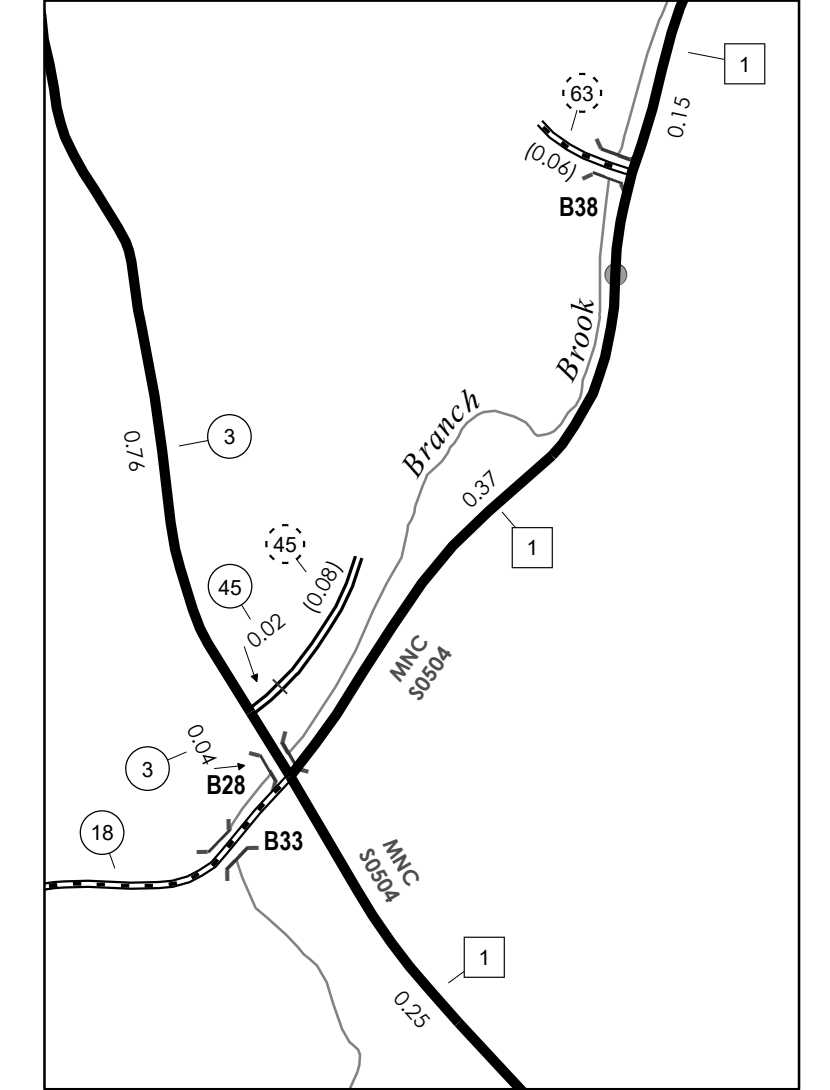

0 0.08 0.16 Miles

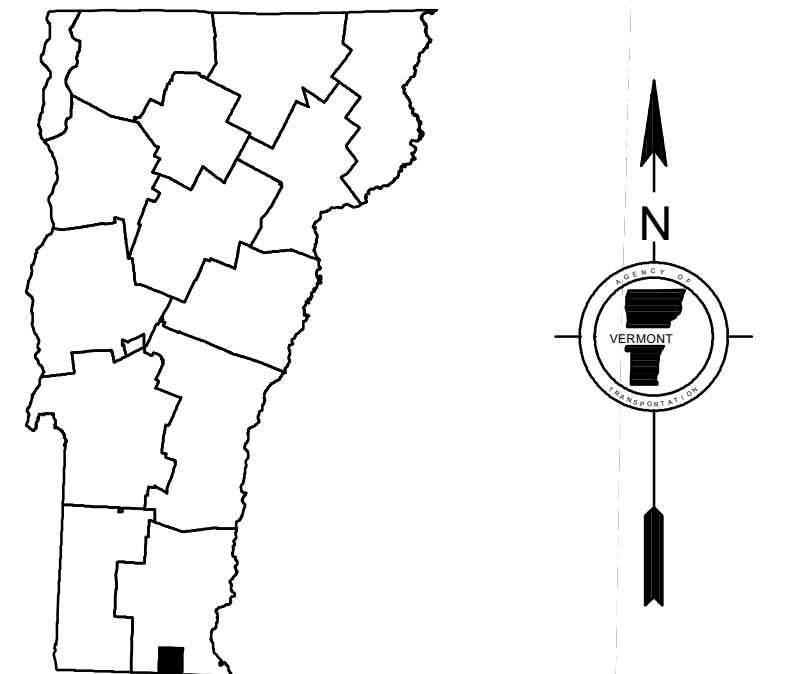

**VERMONT GENERAL HIGHWAY MAP**

**Town of Halifax**

WINDHAM COUNTY

Transportation District #2

Prepared by the Vermont Agency of Transportation  
Division of Policy, Planning and Intermodal Development  
in cooperation with

U.S. Department of Transportation  
Federal Highway Administration

Mileage as of February 10, 2019  
Map prepared April 26, 2019

SCALE 1:31,680

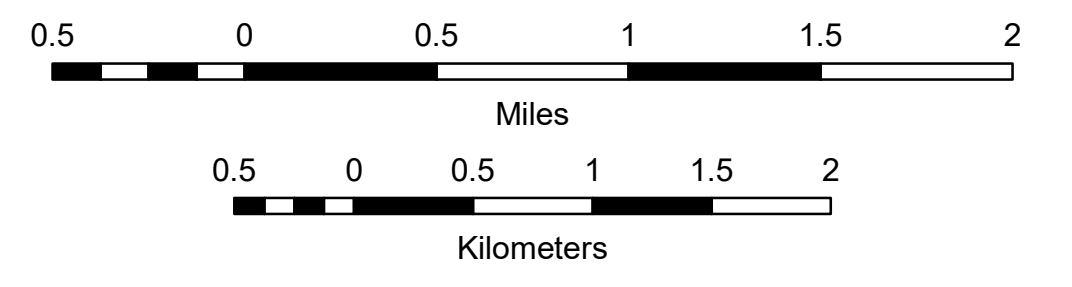

Vermont State Plane Coordinate System  
North American Datum of 1983  
SPCS\_Zone\_Identifier: 4400  
Geodetic Reference System 80  
4,000-meter grid, Easting - Northing