

TOWN HWY. No.	LENGTH IN MILES CLASS 3	LENGTH IN MILES CLASS 4	TOWN HWY. No.	LENGTH IN MILES CLASS 3	LENGTH IN MILES CLASS 4
5	2.02		46	0.21	
6	4.70		47	0.45	
7	3.42		48	0.40	
10	1.25		49	3.58	(0.52)
11	0.20		50	0.73	
12	0.70		51	1.47	
13	2.66		52	0.10	
14	0.15		53	0.11	
15	1.08		54	0.09	
16	0.58	(0.97)	55	0.22	(1.05)
17	0.60	(0.21)	56		(0.50)
18	1.78		57	0.45	
19	0.54		58	0.17	
20	1.82		59	0.10	(0.80)
21	0.80		60	0.06	
22	0.35	(0.20)	61	0.06	
23	1.34		63	0.15	
24	0.20		64	0.07	
25	0.38		65	0.06	
26	0.45	(0.14)	66	0.05	
27	0.89		67	0.15	
28	0.92		69	0.06	
29	0.27		70	0.14	
30	0.96	(1.03)	71	0.22	
31	0.43	(0.90)	72	0.15	
32	0.35		73	0.26	
33	0.36	(0.24)	74	0.09	
34	0.98	(0.39)	75	0.33	
35	0.20		76		(0.10)
36	0.30		77	0.13	
37	1.26	(0.19)	78	0.78	
38	0.72		79	0.60	
39	0.25		80	0.78	
41	0.22		81	0.08	
42	0.70	(0.75)	82	0.04	
43	0.08	(0.14)	83		(0.03)
44	2.46	(0.27)	84		(0.49)
45	0.16		85	0.03	
TOTAL			49.50	8.92	

LEGAL TRAIL No.	LENGTH IN MILES LEGAL TRAIL
1	(1.19)
2	(0.31)
3	(1.49)
4	(1.06)
TOTAL	4.05

MILEAGE SUMMARY		
CLASS 2		
TH-1	8.250	
TH-2	3.700	
TH-3	0.210	
TH-4	5.090	
TOTAL CLASS 2		17.250
CLASS 3		
TOTAL CLASS 3		49.50
TOTAL TOWN		66.750
US HIGHWAY US-5	6.758	
TOTAL US HIGHWAY		6.758
TOTAL STATE		6.758
INTERSTATE I-91	3.925	
TOTAL INTERSTATE		3.925
TOTAL INTERSTATE		3.925

TOTAL, TRAVELED HIGHWAYS, FEB. 10, 2026: 77.433
 (Excludes Class 4 and Legal Trail Mileage)

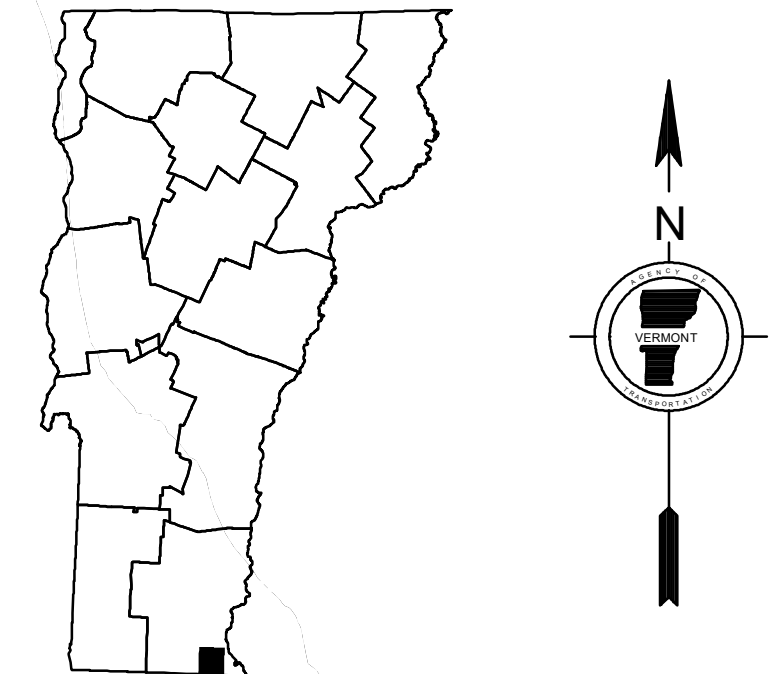
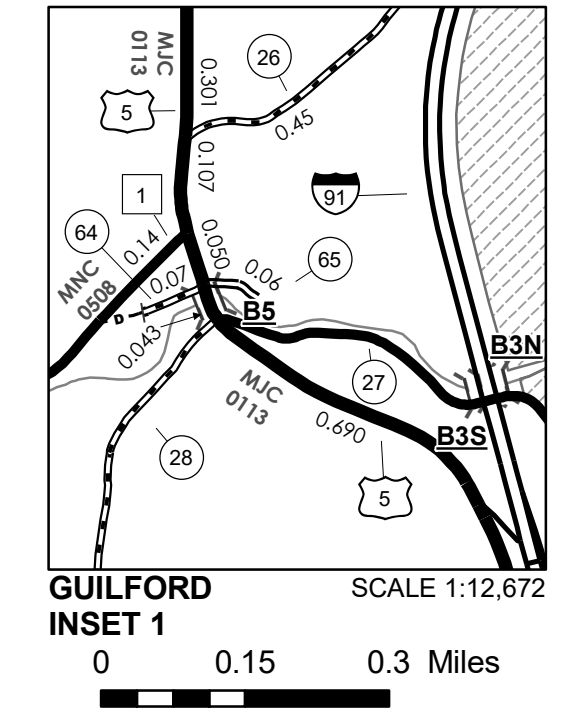
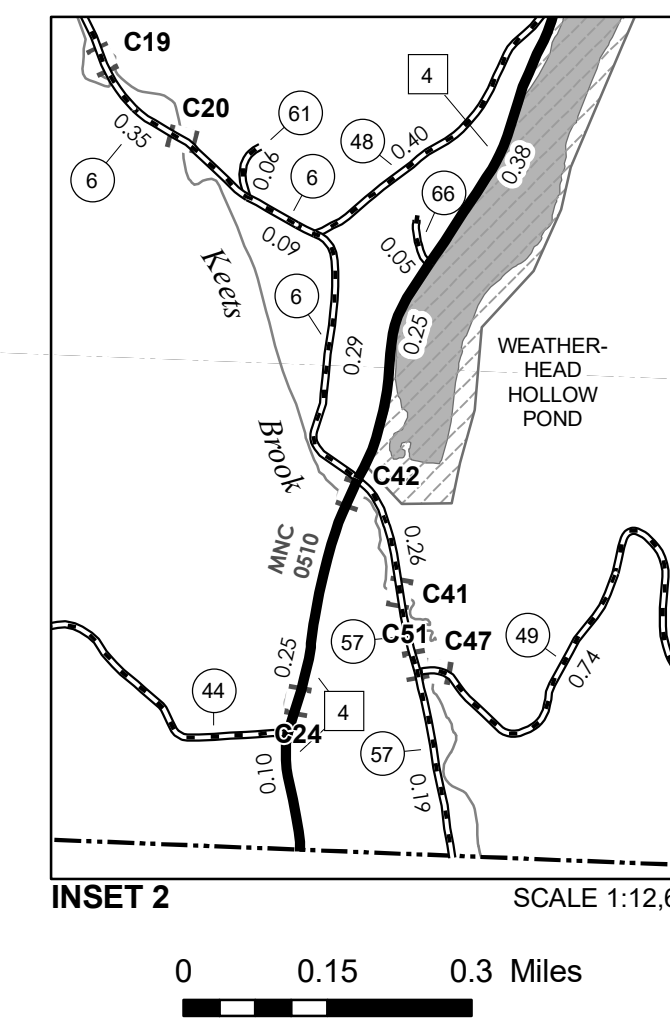
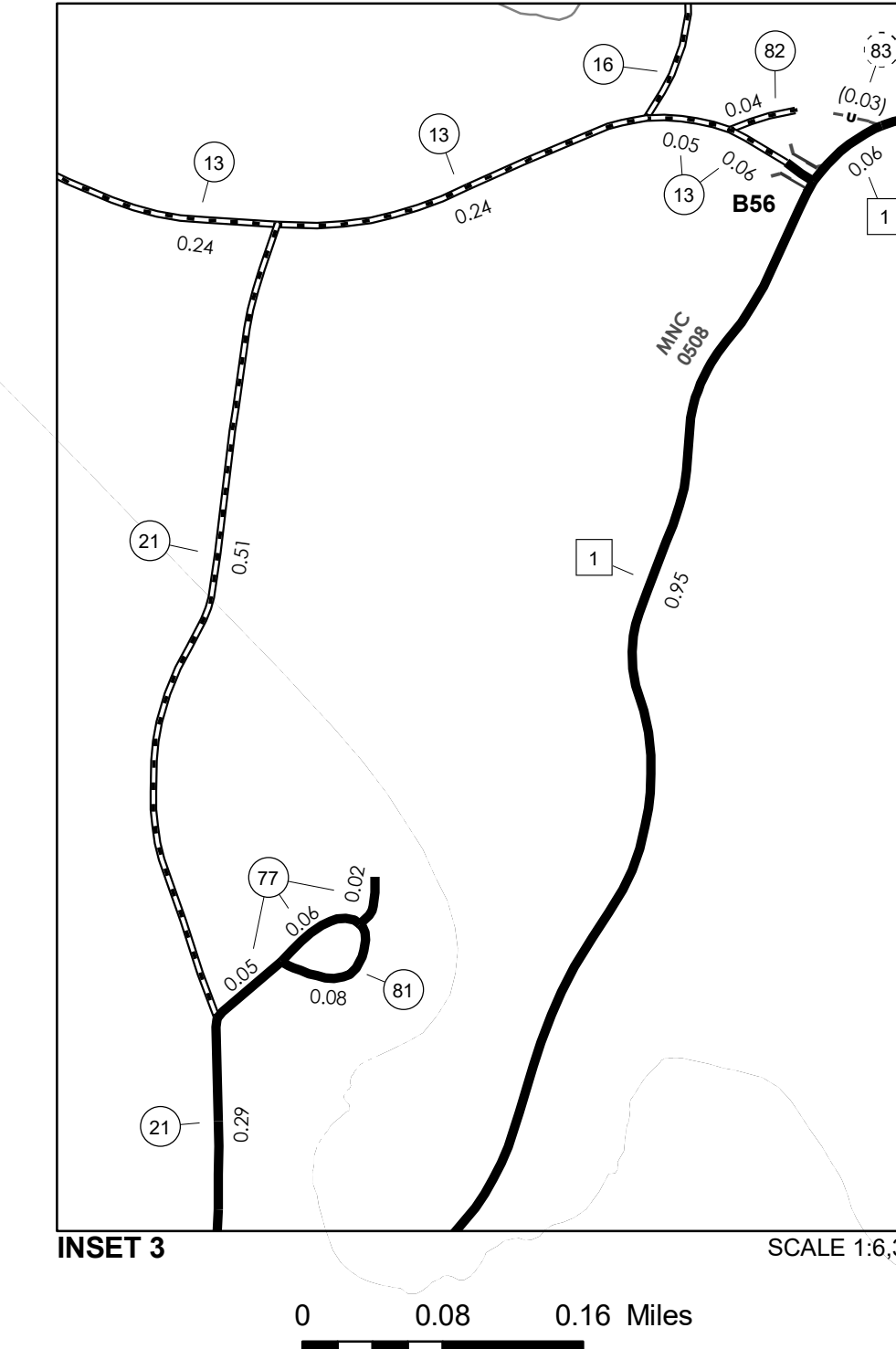
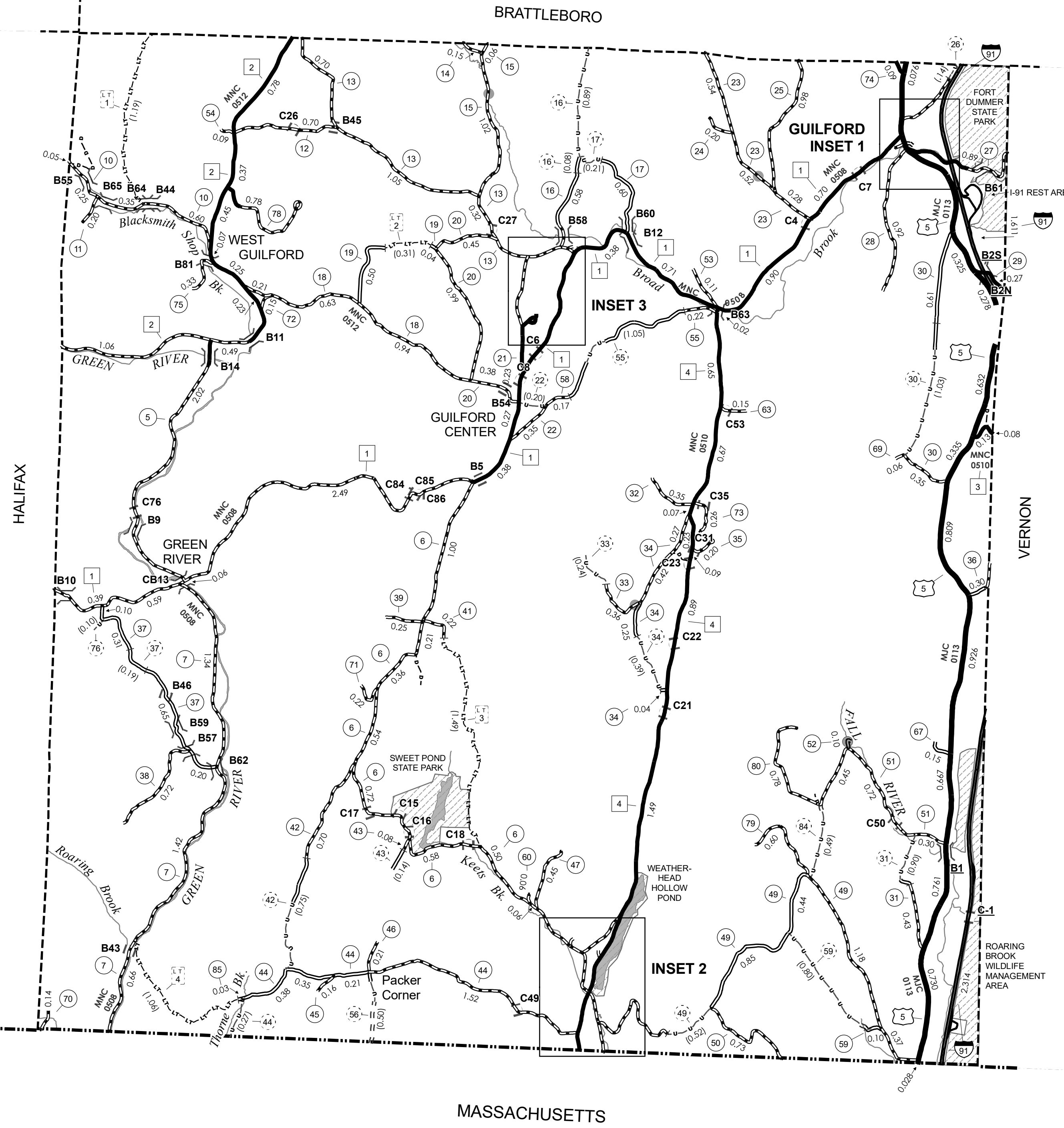

VERMONT GENERAL HIGHWAY MAP

Town of Guilford

WINDHAM COUNTY
 Transportation District #2

Prepared by the
 Vermont Agency of Transportation
 Highway Division
 in cooperation with

U.S. Department of Transportation
 Federal Highway Administration

Mileage as of February 10, 2026
 Map prepared May 27, 2026

SCALE 1:31,680

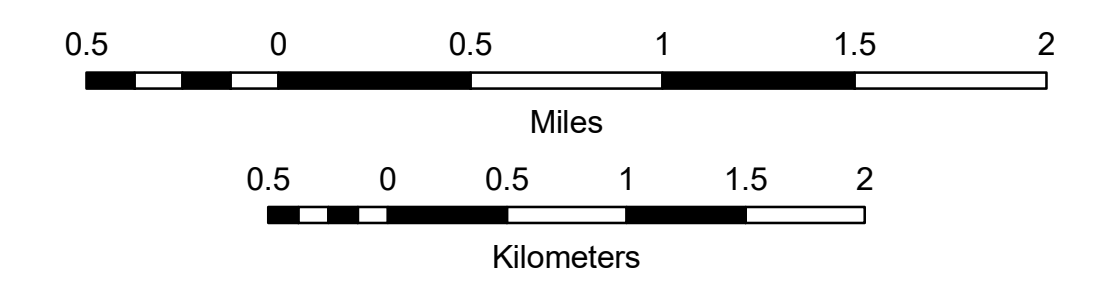

- HIGHWAYS**
 - INTERSTATE
 - U.S. ROUTE
 - STATE ROUTE
 - CLASS 1
 - CLASS 2
 - CLASS 3
 - CLASS 4
 - LEGAL TRAIL
 - PARK AND RIDE
- INTERSTATE OR DIVIDED HIGHWAY
- STATE - HARD SURFACE OR PAVED
- TOWN - HARD SURFACE OR PAVED
- GRAVEL
- SOIL OR GRADED AND DRAINED EARTH
- UNIMPROVED OR PRIMITIVE
- IMPASSABLE OR UNTRAVELED
- HIGHWAY CLASS CHANGE
- RAILROAD
- INACTIVE RAILROAD
- PUBLIC LAND - NATIONAL FOREST
- PUBLIC LAND - STATE/MUNICIPAL
- NFR NATIONAL FOREST ROAD
- ACE ARMY CORPS OF ENGINEERS
- USGH UNITED STATES GOV. HWY.

- POLITICAL SUBDIVISIONS**
 - STATE BOUNDARY
 - COUNTY BOUNDARY
 - TOWN BOUNDARY
 - VILLAGE BOUNDARY
 - URBAN COMPACT BOUNDARY
 - WATER BODY
 - STREAM OR BROOK
- BRIDGE OR CULVERT**
 - BRIDGE OR CULVERT > 20'
 - BRIDGE OR CULVERT 6' - 20'
 - BIKE PATH STRUCTURE
 - VT CULVERTS BRIDGE
 - VT CULVERTS CULVERT > 6'
- BRIDGE OR CULVERT IDENTIFIER**
 - MA MINOR ARTERIAL
 - MJC MAJOR COLLECTOR
 - MNC MINOR COLLECTOR
 - PA PRINCIPAL ARTERIAL
- STATE BRIDGE OR CULVERT IDENTIFIER**
 - B34 / C34
 - TOWN BRIDGE OR CULVERT IDENTIFIER

DISCLAIMER:
 The untraveled highways (laid-out town highways), discontinued highways, and legal trails herein are those of which the Agency of Transportation has record; others may exist.

Highway and bridge data by the Agency of Transportation. Town short structures drawn from the VT CULVERTS (formerly VOBCIT) online database. All other data from the Vermont Open Geodata Portal. Only named streams shown.

Accessibility Statement: The Agency of Transportation is committed to ensuring accessibility and digital accessibility for all. If you need language assistance, reasonable accommodation, or alternative format, please email johnathan.croft@vermont.gov.

Vermont State Plane Coordinate System
 North American Datum of 1983
 SPCS_Zone_Identifier: 4400
 Geodetic Reference System 80
 4,000-meter grid, Easting - Northing