

TOWN HWY. No.	LENGTH IN MILES CLASS 3	LENGTH IN MILES CLASS 4	TOWN HWY. No.	LENGTH IN MILES CLASS 3	LENGTH IN MILES CLASS 4
5	2.02		46	0.21	
6	4.70		47	0.45	
7	3.42		48	0.40	
10	1.25		49	3.58	(0.52)
11	0.20		50	0.73	
12	0.70		51	1.47	
13	2.66		52	0.10	
14	0.15		53	0.11	
15	1.08		54	0.09	
16	0.58	(0.97)	55	0.22	(1.05)
17	0.60	(0.21)	56		(0.50)
18	1.78		57	0.45	
19	0.54		58	0.17	
20	1.82		59	0.10	(0.80)
21	0.80		60	0.06	
22	0.35	(0.20)	61	0.06	
23	1.34		63	0.15	
24	0.20		64	0.07	
25	0.35		65	0.06	
26	0.45	(0.14)	66	0.05	
27	0.89		67	0.15	
28	0.92		69	0.06	
29	0.27		70	0.14	
30	0.96	(1.03)	71	0.22	
31	0.43	(0.90)	72	0.15	
32	0.35		73	0.29	
33	0.36	(0.24)	74	0.09	
34	0.98	(0.39)	75	0.33	
35	0.20		76		(0.10)
36	0.30		77	0.13	
37	1.26	(0.19)	78	0.78	
38	0.72		79	0.60	
39	0.25		80	0.78	
41	0.22		81	0.08	
42	0.70	(0.75)	82	0.04	
43	0.08	(0.14)	83		(0.03)
44	2.46	(0.27)	84		(0.49)
45	0.16		85	0.03	
<b>TOTAL</b>			<b>49.53</b>	<b>8.92</b>	

LEGAL TRAIL No.	LENGTH IN MILES LEGAL TRAIL
1	(1.19)
2	(0.31)
3	(1.49)
4	(1.06)
<b>TOTAL</b>	<b>4.05</b>

MILEAGE SUMMARY		
CLASS 2		
TH-1	8.250	
TH-2	3.700	
TH-3	0.210	
TH-4	5.090	
	<b>TOTAL CLASS 2</b>	<b>17.250</b>
	<b>TOTAL CLASS 3</b>	<b>49.53</b>
	<b>TOTAL TOWN</b>	<b>66.780</b>
US HIGHWAY US-5	6.758	
	<b>TOTAL US HIGHWAY</b>	<b>6.758</b>
	<b>TOTAL STATE</b>	<b>6.758</b>
INTERSTATE I-91	3.925	
	<b>TOTAL INTERSTATE</b>	<b>3.925</b>
	<b>TOTAL INTERSTATE</b>	<b>3.925</b>

**TOTAL, TRAVELED HIGHWAYS, FEB. 10, 2024: 77.463**  
 (Excludes Class 4 and Legal Trail Mileage)

- HIGHWAYS**
  - INTERSTATE
  - U.S. ROUTE
  - STATE ROUTE
  - CLASS 1
  - CLASS 2
  - CLASS 3
  - CLASS 4
  - LEGAL TRAIL
  - PARK AND RIDE
- INTERSTATE OR DIVIDED HIGHWAY
- STATE - HARD SURFACE OR PAVED
- TOWN - HARD SURFACE OR PAVED
- GRAVEL
- SOIL OR GRADED AND DRAINED EARTH
- UNIMPROVED OR PRIMITIVE
- IMPASSABLE OR UNTRAVELED
- LEGAL TRAIL
- DISCONTINUED
- HIGHWAY CLASS CHANGE
- RAILROAD
- INACTIVE RAILROAD
- PUBLIC LAND - NATIONAL FOREST
- PUBLIC LAND - STATE/MUNICIPAL
- NFR NATIONAL FOREST ROAD
- ACE ARMY CORPS OF ENGINEERS
- USGH UNITED STATES GOV. HWY.

- POLITICAL SUBDIVISIONS**
  - STATE BOUNDARY
  - COUNTY BOUNDARY
  - TOWN BOUNDARY
  - VILLAGE BOUNDARY
  - URBAN COMPACT BOUNDARY
  - WATER BODY
  - STREAM OR BROOK
- BRIDGE OR CULVERT**
  - BRIDGE OR CULVERT > 20'
  - BRIDGE OR CULVERT 6' - 20'
  - BIKE PATH STRUCTURE
  - VT CULVERTS BRIDGE
  - VT CULVERTS CULVERT > 6'
- STATE BRIDGE OR CULVERT IDENTIFIER**
- TOWN BRIDGE OR CULVERT IDENTIFIER**

- FEDERAL CLASSIFICATION IDENTIFIER**
  - MA MINOR ARTERIAL
  - MJC MAJOR COLLECTOR
  - MNC MINOR COLLECTOR
  - PA PRINCIPAL ARTERIAL

**DISCLAIMER:**  
 The untraveled highways (laid-out town highways), discontinued highways, and legal trails herein are those of which the Agency of Transportation has record; others may exist.  
 Highway and bridge data by the Agency of Transportation. Town short structures drawn from the VTCULVERTS (formerly VOBCT) online database. All other data from the Vermont Open Geodata Portal. Only named streams shown.

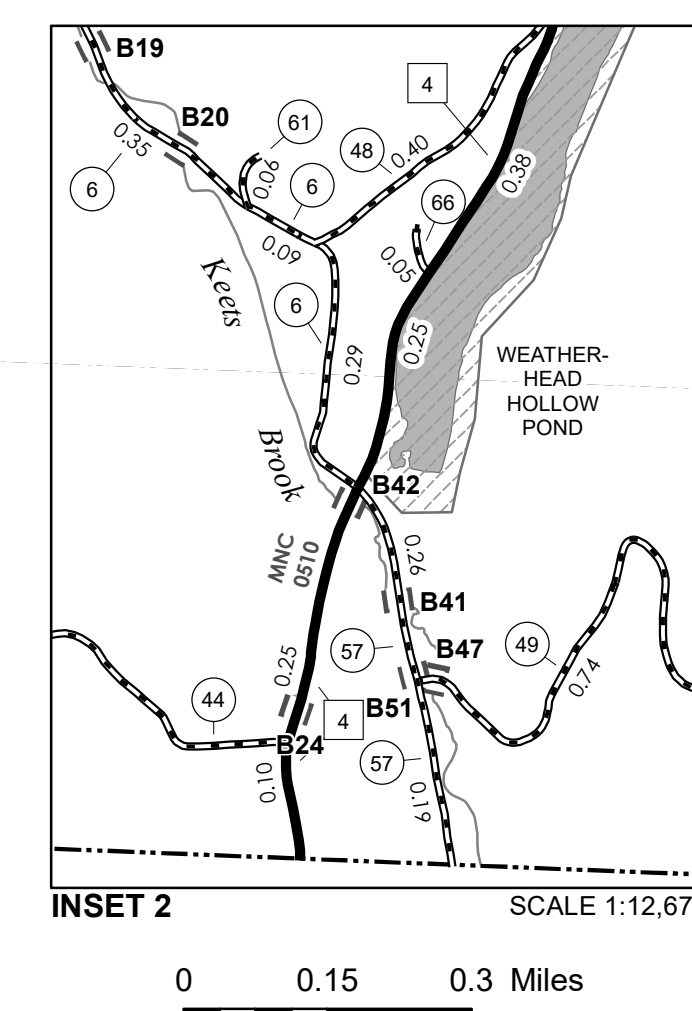
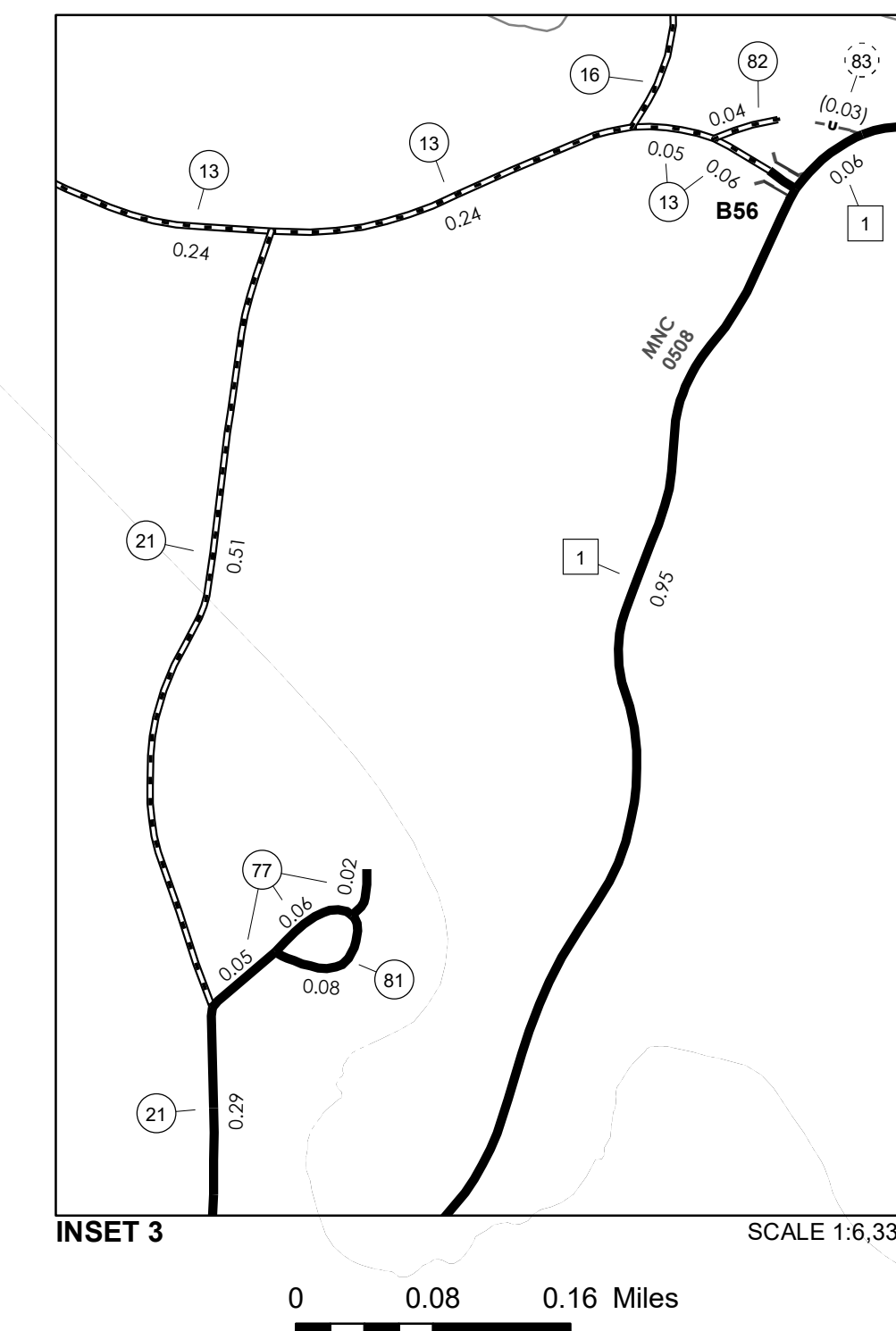
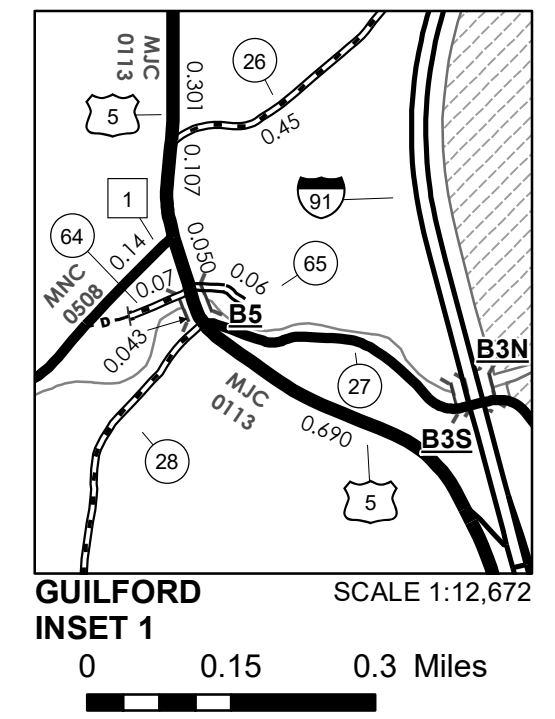

**VERMONT**  
**GENERAL HIGHWAY MAP**  
**Town of Guilford**  
 WINDHAM COUNTY  
 Transportation District #2  
 Prepared by the  
 Vermont Agency of Transportation  
 Division of Policy, Planning and Intermodal Development  
 in cooperation with  
 U.S. Department of Transportation  
 Federal Highway Administration  
 Mileage as of February 10, 2024  
 Map prepared August 05, 2024  
 SCALE 1:31,680

0.5 0 0.5 1 1.5 2 Miles  
 0.5 0 0.5 1 1.5 2 Kilometers