

TOWN HWY. No.	LENGTH IN MILES CLASS 3	CLASS 4	TOWN HWY. No.	LENGTH IN MILES CLASS 3	CLASS 4
6	0.05		49	0.16	
7	0.34		50	0.58	
8	3.37		51	0.06	
9	1.80		52	0.25	
10	0.15		53	0.25	
11	0.29		54	0.05	
12	0.33		55	0.22	
13	0.29		56	0.24	
14	0.72	(0.58)	57	0.74	
15	3.85		58	0.31	
16	0.75		59	0.08	
17	0.95		60	0.36	
18	0.54		65	0.97	
19	3.34		66	0.73	
20	0.32		67	0.85	
21	0.95		68	0.75	
22	1.07		69	0.35	
23	1.56		70	0.51	
24	0.60		71	0.71	
25	1.02		72	0.05	
26	1.37		73	0.20	
27	1.02		74	0.72	
28	1.77		75	0.12	
29		(0.85)	76	0.18	
30	0.45		77	0.71	
31	1.56		78	0.41	
33	0.15		79	1.09	
34	0.22		81	0.20	
35	0.06		82	0.17	
38	0.06		83	0.22	
39	0.40	(0.10)	84	0.04	
41	0.40		85	0.08	
42	2.91		86	0.03	
43	0.65		87	0.24	
44	0.28		88	0.53	
45	0.64		89	0.20	
46	0.17		90	0.66	
47	0.37		91	0.23	
48	0.17		92		(0.51)
TOTAL			49.19	2.04	

TOWN HWY. No.	LENGTH IN MILES "NOT UP TO STANDARD"	LEGAL TRAIL No.	LENGTH IN MILES LEGAL TRAIL
15	(0.53)	2	(0.29)
TOTAL	0.53	3	(0.50)
		4	(2.00)
		5	(2.30)
		6	(1.00)
		7	(0.33)
		9	(0.72)
		10	(0.99)
		11	(0.32)
		12	(1.42)
		13	(0.08)
		14	(0.03)
		15	(0.59)
		16	(0.50)
TOTAL		11.07	

MILEAGE SUMMARY

CLASS 2		
TH-1	4.370	
TH-2	2.000	
TH-3	1.540	
TH-4	1.380	
TH-5	1.090	
TOTAL CLASS 2	10.380	
CLASS 3		
TOTAL CLASS 3	49.19	
TOTAL TOWN	59.570	
STATE HIGHWAY		
VT-100	5.547	
TOTAL STATE HIGHWAY	5.547	
TOTAL STATE	5.547	

TOTAL, TRAVELED HIGHWAYS, FEB. 10, 2026: 65.117
(Excludes Class 4 and Legal Trail Mileage)

- HIGHWAYS**
- INTERSTATE
 - U.S. ROUTE
 - STATE ROUTE
 - CLASS 1
 - CLASS 2
 - CLASS 3
 - CLASS 4
 - LEGAL TRAIL
 - PARK AND RIDE
 - INTERSTATE OR DIVIDED HIGHWAY
 - STATE - HARD SURFACE OR PAVED
 - TOWN - HARD SURFACE OR PAVED
 - GRAVEL
 - SOIL OR GRADED AND DRAINED EARTH
 - UNIMPROVED OR PRIMITIVE
 - IMPASSABLE OR UNTRAVELED
 - LEGAL TRAIL
 - DISCONTINUED
 - HIGHWAY CLASS CHANGE
 - RAILROAD
 - INACTIVE RAILROAD
 - PUBLIC LAND - NATIONAL FOREST
 - PUBLIC LAND - STATE/MUNICIPAL
 - NATIONAL FOREST ROAD
 - ARMY CORPS OF ENGINEERS
 - UNITED STATES GOV. HWY.

- POLITICAL SUBDIVISIONS**
- STATE BOUNDARY
 - COUNTY BOUNDARY
 - TOWN BOUNDARY
 - VILLAGE BOUNDARY
 - URBAN COMPACT BOUNDARY
 - WATER BODY
 - STREAM OR BROOK
- BRIDGE OR CULVERT**
- BRIDGE OR CULVERT > 20'
 - BRIDGE OR CULVERT 6' - 20'
 - BIKE PATH STRUCTURE
 - VT CULVERTS BRIDGE
 - VT CULVERTS CULVERT > 6'
 - STATE BRIDGE OR CULVERT IDENTIFIER
 - TOWN BRIDGE OR CULVERT IDENTIFIER

- FEDERAL CLASSIFICATION IDENTIFIER**
- MA MINOR ARTERIAL
 - MJC MAJOR COLLECTOR
 - MNC MINOR COLLECTOR
 - PA PRINCIPAL ARTERIAL

DISCLAIMER:
The untraveled highways (laid-out town highways), discontinued highways, and legal trails herein are those of which the Agency of Transportation has record; others may exist.

Highway and bridge data by the Agency of Transportation. Town short structures drawn from the VT CULVERTS (formerly VOBCT) online database. All other data from the Vermont Open Geodata Portal. Only named streams shown.

Accessibility Statement: The Agency of Transportation is committed to ensuring accessibility and digital accessibility for all. If you need language assistance, reasonable accommodation, or alternative format, please email johnathan.croft@vermont.gov.

Vermont State Plane Coordinate System
North American Datum of 1983
SPCS_Zone_Identifier: 4400
Geodetic Reference System 80
4,000-meter grid, Easting - Northing

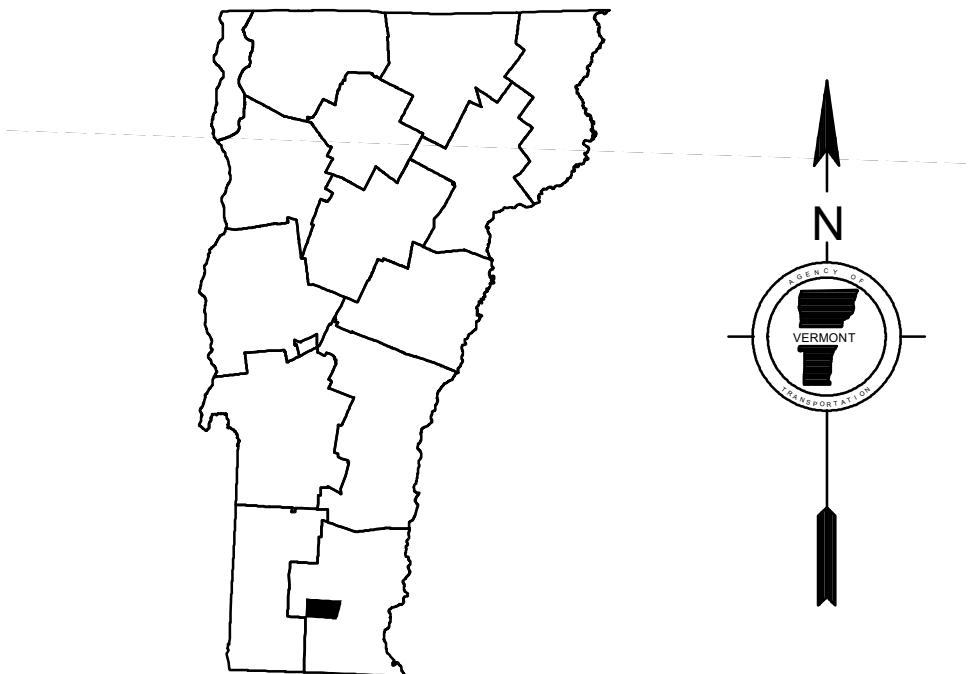
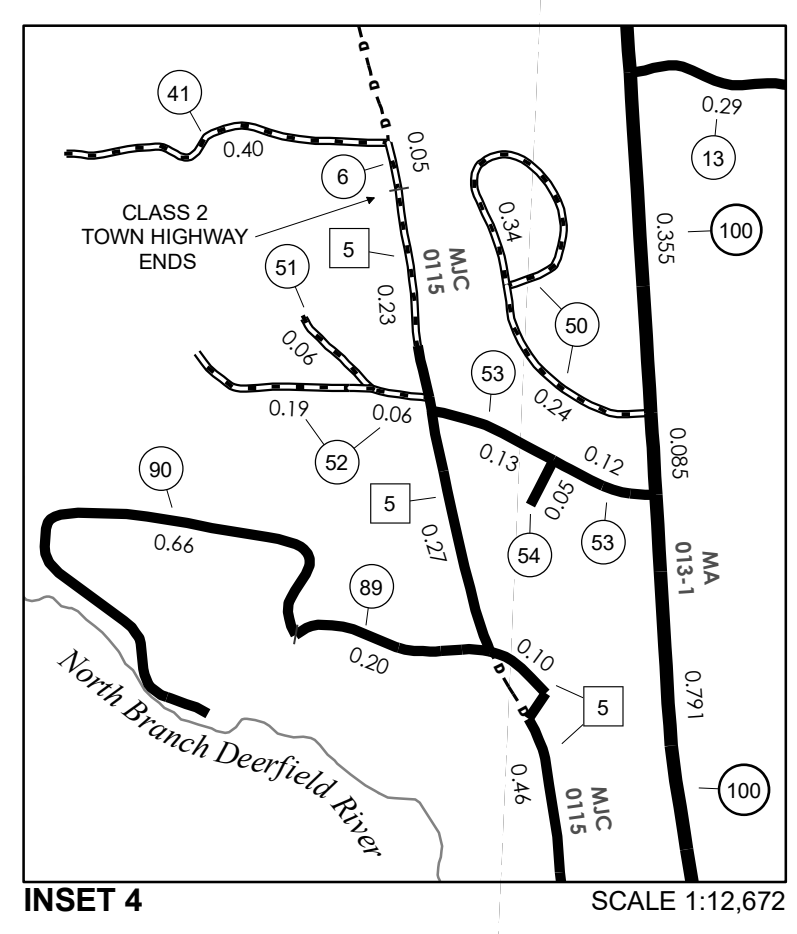
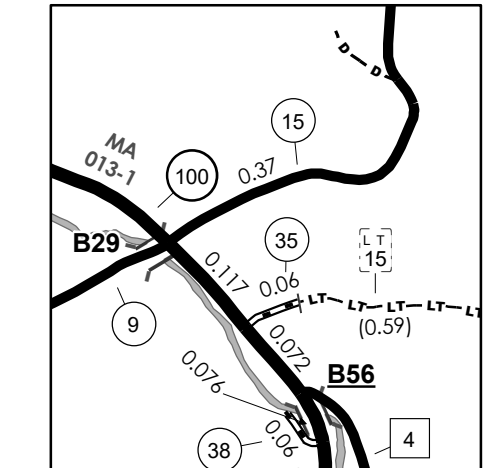
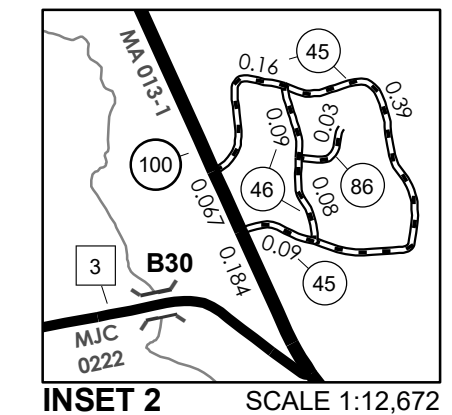
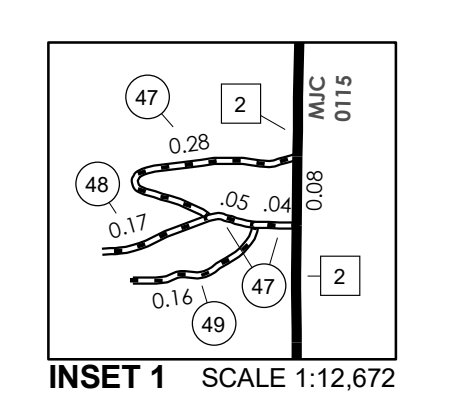

VERMONT GENERAL HIGHWAY MAP
Town of Dover
WINDHAM COUNTY
Transportation District #1

Prepared by the
Vermont Agency of Transportation
Highway Division
in cooperation with
U.S. Department of Transportation
Federal Highway Administration

Mileage as of February 10, 2026
Map prepared May 27, 2026
SCALE 1:25,344

0 0.35 0.7 1.05 1.4 Miles
0.4 0 0.4 0.8 1.2 1.6 Kilometers