

TOWN HWY. No.	LENGTH IN MILES CLASS 3	LENGTH IN MILES CLASS 4	TOWN HWY. No.	LENGTH IN MILES CLASS 3	LENGTH IN MILES CLASS 4
2		(0.51)	388	0.12	
4		(1.87)	390		(0.15)
6		(0.10)	392	0.25	
8	0.94		393	0.06	
10	0.49		395	0.22	
12	3.30		396	0.18	
14	0.20		397	0.16	
18	0.10		398	0.36	
20	0.73	(0.89)	400	0.41	
23	0.11		402	0.09	
24	2.03		404	0.17	
25	0.81		406	0.41	
26	1.87		408	0.05	(0.09)
27	0.18		410	0.13	
28	0.68		412	0.09	
29	0.52		414	0.14	
30	1.09		416	0.23	
32	1.43		418	0.37	
34	0.31		419	0.08	
35	0.31		420	0.19	(0.15)
36	1.98		422	0.07	
38	0.32		423	0.04	
40	0.81		424	0.05	
41	0.09		426	0.04	
42	0.75		428	0.44	
43	0.23		430	0.18	
44	0.04		432	0.04	
46	0.34		434	0.34	
47	0.06		438	0.04	
48	0.50	(1.14)	442	0.20	
50	0.28	(1.11)	444	0.34	
52	1.25		445	0.06	
54	0.94	(0.28)	446	0.37	
56	0.96	(0.69)	448	0.18	
58	0.38		450	0.10	
60	1.21		452	0.10	
62	1.10		454	0.03	
64	0.10		455	0.13	
66	0.38		456	0.09	
68	2.32		458	0.11	
70	0.19	(0.37)	460	0.07	
72	1.77		462	0.40	
73	0.23		464	0.07	
74	0.47		466	0.08	
76	1.54		468	0.22	
78	0.16		470	0.06	
80	0.01		472	0.06	
82	0.21		474	0.05	
83	0.66		476	0.06	
84	0.13		478	0.09	
85	0.42		480	0.38	
86	0.14		481	0.04	
87	0.51		482	0.11	
88	0.20		484	0.09	
89	0.11		486	0.31	
90		(0.12)	488	0.29	
91	0.54		490	0.23	
92	1.27		492	0.07	
300	0.32		494	0.32	
302	0.10		496	0.27	
304	0.31		498	0.25	
306	0.32		500	0.12	
308	0.16		502	0.04	
310	0.18		504	0.38	
314	0.31		506	0.06	
316	0.10		508	0.05	
317	0.04		510	0.07	
318	0.15		512	0.40	
319	0.06		514	0.31	
320	0.11		516	0.12	
322	0.09		518	0.17	
324	0.75		520	0.08	
326	0.10		522	0.26	
327	0.03		524	0.21	
328	0.25		526	0.03	
329		(0.09)	528	0.07	
330	0.15		530	0.56	
332	0.30		532	0.03	
334	0.12		534	0.09	
336	0.16		536	0.21	
338	0.05		538	0.31	
340	0.27		540	0.06	
342	0.13		542	0.04	
344	0.04		544	0.07	
346	0.20		546	0.04	
350	0.13		548	0.42	
352	0.04		549	0.20	
354	0.09		700	0.21	
355	0.48		701	0.03	
356	0.30		702	0.08	
358	0.07		703	0.32	
360	0.18		704	0.16	
362	0.10		705	0.18	
364	0.13		706	0.33	
366	0.19		707	0.66	
368	0.10		708	0.45	
370	0.05		709	0.09	
372	0.17		710	0.35	
375	0.04		711	0.11	
376	0.12		712	0.12	
378	1.09		714	0.28	
380	0.19		715	0.17	
382	0.20		716	0.31	
384	0.11		717	0.15	
386	0.15				
<b>TOTAL</b>	<b>65.01</b>	<b>7.56</b>			

**MILEAGE SUMMARY**

CLASS 1		
TH-1	2.168	
TH-2	2.792	
TH-3	0.326	
TH-4	1.069	
<b>TOTAL CLASS 1</b>	<b>6.355</b>	
CLASS 1 - Ramps		
TH-1	0.065	
<b>TOTAL CLASS 1 - Ramps</b>	<b>0.065</b>	
CLASS 2		
TH-5	2.850	
TH-6	3.800	
TH-7	0.080	
TH-8	3.030	
TH-9	2.060	
TH-10	1.670	
TH-11	0.400	
<b>TOTAL CLASS 2</b>	<b>13.890</b>	
CLASS 3		
<b>TOTAL CLASS 3</b>	<b>65.01</b>	
<b>TOTAL TOWN</b>	<b>85.320</b>	
STATE HIGHWAY		
VT-9	4.412	
VT-30	3.254	
VT-142	1.098	
NSH-BSH	0.135	
<b>TOTAL STATE HIGHWAY</b>	<b>8.899</b>	
US HIGHWAY		
US-5	3.599	
<b>TOTAL US HIGHWAY</b>	<b>3.599</b>	
<b>TOTAL STATE</b>	<b>12.498</b>	
INTERSTATE		
I-91	6.085	
<b>TOTAL INTERSTATE</b>	<b>6.085</b>	
INTERSTATE - Ramps		
I-91	3.624	
<b>TOTAL INTERSTATE - Ramps</b>	<b>3.624</b>	
<b>TOTAL INTERSTATE</b>	<b>9.709</b>	
<b>TOTAL, TRAVELED HIGHWAYS, FEB. 10, 2016:</b>	<b>107.527</b>	
<small>(Excludes Class 4 and Legal Trail Mileage)</small>		

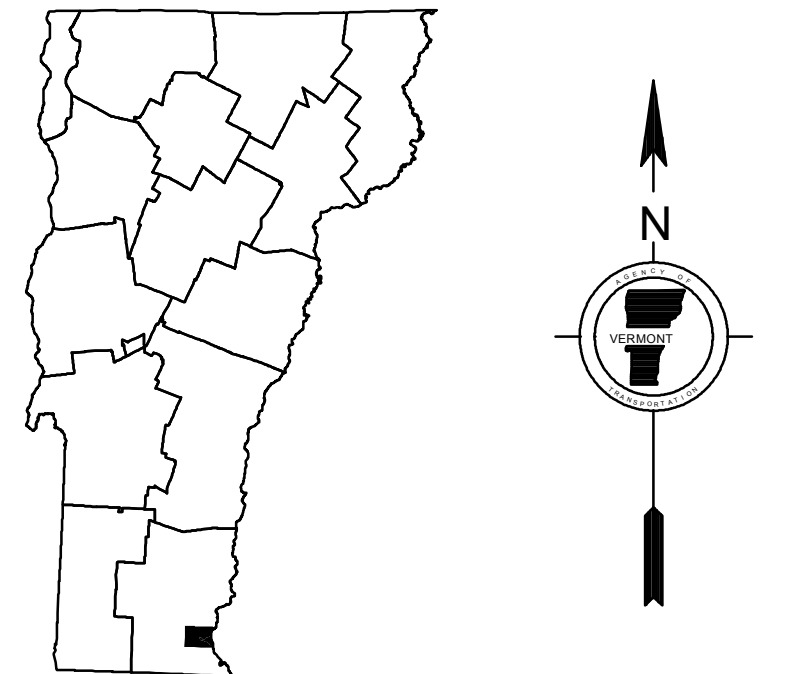
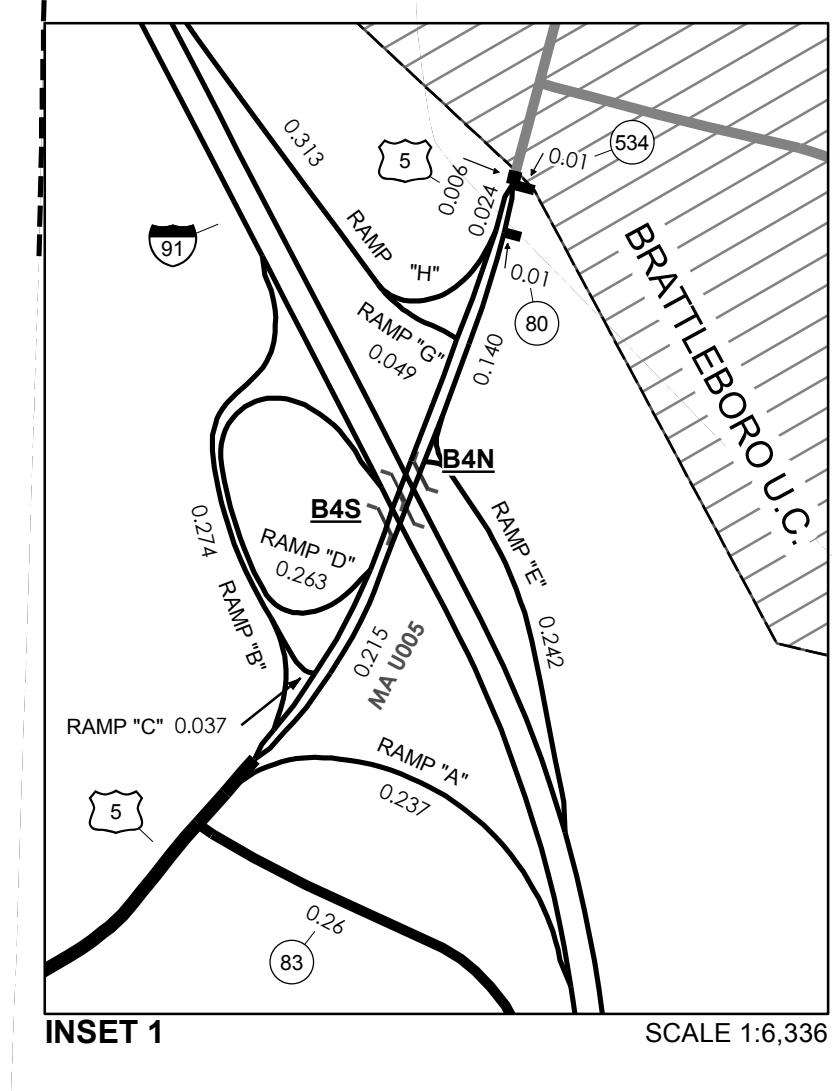
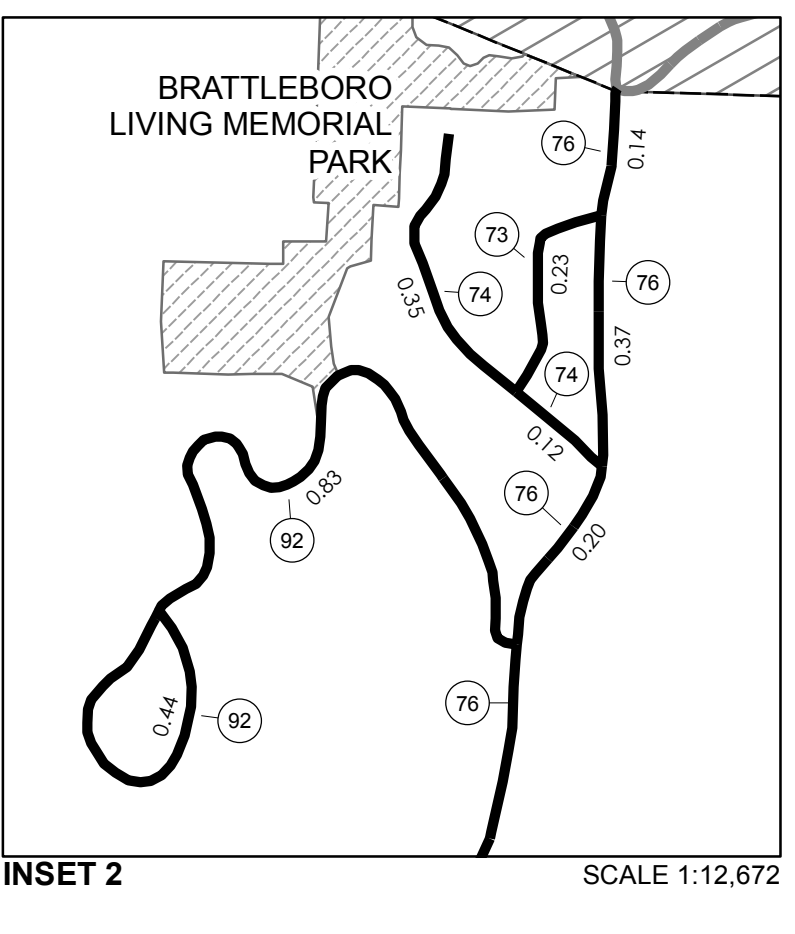
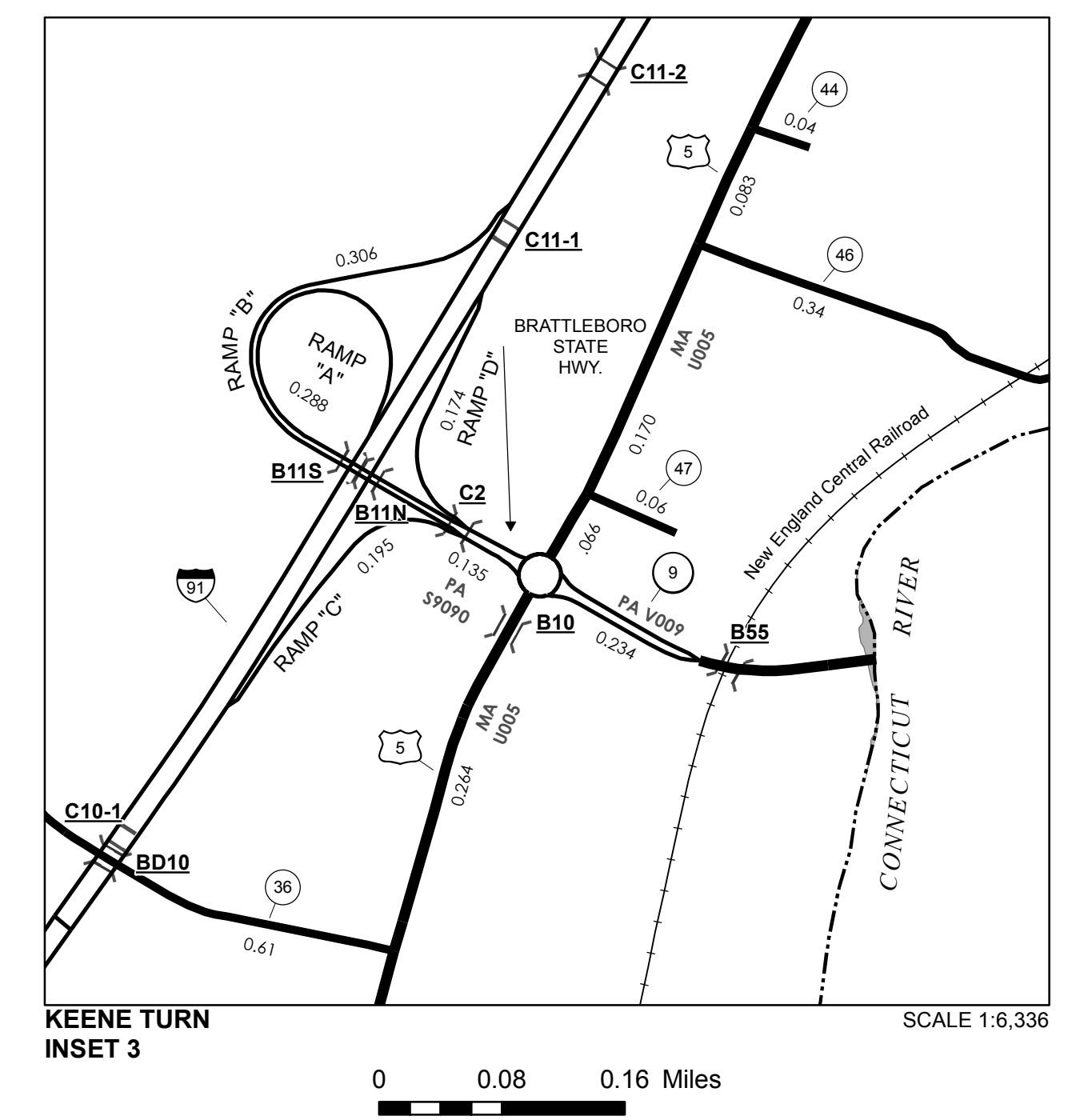

**VERMONT**  
**GENERAL HIGHWAY MAP**  
**Town of Brattleboro**  
 WINDHAM COUNTY  
 Transportation District #2  
 Prepared by the  
 Vermont Agency of Transportation  
 Division of Policy, Planning and Intermodal Development  
 in cooperation with  
 U.S. Department of Transportation  
 Federal Highway Administration  
 Mileage as of February 10, 2016  
 Map prepared July 20, 2016  
 SCALE 1:31,680  
 0.5 0 0.5 1 1.5 2 Miles  
 0.5 0 0.5 1 1.5 2 Kilometers

**DISCLAIMER:**  
 The untraveled highways (laid-out town highways), discontinued highways, and legal trails hereon are those of which the Agency of Transportation has record; others may exist.

Highway and bridge data by the Agency of Transportation. Town short structures are drawn from the Vermont Online Bridge & Culvert Inventory Tool (VOBCIT) database. All other data from the Vermont Center for Geographic Information. Only named streams are shown.

Vermont State Plane Coordinate System  
 North American Datum of 1983  
 SPCS\_Zone\_Identifier: 4400  
 Geodetic Reference System 80  
 4,000-meter grid, Easting - Northing