

484,000 488,000 492,000 496,000 500,000 504,000 508,000

220,000 220,000

216,000 216,000

212,000 212,000

208,000 208,000

204,000 204,000

TOWN HWY. NO.	LENGTH IN MILES CLASS 3	LENGTH IN MILES CLASS 4
3	1.930	(0.300)
4	3.280	(0.730)
5	0.610	(0.350)
7	1.680	
8	0.730	
9	0.100	
11	0.510	
12	0.170	
13	0.420	
14	0.100	
15	0.750	
16	0.080	
19	0.110	
* 19		(0.060)
20	0.100	
22	0.320	
26	0.110	
27		(0.200)
28	1.060	(0.940)
29	0.200	
30	2.200	
31	0.050	(0.150)
33	0.260	(0.040)
39	0.260	
<b>TOTAL</b>	<b>15.030</b>	<b>2.770</b>

LEGAL TRAIL NO.	LENGTH IN MILES
1	(2.050)
2	(0.670)
3	(1.030)
4	(0.300)
5	(0.300)
6	(0.900)
7	(1.400)
8	(0.700)
9	(0.630)
10	(0.200)
11	(0.080)
<b>TOTAL</b>	<b>8.260</b>

\* This portion of town highway is Class 3, but is functionally Class 4

**MILEAGE SUMMARY**

CLASS 2		
TH-1	2.000	
TH-2	3.770	
<b>TOTAL CLASS 2</b>	<b>5.770</b>	
CLASS 3		
<b>TOTAL CLASS 3</b>	<b>15.030</b>	
<b>TOTAL TOWN</b>	<b>20.800</b>	
STATE HIGHWAY		
VT-12	7.853	
<b>TOTAL STATE HIGHWAY</b>	<b>7.853</b>	
<b>TOTAL STATE</b>	<b>7.853</b>	

**TOTAL, TRAVELED HIGHWAYS, FEB. 10, 2007: 28.653**  
(Excludes Class 4 and Legal Trail Mileage)

- HIGHWAYS**
- INTERSTATE
- U.S. ROUTE
- STATE ROUTE
- CLASS 1
- CLASS 2
- CLASS 3
- CLASS 4
- LEGAL TRAIL
- INTERSTATE OR DIVIDED HIGHWAY
- STATE - HARD SURFACE OR PAVED
- TOWN - HARD SURFACE OR PAVED
- GRAVEL
- SOIL OR GRADED AND DRAINED EARTH
- UNIMPROVED OR PRIMITIVE
- IMPASSABLE OR UNTRAVELED
- LEGAL TRAIL
- DISCONTINUED
- HIGHWAY CLASS CHANGE
- RAILROAD
- FEDERAL CLASSIFICATION IDENTIFIER**
- FAU URBAN ARTERIAL OR COLLECTOR
- MA MINOR ARTERIAL
- MJC MAJOR COLLECTOR
- MNC MINOR COLLECTOR
- PA PRINCIPAL ARTERIAL
- PUBLIC LAND
- POLITICAL SUBDIVISIONS**
- STATE BOUNDARY
- COUNTY BOUNDARY
- TOWN BOUNDARY
- VILLAGE BOUNDARY
- URBAN COMPACT BOUNDARY
- WATER BODIES**
- OPEN WATER
- SWAMP
- STREAM OR BROOK
- BRIDGE OR CULVERT**
- BRIDGE OR CULVERT GREATER THAN 20'
- BRIDGE OR CULVERT 6' - 20'
- B34 STATE BRIDGE IDENTIFIER
- B34 TOWN BRIDGE IDENTIFIER

**DISCLAIMER:**  
The untraveled highways (laid-out town highways), discontinued highways, and legal trails shown hereon are those of which the Agency of Transportation has record; others may exist.  
Highway and bridge data by the Agency of Transportation, Policy & Planning Division. All other data from the Vermont Center for Geographic Information.

Vermont State Plane Coordinate System  
North American Datum of 1983  
SPCS\_Zone\_Identifier: 4400  
Geodetic Reference System 80  
4,000-meter grid, Easting - Northing

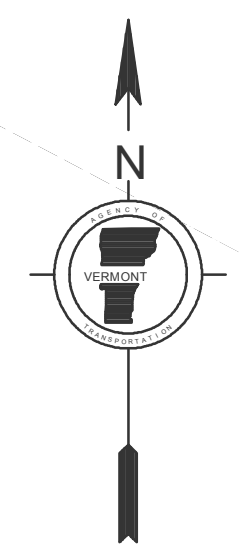
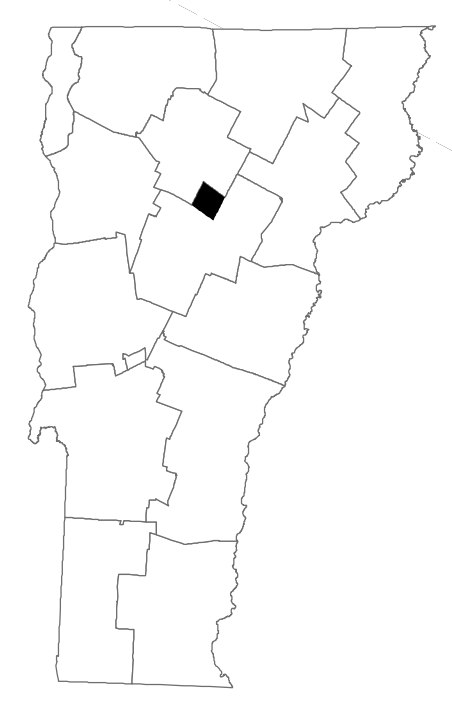
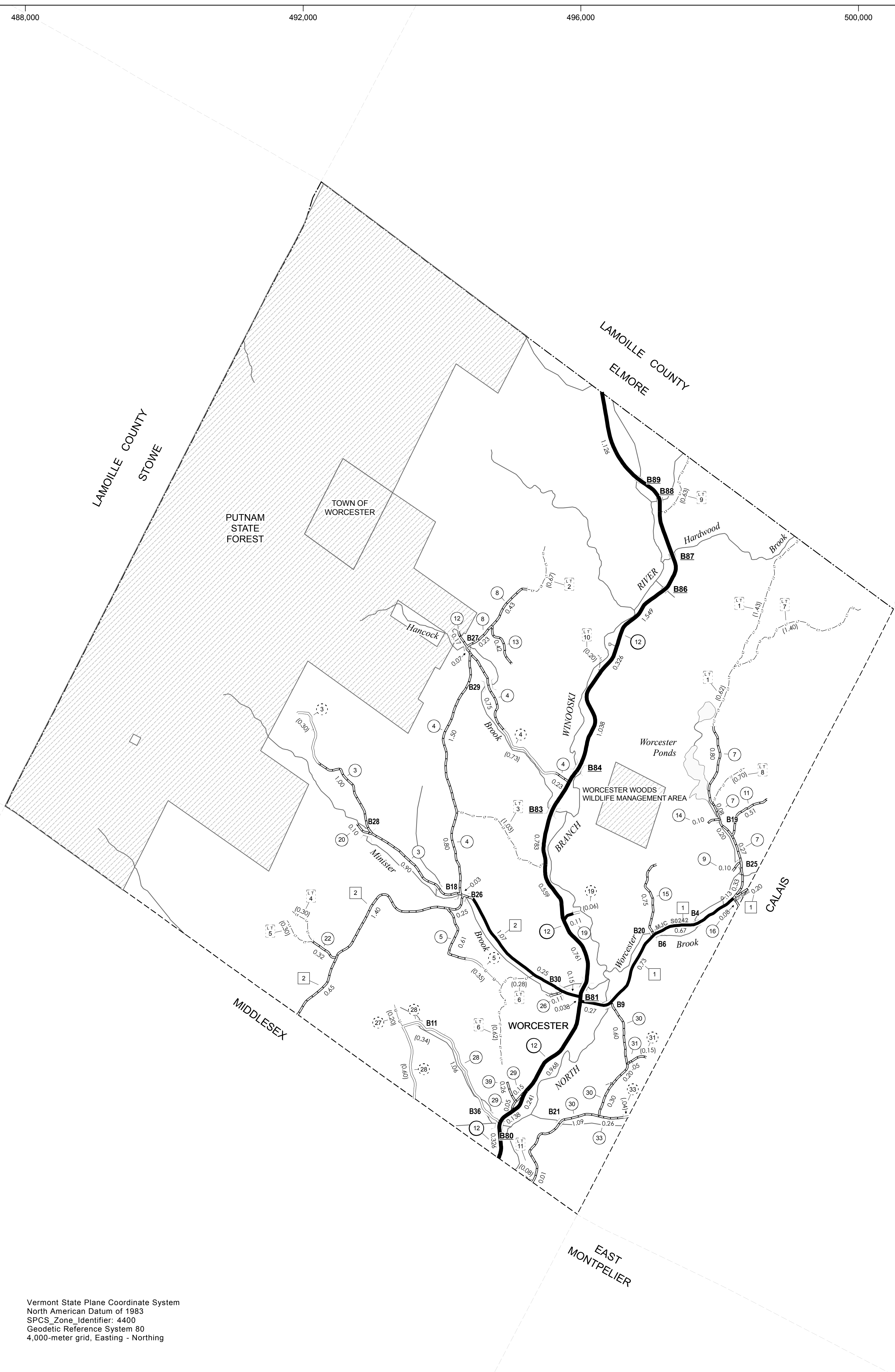

**VERMONT**  
**GENERAL HIGHWAY MAP**  
**Town of Worcester**  
WASHINGTON COUNTY

Transportation District #6

Prepared by the  
Vermont Agency of Transportation  
Policy & Planning Division  
in cooperation with  
U.S. Department of Transportation  
Federal Highway Administration

Mileage as of: Feb. 10, 2007  
Map generated: October, 2007

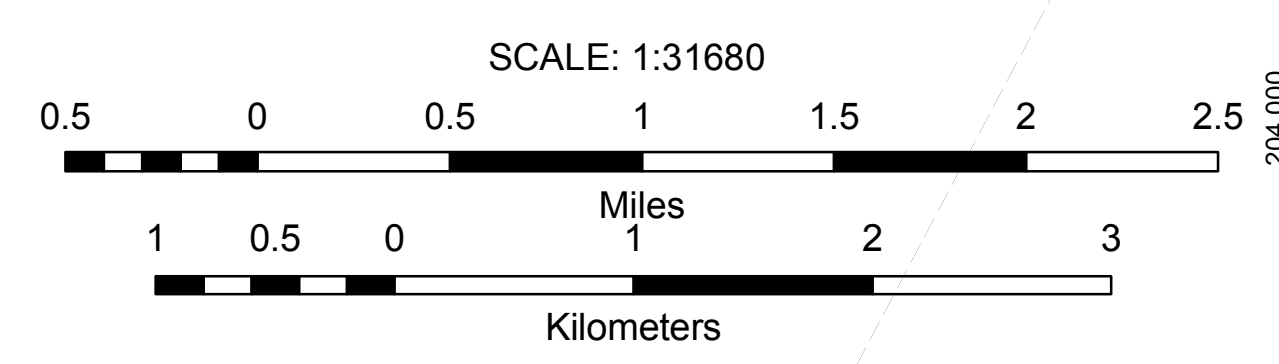

484,000 488,000 492,000 496,000 500,000 504,000 508,000