

TOWN HWY. NO.	LENGTH IN MILES CLASS 3	LENGTH IN MILES CLASS 4
6	0.100	
7	4.690	
8	0.250	
9	0.200	
10	0.170	
11	0.650	
12	0.090	
13	0.780	(0.470)
14	0.250	(0.050)
15	0.500	
16	3.400	
17	0.220	(0.030)
18	3.420	(0.750)
19	0.150	
20	0.600	
21	1.490	
22	0.450	
23	1.030	
24	0.200	
26	2.060	(0.880)
27	0.100	
29	0.700	
30	0.750	(0.250)
31		(0.310)
32	0.050	
33	0.600	(0.300)
34	0.210	(0.090)
* 34		(0.100)
35	0.150	
36	0.220	
37	0.350	
38	1.800	
39	0.200	
40	0.200	(0.040)
<b>TOTAL</b>	<b>26.030</b>	<b>3.270</b>

\* This portion of town highway is Class 3, but is functionally Class 4

**MILEAGE SUMMARY**

CLASS 2			
TH-1	4.650		
TH-2	5.040		
TH-3	0.180		
TH-4	0.050		
TH-5	3.300		
	<b>TOTAL CLASS 2</b>	<b>13.220</b>	
CLASS 3			
	<b>TOTAL CLASS 3</b>	<b>26.030</b>	
	<b>TOTAL TOWN</b>	<b>39.250</b>	
STATE HIGHWAY			
VT-214	0.662		
	<b>TOTAL STATE HIGHWAY</b>	<b>0.662</b>	
US HIGHWAY			
US-2	1.486		
	<b>TOTAL US HIGHWAY</b>	<b>1.486</b>	
	<b>TOTAL STATE</b>	<b>2.148</b>	

**TOTAL, TRAVELED HIGHWAYS, FEB. 10, 2007: 41.398**  
(Excludes Class 4 and Legal Trail Mileage)

- HIGHWAYS**
- INTERSTATE
  - U.S. ROUTE
  - STATE ROUTE
  - CLASS 1
  - CLASS 2
  - CLASS 3
  - CLASS 4
  - LEGAL TRAIL
  - INTERSTATE OR DIVIDED HIGHWAY
  - STATE - HARD SURFACE OR PAVED
  - TOWN - HARD SURFACE OR PAVED
  - GRAVEL
  - SOIL OR GRADED AND DRAINED EARTH
  - UNIMPROVED OR PRIMITIVE
  - IMPASSABLE OR UNTRAVELED
  - LEGAL TRAIL
  - DISCONTINUED
  - HIGHWAY CLASS CHANGE
  - RAILROAD

- PUBLIC LAND**
- POLITICAL SUBDIVISIONS**
- STATE BOUNDARY
  - COUNTY BOUNDARY
  - TOWN BOUNDARY
  - VILLAGE BOUNDARY
  - URBAN COMPACT BOUNDARY
- WATER BODIES**
- OPEN WATER
  - SWAMP
  - STREAM OR BROOK
- BRIDGE OR CULVERT**
- BRIDGE OR CULVERT GREATER THAN 20'
  - BRIDGE OR CULVERT 6' - 20'
- B34 STATE BRIDGE IDENTIFIER**
- B34 TOWN BRIDGE IDENTIFIER**
- FEDERAL CLASSIFICATION IDENTIFIER**
- FAU URBAN ARTERIAL OR COLLECTOR
  - MA MINOR ARTERIAL
  - MJC MAJOR COLLECTOR
  - MNC MINOR COLLECTOR
  - PA PRINCIPAL ARTERIAL

**DISCLAIMER:**

The untraveled highways (laid-out town highways), discontinued highways, and legal trails shown hereon are those of which the Agency of Transportation has record; others may exist.

Highway and bridge data by the Agency of Transportation, Policy & Planning Division. All other data from the Vermont Center for Geographic Information.

Vermont State Plane Coordinate System  
North American Datum of 1983  
SPCS\_Zone\_Identifier: 4400  
Geodetic Reference System 80  
4,000-meter grid, Easting - Northing

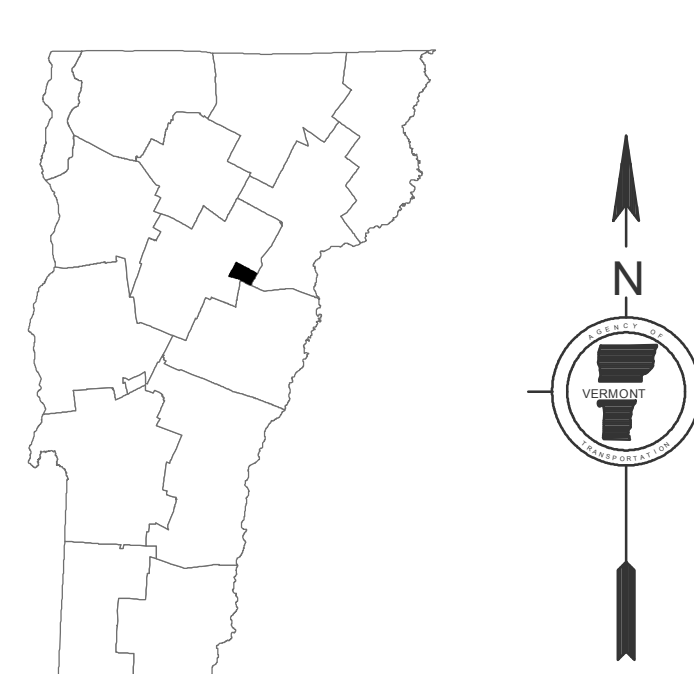
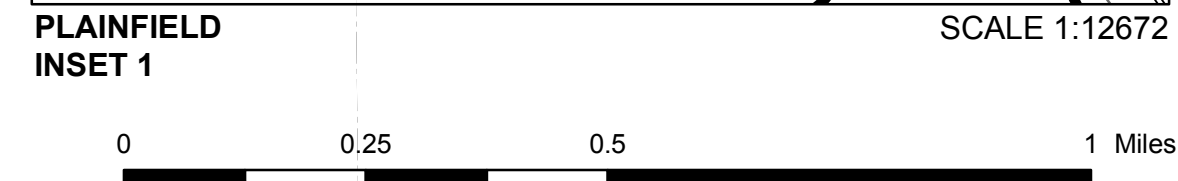
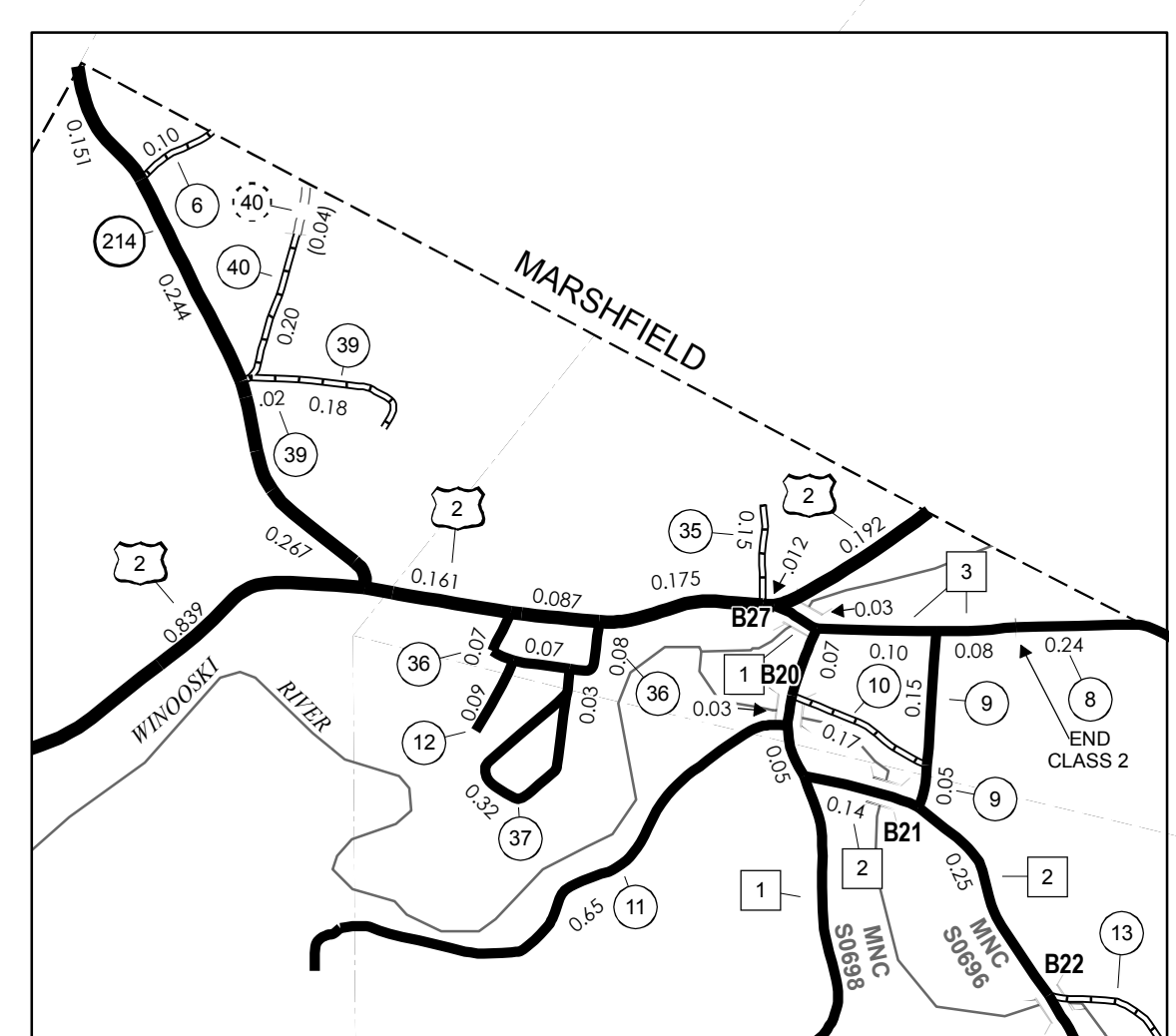
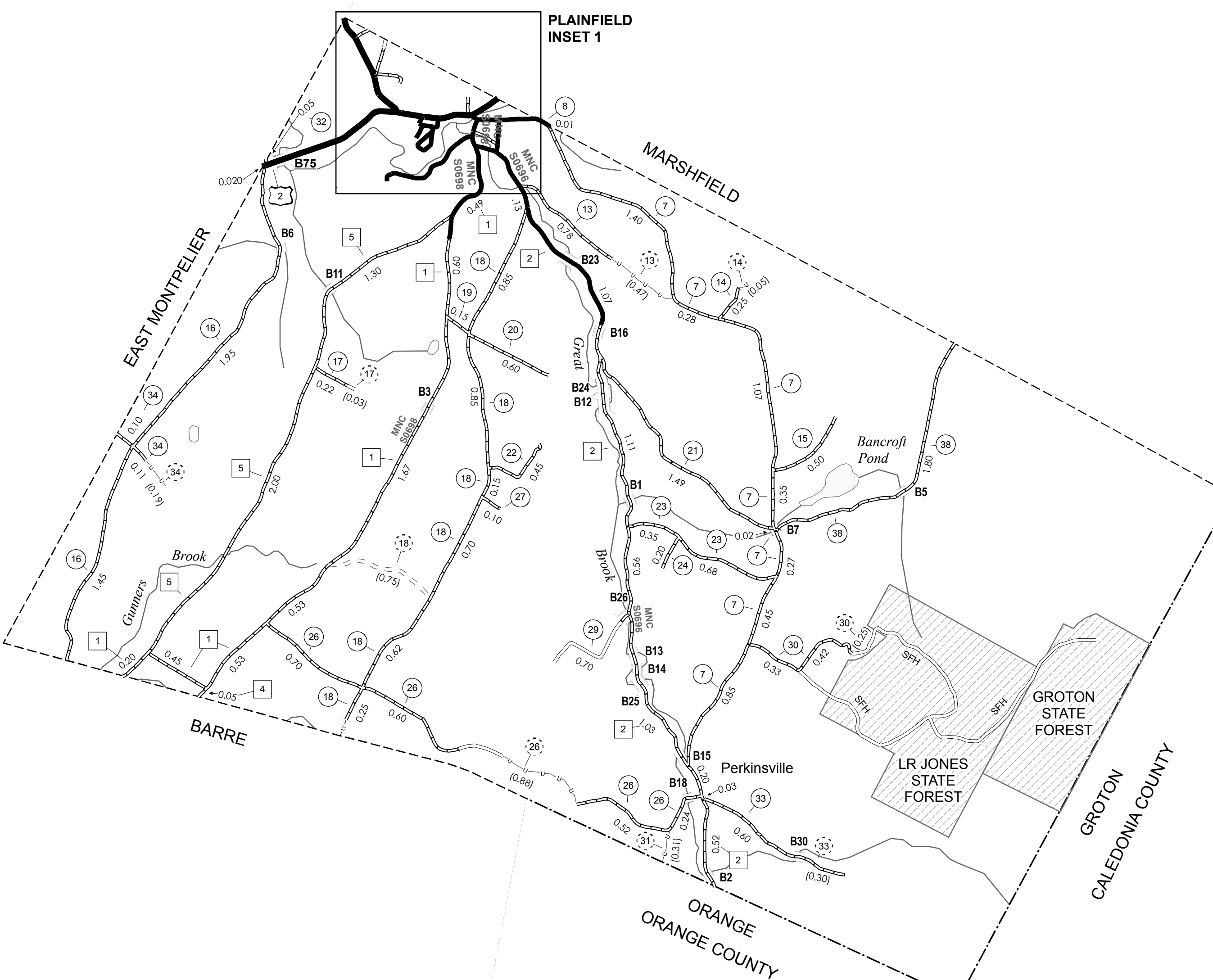

**VERMONT**  
**GENERAL HIGHWAY MAP**  
**Town of Plainfield**  
WASHINGTON COUNTY

Transportation District #6

Prepared by the  
Vermont Agency of Transportation  
Policy & Planning Division  
in cooperation with  
U.S. Department of Transportation  
Federal Highway Administration

Mileage as of: Feb. 10, 2007  
Map generated: October, 2007

