

TOWN HWY. No.	LENGTH IN MILES CLASS 3	LENGTH IN MILES CLASS 4
5	4.46	
6	1.55	(0.68)
7	0.10	(0.05)
8	0.17	
9	1.20	(0.55)
11	0.10	
12	0.41	
14	0.14	(0.55)
15	1.45	(1.06)
17	1.65	
19		(0.13)
20	1.55	
21	1.45	
22	0.20	
23		(0.40)
24	0.17	(0.91)
25	0.55	(0.30)
26	1.45	
27	0.13	
29	0.10	
30	0.92	(2.08)
31		(2.60)
33		(0.50)
35	0.45	(0.15)
36	0.65	
37	1.68	
38	0.90	
39	0.10	
40	0.62	
41	1.91	(0.15)
42	0.42	
43	0.25	
44	0.30	
46		(1.21)
47		(0.40)
48	0.06	(0.50)
50	0.16	
53		(0.52)
54	0.44	(0.35)
55	0.20	
57	0.08	
58		(0.04)
59	0.11	
63	0.08	
64	0.07	
65	0.35	(0.04)
66	0.10	
67	0.50	
<b>TOTAL</b>	<b>25.73</b>	<b>13.17</b>

**MILEAGE SUMMARY**

CLASS 2		
TH-1	6.700	
TH-2	2.830	
TH-3	1.200	
<b>TOTAL CLASS 2</b>	<b>10.730</b>	
CLASS 3		
<b>TOTAL CLASS 3</b>	<b>25.73</b>	
<b>TOTAL TOWN</b>	<b>36.460</b>	
STATE HIGHWAY		
VT-100	1.227	
VT-100B	7.841	
<b>TOTAL STATE HIGHWAY</b>	<b>9.068</b>	
US HIGHWAY		
US-2	3.219	
<b>TOTAL US HIGHWAY</b>	<b>3.219</b>	
<b>TOTAL STATE</b>	<b>12.287</b>	
<b>TOTAL TRAVELED HIGHWAYS, FEB. 10, 2014:</b>	<b>48.747</b>	

(Excludes Class 4, Legal Trail, and Undeveloped Corridor Mileage)

**TOWN HWY. No.**

42	0.18
<b>TOTAL</b>	<b>0.18</b>

**LENGTH IN MILES "NOT UP TO STANDARD"**

\* The sections of the town highways listed above are legally Class 3, but have been deemed "Not Up To Standard" and are functionally Class 4 Town Highways

**LEGAL TRAIL No.**

1	1.50
2	1.10
3	0.65
4	0.10
5	1.31
6	1.05
7	0.25
8	0.10
9	0.45
10	0.40
11	1.00
12	1.25
13	0.75
14	0.20
15	0.40
16	0.30
17	1.00
18	1.30
19	0.60
20	0.20
21	0.90
<b>TOTAL</b>	<b>14.81</b>

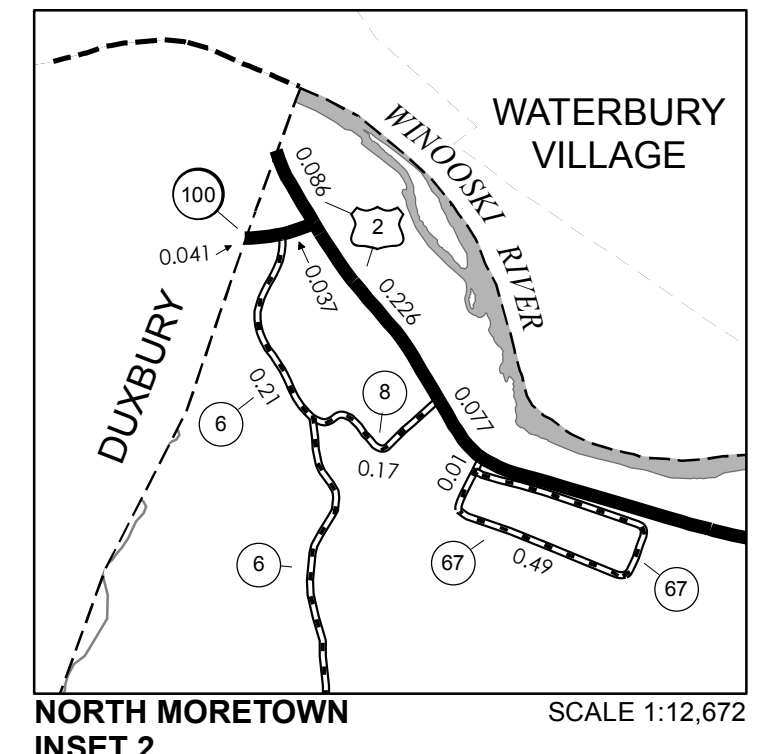
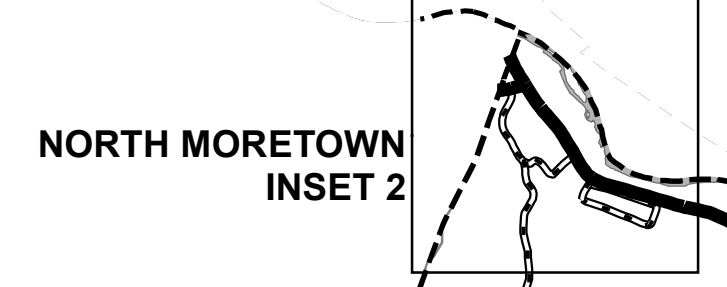
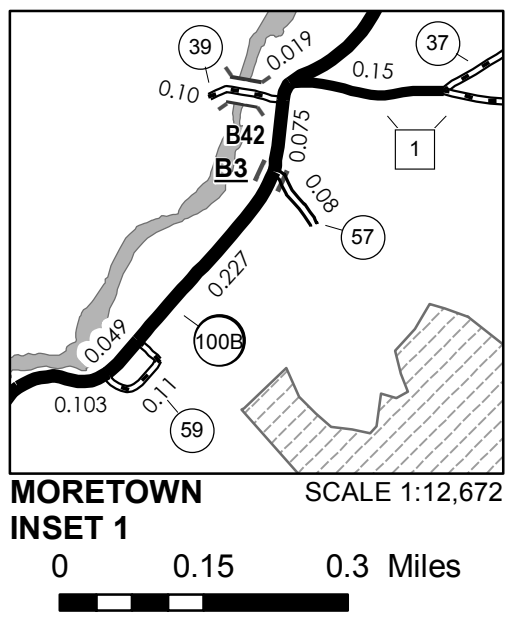

**FEDERAL CLASSIFICATION IDENTIFIER**

FAU URBAN ARTERIAL OR COLLECTOR  
 MA MINOR ARTERIAL  
 MJC MAJOR COLLECTOR  
 MNC MINOR COLLECTOR  
 PA PRINCIPAL ARTERIAL

**BRIDGE OR CULVERT**

BRIDGE OR CULVERT > 20'  
 BRIDGE OR CULVERT 6' - 20'  
 VOBICIT BRIDGE  
 VOBICIT CULVERT > 6'

**B34 / C34 STATE BRIDGE OR CULVERT IDENTIFIER**  
**B34 / C34 TOWN BRIDGE OR CULVERT IDENTIFIER**

**VERMONT GENERAL HIGHWAY MAP**

**Town of Moretown**

WASHINGTON COUNTY

Transportation District #6

Prepared by the  
 Vermont Agency of Transportation  
 Division of Policy, Planning and Intermodal Development  
 in cooperation with  
 U.S. Department of Transportation  
 Federal Highway Administration

Mileage as of February 10, 2014  
 Map prepared October 03, 2014  
 SCALE 1:31,680

0.5 0 0.5 1 1.5 2  
 Miles

0.5 0 0.5 1 1.5 2  
 Kilometers

**DISCLAIMER:**  
 The untraveled highways (laid-out town highways), discontinued highways, and legal trails hereon are those of which the Agency of Transportation has record; others may exist.

Highway and bridge data by the Agency of Transportation. Town short structures are drawn from the Vermont Online Bridge & Culvert Inventory Tool (VOBCIT) database. All other data from the Vermont Center for Geographic Information. Only named streams are shown.

Vermont State Plane Coordinate System  
 North American Datum of 1983  
 SPCS\_Zone\_Identifier: 4400  
 Geodetic Reference System 80  
 4,000-meter grid, Easting - Northing