

TOWN HWY. No.	LENGTH IN MILES CLASS 3	LENGTH IN MILES CLASS 4	TOWN ROAD NAME	TOWN HWY. No.	LENGTH IN MILES CLASS 3	LENGTH IN MILES CLASS 4	TOWN ROAD NAME	TOWN HWY. No.	LENGTH IN MILES CLASS 3	LENGTH IN MILES CLASS 4	TOWN ROAD NAME
101	0.23		BAILEY AVE	159	0.12		GRANITE ST	218	0.11		PARK AVE
102	0.20		BALDWIN ST	160	0.40		GREEN MOUNTAIN DR	219	0.11		PARKSIDE DR
103		(0.12)	BALLFIELD DR	161	0.20		GREENFIELD TER	220	0.37		PARKWAY ST
104	0.18		BINGHAM ST	162	0.19		GREENOCK AVE	221	0.19		PEARL ST
105	0.08		BLACKWELL ST	163	0.03		GREENWOOD TER	222	0.03		PECK PT
106	0.04		BLANCHARD CT	164	0.04		GROUT RD	223	0.16		PERKINS RD
107	0.44		BLISS RD	165	0.09		GUERNSEY AVE	224	0.13		PHELPS ST
108	0.08		BLODGETT AVE	166	0.17		HACKAMORE RD	225	0.13		PHILLIPS RD
109	0.28		BROWN ST	167	0.03		HAGGETT RD	226	0.18		POOL SIDE DR
110	0.07		CEDAR ST	168	0.17		HARRISON AVE	227	0.05		PITKIN CT
111	0.09		CENTER ST	169	0.02		HARRY SHERIDAN AVE	228	0.14		PLEASANT ST
112	0.08		CHAPMAN RD	170	0.03		HAZEN PL	229	0.29		PLEASANTVIEW ST
113	0.14		CHARLES ST	171	0.12		HEATON ST	230	0.08	(0.08)	PROSPECT ST
114	0.13		CHERRY AVE	172	0.36		HEBERT RD	231	0.45		PUTNAM ST
115	0.25		CHESTNUT HILL RD	173	0.07		HIGH SCHOOL DR	232	0.04		QUESNEL DR
116	0.17		FINCH RD	174	0.08		HIGHLAND AVE	233	0.09		REDSTONE AVE
117	0.18		CITYSIDE DR	175	1.04		HILL ST	234	0.13		RICHARDSON ST
118	0.49		CLARENDON AVE	176	0.08		HILLCREST DR	235	0.08		RIDGE ST
119	0.22		CLIFF ST	177	0.04		HILLSIDE AVE	236	0.25		ROBERTS ST
120	0.71		COLLEGE ST	178	0.08		HINCKLEY AVE	237	0.12		ROBINHOOD CIR
121	0.52		COLONIAL DR	179	0.07		HOLMES CT	238	0.16		SABIN ST
122	0.06		COOLIDGE ST	180	0.04		HORN OF THE MOON RD	239	0.14		SCHOOL AVE
123	0.07		CORRY RD	181	0.04		HUBBARD PARK DR	240	0.05		SCHOOL ST
124	0.52		CORSE ST	182	0.27		HUBBARD PARK DR	241	0.22		SCRIBNER ST
125	0.19		COUNTRY CLUB RD	183	0.37		HURD ST	242	0.06	(0.01)	SHERWOOD DR
126	0.20		COURT ST	184	0.37		HURD ST	243	0.06		SIBLEY AVE
127	0.11		CRESCENT LN	185	0.18		INDEPENDENCE GRN	244	0.17		SPRING HOLLOW LN
128	0.07		CRESTVIEW DR	186	0.26		ISABEL CIR	245	0.30		SPRING ST
129	0.10		CROSS ST	187	0.07		JAY ST	246	0.09		SAINT PAUL ST
130		(0.06)	CUMMINGS ST	188	0.07		JORDAN ST	247	0.17		SUMMER ST
131	0.25		CUMMINGS ST	189	0.15		JURSON DR	248	0.30		SUNNYSIDE TER
132	0.52		DAIRY LN	190	0.09		KEMP AVE	249	0.08		SUNSET AVE
133	0.12		DEERFIELD DR	191	0.19		KENT ST	250	0.11		TAPLIN ST
134	0.17		DERBY DR	192	0.17		LAGUE DR	251	0.07		TERRACE ST
135	0.20		DOVER RD	193	0.08		LANGDON ST	252	0.08		TOWNE ST
136	0.08		DOWNING ST	194	0.58		LIBERTY ST	253	0.11		TRACY ST
137	0.16		DUNPATRICK CIR	195	0.13		LINCOLN AVE	254	0.24		TREMONT ST
138	0.09		DWIGHT ST	196	0.06		LONGMEADOW DR	255	0.06		VALERIE AVE
139	0.08		EVER AVE	197	0.31		LOUIS ST	256	0.07		VEO DR
140	0.55		E STATE ST	198	0.06		MARVIN ST	257	0.19		VINE ST
141	0.06		EDWARDS ST	199	0.06		MATHER TER	258	0.17		WALKER TER
142	0.05		EMMONS ST	200	0.11		MCKINLEY ST	259	0.17		WAVERLY PL
143	0.11		EMMONS ST	201	0.12		MEADOW LN	260	0.07		WEST ST
144	0.25		FIRST AVE	202	0.12		MEDAN ST	261	0.04		WESTWOOD DR
145	0.20		FOREST DR	203	0.09		MERRILL TER	262	0.11		WHEELOCK ST
146	0.22		FOSTER ST	204	0.42		MILLS CT	263	0.36		WHITTIER ST
147	0.06		FRANK ST	205	0.42		MILL RD	264	0.36		WILDER ST
148	0.13		FRANKLIN ST	207	0.39		MOONLIGHT TER	265	0.05		WILSON ST
149	0.37		FREEDOM DR	208	0.09		MOUNTAINVIEW ST	266	0.08		WINTER ST
150	0.09		FULLER ST	209	0.40		MONSIGNOR CROSBY AVE	267	0.14		WOODCREST RD
151	0.13		GAYLORD DR	210	0.45		MURRAY RD	268	0.22		WOODROW AVE
152	0.29		GEORGE ST	211	0.08		MURRAY RD	269	0.05		GIN LN
153	0.22		GIDNEY PL	212	0.23		N COLLEGE ST	270	0.19		
154	1.07		GOULD HILL RD	213	0.27		N FRANKLIN ST	271	0.05		
155	0.08		GOV DAVIS AVE	214	0.78		N PARK DR	271	0.14		
156	0.04		GOVERNOR ARKEN AVE	215	0.07		NELSON ST	271	0.03		
157	0.04		GRAHAM TER	216	1.32		NORTH ST	271	0.14		
158	0.30		GRANDVIEW TER	217	0.53		OLD COUNTRY CLUB RD	271	0.14		
			TOTAL	32.99	0.53						

MILEAGE SUMMARY

CLASS	MILEAGE	TOTAL CLASS
TH-1	4.490	
TH-2	0.687	
TH-3	0.975	
TH-4	0.862	
TH-5	3.455	
TH-6	0.036	
TOTAL CLASS 1		10.505
CLASS 1 - Ramps	0.026	
TH-1	0.026	
TOTAL CLASS 1 - Ramps		0.026
CLASS 2	0.050	
TH-7	1.641	
TH-8	0.120	
TH-9	1.210	
TH-10	1.100	
TH-11	1.680	
TH-12	1.960	
TH-13	0.190	
TH-14	0.330	
TH-15	0.910	
TH-16	0.910	
TOTAL CLASS 2		8.291
CLASS 2 - Ramps	0.020	
TH-11	0.020	
TOTAL CLASS 2 - Ramps		0.020
CLASS 3	32.99	
TOTAL CLASS 3		32.99
TOTAL TOWN		51.832
STATE HIGHWAY	0.757	
NSH-MJSH	0.854	
NSH-MSH	0.196	
TOTAL STATE HIGHWAY		1.611
STATE HIGHWAY - Ramps	0.196	
NSH-MJSH	0.196	
TOTAL STATE HIGHWAY - Ramps		0.196
TOTAL STATE		1.807
INTERSTATE	1.545	
I-89	1.545	
TOTAL INTERSTATE		1.545
INTERSTATE - Ramps	0.780	
I-89	0.780	
TOTAL INTERSTATE - Ramps		0.780
TOTAL INTERSTATE		2.325
TOTAL, TRAVELED HIGHWAYS, FEB. 10, 2026		55.964

(Excludes Class 4 and Legal Trail Mileage)

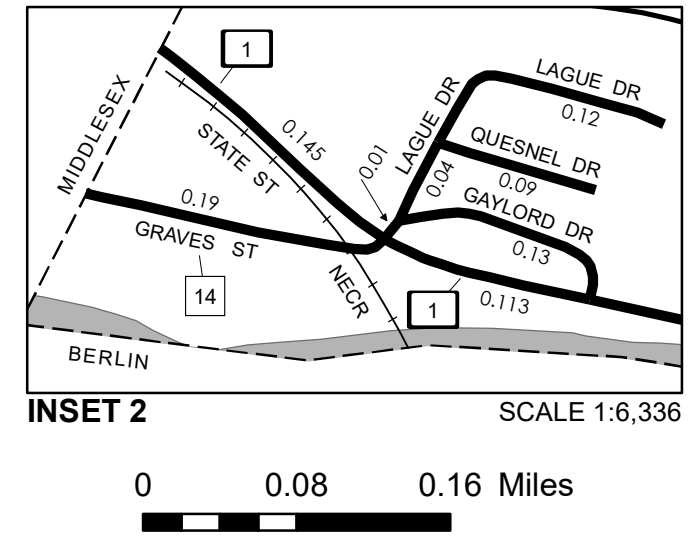

INSET 1

0 0.075 0.15 Miles

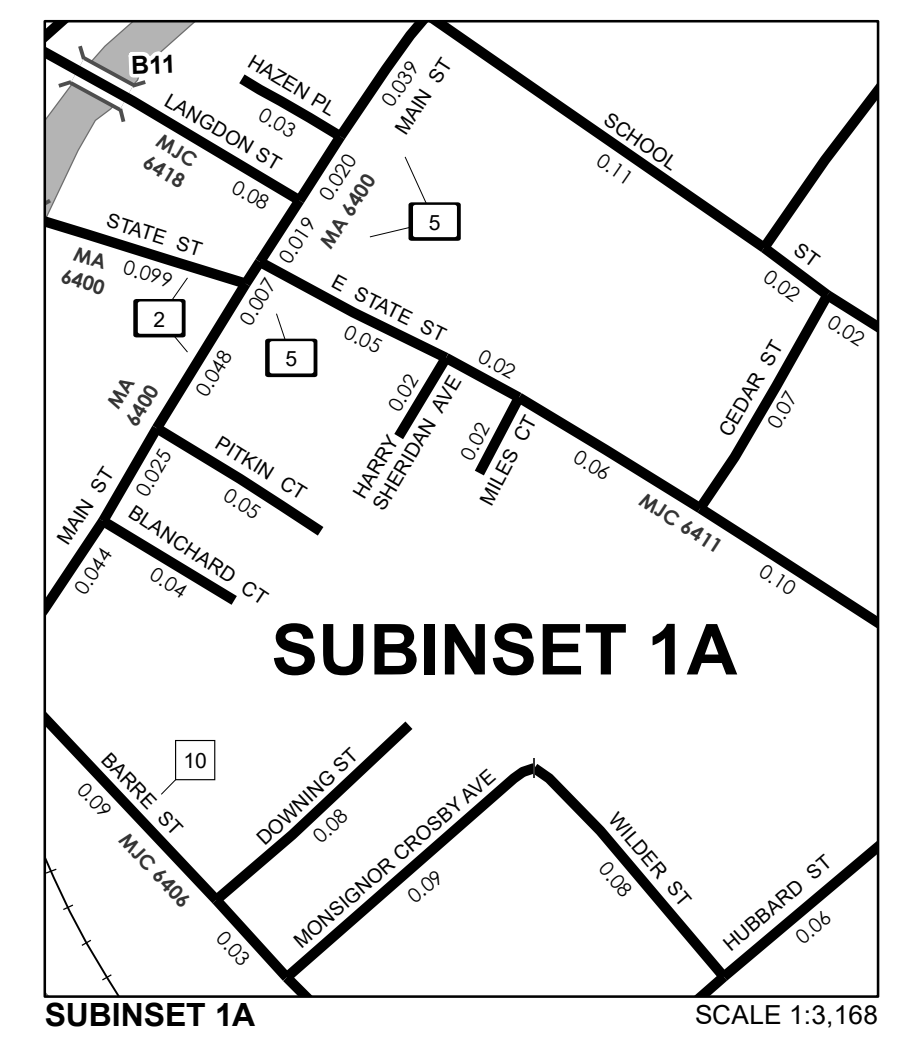

INSET 2

0 0.04 0.08 Miles

- HIGHWAYS**
- INTERSTATE
 - U.S. ROUTE
 - STATE ROUTE
 - CLASS 1
 - CLASS 2
 - CLASS 3
 - CLASS 4
 - LEGAL TRAIL
- ROAD TYPES**
- GRAVEL
 - SOIL OR GRADED AND DRAINED EARTH
 - UNIMPROVED OR PRIMITIVE
 - IMPASSABLE OR UNTRAVELED
 - LEGAL TRAIL
 - DISCONTINUED
 - HIGHWAY CLASS CHANGE
 - RAILROAD
 - INACTIVE RAILROAD
 - PUBLIC LAND - NATIONAL FOREST
 - PUBLIC LAND - STATE/MUNICIPAL
- POLITICAL SUBDIVISIONS**
- STATE BOUNDARY
 - COUNTY BOUNDARY
 - TOWN BOUNDARY
 - VILLAGE BOUNDARY
 - URBAN COMPACT BOUNDARY
 - WATER BODY
 - STREAM OR BROOK
- BRIDGE OR CULVERT**
- BRIDGE OR CULVERT > 20'
 - BRIDGE OR CULVERT 6' - 20'
 - BIKE PATH STRUCTURE
 - VT CULVERTS BRIDGE
 - VT CULVERTS CULVERT > 6'
- IDENTIFIERS**
- B34 / C34 STATE BRIDGE OR CULVERT IDENTIFIER
 - B34 / C34 TOWN BRIDGE OR CULVERT IDENTIFIER
 - NFR NATIONAL FOREST ROAD
 - ACE ARMY CORPS OF ENGINEERS
 - USGN UNITED STATES GOV. HWY.
 - P PARK AND RIDE
- FEDERAL CLASSIFICATION IDENTIFIER**
- MA MINOR ARTERIAL
 - MJC MAJOR COLLECTOR
 - MNC MINOR COLLECTOR
 - PA PRINCIPAL ARTERIAL

DISCLAIMER:
The untraveled highways (laid-out town highways), discontinued highways, and legal trails herein are those of which the Agency of Transportation has record; others may exist.

Highway and bridge data by the Agency of Transportation. Town short structures drawn from the VTCULVERTS (formerly VOBCT) online database. All other data from the Vermont Open Geodata Portal. Only named streams shown.

Accessibility Statement: The Agency of Transportation is committed to ensuring accessibility and digital accessibility for all. If you need language assistance, reasonable accommodation, or alternative format, please email johnathan.croft@vermont.gov.

Vermont State Plane Coordinate System
North American Datum of 1983
SPCS Zone Identifier: 4400
Geoid Reference System 80
2,000-meter grid, Easting - Northing

VERMONT GENERAL HIGHWAY MAP
City of Montpelier
WASHINGTON COUNTY
Transportation District #6

Prepared by the
Vermont Agency of Transportation
Highway Division
in cooperation with
U.S. Department of Transportation
Federal Highway Administration

Mileage as of February 10, 2026
Map prepared June 10, 2026
SCALE 1:12,672

0 0.15 0.3 0.45 0.6 Miles
0.2 0 0.2 0.4 0.6 0.8 Kilometers