

TOWN HWY. No.	LENGTH IN MILES CLASS 3	TOWN ROAD NAME	TOWN HWY. No.	LENGTH IN MILES CLASS 3	TOWN ROAD NAME	TOWN HWY. No.	LENGTH IN MILES CLASS 4	TOWN ROAD NAME
101	0.23	BAILEY AVE	216	1.32	GRANDVIEW TER			
102	0.20	BALDWIN ST	217	0.53	GRANITE ST			
103	0.18	BALLFIELD DR	218	0.11	PARK AVE			
104	0.16	BINGHAM ST	219	0.11	PARKSIDE DR			
105	0.08	BLACKWELL ST	220	0.37	PARKWAY ST			
106	0.04	BLANCHARD CT	221	0.19	PEARL ST			
107	0.44	BLISS RD	222	0.03	PECK PL			
108	0.06	BLODGETT AVE	223	0.16	PERKINS RD			
109	0.38	BROWN ST	224	0.13	PHILIPS ST			
110	0.07	CEDAR ST	225	0.13	PHILLIPS RD			
111	0.09	CENTER ST	226	0.18	PINEWOOD RD			
112	0.08	CHAPMAN RD	227	0.05	PITKIN CT			
113	0.14	CHARLES ST	228	0.14	PLEASANT ST			
114	0.13	CHERRY AVE	229	0.29	PLEASANTVIEW ST			
115	0.25	CHESTNUT HILL RD	230	(0.08)	POOLSIDE DR			
116	0.17	FINCH RD	231	0.45	PROSPECT ST			
117	0.18	CITYSIDE DR	232	0.04	PUTNAM ST			
118	0.49	CLARENDON AVE	233	0.09	QUESNEL DR			
119	0.22	CLIFF ST	234	0.13	REDSTONE AVE			
120	0.71	COLLEGE ST	235	0.08	RICHARDSON ST			
121	0.52	COLONIAL DR	236	0.25	RIDGE ST			
122	0.06	COOLIDGE ST	237	0.12	ROBERTS ST			
123	0.07	CORRY RD	238	0.16	ROBINHOOD CIR			
124	0.52	CORSE ST	239	0.14	SABIN ST			
125	0.19	COUNTRY CLUB RD	240	0.05	SCHOOL AVE			
126	0.20	COURT ST	241	0.22	SCHOOL ST			
127	0.11	CRESCENT LN	242	0.09	SCRIBNER ST			
128	0.07	CRESTVIEW DR	243	0.06	SCRIBNER ST			
129	0.10	CROSS ST	244	0.54	SHERWOOD DR			
130	0.25	CUMMINGS ST	245	0.17	SIBLEY AVE			
131	0.12	DAIRY LN	246	0.09	SPRING HOLLOW LN			
132	0.52	DEERFIELD DR	247	0.17	SPRING ST			
133	0.12	DERBY DR	248	0.30	SAINT PAUL ST			
134	0.09	DEWEY ST	249	0.08	SUMMIT ST			
135	0.20	DOVER RD	250	0.11	SUNNYSIDE TER			
136	0.08	DOWNING ST	251	0.07	SUNSET AVE			
137	0.16	DUNPATRICK CIR	252	0.08	TAPLIN ST			
138	0.09	DUNNELL ST	253	0.11	TERRACE ST			
139	0.08	DOVER AVE	254	0.24	TOWNE ST			
140	0.55	E STATE ST	255	0.06	TRACY ST			
141	0.06	EDWARDS ST	256	0.07	TREMONT ST			
142	0.05	EMMONS ST	257	0.19	VALERIE AVE			
143	0.09	EMMING ST	258	0.11	VEO RD			
144	0.25	FIRST AVE	259	0.17	VINE ST			
145	0.20	FOREST DR	260	0.07	WALKER TER			
146	0.22	FOSTER ST	261	0.04	WALKER TER			
147	0.06	FRANK ST	262	0.11	WALKER TER			
148	0.13	FRANKLIN ST	263	0.36	WALKER TER			
149	0.37	FREEDOM DR	264	0.38	WALKER TER			
150	0.09	FULLER ST	265	0.05	WALKER TER			
151	0.13	GAYLORD DR	266	0.08	WALKER TER			
152	0.29	GEORGE ST	267	0.14	WALKER TER			
153	0.22	GIDNEY PL	268	0.22	WALKER TER			
154	1.07	GOULD HILL RD	269	0.05	WALKER TER			
155	0.08	GOV DAVIS AVE	270	0.19	WALKER TER			
156	0.08	GOVERNOR ARKEN AVE	271	0.19	WALKER TER			
157	0.04	GRAHAM TER	272	0.03	WALKER TER			
					GIN LN			
			TOTAL	33.07	0.53			

MILEAGE SUMMARY

CLASS	TH-1	TH-2	TH-3	TH-4	TH-5	TH-6	TOTAL CLASS 1
	4.490	0.687	0.975	0.862	3.455	0.036	10.505
CLASS 1 - Ramps							
TH-1	0.026						0.026
CLASS 2							
TH-7	0.050						0.050
TH-8	1.641						1.641
TH-9	0.120						0.120
TH-10	1.210						1.210
TH-11	1.100						1.100
TH-12	1.680						1.680
TH-13	1.960						1.960
TH-14	0.190						0.190
TH-15	0.330						0.330
TH-16	0.910						0.910
CLASS 2 - Ramps							
TH-11	0.020						0.020
CLASS 3							
TOTAL CLASS 3	33.07						33.07
TOTAL TOWN	51.912						51.912

STATE HIGHWAY	NSH-MJSH	NSH-MSH	TOTAL STATE HIGHWAY
	0.757	0.854	1.611
STATE HIGHWAY - Ramps			
NSH-MJSH	0.196		0.196
TOTAL STATE HIGHWAY - Ramps			
NSH-MJSH	0.196		0.196
INTERSTATE			
I-89	1.545		1.545
INTERSTATE - Ramps			
I-89	0.780		0.780
TOTAL INTERSTATE - Ramps			
I-89	0.780		0.780
TOTAL INTERSTATE			
I-89	2.325		2.325
TOTAL, TRAVELED HIGHWAYS, FEB. 10, 2022:	56.044		56.044

(Excludes Class 4 and Legal Trail Mileage)

- HIGHWAYS**
- INTERSTATE
 - U.S. ROUTE
 - STATE ROUTE
 - CLASS 1
 - CLASS 2
 - CLASS 3
 - CLASS 4
 - LEGAL TRAIL
 - GRAVEL
 - SOIL OR GRADED AND DRAINED EARTH
 - UNIMPROVED OR PRIMITIVE
 - IMPASSABLE OR UNTRAVELED
 - LEGAL TRAIL
 - DISCONTINUED
 - HIGHWAY CLASS CHANGE
 - RAILROAD
 - INACTIVE RAILROAD
 - PUBLIC LAND - NATIONAL FOREST
 - PUBLIC LAND - STATE/MUNICIPAL
- POLITICAL SUBDIVISIONS**
- STATE BOUNDARY
 - COUNTY BOUNDARY
 - TOWN BOUNDARY
 - VILLAGE BOUNDARY
 - URBAN COMPACT BOUNDARY
 - WATER BODY
 - STREAM OR BROOK
- BRIDGE OR CULVERT**
- BRIDGE OR CULVERT > 20'
 - BRIDGE OR CULVERT 6' - 20'
 - BIKE PATH STRUCTURE
 - VT CULVERTS
 - VT CULVERTS CULVERT + 6'
- B34 / C34** STATE BRIDGE OR CULVERT IDENTIFIER
B34 / C34 TOWN BRIDGE OR CULVERT IDENTIFIER
NFR NATIONAL FOREST ROAD
USGH UNITED STATES GOV. HWY.
P PARK AND RIDE
FEDERAL CLASSIFICATION IDENTIFIER
- MA MINOR ARTERIAL
 - MJC MAJOR COLLECTOR
 - MNC MINOR COLLECTOR
 - PA PRINCIPAL ARTERIAL

DISCLAIMER:
 The untraveled highways (laid-out town highways), discontinued highways, and legal trails herein are those of which the Agency of Transportation has record; others may exist.

Vermont State Plane Coordinate System
 North American Datum of 1983
 SPCS Zone Identifier: 4400
 Geodetic Reference System 80
 2,000-meter grid, Easting - Northing



INSET 1
 SCALE 1:6,336

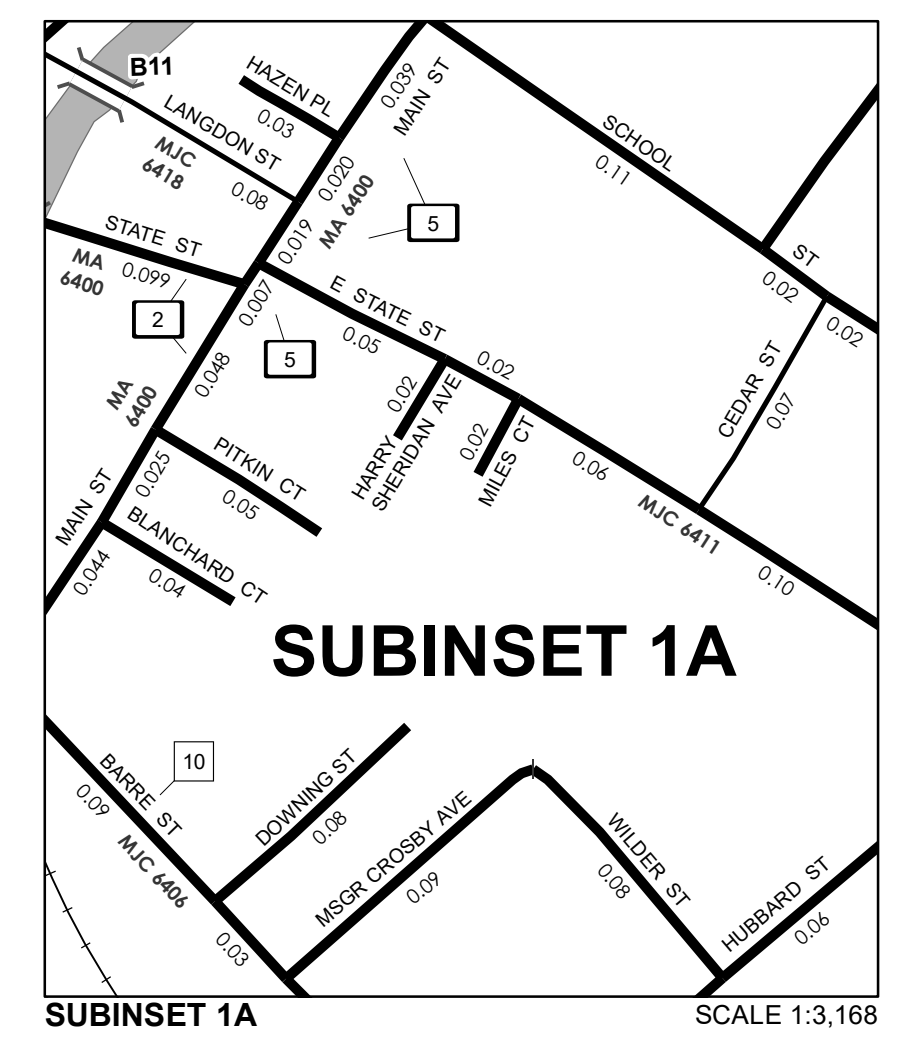

INSET 2
 SCALE 1:6,336

VERMONT GENERAL HIGHWAY MAP
City of Montpelier
 WASHINGTON COUNTY
 Transportation District #6

Prepared by the
 Vermont Agency of Transportation
 Division of Policy, Planning and Intermodal Development
 in cooperation with
 U.S. Department of Transportation
 Federal Highway Administration

Mileage as of February 10, 2022
 Map prepared July 01, 2022
 SCALE 1:12,672

0 0.15 0.3 0.45 0.6 Miles
 0 0.2 0.4 0.6 0.8 Kilometers