

TOWN HWY. CLASS	LENGTH IN MILES	TOWN ROAD NAME	TOWN HWY. CLASS	LENGTH IN MILES	TOWN ROAD NAME	TOWN HWY. CLASS	LENGTH IN MILES	TOWN ROAD NAME
No.	3		No.	3		No.	3	
101	0.23	BAILEY AV	158	0.30	GRANDVIEW TERR	216	1.32	NORTH ST
102	0.20	BALDWIN ST	159	0.12	GRANITE ST	217	0.53	OLD COUNTRY CLUB RD
103	0.16	BALLFIELD DR	160	0.40	GREEN MOUNTAIN DR	218	0.11	PARK AV
104	0.18	BINGHAM ST	161	0.20	GREENFIELD TERR	219	0.11	PARKSIDE DR
105	0.08	BLACKWELL ST	162	0.19	GREENOCK AV	220	0.37	PARKWAY ST
106	0.04	BLANCHARD CT	163	0.03	GREENWOOD TERR	221	0.19	PEARL ST
107	0.44	BLISS RD	164	0.04	GROUT RD	222	0.03	PECK PL
108	0.06	BLODGETT AV	165	0.09	GUERNSEY AV	223	0.16	PERKINS RD
109	0.28	BROWN ST	166	0.17	HACKAMORE RD	224	0.13	PHILIPS ST
110	0.07	CEDAR ST	167	0.03	HAGGETT RD	225	0.13	PHILLIPS RD
111	0.09	CENTER ST	168	0.17	HARRISON AV	226	0.18	PINEWOOD RD
112	0.08	CHAPMAN RD	169	0.02	HARRY SHERIDAN AV	227	0.05	PITKIN CT
113	0.14	CHARLES ST	170	0.03	HAZEN PL	228	0.14	PLEASANT ST
114	0.13	CHERRY AV	171	0.12	HEATON ST	229	0.29	PLEASANTVIEW ST
115	0.25	CHESTNUT HILL RD	172	0.44	HEBERT RD	230	(0.08)	POOLSIDE DR
116	0.18	CITY DUMP RD	173	0.07	HIGH SCHOOL DR	231	0.45	PROSPECT ST
117	0.49	CITYSIDE DR	174	0.08	HIGHLAND AV	232	0.04	PUTNAM ST
118	0.22	CLARENDON AV	175	1.04	HILL ST	233	0.09	QUESNEL DR
119	0.29	CLIFF ST	176	0.08	HILLCREST DR	234	0.13	REDSTONE AV
120	0.71	COLLEGE ST	177	0.04	HILLHEAD ST	235	0.08	RICHARDSON ST
121	0.52	COLONIAL DR	178	0.08	HILLSIDE AV	236	0.25	RIDGE ST
122	0.06	COOLIDGE ST	179	0.07	HINKLEY ST	237	0.12	ROBERTS ST
123	0.07	CORRY RD	180	0.04	HOLMES CT	238	0.16	ROBINHOOD CIR
124	0.52	CORSE ST	181	0.04	HOPKINS ST	239	0.14	SABIN ST
125	0.19	COUNTRY CLUB RD	182	0.27	HORN OF THE MOON RD	240	0.05	SCHOOL AV
126	0.20	COURT ST	183	0.37	HUBBARD PARK DR	241	0.22	SCHOOL ST
127	0.11	CRESCENT LN	184	0.37	HUBBARD ST	242	0.06	SCRIBNER ST
128	0.07	CRESTVIEW DR	185	0.18	INDEPENDENCE GREEN	243	0.54	SHERWOOD DR
129	0.10	CROSS ST	186	0.26	ISABEL CIR	244	0.17	SIBLEY AV
130	0.25	CUMMINGS ST	187	0.07	JAY ST	245	0.30	SPRING HOLLOW LN
131	0.12	CUMMINGS LN	188	0.07	JORDAN ST	246	0.09	SPRING ST
132	0.52	DEERFIELD DR	189	0.15	JUDSON DR	247	0.17	ST PAUL ST
133	0.12	DERBY DR	190	0.09	KEMP AV	248	0.30	SUMMER ST
134	0.07	DEVNEY ST	191	0.19	KENT ST	249	0.08	SUNNYSIDE TERR
135	0.20	DOVER RD	193	0.08	LAGUE DR	250	0.11	SUNSET AV
136	0.08	DOWNING ST	194	0.58	LANGDON ST	251	0.07	TAPLIN ST
137	0.16	DUNPATRICK CIR	195	0.13	LIBERTY ST	252	0.08	TERRACE ST
138	0.09	DUNN ST	196	0.06	LINCOLN AV	253	0.11	TOWNE ST
139	0.08	DYER AV	197	0.21	LONGMEADOW DR	254	0.24	TRACY ST
140	0.55	E STATE ST	198	0.37	LOOMIS ST	255	0.06	TREMONT ST
141	0.06	EDWARDS ST	199	0.06	MARVIN ST	256	0.07	VALERIE AV
142	0.05	EMMONS ST	200	0.11	MATHER TERR	257	0.19	VED RD
143	0.17	EMWING ST	201	0.12	MCKINLEY ST	258	(0.26)	VINE ST
144	0.25	FIRST AV	202	0.12	MEADOW LN	259	0.17	WALKER TERR
145	0.20	FOREST DR	203	0.09	MECHANIC ST	260	0.07	WALKER PL
146	0.22	FOSTER ST	204	0.02	MERRILL TERR	261	0.04	WALTERY PL
147	0.06	FRANK ST	205	0.42	MILL RD	262	0.11	WEST ST
148	0.13	FRANKLIN ST	206	0.15	MILL RD	263	0.36	WESTWOOD DR
149	0.37	FREEDOM DR	207	0.39	MOONLIGHT TERR	264	0.38	WHELOCK ST
150	0.09	FULLER ST	208	0.09	MOUNTAINVIEW ST	265	0.05	WHITTIER ST
151	0.13	GAYLORD DR	209	0.40	MSGR CROSBY AV	266	0.08	WILDER ST
152	0.29	GEORGE ST	210	0.45	MURRAY HILL DR	267	0.14	WILSON ST
153	0.22	GIDNEY PL	211	0.08	MURRAY RD	268	0.22	WINTER ST
154	1.07	GOULD HILL RD	212	0.23	N COLLEGE ST	269	0.05	WITT PL
155	0.08	GOV DAVIS AV	213	0.27	N FRANKLIN ST	270	0.19	WOODCREST RD
156	0.08	GOVERNOR ARKEN AV	214	0.78	N PARK DR	271	0.19	WOODROW AV
157	0.04	GRAHAM TERR	215	0.04	NATIONAL LIFE DR			
					NELSON ST			
					TOTAL	32.87	0.82	

MILEAGE SUMMARY

CLASS	LENGTH	TOTAL CLASS
TH-1	4.490	
TH-2	0.687	
TH-3	0.975	
TH-4	0.862	
TH-5	3.455	
TH-6	0.036	
TOTAL CLASS 1		10.505
TH-7	0.026	
TH-8	1.641	
TH-9	0.120	
TH-10	1.210	
TH-11	1.100	
TH-12	1.680	
TH-13	1.960	
TH-14	0.190	
TH-15	0.330	
TH-16	0.910	
TOTAL CLASS 2		8.291
TH-11	0.020	
TOTAL CLASS 2 - Ramps		0.020
TOTAL CLASS 3		32.87
TOTAL TOWN		51.712
NSH-MJSH	0.757	
NSH-MSH	0.854	
TOTAL STATE HIGHWAY		1.611
NSH-MJSH - Ramps	0.196	
TOTAL STATE HIGHWAY - Ramps		0.196
TOTAL STATE		1.807
I-89	1.545	
TOTAL INTERSTATE		1.545
I-89 - Ramps	0.780	
TOTAL INTERSTATE - Ramps		0.780
TOTAL INTERSTATE		2.325
TOTAL TRAVELED HIGHWAYS, FEB. 10, 2015:		55.844

(Excludes Class 4, Legal Trail, and Unidentified Corridor Mileage)

- HIGHWAYS**
- INTERSTATE
 - U.S. ROUTE
 - STATE ROUTE
 - CLASS 1
 - CLASS 2
 - CLASS 3
 - CLASS 4
 - LEGAL TRAIL
 - GRAVEL
 - SOIL OR GRADED AND DRAINED EARTH
 - UNIMPROVED OR PRIMITIVE
 - IMPASSABLE OR UNTRAVELED
 - LEGAL TRAIL
 - DISCONTINUED
 - HIGHWAY CLASS CHANGE
 - RAILROAD
 - INACTIVE RAILROAD
 - PUBLIC LAND - GREEN MOUNTAIN NATIONAL FOREST
 - PUBLIC LAND - STATE/MUNICIPAL
- POLITICAL SUBDIVISIONS**
- STATE BOUNDARY
 - COUNTY BOUNDARY
 - TOWN BOUNDARY
 - VILLAGE BOUNDARY
 - URBAN COMPACT BOUNDARY
 - WATER BODY
 - STREAM OR BROOK
- BRIDGE OR CULVERT**
- BRIDGE OR CULVERT > 20'
 - BRIDGE OR CULVERT 6' - 20'
 - VOBCIT BRIDGE
 - VOBCIT CULVERT > 6'
- B34 / C34 STATE BRIDGE OR CULVERT IDENTIFIER**
- B34 / C34 TOWN BRIDGE OR CULVERT IDENTIFIER**
- NFR NATIONAL FOREST ROAD**
- SFH STATE FOREST HIGHWAY**
- P PARK AND RIDE**
- FEDERAL CLASSIFICATION IDENTIFIER**
- FAU URBAN ARTERIAL OR COLLECTOR
 - MA MINOR ARTERIAL
 - MJC MAJOR COLLECTOR
 - MNC MINOR COLLECTOR
 - PA PRINCIPAL ARTERIAL

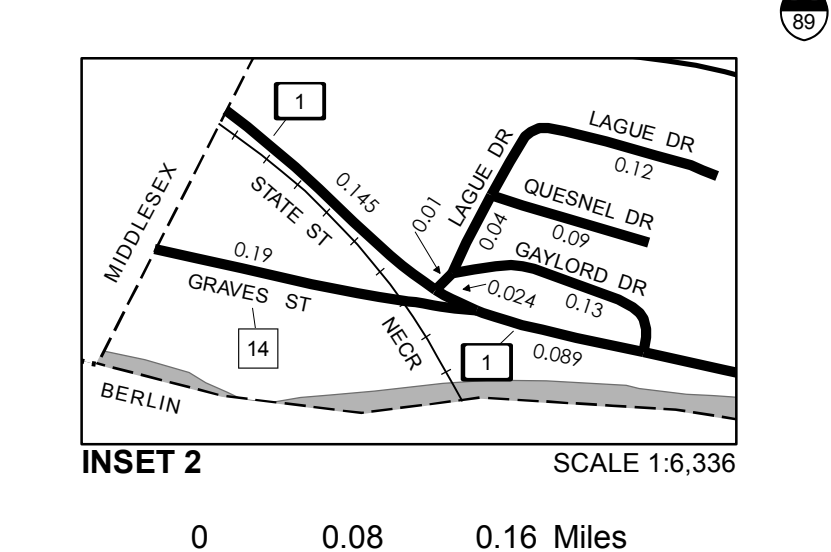

DISCLAIMER:
The untraveled highways (laid-out town highways), discontinued highways, and legal trails hereon are those of which the Agency of Transportation has record; others may exist.

Highway and bridge data by the Agency of Transportation. Town short structures are drawn from the Vermont Online Bridge & Culvert Inventory Tool (VOBCIT) database. All other data from the Vermont Center for Geographic Information. Only named streams are shown.

Vermont State Plane Coordinate System
North American Datum of 1983
SPCS, Zone Identifier: 4400
Geodetic Reference System 80
2,000-meter grid, Easting - Northing



INSET 1 SCALE 1:6,336

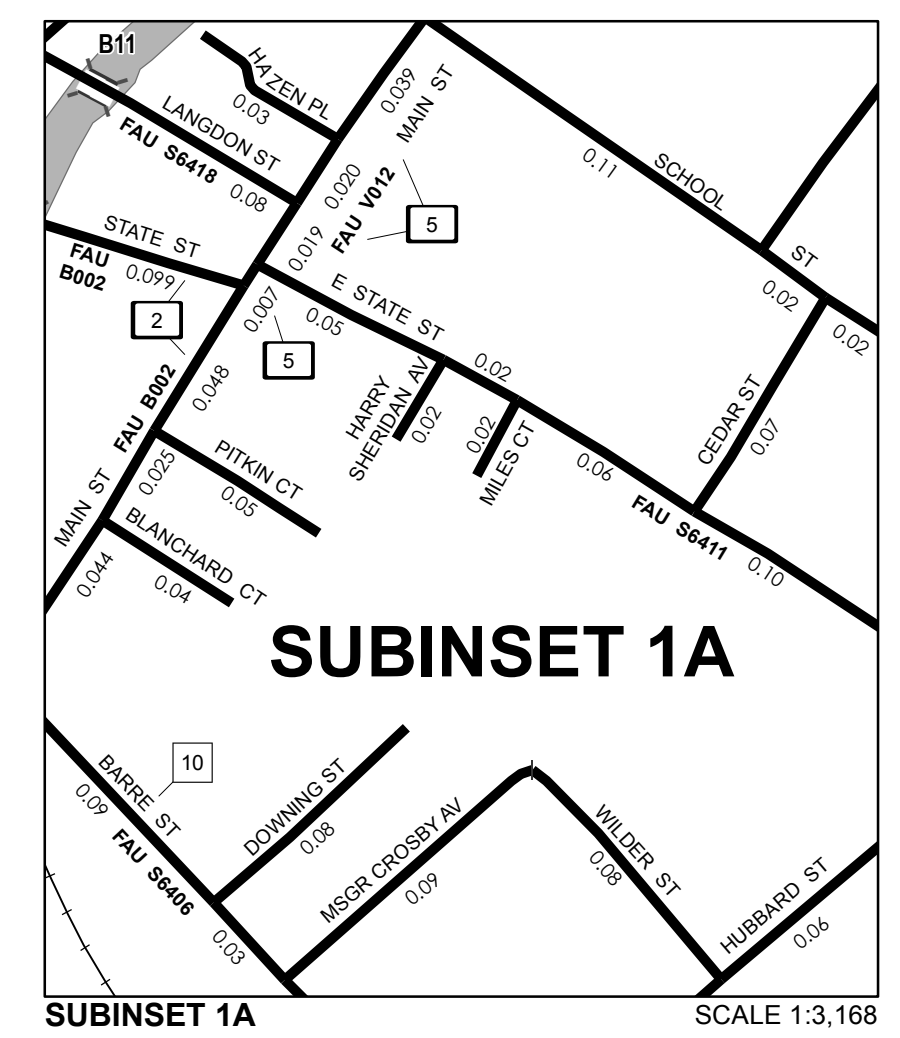

INSET 2 SCALE 1:6,336

VERMONT GENERAL HIGHWAY MAP
City of Montpelier
WASHINGTON COUNTY
Transportation District #6

Prepared by the
Vermont Agency of Transportation
Division of Policy, Planning and Intermodal Development
in cooperation with
U.S. Department of Transportation
Federal Highway Administration

Mileage as of February 10, 2015
Map prepared June 19, 2015
SCALE 1:12,672

0 0.15 0.3 0.45 0.6 Miles
0.2 0 0.2 0.4 0.6 0.8 Kilometers