

TOWN HWY. No.	LENGTH IN MILES CLASS 3	LENGTH IN MILES CLASS 4	LEGAL TRAIL No.	LENGTH IN MILES LEGAL TRAIL
3	2.57		1	(0.38)
5	0.70			
6	5.75			
7	3.09			
8		(0.90)		
9		(1.09)		
10	0.20			
11	0.95			
12	0.53			
13	0.43			
14		(0.20)		
15		(0.25)		
16	0.23			
17	1.05			
19	0.46			
20	2.07			
21	2.79	(0.16)		
22		(1.55)		
23	1.18			
24	0.43	(0.69)		
25	1.60			
26	1.10			
27	0.30			
28	1.91			
29	0.33	(0.67)		
30	1.50			
31	0.28			
32	1.16	(0.59)		
33	0.27	(1.23)		
34	0.51			
35	1.20	(0.30)		
36	0.64			
37	0.78			
38	0.70	(0.26)		
39	0.36			
40		(0.62)		
41		(0.04)		
42	0.21			
43	0.15			
44	0.19			
45	2.25			
46	0.06	(0.10)		
47		(0.24)		
48	0.10			
49	0.07			
50	0.18			
<b>TOTAL</b>	<b>38.28</b>	<b>8.89</b>		

TOWN HWY. No.	LENGTH IN MILES "NOT UP TO STANDARD"
12	(0.83)
13	(0.06)
<b>TOTAL</b>	<b>0.89</b>

\* The sections of the town highways listed above are legally Class 3, but have been deemed "Not Up To Standard" and are functionally Class 4 Town Highways

MILEAGE SUMMARY		
CLASS 2		
TH-1	6.690	
TH-2	4.720	
TH-3	4.310	
TH-4	2.230	
<b>TOTAL CLASS 2</b>	<b>17.950</b>	
CLASS 3		
<b>TOTAL CLASS 3</b>	<b>38.28</b>	
<b>TOTAL TOWN</b>	<b>56.230</b>	
STATE HIGHWAY		
VT-103	4.236	
<b>TOTAL STATE HIGHWAY</b>	<b>4.236</b>	
<b>TOTAL STATE</b>	<b>4.236</b>	

**TOTAL, TRAVELED HIGHWAYS, FEB. 10, 2013: 60.466**  
(Excludes Class 4, Legal Trail, and Unidentified Corridor Mileage)

**DISCLAIMER:**  
The untraveled highways (laid-out town highways), discontinued highways, and legal trails herein are those of which the Agency of Transportation has record; others may exist.

Highway and bridge data by the Agency of Transportation. All other data from the Vermont Center for Geographic Information. Only named streams are shown.

HIGHWAYS	
	INTERSTATE
	U.S. ROUTE
	STATE ROUTE
	CLASS 1
	CLASS 2
	CLASS 3
	CLASS 4
	LEGAL TRAIL
	INTERSTATE OR DIVIDED HIGHWAY
	STATE - HARD SURFACE OR PAVED
	TOWN - HARD SURFACE OR PAVED
	GRAVEL
	SOIL OR GRADED AND DRAINED EARTH
	UNIMPROVED OR PRIMITIVE
	IMPASSABLE OR UNTRAVELED
	LEGAL TRAIL
	DISCONTINUED
	HIGHWAY CLASS CHANGE
	RAILROAD
	INACTIVE RAILROAD
	NFR NATIONAL FOREST ROAD
	SFH STATE FOREST HIGHWAY
	PARK AND RIDE

POLITICAL SUBDIVISIONS	
	STATE BOUNDARY
	COUNTY BOUNDARY
	TOWN BOUNDARY
	VILLAGE BOUNDARY
	URBAN COMPACT BOUNDARY
	WATER BODY
	STREAM OR BROOK

BRIDGE OR CULVERT	
	BRIDGE OR CULVERT GREATER THAN 20'
	BRIDGE OR CULVERT 6' - 20'

FEDERAL CLASSIFICATION IDENTIFIER	
FAU	URBAN ARTERIAL OR COLLECTOR
MA	MINOR ARTERIAL
MJC	MAJOR COLLECTOR
MNC	MINOR COLLECTOR
PA	PRINCIPAL ARTERIAL

BRIDGE OR CULVERT IDENTIFIER	
B34 / C34	STATE BRIDGE OR CULVERT IDENTIFIER
B34 / C34	TOWN BRIDGE OR CULVERT IDENTIFIER

Vermont State Plane Coordinate System  
North American Datum of 1983  
SPCS\_Zone\_Identifier: 4400  
Geodetic Reference System 80  
4,000-meter grid, Easting - Northing

For more information contact: Vermont Agency of Transportation, Division of Policy, Planning & Intermodal Development - Mapping Unit, 1 National Life Drive, Montpelier, VT 05633-5001 Telephone: 802-828-2600.

This map was funded in part through grants from the Federal Highway Administration, U.S. Department of Transportation. The representation of the authors expressed herein do not necessarily state or reflect those of the U. S. Department of Transportation.

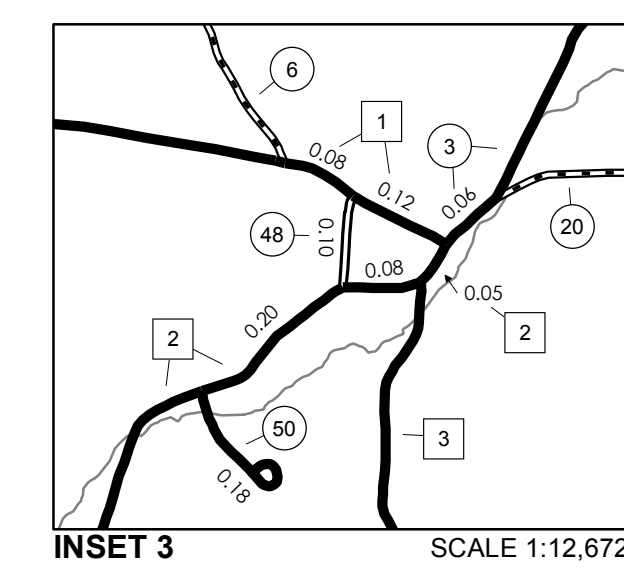
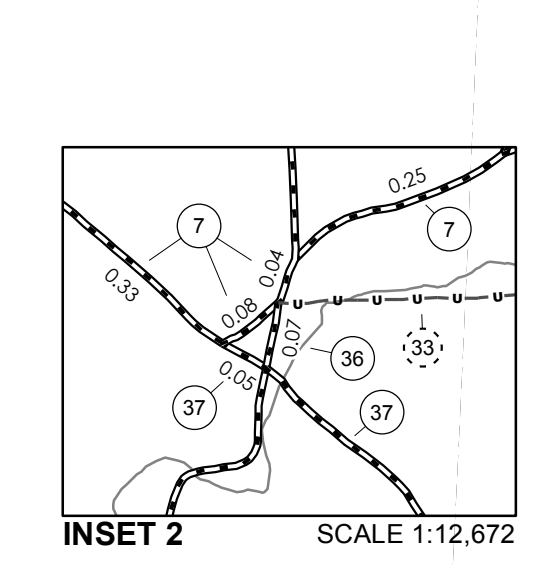
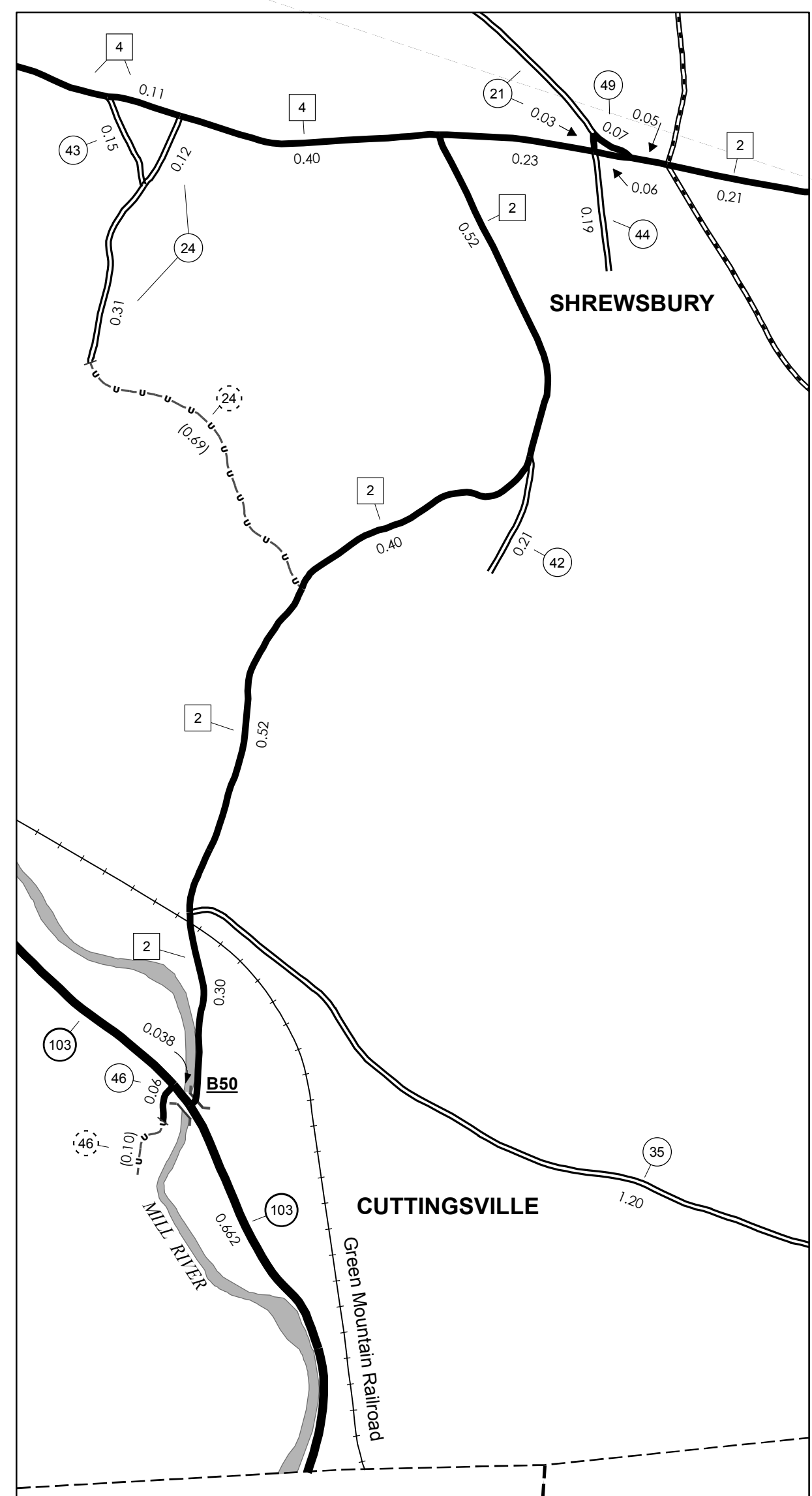

**VERMONT**  
**GENERAL HIGHWAY MAP**  
**Town of Shrewsbury**  
RUTLAND COUNTY  
Transportation District #3  
Prepared by the  
Vermont Agency of Transportation  
Division of Policy, Planning and Intermodal Development  
in cooperation with  
U.S. Department of Transportation  
Federal Highway Administration  
Mileage as of February 10, 2013  
Map prepared October 15, 2013  
SCALE 1:31,680

0.5 0 0.5 1 1.5 2  
Miles  
0.5 0 0.5 1 1.5 2  
Kilometers