

TOWN HWY. NO.	LENGTH IN MILES CLASS 3	CLASS 4
7	2.01	(1.05)
9	0.04	
10	1.74	
11	1.19	
12	1.82	
13	0.31	(0.10)
14	1.37	
15	2.48	
16	1.99	
17	0.03	
18	0.07	
19	0.08	
20	0.88	
21	0.49	(0.61)
22	0.60	
23	0.57	
24	3.12	
25	0.40	
26	0.30	
27	0.50	
28	1.25	
29	0.45	
30	2.94	
31	0.25	
32	0.06	
33	0.20	
34	0.07	
35	0.46	
36	0.54	
37	0.65	
<b>TOTAL</b>	<b>26.86</b>	<b>1.76</b>

\* This portion of town highway is Class 3, but is functionally Class 4

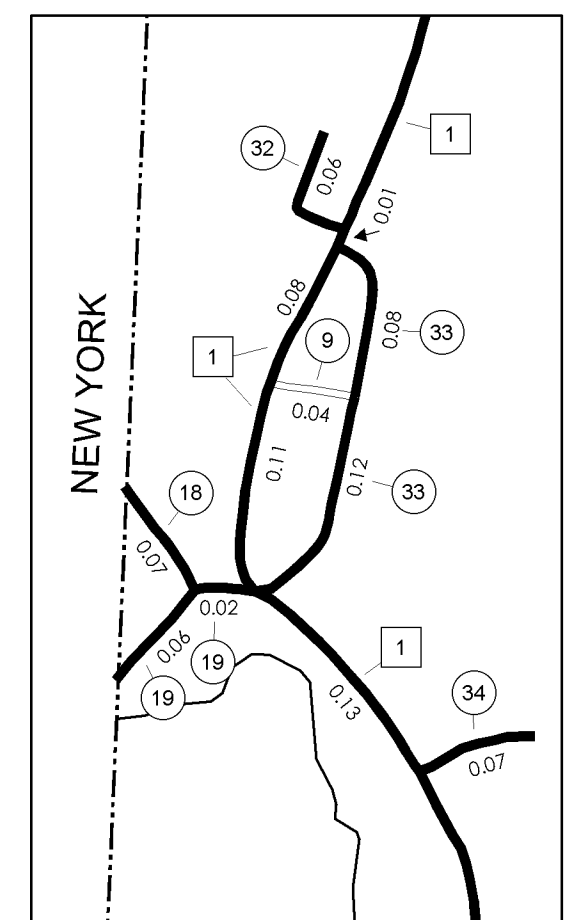

WEST PAWLET INSET 2 SCALE 1:6336

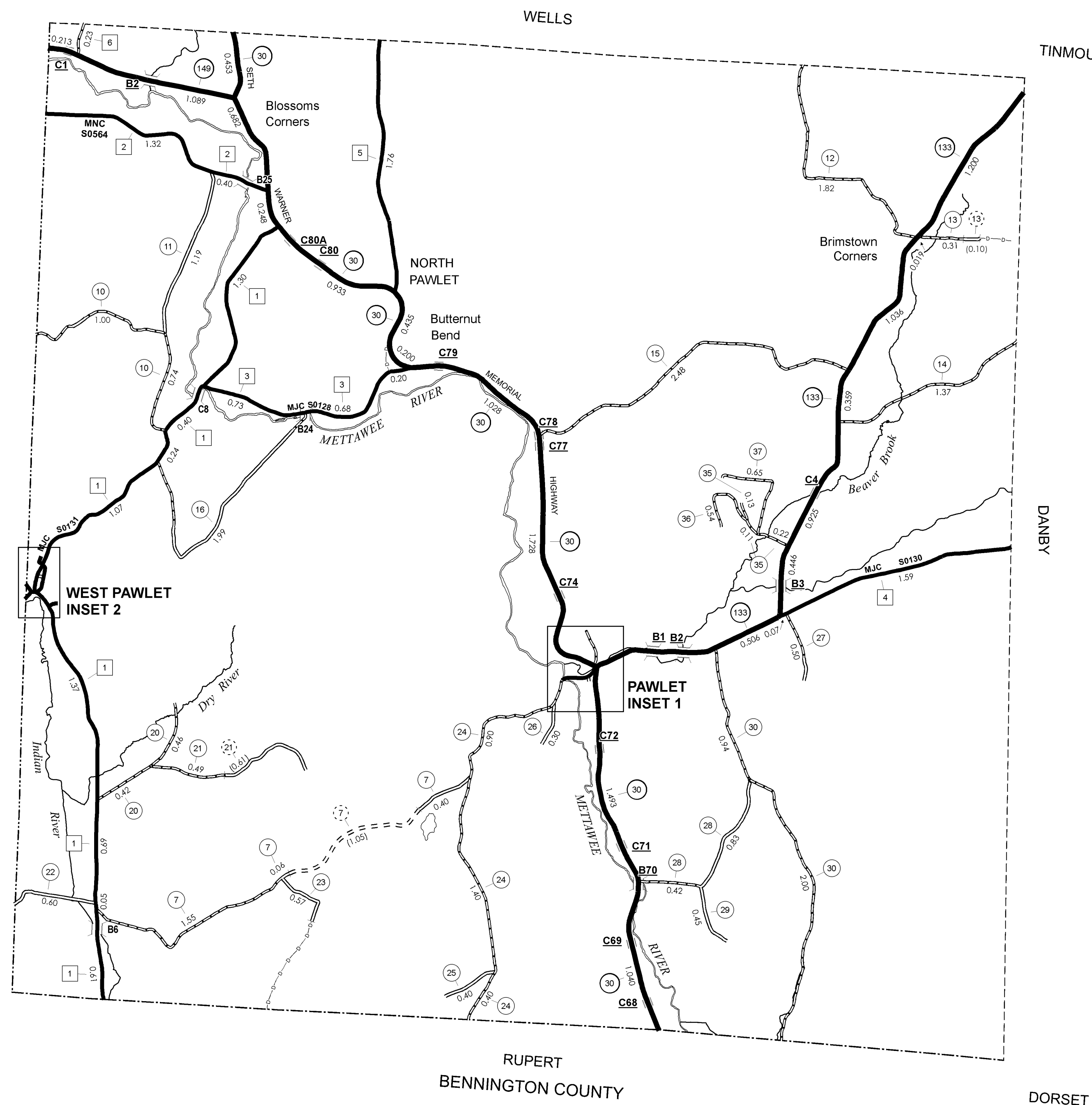

**MILEAGE SUMMARY**

CLASS 2		
TH-1	6.060	
TH-2	1.720	
TH-3	1.610	
TH-4	1.660	
TH-5	1.760	
TH-6	0.230	
<b>TOTAL CLASS 2</b>	<b>13.040</b>	
CLASS 3		
<b>TOTAL CLASS 3</b>	<b>26.860</b>	
<b>TOTAL TOWN</b>	<b>39.900</b>	
STATE HIGHWAY		
VT-30	8.260	
VT-133	5.325	
VT-149	1.302	
<b>TOTAL STATE HIGHWAY</b>	<b>14.887</b>	
<b>TOTAL STATE</b>	<b>14.887</b>	

**TOTAL, TRAVELED HIGHWAYS, FEB. 10, 2008: 54.787**  
(Excludes Class 4 and Legal Trail Mileage)

- HIGHWAYS**
- INTERSTATE
  - U.S. ROUTE
  - STATE ROUTE
  - CLASS 1
  - CLASS 2
  - CLASS 3
  - CLASS 4
  - LEGAL TRAIL
  - INTERSTATE OR DIVIDED HIGHWAY
  - STATE - HARD SURFACE OR PAVED
  - TOWN - HARD SURFACE OR PAVED
  - GRAVEL
  - SOIL OR GRADED AND DRAINED EARTH
  - UNIMPROVED OR PRIMITIVE
  - IMPASSABLE OR UNTRAVELED
  - LEGAL TRAIL
  - DISCONTINUED
  - HIGHWAY CLASS CHANGE
  - RAILROAD
- PUBLIC LAND**
- POLITICAL SUBDIVISIONS**
- STATE BOUNDARY
  - COUNTY BOUNDARY
  - TOWN BOUNDARY
  - VILLAGE BOUNDARY
  - URBAN COMPACT BOUNDARY
  - OPEN WATER
  - STREAM OR BROOK
- BRIDGE OR CULVERT**
- BRIDGE OR CULVERT GREATER THAN 20'
  - BRIDGE OR CULVERT 6' - 20'
- B34 / C34 STATE BRIDGE OR CULVERT IDENTIFIER**  
**B34 / C34 TOWN BRIDGE OR CULVERT IDENTIFIER**
- FEDERAL CLASSIFICATION IDENTIFIER**
- FAU URBAN ARTERIAL OR COLLECTOR
  - MA MINOR ARTERIAL
  - MJC MAJOR COLLECTOR
  - MNC MINOR COLLECTOR
  - PA PRINCIPAL ARTERIAL

**DISCLAIMER:**

The untraveled highways (laid-out town highways), discontinued highways, and legal trails shown hereon are those of which the Agency of Transportation has record; others may exist.

Highway and bridge data by the Agency of Transportation, Policy & Planning Division. All other data from the Vermont Center for Geographic Information.

Vermont State Plane Coordinate System  
North American Datum of 1983  
SPCS\_Zone\_Identifier: 4400  
Geodetic Reference System 80  
4,000-meter grid, Easting - Northing

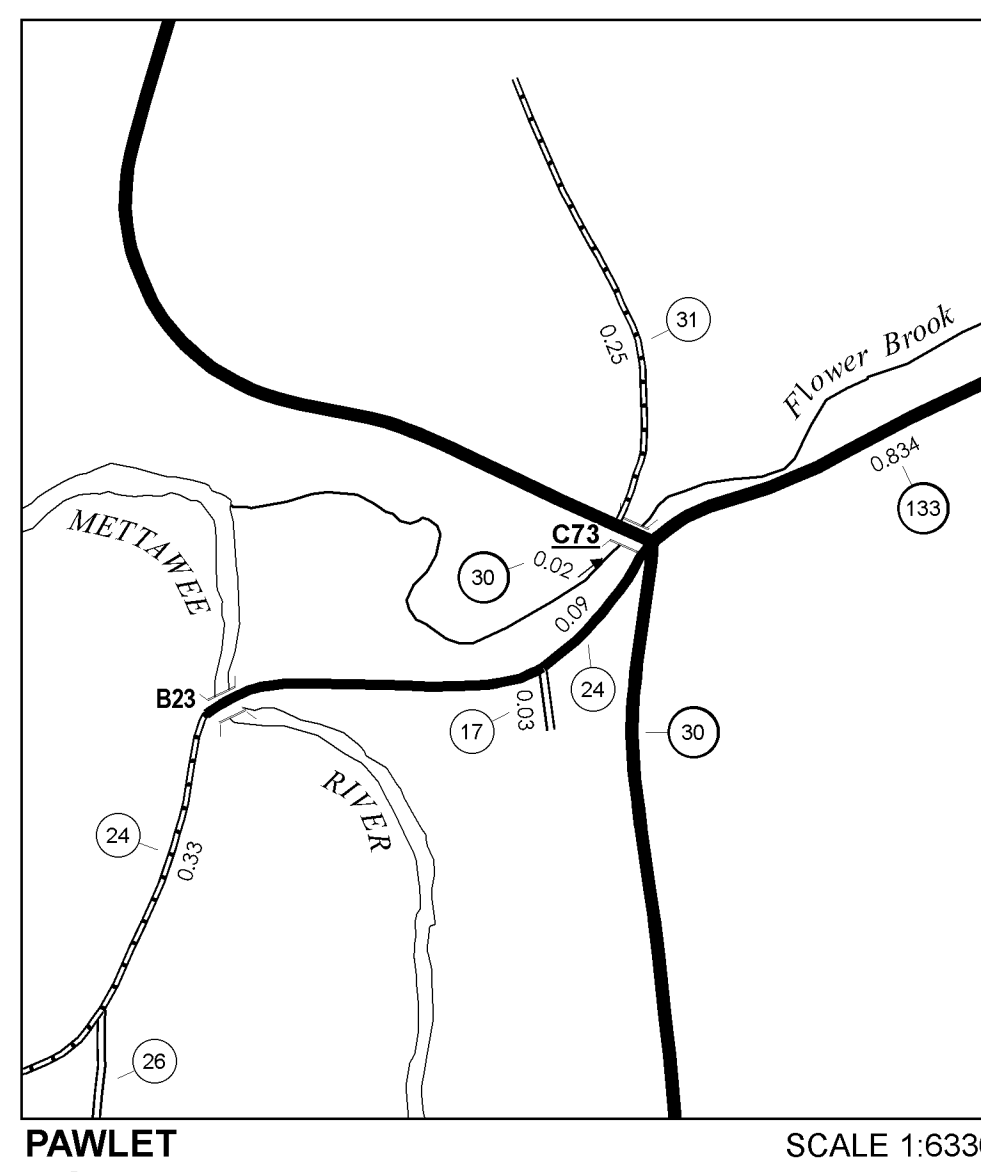

PAWLET INSET 1 SCALE 1:6336

**STRUCTURES - SURFACE WATER NOTE:**

Town short structures (bridges or culverts from 6-feet to less than 20-feet) were not represented due to inconsistencies in the data.

The surface waters are from the Vermont Hydrological Dataset (VHD). Only the named streams are shown.

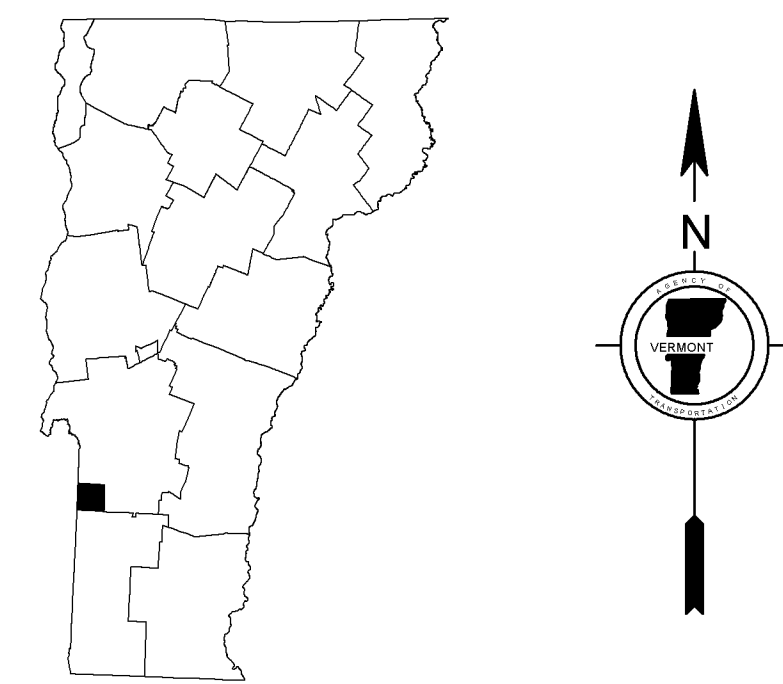

**VERMONT**  
**GENERAL HIGHWAY MAP**  
**Town of Pawlet**  
RUTLAND COUNTY

Transportation District #1

Prepared by the  
Vermont Agency of Transportation  
Policy & Planning Division  
in cooperation with  
U.S. Department of Transportation  
Federal Highway Administration

Mileage as of: February 10, 2008  
Map generated: October, 2008

SCALE: 1:31680

