

TOWN HWY. No.	LENGTH IN MILES CLASS 3	LENGTH IN MILES CLASS 4	TOWN HWY. No.	LENGTH IN MILES CLASS 3	LENGTH IN MILES CLASS 4
4	3.62		38	0.21	
5	2.23		39		(0.60)
6	1.51		40	1.39	(0.16)
7	0.04		41	0.07	
8	0.70		42	1.86	
9	0.17		43	0.55	
10	1.67	(1.00)	44	1.93	
11	0.70	(1.22)	45	2.79	
12	1.27		46	0.70	
13	0.53		47	0.83	
14	0.40	(0.50)	48	0.16	
15	0.81	(0.50)	49		(0.70)
16	0.70		50	0.10	
17	2.35	(0.81)	52	0.04	
18	1.05		53	0.02	
19	0.75	(0.45)	54	0.02	
20	1.30	(0.42)	55	0.17	
21	0.49		56	0.17	
22	1.00		57	0.93	
23	1.70		58	0.22	
24	1.62	(0.65)	59		(0.35)
25	0.35	(0.03)	60	0.20	
26	0.17		61	0.56	
27	1.79		62	0.31	
28	0.20		63	0.04	
29	0.34	(0.26)	64	0.15	
30	1.74		65	0.38	
31	0.16	(0.09)	66	0.10	
32	0.16	(1.54)	67	0.11	
33	0.17		68	0.60	
34	1.11		69	0.13	
35	0.32		70		(0.03)
36	0.25	(1.57)	71		(0.06)
37	1.52	(0.64)			
TOTAL			47.53	11.58	

TOWN HWY. No. 25 (0.12)
 29 (0.18)
 60 (0.21)
TOTAL 0.51

*The sections of the town highways listed above are legally Class 3, but have been deemed "Not Up to Standard" and are functionally Class 4 Town Highways

MILEAGE SUMMARY

CLASS 2		
TH-1	6.780	
TH-2	3.830	
TOTAL CLASS 2	10.610	
TOTAL CLASS 3	47.53	
TOTAL TOWN	58.140	
STATE HIGHWAY		
VT-103	7.683	
VT-140	0.152	
VT-155	7.603	
TOTAL STATE HIGHWAY	15.438	
TOTAL STATE	15.438	

TOTAL, TRAVELED HIGHWAYS, FEB. 10, 2026: 73.578
 (Excludes Class 4 and Legal Trail Mileage)

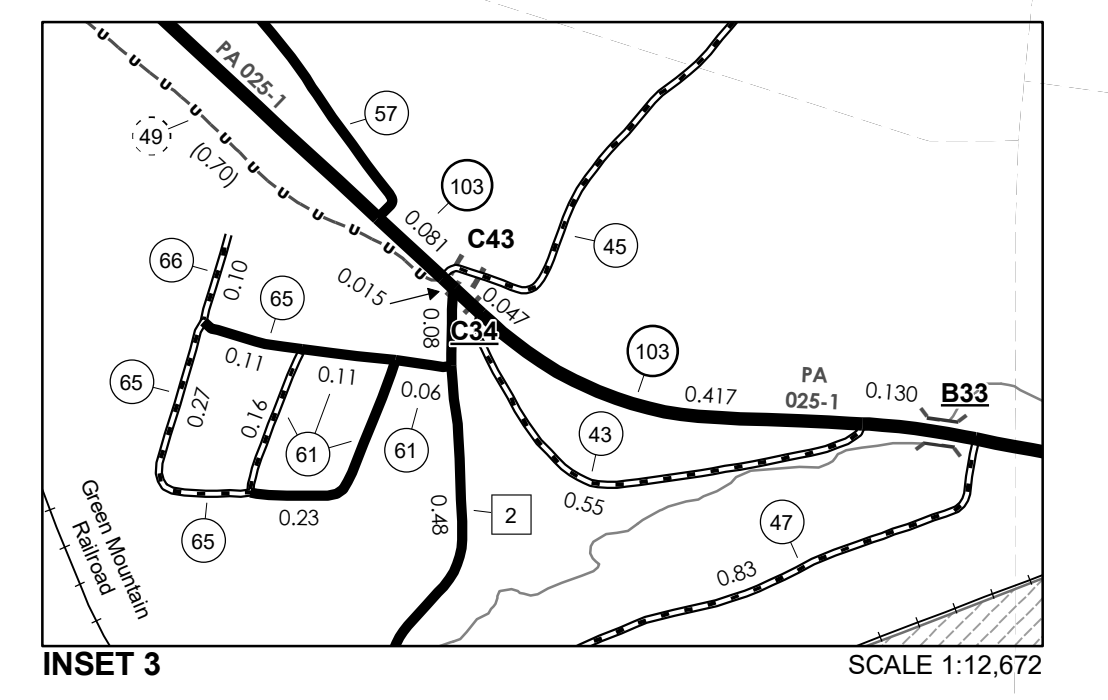
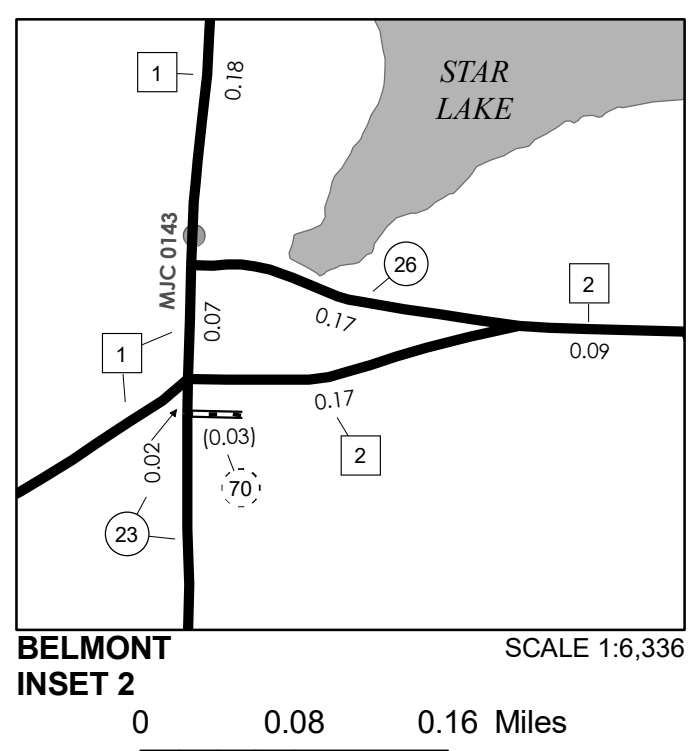
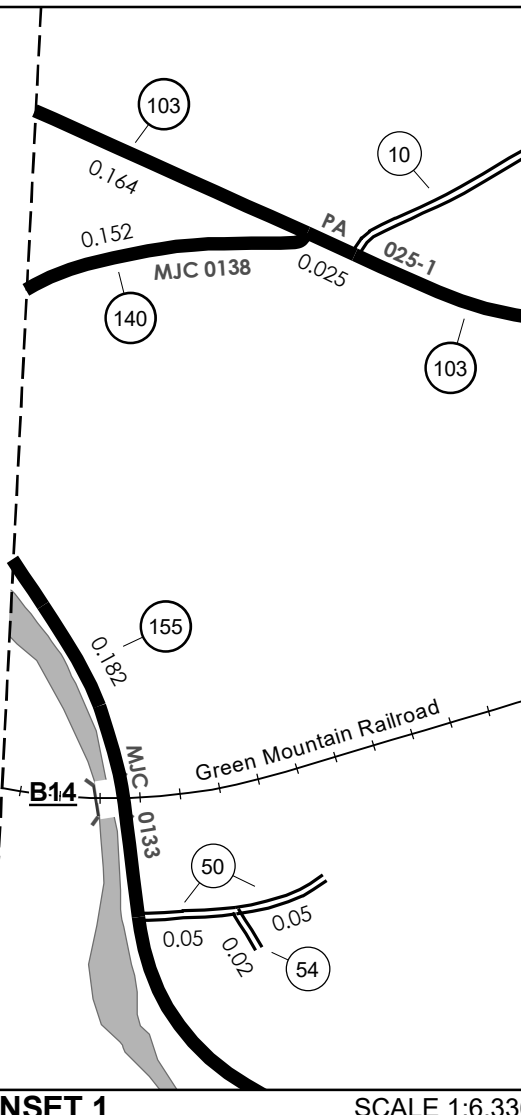

- HIGHWAYS**
- INTERSTATE
 - U.S. ROUTE
 - STATE ROUTE
 - CLASS 1
 - CLASS 2
 - CLASS 3
 - CLASS 4
 - LEGAL TRAIL
 - PARK AND RIDE
 - INTERSTATE OR DIVIDED HIGHWAY
 - STATE - HARD SURFACE OR PAVED
 - TOWN - HARD SURFACE OR PAVED
 - GRAVEL
 - SOIL OR GRADED AND DRAINED EARTH
 - UNIMPROVED OR PRIMITIVE
 - IMPASSABLE OR UNTRAVELED
 - LEGAL TRAIL
 - DISCONTINUED
 - HIGHWAY CLASS CHANGE
 - RAILROAD
 - INACTIVE RAILROAD
 - PUBLIC LAND - NATIONAL FOREST
 - PUBLIC LAND - STATE/MUNICIPAL
 - NFR NATIONAL FOREST ROAD
 - ACE ARMY CORPS OF ENGINEERS
 - USGH UNITED STATES GOV. HWY.
- POLITICAL SUBDIVISIONS**
- STATE BOUNDARY
 - COUNTY BOUNDARY
 - TOWN BOUNDARY
 - VILLAGE BOUNDARY
 - URBAN COMPACT BOUNDARY
 - WATER BODY
 - STREAM OR BROOK
- BRIDGE OR CULVERT**
- BRIDGE OR CULVERT > 20'
 - BRIDGE OR CULVERT 6' - 20'
 - BIKE PATH STRUCTURE
 - VT CULVERTS BRIDGE
 - VT CULVERTS CULVERT > 6'
- FEDERAL CLASSIFICATION IDENTIFIER**
- MA MINOR ARTERIAL
 - MJC MAJOR COLLECTOR
 - MNC MINOR COLLECTOR
 - PA PRINCIPAL ARTERIAL
- B34 / C34 STATE BRIDGE OR CULVERT IDENTIFIER**
B34 / C34 TOWN BRIDGE OR CULVERT IDENTIFIER

DISCLAIMER:
 The untraveled highways (laid-out town highways), discontinued highways, and legal trails herein are those of which the Agency of Transportation has record; others may exist.

Highway and bridge data by the Agency of Transportation. Town short structures drawn from the VT CULVERTS (formerly VOBCT) online database. All other data from the Vermont Open Geodata Portal. Only named streams shown.

Accessibility Statement: The Agency of Transportation is committed to ensuring accessibility and digital accessibility for all. If you need language assistance, reasonable accommodation, or alternative format, please email johnathan.croft@vermont.gov.

Vermont State Plane Coordinate System
 North American Datum of 1983
 SPCS_Zone_Identifier: 4400
 Geodetic Reference System 80
 4,000-meter grid, Easting - Northing

VERMONT
GENERAL HIGHWAY MAP
Town of Mount Holly
 RUTLAND COUNTY
 Transportation District #3
 Prepared by the
 Vermont Agency of Transportation
 Highway Division
 in cooperation with
 U.S. Department of Transportation
 Federal Highway Administration
 Mileage as of February 10, 2026
 Map prepared May 27, 2026
 SCALE 1:31,680

0.5 0 0.5 1 1.5 2 Miles
 0.5 0 0.5 1 1.5 2 Kilometers