

TOWN HWY. No.	LENGTH IN MILES CLASS 3	LENGTH IN MILES CLASS 4
3	0.06	
4	3.20	
5	3.17	
6	3.53	
8	0.87	
10	1.50	
11	0.20	
12	0.15	
13	0.49	
14	0.64	
15	3.74	
16	0.31	
17	0.42	
18	0.36	
19	0.93	
20	2.59	
21	0.65	
22	0.10	
23	0.43	
24	0.38	
25	0.73	
26	3.68	
27	1.59	
28	0.15	
29	1.33	
30	0.62	
31	1.15	
32	0.76	
33	1.34	
34	1.75	
35	1.26	
36	0.71	
41	0.06	
42	0.15	
45	0.12	
47		(0.24)
TOTAL	39.12	0.40

TOWN HWY. No. 41 LENGTH IN MILES "NOT UP TO STANDARD" (0.16)
TOTAL 0.16
 * The sections of the town highways listed above are legally Class 3, but have been deemed "Not Up To Standard" and are functionally Class 4 Town Highways

LEGAL TRAIL No.	LENGTH IN MILES LEGAL TRAIL
2	(0.08)
TOTAL	0.08

MILEAGE SUMMARY		
CLASS 2		
TH-1	8.490	
TH-2	3.230	
TH-3	2.950	
TOTAL CLASS 2	14.670	
CLASS 3		
TOTAL CLASS 3	39.12	
TOTAL TOWN	53.790	
STATE HIGHWAY		
VT-133	0.024	
TOTAL STATE HIGHWAY	0.024	
US HIGHWAY		
US-7	2.473	
TOTAL US HIGHWAY	2.473	
TOTAL STATE	2.497	

TOTAL, TRAVELED HIGHWAYS, FEB. 10, 2022: 56.287
 (Excludes Class 4 and Legal Trail Mileage)

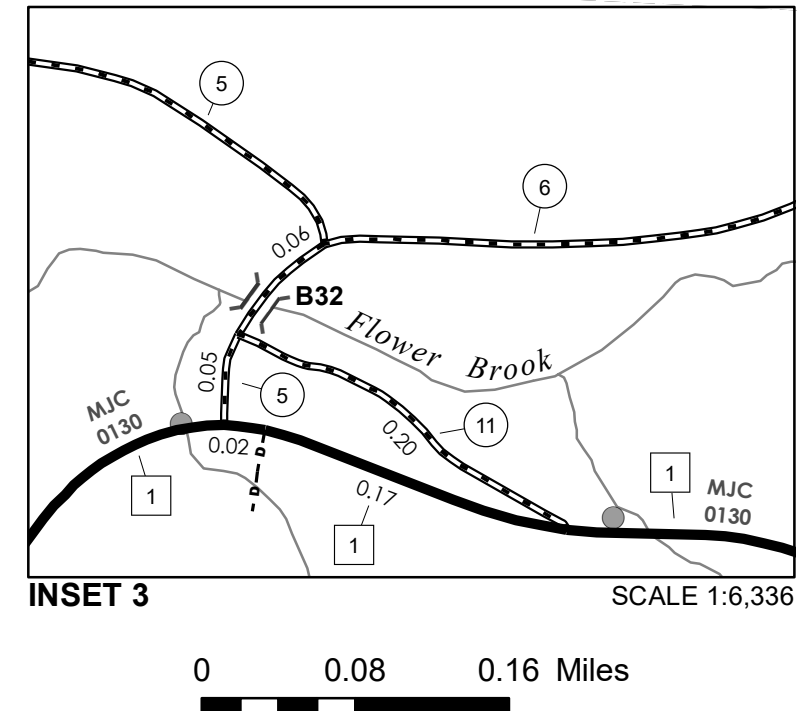

INSET 3 SCALE 1:6,336
 0 0.08 0.16 Miles

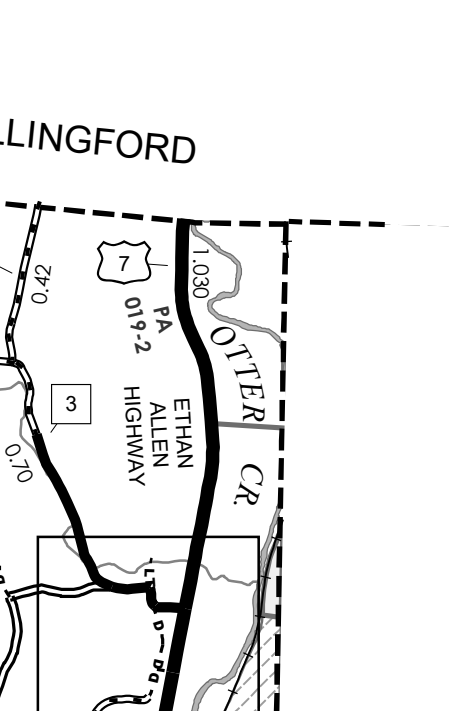

INSET 1

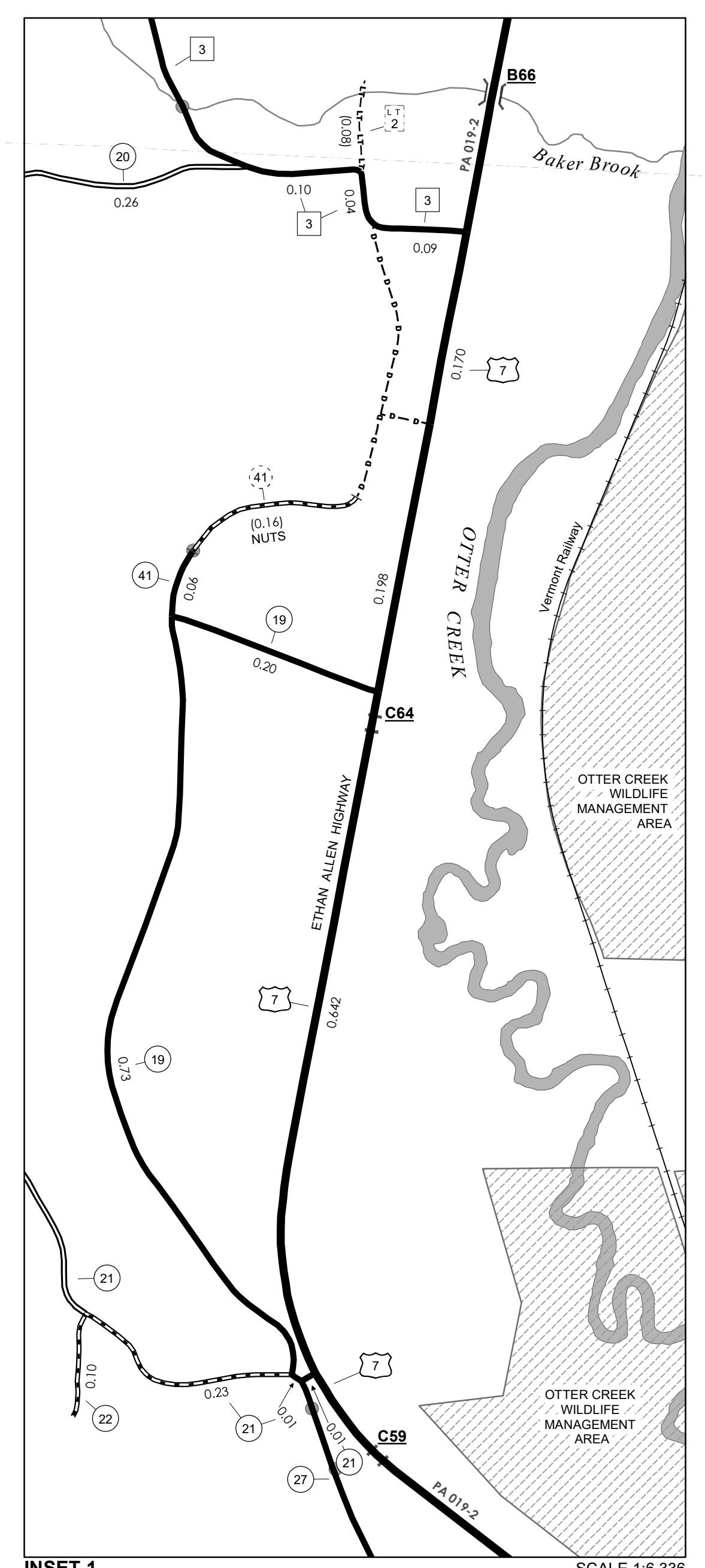

INSET 1 SCALE 1:6,336
 0 0.08 0.16 Miles

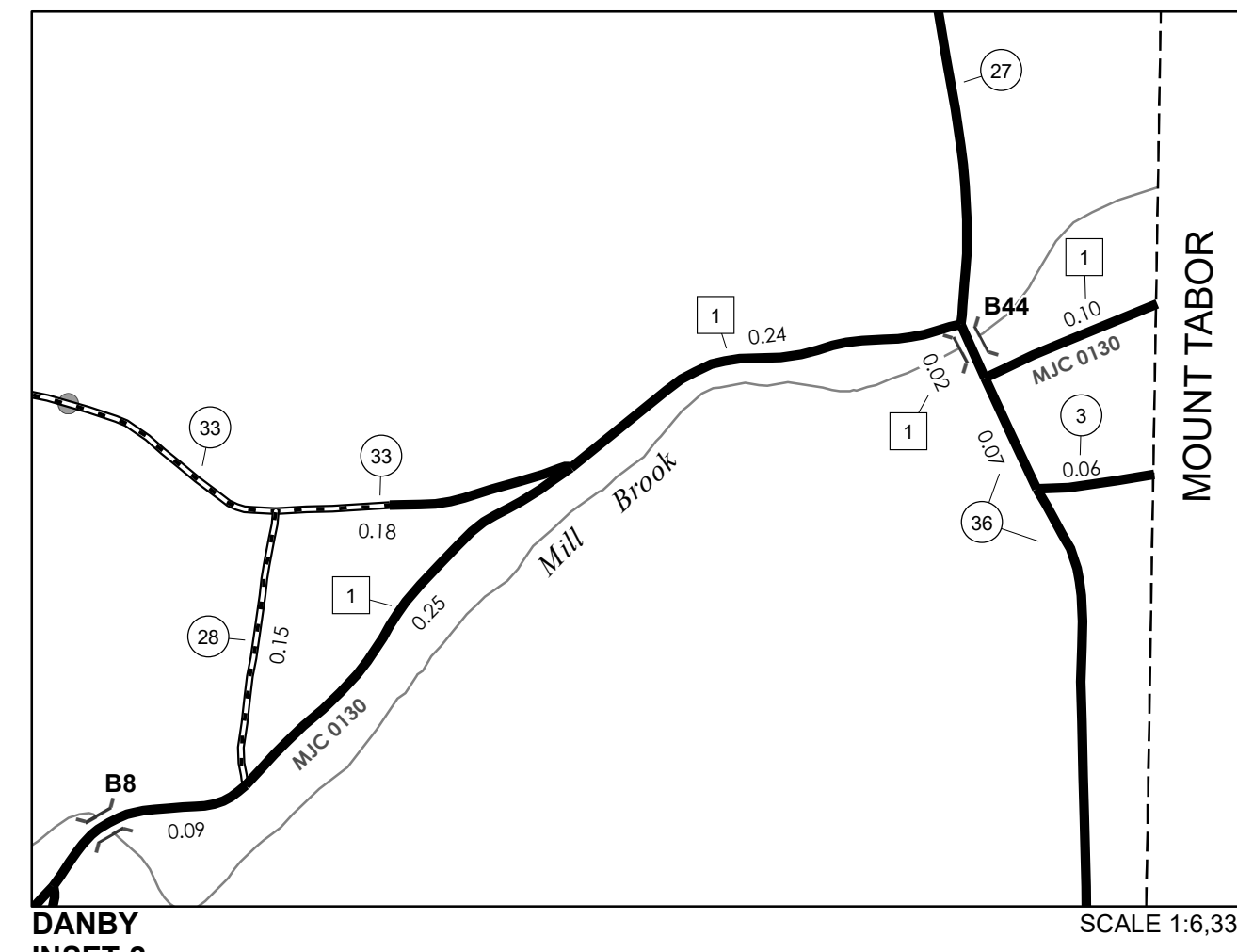

DANBY INSET 2 SCALE 1:6,336
 0 0.08 0.16 Miles

- HIGHWAYS**
 - INTERSTATE
 - U.S. ROUTE
 - STATE ROUTE
 - CLASS 1
 - CLASS 2
 - CLASS 3
 - CLASS 4
 - LEGAL TRAIL
 - PARK AND RIDE
 - INTERSTATE OR DIVIDED HIGHWAY
 - STATE - HARD SURFACE OR PAVED
 - TOWN - HARD SURFACE OR PAVED
 - GRAVEL
 - SOIL OR GRADED AND DRAINED EARTH
 - UNIMPROVED OR PRIMITIVE
 - IMPASSABLE OR UNTRAVELED
 - LEGAL TRAIL
 - DISCONTINUED
 - HIGHWAY CLASS CHANGE
 - RAILROAD
 - INACTIVE RAILROAD
 - PUBLIC LAND - NATIONAL FOREST
 - PUBLIC LAND - STATE/MUNICIPAL
 - NATIONAL FOREST ROAD
 - USGH UNITED STATES GOV. HWY.
- POLITICAL SUBDIVISIONS**
 - STATE BOUNDARY
 - COUNTY BOUNDARY
 - TOWN BOUNDARY
 - VILLAGE BOUNDARY
 - URBAN COMPACT BOUNDARY
 - WATER BODY
 - STREAM OR BROOK
 - BRIDGE OR CULVERT
 - BRIDGE OR CULVERT > 20'
 - BRIDGE OR CULVERT 6' - 20'
 - BIKE PATH STRUCTURE
 - VT CULVERTS BRIDGE
 - VT CULVERTS CULVERT > 6'
 - STATE BRIDGE OR CULVERT IDENTIFIER (B34 / C34)
 - TOWN BRIDGE OR CULVERT IDENTIFIER (B34 / C34)
- FEDERAL CLASSIFICATION IDENTIFIER**
 - MA MINOR ARTERIAL
 - MJC MAJOR COLLECTOR
 - MNC MINOR COLLECTOR
 - PA PRINCIPAL ARTERIAL

DISCLAIMER:
 The untraveled highways (laid-out town highways), discontinued highways, and legal trails herein are those of which the Agency of Transportation has record; others may exist.

Highway and bridge data by the Agency of Transportation. Town short structures drawn from the VTCULVERTS (formerly VOBCIT) online database. All other data from the Vermont Open Geodata Portal. Only named streams shown.

Vermont State Plane Coordinate System
 North American Datum of 1983
 SPCS_Zone_Identifier: 4400
 Geodetic Reference System 80
 4,000-meter grid, Easting - Northing

VERMONT GENERAL HIGHWAY MAP

Town of Danby

RUTLAND COUNTY
 Transportation District #1
 Prepared by the Vermont Agency of Transportation
 Division of Policy, Planning and Intermodal Development
 in cooperation with
 U.S. Department of Transportation
 Federal Highway Administration

