

TOWN HWY. NO.	CLASS 3	CLASS 4
9	2.94	(0.82)
10	0.19	
11	1.95	
12	1.52	
13	0.95	
14	0.31	
15	0.11	
16	0.21	
17	1.64	
18		(1.30)
19	0.65	
20	0.70	
21	0.30	
22	2.20	
23	0.32	
24	0.58	
25	1.55	
26	1.29	
28	0.50	
29	0.06	
30	0.39	
31	0.07	
32	0.13	
33		(0.07)
34	0.07	
35	0.06	
37	0.60	
38	0.14	
39	3.06	
40	0.15	
42	0.42	
43	0.14	
44	0.28	
45	0.28	
46	0.24	
47	0.20	
48	0.21	
49	0.53	
50	0.15	
51	0.36	
52		(0.28)
TOTAL	25.45	2.73

MILEAGE SUMMARY		
CLASS 2		
TH-1	4.110	
TH-2	5.550	
TH-3	6.210	
TH-4	1.940	
TH-6	0.540	
TH-7	1.760	
TH-8	3.260	
TOTAL CLASS 2	23.370	
CLASS 3		
TOTAL CLASS 3	25.450	
TOTAL TOWN	48.820	
STATE HIGHWAY		
VT-7B	5.245	
VT-103	1.979	
VT-133	1.434	
TOTAL STATE HIGHWAY	8.658	
STATE HIGHWAY - Ramp		
VT-103	0.127	
TOTAL STATE HIGHWAY - Ramp	0.127	
US HIGHWAY		
US-7	5.656	
TOTAL US HIGHWAY	5.656	
TOTAL STATE	14.441	

TOTAL, TRAVELED HIGHWAYS, FEB. 10, 2010: 63.261
(Excludes Class 4 and Legal Trail Mileage)

- HIGHWAYS**
- INTERSTATE
- U.S. ROUTE
- STATE ROUTE
- CLASS 1
- CLASS 2
- CLASS 3
- CLASS 4
- LEGAL TRAIL
- INTERSTATE OR DIVIDED HIGHWAY
- STATE - HARD SURFACE OR PAVED
- TOWN - HARD SURFACE OR PAVED
- GRAVEL
- SOIL OR GRADED AND DRAINED EARTH
- UNIMPROVED OR PRIMITIVE
- IMPASSABLE OR UNTRAVELED
- LEGAL TRAIL
- DISCONTINUED
- HIGHWAY CLASS CHANGE
- RAILROAD
- PUBLIC LAND
- POLITICAL SUBDIVISIONS
- STATE BOUNDARY
- COUNTY BOUNDARY
- TOWN BOUNDARY
- VILLAGE BOUNDARY
- URBAN COMPACT BOUNDARY
- WATER BODIES
- STREAM OR BROOK
- BRIDGE OR CULVERT
- BRIDGE OR CULVERT GREATER THAN 20'
- BRIDGE OR CULVERT 6' - 20'
- TOWN SHORT STRUCTURE
- B34 / C34 STATE BRIDGE OR CULVERT IDENTIFIER
- B34 / C34 TOWN BRIDGE OR CULVERT IDENTIFIER
- FEDERAL CLASSIFICATION IDENTIFIER
- FAU URBAN ARTERIAL OR COLLECTOR
- MA MINOR ARTERIAL
- MJC MAJOR COLLECTOR
- MNC MINOR COLLECTOR
- PA PRINCIPAL ARTERIAL

STRUCTURES - SURFACE WATER NOTE:
STRUCTURES: Town short structures (bridges or culverts from 4-feet to less than 20-feet) are drawn from the Vermont Online Bridge & Culvert Inventory Tool (VOBCIT) database.
NOTE: Town shorts are not consistently tagged within VOBCIT.
The surface waters are from the Vermont Hydrological Dataset (VHD). Only the named streams are shown.

DISCLAIMER:
The untraveled highways (laid-out town highways), discontinued highways, and legal trails shown hereon are those of which the Agency of Transportation has record; others may exist.
Highway and bridge data by the Agency of Transportation. All other data from the Vermont Center for Geographic Information.

Vermont State Plane Coordinate System
North American Datum of 1983
SPCS Zone Identifier: 4400
Geodetic Reference System 80
4,000-meter grid, Easting - Northing

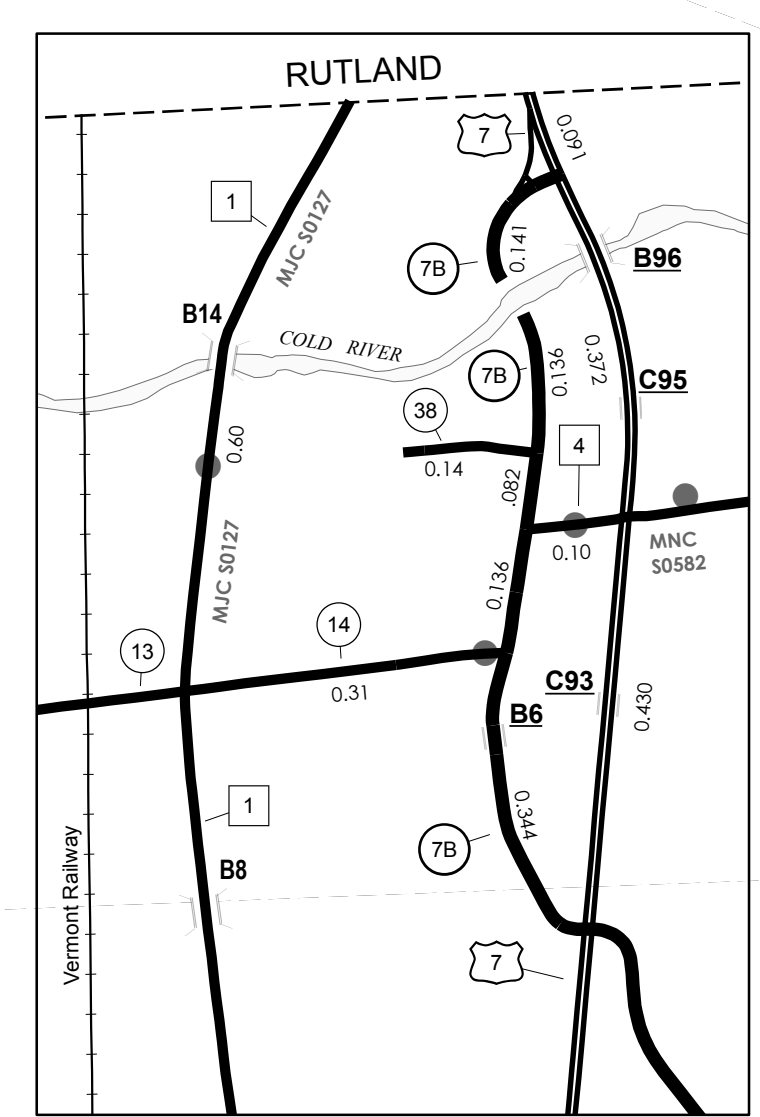
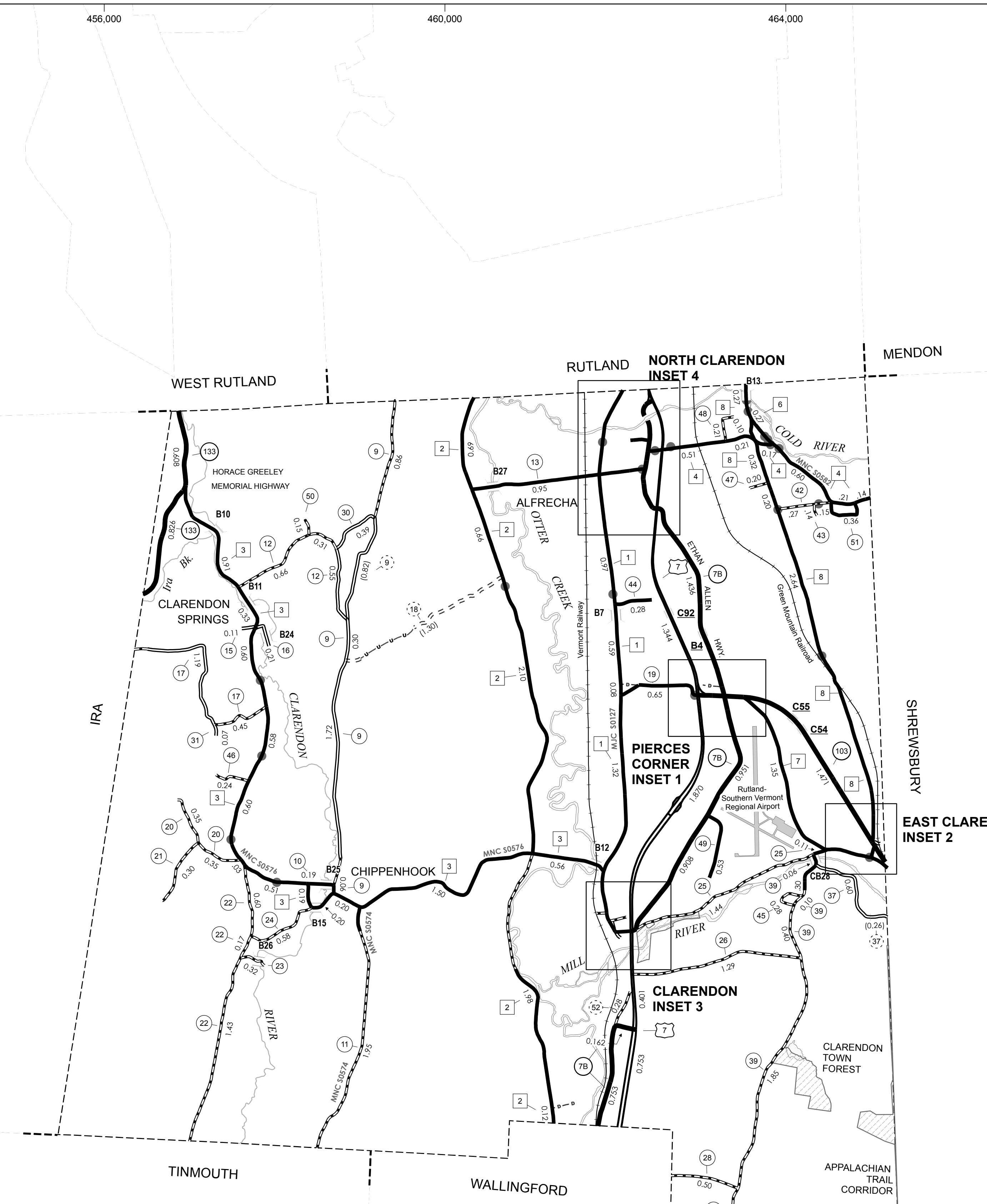

NORTH CLARENDON INSET 4
INSET SCALE 1:12672
0 0.2 0.4 Miles

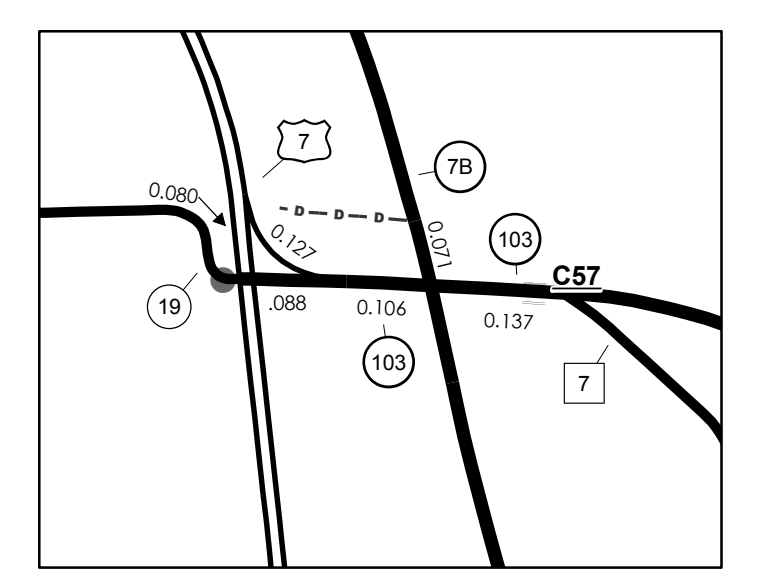

PIERCES CORNER INSET 1
INSET SCALE 1:12672
0 0.2 0.4 Miles

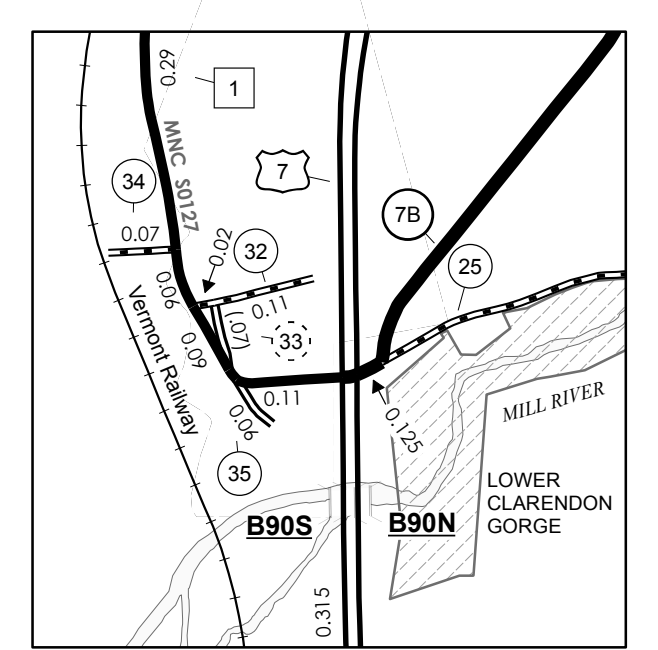
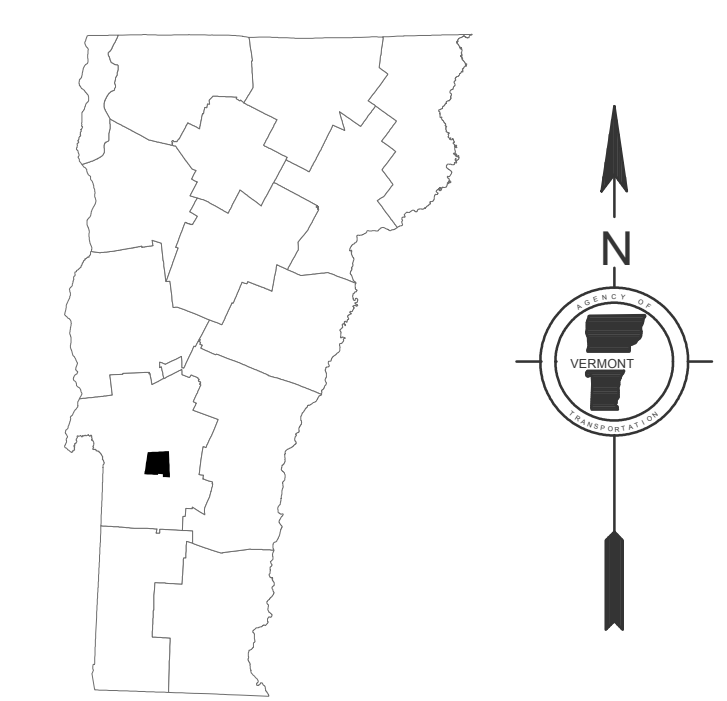

CLARENDON INSET 3
INSET SCALE 1:12672
0 0.2 0.4 Miles

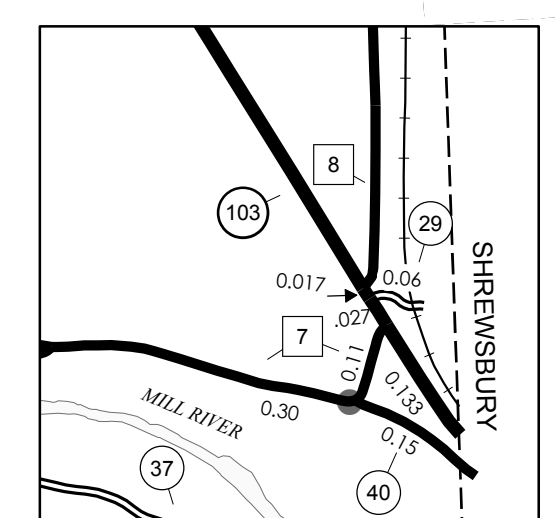

EAST CLARENDON INSET 2
INSET SCALE 1:12672
0 0.2 0.4 Miles

VERMONT GENERAL HIGHWAY MAP

Town of Clarendon

RUTLAND COUNTY

Transportation District #3

Prepared by the
Vermont Agency of Transportation
Division of Planning, Outreach
and Community Affairs
in cooperation with
U.S. Department of Transportation
Federal Highway Administration

Mileage as of February 10, 2010
Map prepared April 5, 2010

SCALE 1:31,680

