

TOWN HWY. NO.	LENGTH IN MILES CLASS 3	LENGTH IN MILES CLASS 4
9	2.940	(0.820)
10	0.190	
11	1.950	
12	1.520	
13	0.950	
14	0.310	
15	0.110	
16	0.210	
17	1.640	
18		(1.300)
19	0.650	
20	0.700	
21	0.300	
22	2.200	
23	0.320	
24	0.580	
25	1.550	
26	1.290	
28	0.500	
29	0.060	
30	0.390	
31	0.070	
32	0.130	
33		(0.070)
34	0.070	
35	0.040	
37	0.600	
38	0.140	
39	3.060	
40	0.150	
42	0.420	
43	0.140	
44	0.280	
45	0.280	
46	0.240	
47	0.200	
48	0.210	
49	0.530	
50	0.150	
51	0.360	
<b>TOTAL</b>	<b>25.430</b>	<b>2.450</b>

**MILEAGE SUMMARY**

<b>CLASS 2</b>	
TH-1	4.110
TH-2	5.550
TH-3	6.210
TH-4	1.940
TH-6	0.540
TH-7	1.760
TH-8	3.260
<b>TOTAL CLASS 2</b>	<b>23.370</b>
<b>CLASS 3</b>	
<b>TOTAL CLASS 3</b>	<b>25.430</b>
<b>TOTAL TOWN</b>	<b>48.800</b>
<b>STATE HIGHWAY</b>	
VT-7B	5.245
VT-103	1.979
VT-133	1.434
<b>TOTAL STATE HIGHWAY</b>	<b>8.658</b>
<b>STATE HIGHWAY - Ramp</b>	
VT-103	0.127
<b>TOTAL STATE HIGHWAY - Ramp</b>	<b>0.127</b>
<b>US HIGHWAY</b>	
US-7	5.656
<b>TOTAL US HIGHWAY</b>	<b>5.656</b>
<b>TOTAL STATE</b>	<b>14.441</b>

**TOTAL, TRAVELED HIGHWAYS, FEB. 10, 2007: 63.241**  
(Excludes Class 4 and Legal Trail Mileage)

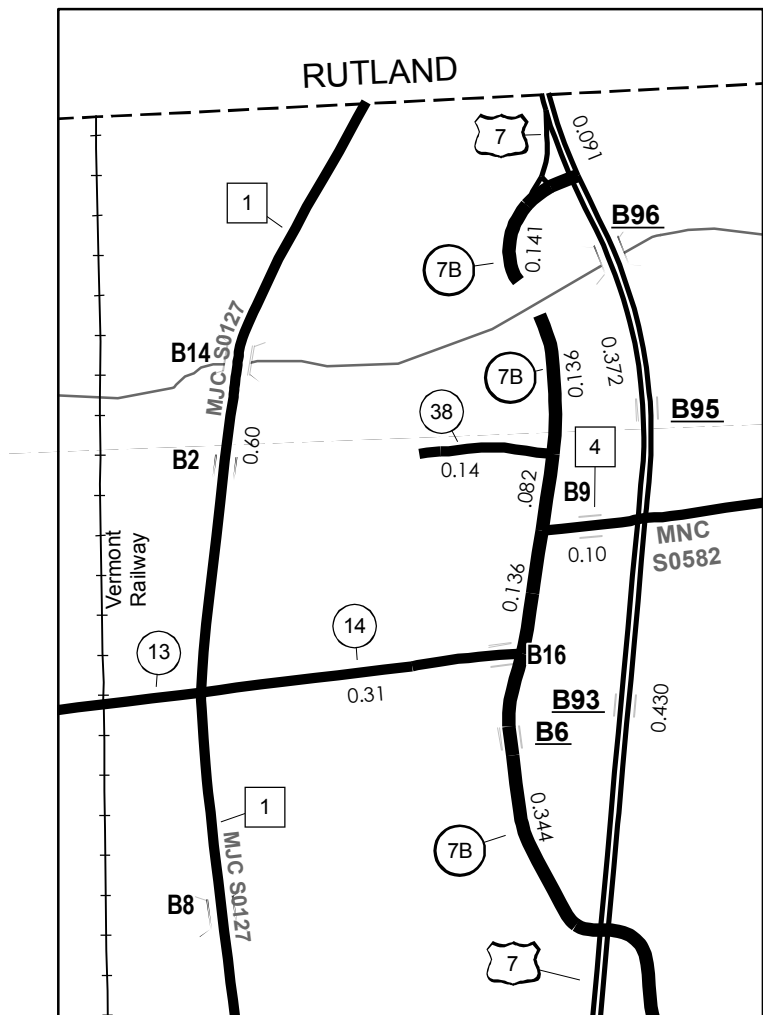
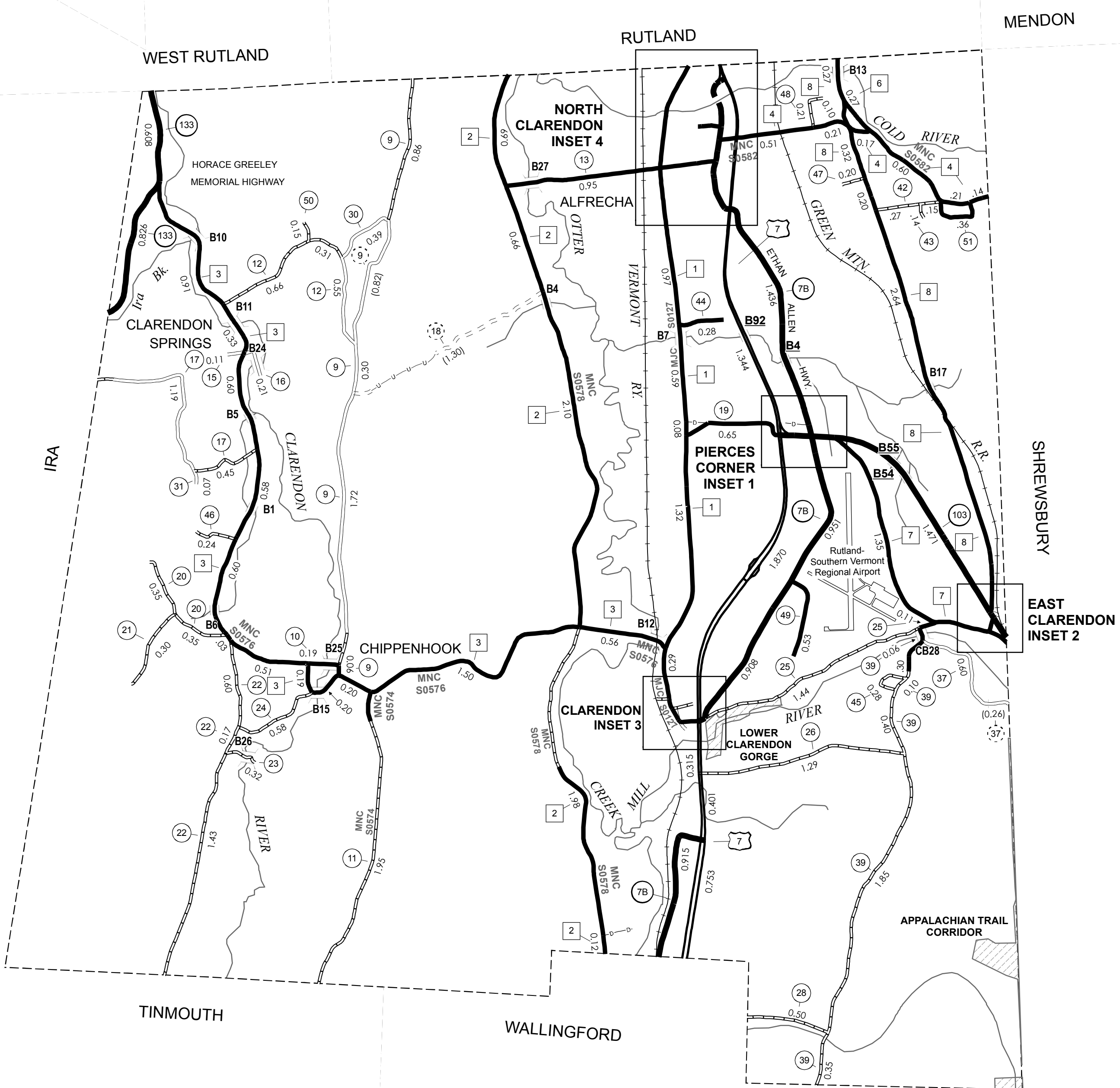

NORTH CLARENDON INSET 4 SCALE 1:12672

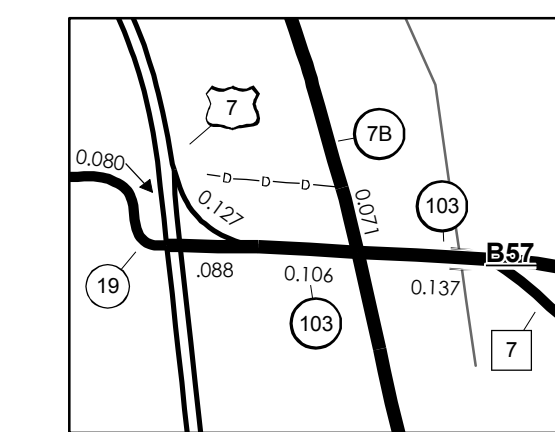

PIERCES CORNER INSET 1 SCALE 1:12672

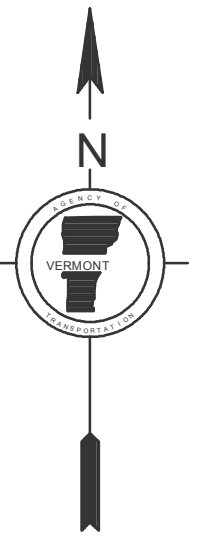
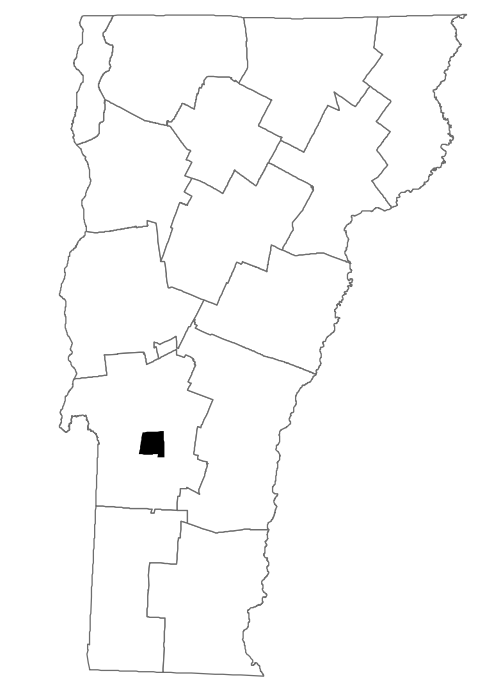
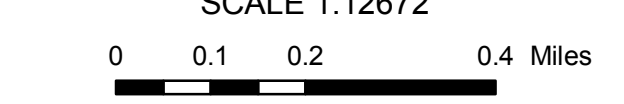

- HIGHWAYS**
- INTERSTATE
- U.S. ROUTE
- STATE ROUTE
- CLASS 1
- CLASS 2
- CLASS 3
- CLASS 4
- LEGAL TRAIL
- INTERSTATE OR DIVIDED HIGHWAY
- STATE - HARD SURFACE OR PAVED
- TOWN - HARD SURFACE OR PAVED
- GRAVEL
- SOIL OR GRADED AND DRAINED EARTH
- UNIMPROVED OR PRIMITIVE
- IMPASSABLE OR UNTRAVELED
- LEGAL TRAIL
- DISCONTINUED
- HIGHWAY CLASS CHANGE
- RAILROAD
- FEDERAL CLASSIFICATION IDENTIFIER
- FAU URBAN ARTERIAL OR COLLECTOR
- MA MINOR ARTERIAL
- MJC MAJOR COLLECTOR
- MNC MINOR COLLECTOR
- PA PRINCIPAL ARTERIAL
- PUBLIC LAND
- POLITICAL SUBDIVISIONS
- STATE BOUNDARY
- COUNTY BOUNDARY
- TOWN BOUNDARY
- VILLAGE BOUNDARY
- URBAN COMPACT BOUNDARY
- WATER BODIES
- OPEN WATER
- SWAMP
- STREAM OR BROOK
- BRIDGE OR CULVERT
- BRIDGE OR CULVERT GREATER THAN 20'
- BRIDGE OR CULVERT 6' - 20'
- B34 STATE BRIDGE IDENTIFIER
- B34 TOWN BRIDGE IDENTIFIER

**DISCLAIMER:**  
The untraveled highways (laid-out town highways), discontinued highways, and legal trails shown hereon are those of which the Agency of Transportation has record; others may exist.  
Highway and bridge data by the Agency of Transportation, Policy & Planning Division. All other data from the Vermont Center for Geographic Information.

Vermont State Plane Coordinate System  
North American Datum of 1983  
SPCS Zone Identifier: 4400  
Geodetic Reference System 80  
4,000-meter grid, Easting - Northing

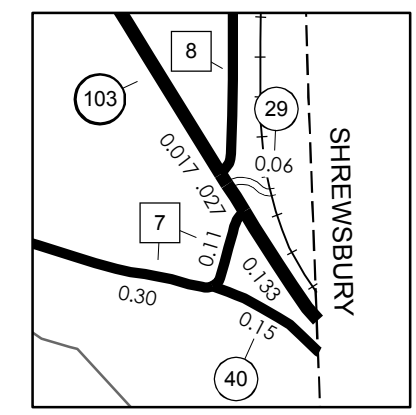

EAST CLARENDON INSET 2

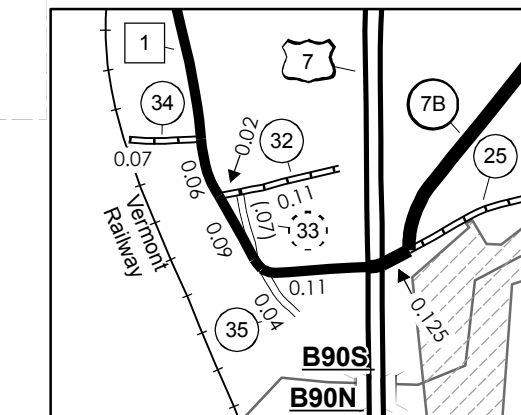

CLARENDON INSET 3

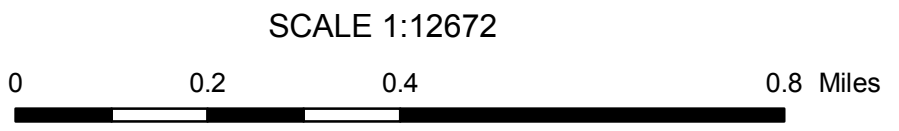

**VERMONT GENERAL HIGHWAY MAP**  
**Town of Clarendon**  
RUTLAND COUNTY

Transportation District #3

Prepared by the  
Vermont Agency of Transportation  
Policy & Planning Division  
in cooperation with  
U.S. Department of Transportation  
Federal Highway Administration

Mileage as of: Feb. 10, 2007  
Map generated: October, 2007

