

TOWN HWY. NO.	LENGTH IN MILES CLASS 3	LENGTH IN MILES CLASS 4	TOTAL	FUNCTIONALLY CLASS 4
5	0.270	46	0.920	(1.240)
6	0.120	47	0.100	(0.350)
7	0.100	48	1.950	
8	0.410	49	0.100	
9	0.120	50	0.160	
10	0.100	51	0.400	
11	0.150	52	0.340	
12	0.670	53	0.280	
13	1.550	54	0.290	
14	0.630	55	0.120	
15	1.200	56	1.120	
16	1.220	57	0.540	
17	0.080	58	0.060	
18		59	0.190	
19	0.060 (1.790)	60	0.060	
20	0.080 (0.040)	61	0.170	
21		62	0.240	
22	1.250 (0.010)	63	0.400	
23	0.300	64	0.100	
24	2.240	65	0.500	
25	0.730 (0.420)	66	0.420	
26	1.050	67	0.110	
27	0.200	68	0.260	
28	0.770	69	0.340	
29	1.800	70	0.120	
30	0.450	71	0.100	
31	1.600	72	0.150	
32	0.440	73	0.090	
33		74	0.190	
34	0.160 (0.330)	75	0.120	
35	0.180	76	0.290	
36	0.420	77	0.120	
37	0.140	78	0.120	
38	0.100	79	0.410	
39	0.150	80	0.170	
41	1.090	81	0.240	
42	1.700	82	0.090	
43	0.400	83	0.290	
44	2.230	84	0.100	
45		85	0.180	
45	(0.524)			
45	(0.176)			
TOTAL		36.110	4.880	

* This portion of town highway is Class 3, but is functionally Class 4

MILEAGE SUMMARY		
CLASS 1		
TH-1	1.096	
TOTAL CLASS 1	1.096	
CLASS 2		
TH-2	4.820	
TH-3	4.970	
TH-4	2.650	
TH-5	4.120	
TH-6	1.300	
TOTAL CLASS 2	17.860	
CLASS 3		
TOTAL CLASS 3	36.110	
TOTAL TOWN	55.066	
STATE HIGHWAY		
VT-4A	5.841	
VT-30	6.566	
NSH-CSH	0.398	
TOTAL STATE HIGHWAY	12.805	
US HIGHWAY		
US-4	7.038	
TOTAL US HIGHWAY	7.038	
US HIGHWAY - Ramp		
US-4	1.806	
TOTAL US HIGHWAY - Ramp	1.806	
TOTAL STATE	21.649	

TOTAL, TRAVELED HIGHWAYS, FEB. 10, 2007: 76.715
(Excludes Class 4 and Legal Trail Mileage)

- HIGHWAYS**
 - INTERSTATE
 - U.S. ROUTE
 - STATE ROUTE
 - CLASS 1
 - CLASS 2
 - CLASS 3
 - CLASS 4
 - INTERSTATE OR DIVIDED HIGHWAY
 - STATE - HARD SURFACE OR PAVED
 - TOWN - HARD SURFACE OR PAVED
 - STATE FOREST HIGHWAY
 - GRAVEL
 - SOIL OR GRADED AND DRAINED EARTH
 - UNIMPROVED OR PRIMITIVE
 - IMPASSABLE OR UNTRAVELED
 - LEGAL TRAIL
 - DISCONTINUED
 - HIGHWAY CLASS CHANGE
 - RAILROAD
- PUBLIC LAND**
 - POLITICAL SUBDIVISIONS
 - STATE BOUNDARY
 - COUNTY BOUNDARY
 - TOWN BOUNDARY
 - VILLAGE BOUNDARY
 - URBAN COMPACT
 - WATER BODIES
 - OPEN WATER
 - SWAMP
 - STREAM OR BROOK
 - BRIDGE OR CULVERT
 - BRIDGE OR CULVERT GREATER THAN 20'
 - BRIDGE OR CULVERT 6' - 20'
 - B34 STATE BRIDGE IDENTIFIER
 - B34 TOWN BRIDGE IDENTIFIER
 - SFH STATE FOREST HIGHWAY
 - WMA WILDLIFE MANAGEMENT AREA
- FEDERAL CLASSIFICATION IDENTIFIER**
 - FAU URBAN ARTERIAL OR COLLECTOR
 - MA MINOR ARTERIAL
 - MJC MAJOR COLLECTOR
 - MNC MINOR COLLECTOR
 - PA PRINCIPAL ARTERIAL

DISCLAIMER:
The untraveled highways (laid-out town highways), discontinued highways, and legal trails shown hereon are those of which the Agency of Transportation has record; others may exist.
Highway and bridge data by the Agency of Transportation, Policy & Planning Division. All other data from the Vermont Center for Geographic Information.

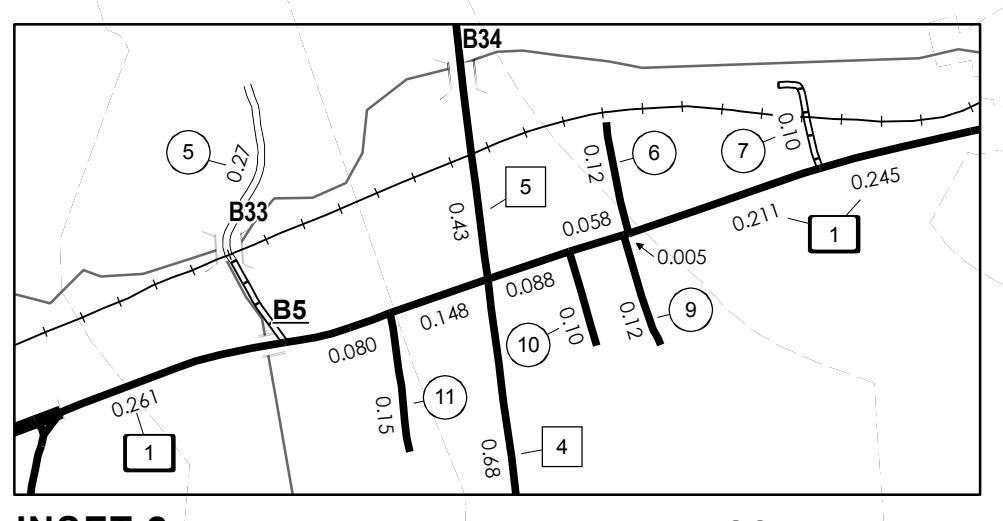
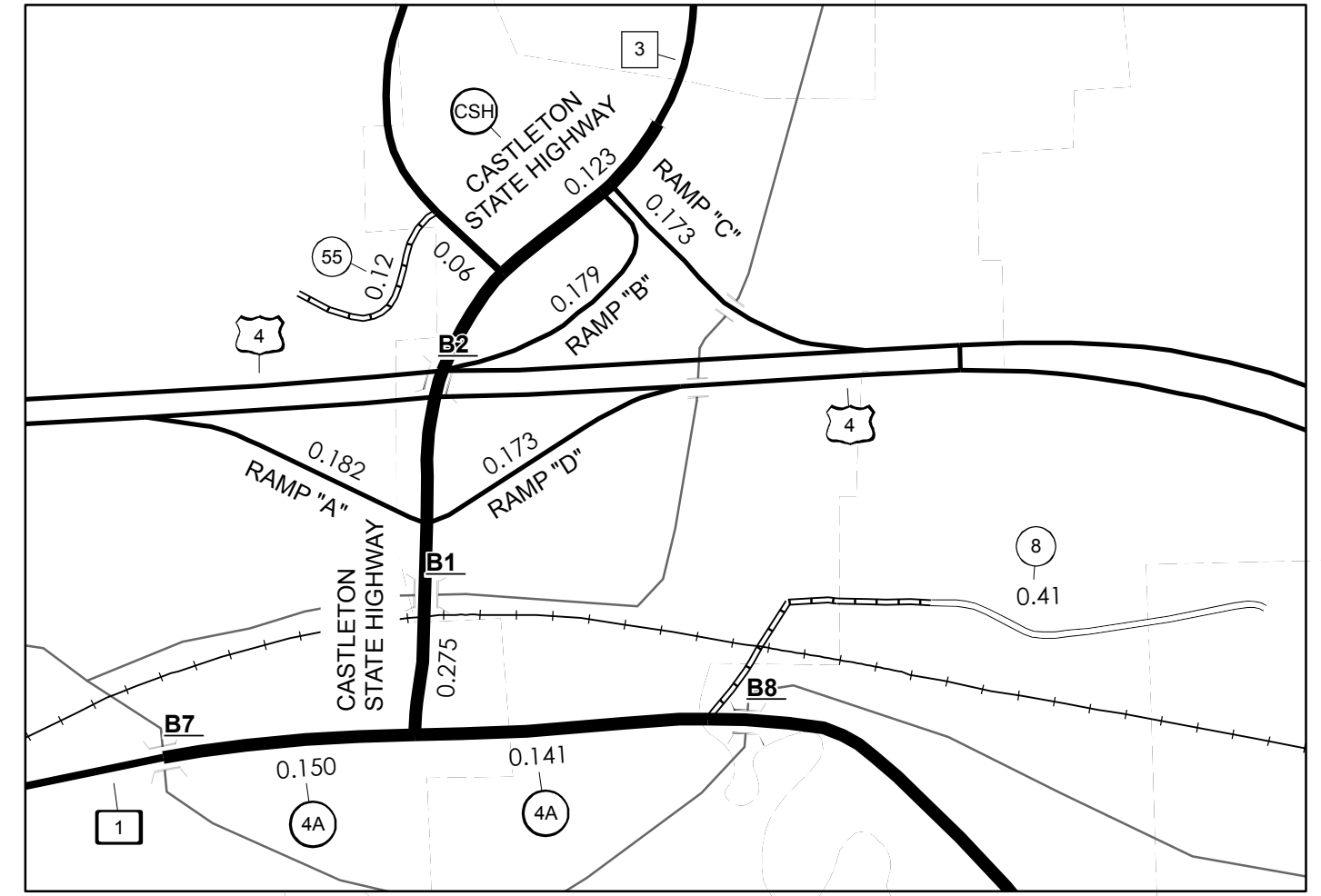
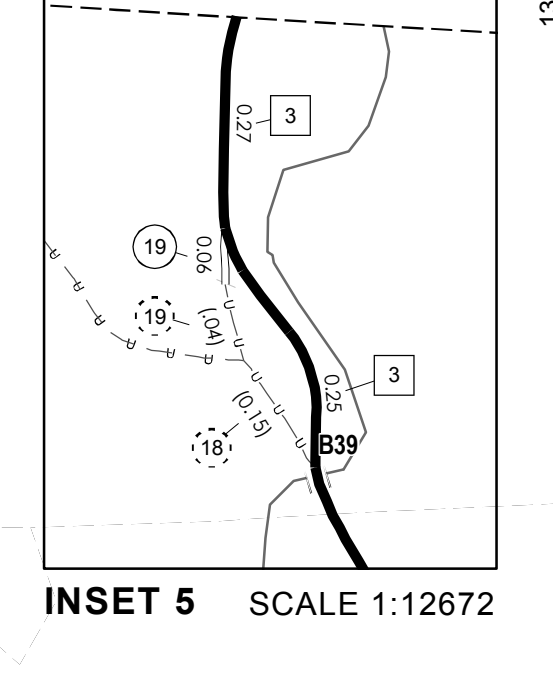
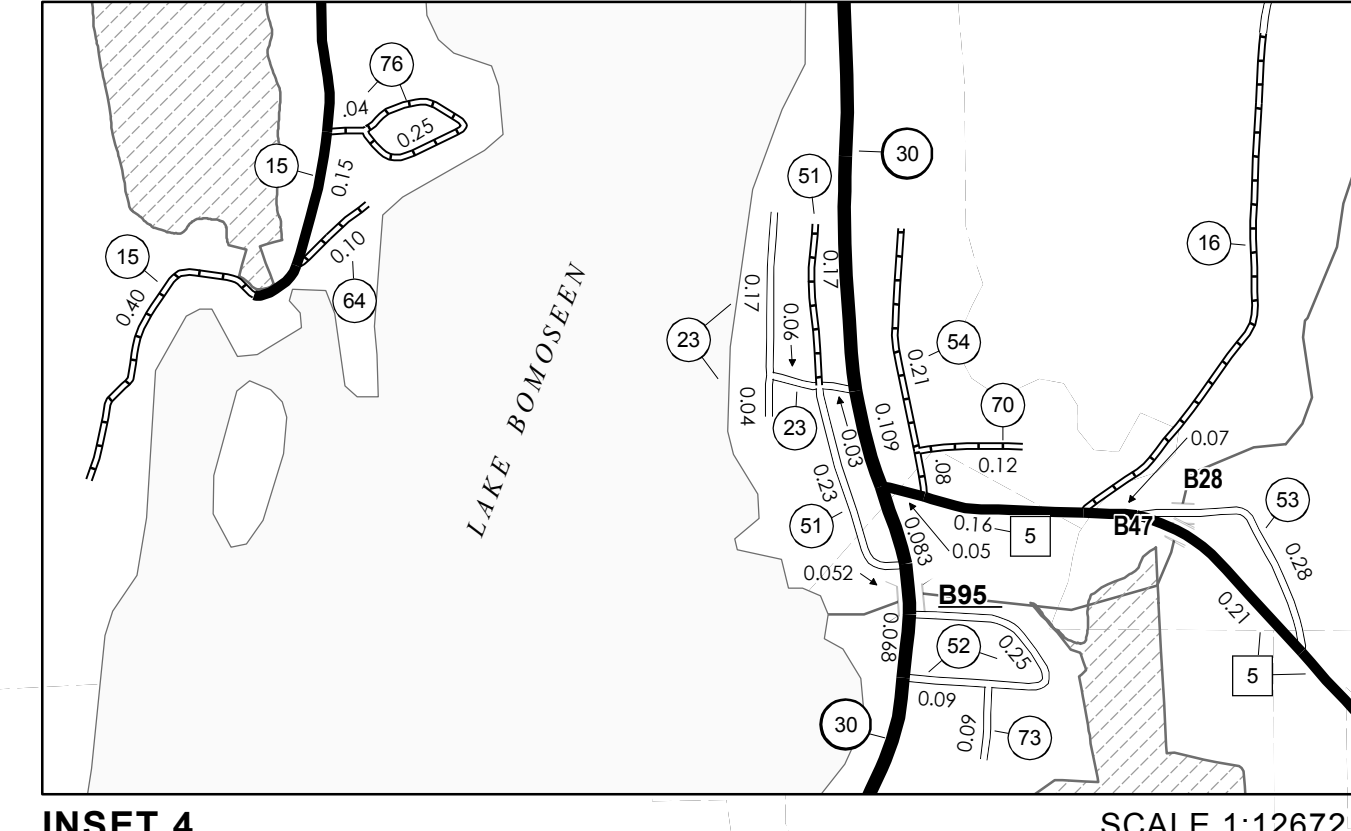
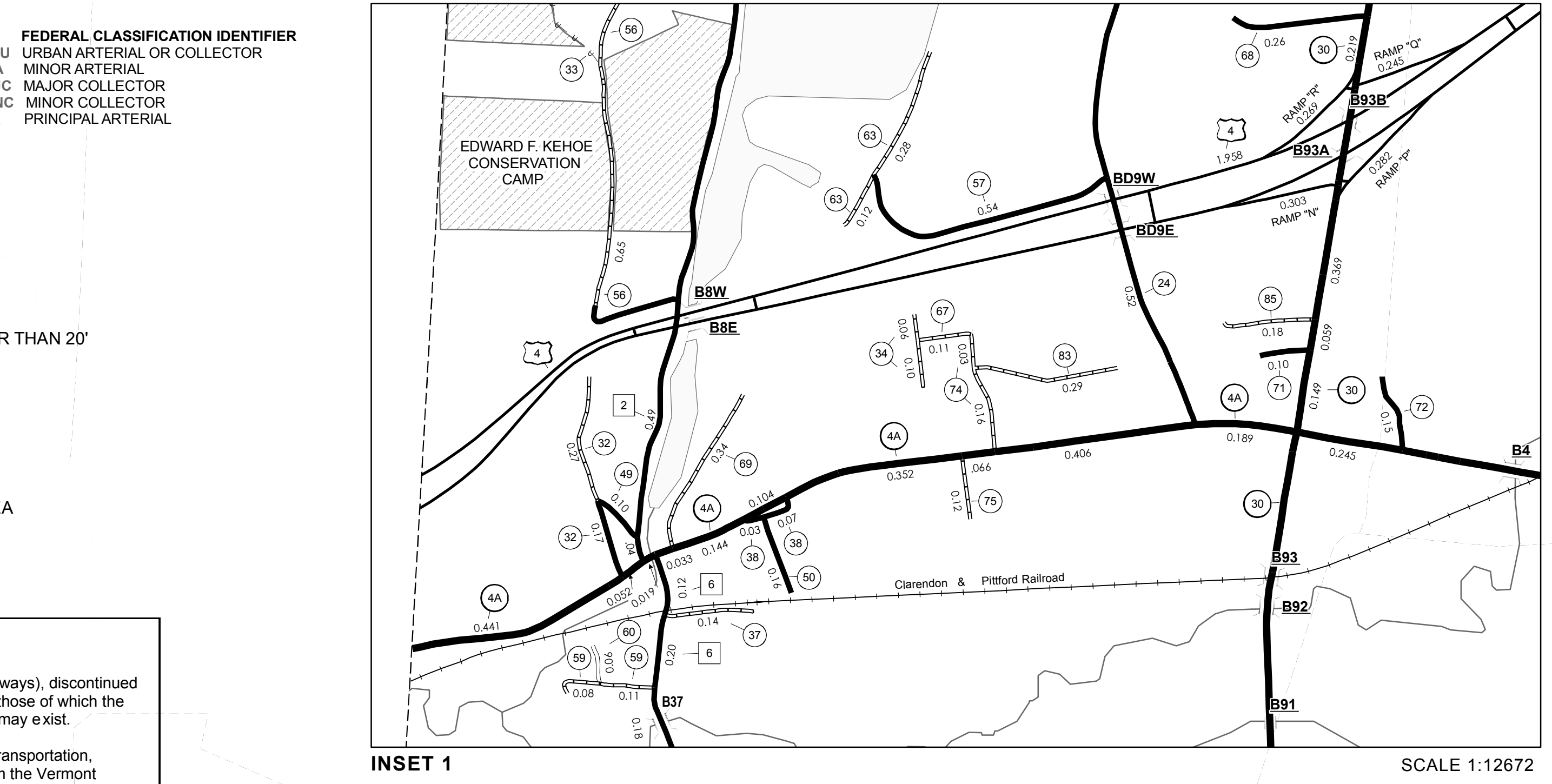
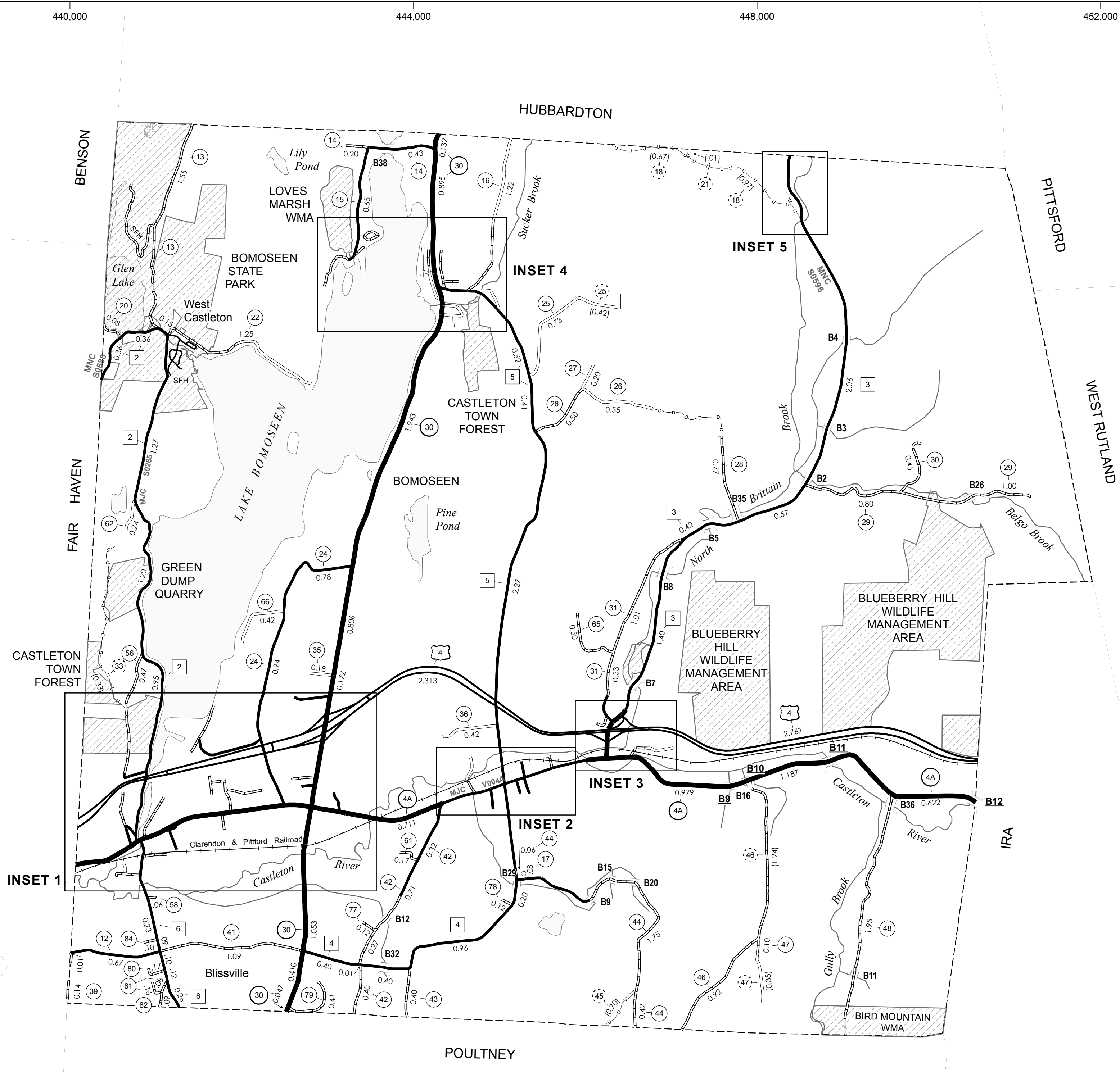

VERMONT GENERAL HIGHWAY MAP
Town of Castleton
RUTLAND COUNTY
Transportation District #3

Prepared by the
Vermont Agency of Transportation
Policy & Planning Division
in cooperation with
U.S. Department of Transportation
Federal Highway Administration

Mileage as of: Feb. 10, 2007
Map generated: October, 2007

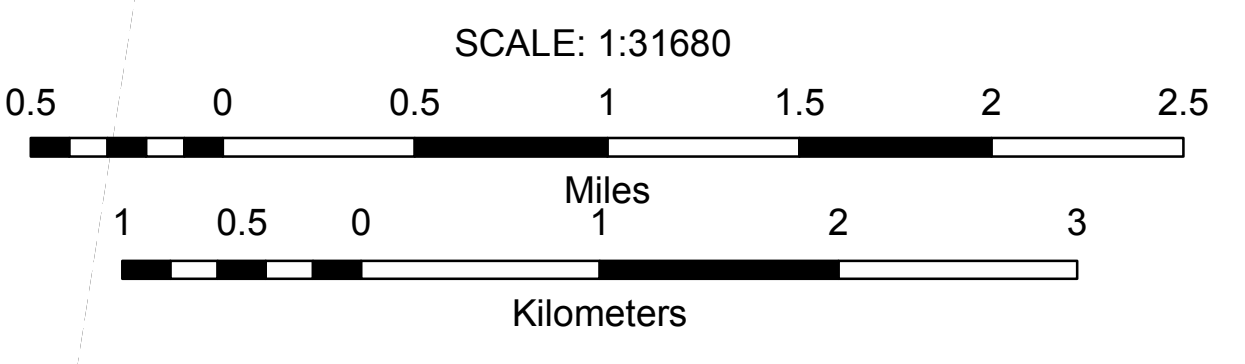

Vermont State Plane Coordinate System
North American Datum of 1983
SPCS_Zone_Identifier: 4400
Geodetic Reference System 80
4,000-meter grid, Easting - Northing