

MILEAGE SUMMARY

CLASS 2			
TH-1	3.720		
TH-2	4.240		
TH-3	4.900		
TH-4	2.100		
	TOTAL CLASS 2	14.960	
CLASS 3			
	TOTAL CLASS 3	36.61	
	TOTAL TOWN	51.570	
STATE HIGHWAY			
VT-22A	6.276		
	TOTAL STATE HIGHWAY	6.276	
	TOTAL STATE	6.276	

TOTAL, TRAVELED HIGHWAYS, FEB. 10, 2017: 57.846
(Excludes Class 4 and Legal Trail Mileage)

TOWN HWY. No.	LENGTH IN MILES CLASS 3	LENGTH IN MILES CLASS 4
6	2.95	(0.85)
7	5.03	
8	3.13	
9	0.33	
10	0.29	
11	3.28	
12	0.40	
13	1.09	
14	1.00	
15	0.65	
16	0.30	(0.05)
17	3.30	
18	3.60	
19		(0.75)
20	2.10	
21	0.90	
22	0.62	
23	0.18	(0.72)
24	0.86	
25	1.74	
26	1.05	
27	0.14	
28	0.60	
29	2.22	
30	0.80	
31	0.05	
32		(1.70)
TOTAL	36.61	4.07

TOWN HWY. No.	LENGTH IN MILES "NOT UP TO STANDARD"
27	(0.11)
TOTAL	0.11

*The sections of the town highways listed above are legally Class 3, but have been deemed "Not Up To Standard" and are functionally Class 4 Town Highways

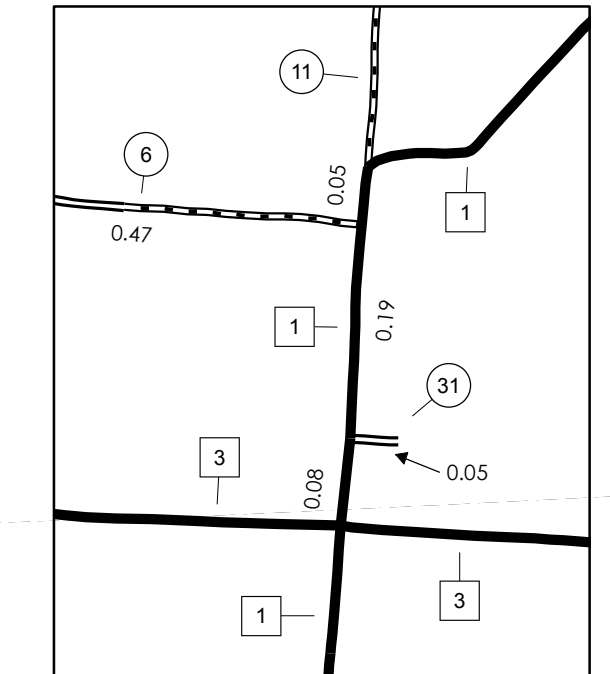
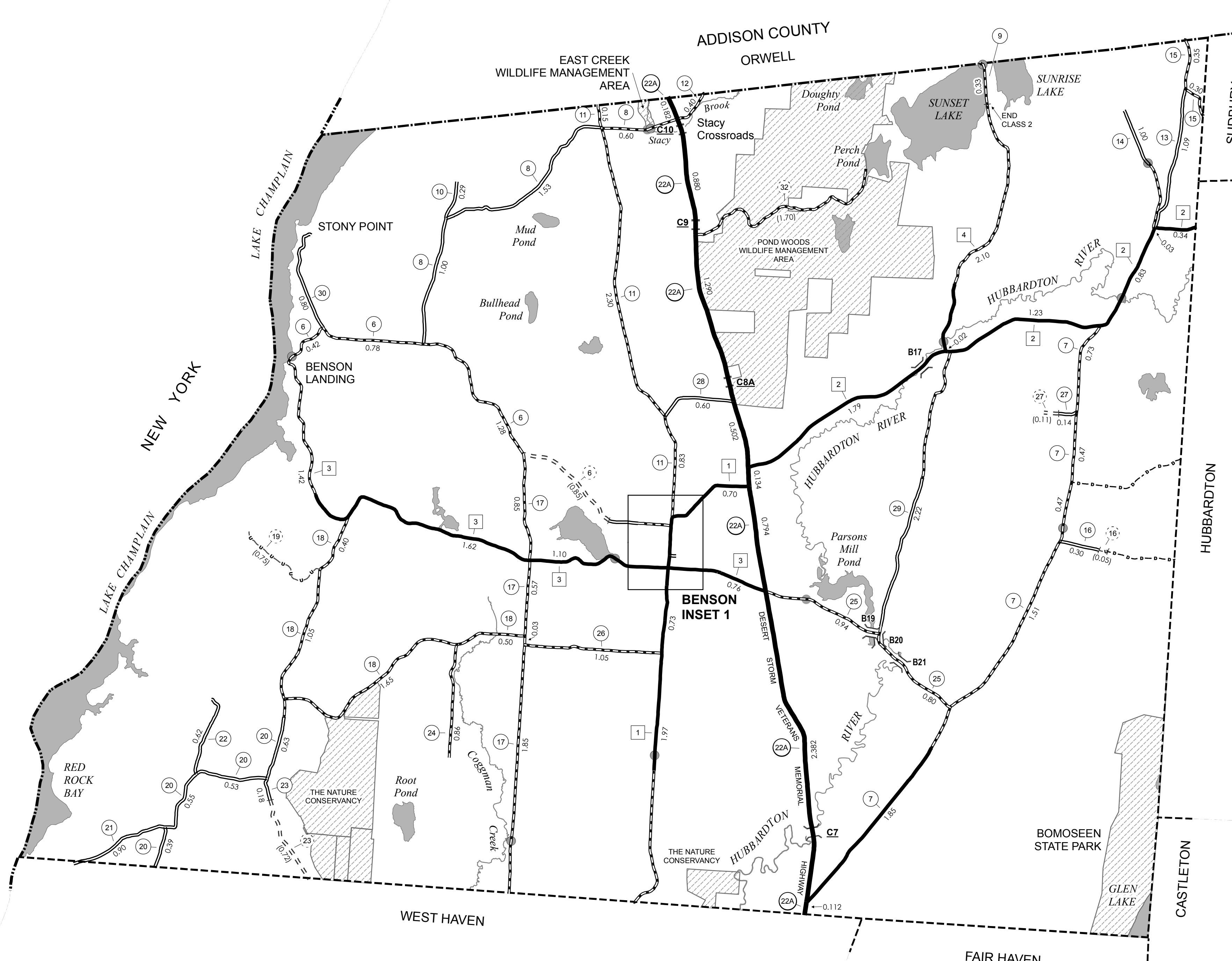

BENSON INSET 1 SCALE 1:12,672
0 0.15 0.3 Miles

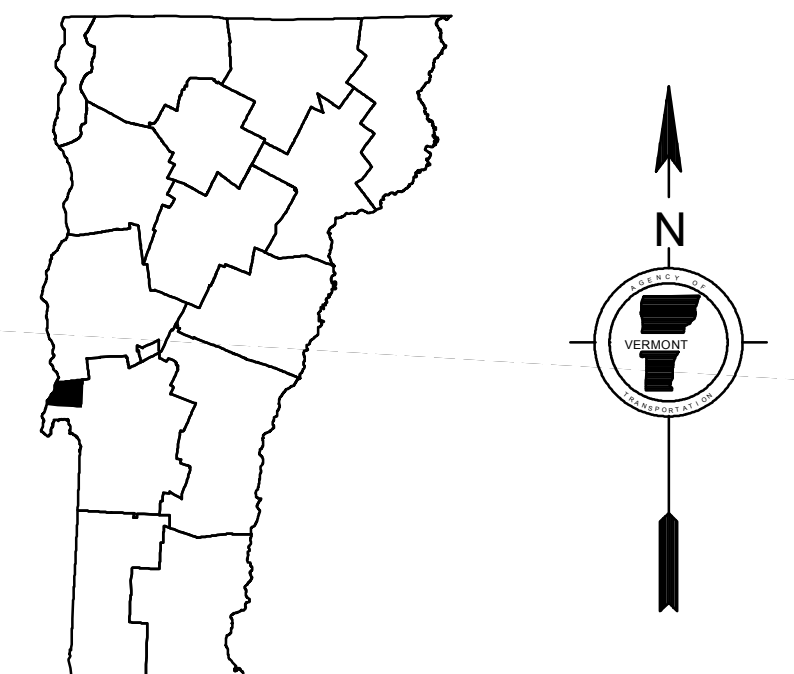

VERMONT GENERAL HIGHWAY MAP Town of Benson

RUTLAND COUNTY
Transportation District #3

Prepared by the
Vermont Agency of Transportation
Division of Policy, Planning and Intermodal Development
in cooperation with
U.S. Department of Transportation
Federal Highway Administration

Mileage as of February 10, 2017
Map prepared June 29, 2017

SCALE 1:31,680

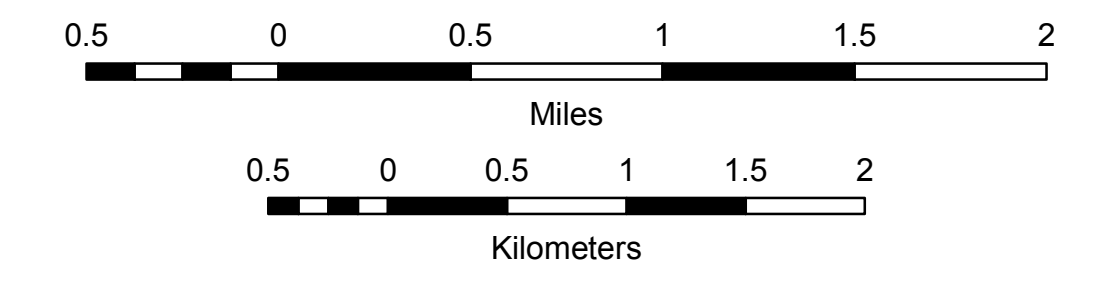

- HIGHWAYS**
 - INTERSTATE OR DIVIDED HIGHWAY
 - STATE - HARD SURFACE OR PAVED
 - TOWN - HARD SURFACE OR PAVED
 - GRAVEL
 - SOIL OR GRADED AND DRAINED EARTH
 - UNIMPROVED OR PRIMITIVE
 - IMPASSABLE OR UNTRAVELED
 - LEGAL TRAIL
 - DISCONTINUED
 - HIGHWAY CLASS CHANGE
 - RAILROAD
 - INACTIVE RAILROAD
 - PUBLIC LAND - NATIONAL FOREST
 - PUBLIC LAND - STATE/MUNICIPAL
 - NATIONAL FOREST ROAD
 - STATE FOREST HIGHWAY
- POLITICAL SUBDIVISIONS**
 - STATE BOUNDARY
 - COUNTY BOUNDARY
 - TOWN BOUNDARY
 - VILLAGE BOUNDARY
 - URBAN COMPACT BOUNDARY
 - WATER BODY
 - STREAM OR BROOK
- BRIDGE OR CULVERT**
 - BRIDGE OR CULVERT > 20'
 - BRIDGE OR CULVERT 6' - 20'
 - BIKE PATH STRUCTURE
 - VOBCIT BRIDGE
 - VOBCIT CULVERT > 6'
 - STATE BRIDGE OR CULVERT IDENTIFIER
 - TOWN BRIDGE OR CULVERT IDENTIFIER
- FEDERAL CLASSIFICATION IDENTIFIER**
 - MA MINOR ARTERIAL
 - MJC MAJOR COLLECTOR
 - MNC MINOR COLLECTOR
 - PA PRINCIPAL ARTERIAL

DISCLAIMER:
The untraveled highways (laid-out town highways), discontinued highways, and legal trails hereon are those of which the Agency of Transportation has record; others may exist.

Highway and bridge data by the Agency of Transportation. Town short structures drawn from the Vermont Online Bridge & Culvert Inventory Tool (VOBCIT) database. All other data from the Vermont Center for Geographic Information. Only named streams shown.

Vermont State Plane Coordinate System
North American Datum of 1983
SPCS_Zone_Identifier: 4400
Geodetic Reference System 80
4,000-meter grid, Easting - Northing