

TOWN HWY. No.	LENGTH IN MILES CLASS 3	CLASS 4
7	2.56	
8	0.50	
9	1.15	
10	2.49	
11		(0.50)
12	1.30	
13	1.17	(0.58)
14	0.85	
15	0.50	
16	0.10	
17	2.32	
18	0.30	
19	0.80	(0.60)
20	0.56	
21	1.55	
23		(0.65)
24	0.80	
25	1.25	
26	0.25	(0.66)
27	0.15	
28	1.80	
29	0.25	
30	0.45	
31	0.37	(0.33)
32	0.37	
33	1.10	
34	0.12	
35	0.55	
36	0.70	
37	0.10	
38		(0.65)
39	3.10	
40	0.03	
41	3.51	
42	1.47	
43	1.30	
44	2.30	
45		(0.50)
46	0.50	
47	0.60	
48	0.09	
49	0.40	
50	0.10	
51	2.30	
52	0.45	
53	0.11	
54	0.05	
55	0.04	
57	0.08	
59	1.23	
60	0.07	
62	0.21	
63	0.15	
64		(1.65)
TOTAL	42.50	6.12

CLASS 2	LENGTH IN MILES	TOTAL CLASS 2
TH-1	5.460	
TH-2	2.180	
TH-3	3.320	
TH-4	3.800	
TH-5	0.670	
TH-6	2.810	
TOTAL CLASS 2		18.240
TOTAL CLASS 3		42.50
TOTAL TOWN		60.740
STATE HIGHWAY VT-14	7.962	
TOTAL STATE HIGHWAY		7.962
TOTAL STATE		7.962

MILEAGE SUMMARY

CLASS	LENGTH IN MILES	TOTAL
CLASS 2	18.240	
CLASS 3	42.500	
STATE HIGHWAY	7.962	
TOTAL TRAVELED HIGHWAYS, FEB. 10, 2014:	68.702	

(Excludes Class 4, Legal Trail, and Unidentified Corridor Mileage)

TOWN HWY. No.	LENGTH IN MILES "NOT UP TO STANDARD"
24	(0.10)
56	(0.03)
57	(0.11)
TOTAL	0.24

*The sections of the town highways listed above are legally Class 3, but have been deemed "Not Up To Standard" and are functionally Class 4 Town Highways

LEGAL TRAIL No.	LENGTH IN MILES LEGAL TRAIL
2	(2.59)
1	(0.08)
TOTAL	2.67

BRIDGE OR CULVERT	IDENTIFIER
BRIDGE OR CULVERT > 20'	B34 / C34
BRIDGE OR CULVERT 6' - 20'	B34 / C34
VOBCIT BRIDGE	B34 / C34
VOBCIT CULVERT > 6'	B34 / C34
STATE BRIDGE OR CULVERT IDENTIFIER	B34 / C34
TOWN BRIDGE OR CULVERT IDENTIFIER	B34 / C34

For more information contact: Vermont Agency of Transportation, Division of Policy, Planning & Intermodal Development - Mapping Section, 1 National Life Drive, Montpelier, VT 05633-5001 Telephone: 802-828-2600.

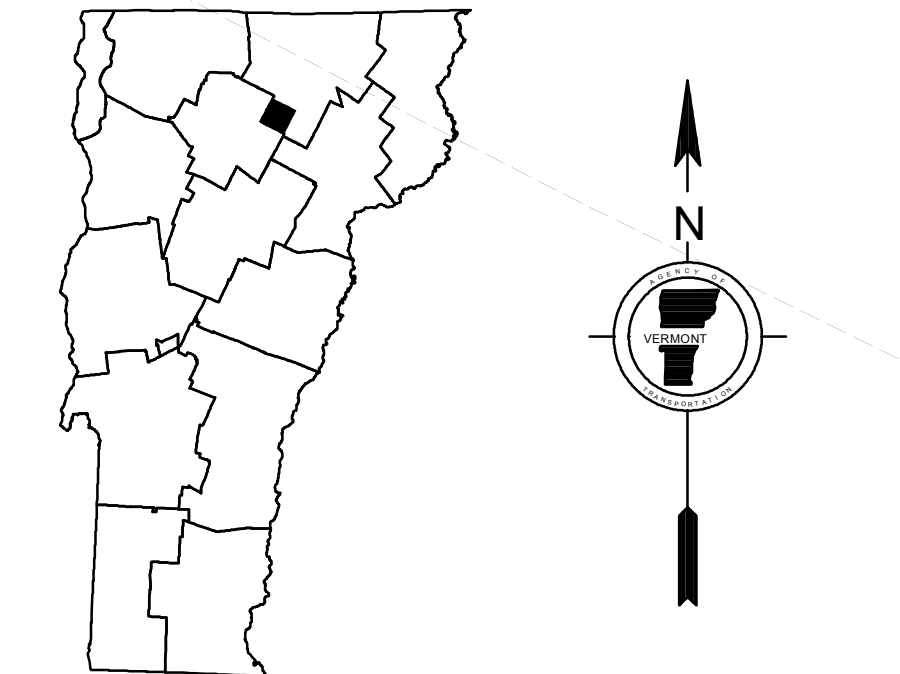
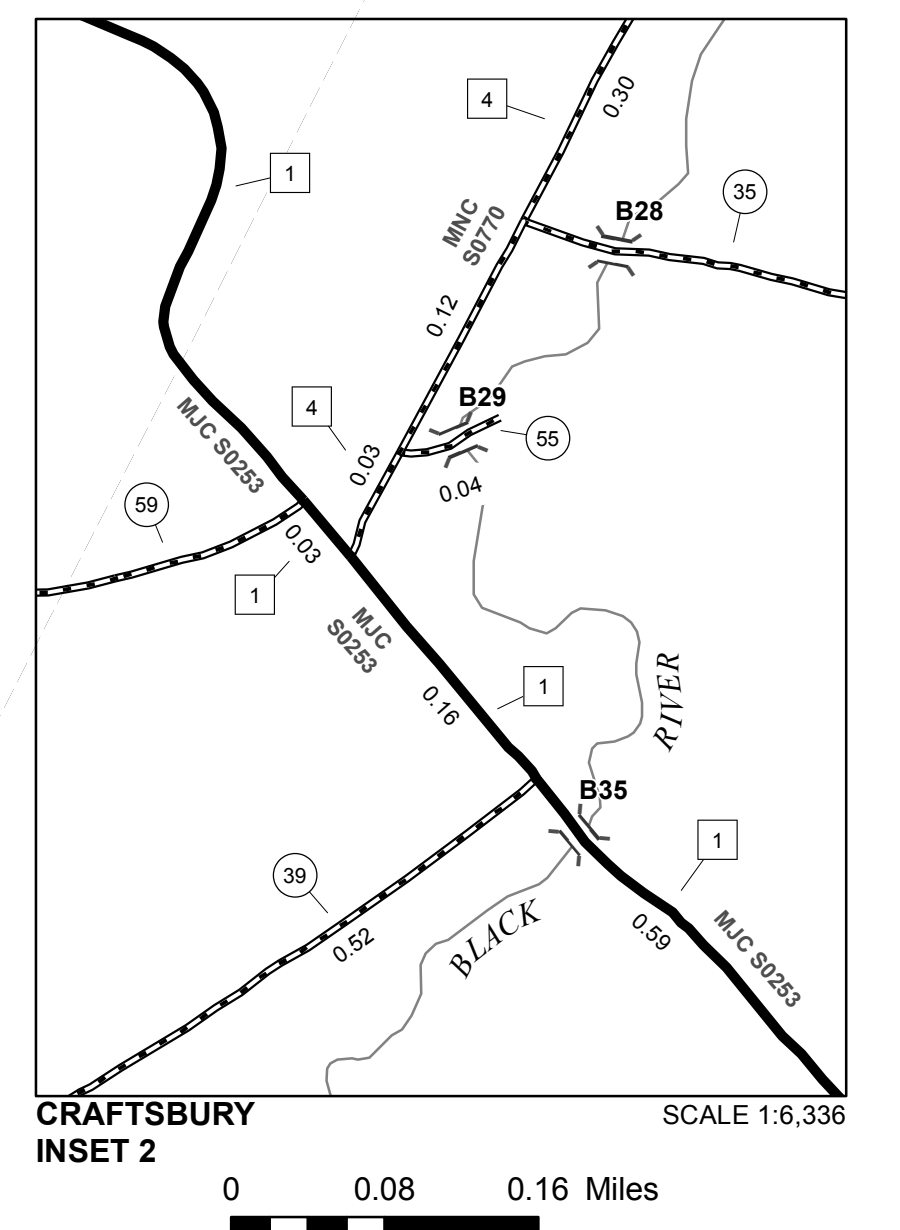
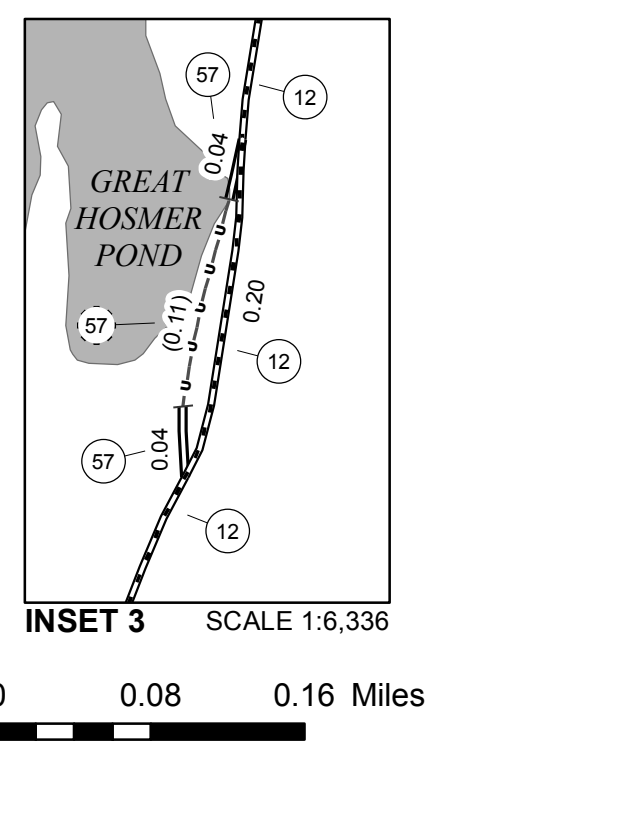
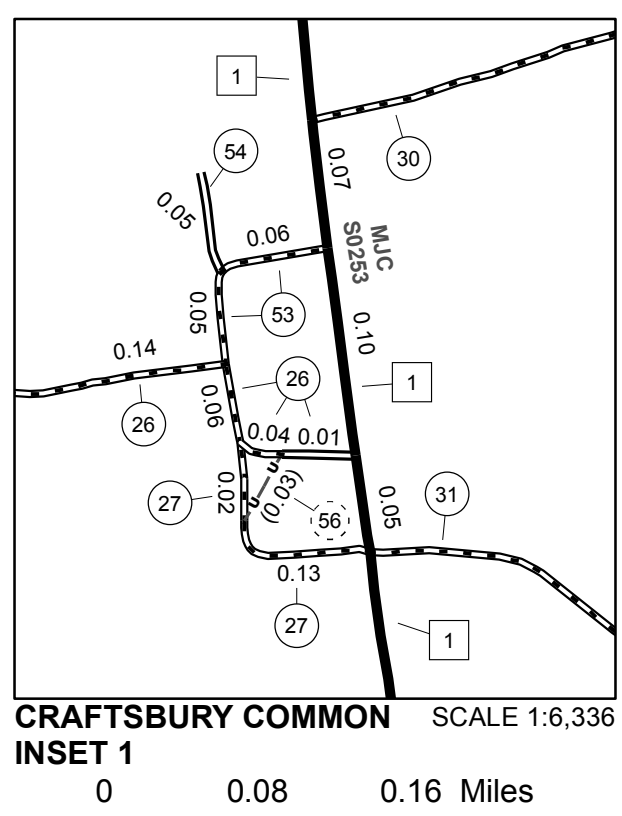

VERMONT GENERAL HIGHWAY MAP

Town of Craftsbury

ORLEANS COUNTY
Transportation District #9

Prepared by the
Vermont Agency of Transportation
Division of Policy, Planning and Intermodal Development
in cooperation with
U.S. Department of Transportation
Federal Highway Administration

Mileage as of February 10, 2014
Map prepared October 06, 2014

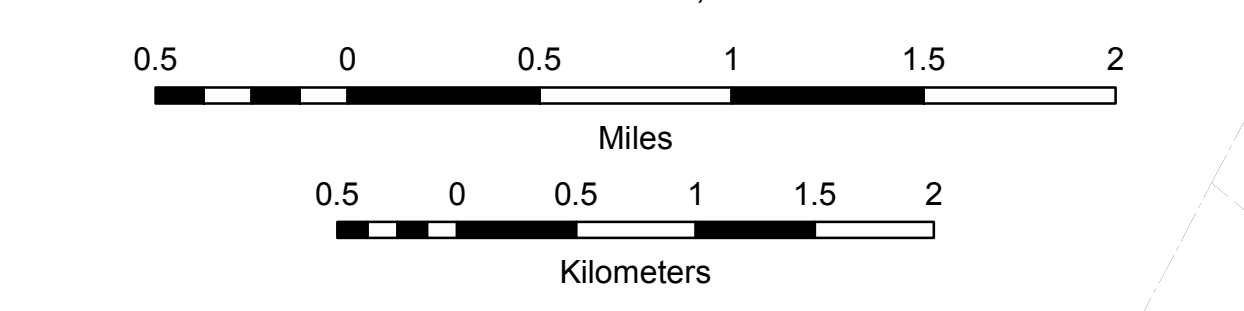

DISCLAIMER:
The untraveled highways (laid-out town highways), discontinued highways, and legal trails herein are those of which the Agency of Transportation has record; others may exist.
Highway and bridge data by the Agency of Transportation. Town short structures are drawn from the Vermont Online Bridge & Culvert Inventory Tool (VOBCIT) database. All other data from the Vermont Center for Geographic Information. Only named streams are shown.

Vermont State Plane Coordinate System
North American Datum of 1983
SPCS_Zone_Identifier: 4400
Geodetic Reference System 80
4,000-meter grid, Easting - Northing