

TOWN HWY. NO.	CLASS 3	CLASS 4	LENGTH IN MILES
5	2.20		
6	0.15		
7	0.56		
8	0.40	(0.27)	(0.23)
9	0.35		
10	0.15		
11			(0.12)
12	0.05		
13	0.06		
14	2.13		
15	0.45		
16	0.10		
17			(0.55)
18	0.55		
19	1.76		
20	2.42		
21	0.05		
21*			(0.07)
22	0.20		
23			(0.60)
24			(0.05)
25	0.10		
26	0.30		
27	1.15		
28	0.06		
29			(1.10)
30	0.10		
31	0.35		
32	0.85		
33	0.10		
34	0.55		(0.60)
35	0.05		(0.30)
36	0.97		
37			(0.30)
38			(0.20)
39	0.07		
40	0.10		
41	0.10		
42			(0.10)
43			(0.60)
44	1.21		(1.29)
45	0.95		
46	1.06		
47	0.50		
48	1.20		
49			(0.25)
50	0.60		
51			(0.25)
52	0.75		
53	0.25		
54	0.38		
55	0.10		
56			(0.23)
57	0.52		
58	1.20		
59	0.40		
60	0.12		
61	0.20		
TOTAL	25.88	7.11	

* This portion of town highway is Class 3, but is functionally Class 4

MILEAGE SUMMARY

CLASS 2		
TH-1	6.280	
TH-2	1.360	
TH-3	0.850	
TH-4	1.950	
TOTAL CLASS 2	10.440	
CLASS 3		
TOTAL CLASS 3	25.880	
TOTAL TOWN	36.320	
STATE HIGHWAY		
VT-14	4.252	
VT-105	1.117	
COVENTRY STATE HIGHWAY	2.543	
TOTAL STATE HIGHWAY	7.912	
STATE HIGHWAY - Ramp		
VT-14	0.088	
TOTAL STATE HIGHWAY - Ramp	0.088	
US HIGHWAY		
US-5	4.892	
TOTAL US HIGHWAY	4.892	
TOTAL STATE	12.892	
INTERSTATE		
I-91	3.684	
TOTAL INTERSTATE	3.684	

TOTAL, TRAVELED HIGHWAYS, FEB. 10, 2010: 52.896
(Excludes Class 4 and Legal Trail Mileage)

- HIGHWAYS**
- INTERSTATE
 - U.S. ROUTE
 - STATE ROUTE
 - CLASS 1
 - CLASS 2
 - CLASS 3
 - CLASS 4
 - LEGAL TRAIL
 - INTERSTATE OR DIVIDED HIGHWAY
 - STATE - HARD SURFACE OR PAVED
 - TOWN - HARD SURFACE OR PAVED
 - GRAVEL
 - SOIL OR GRADED AND DRAINED EARTH
 - UNIMPROVED OR PRIMITIVE
 - IMPASSABLE OR UNTRAVELED
 - LEGAL TRAIL
 - DISCONTINUED
 - HIGHWAY CLASS CHANGE
 - RAILROAD
 - INACTIVE RAILROAD

- POLITICAL SUBDIVISIONS**
- STATE BOUNDARY
 - COUNTY BOUNDARY
 - TOWN BOUNDARY
 - VILLAGE BOUNDARY
 - URBAN COMPACT BOUNDARY
 - WATER BODIES
 - STREAM OR BROOK
 - BRIDGE OR CULVERT
 - BRIDGE OR CULVERT GREATER THAN 20'
 - BRIDGE OR CULVERT 6' - 20'
 - TOWN SHORT STRUCTURE
 - B34 / C34 STATE BRIDGE OR CULVERT IDENTIFIER
 - B34 / C34 TOWN BRIDGE OR CULVERT IDENTIFIER
- FEDERAL CLASSIFICATION IDENTIFIER**
- FAU URBAN ARTERIAL OR COLLECTOR
 - MA MINOR ARTERIAL
 - MJC MAJOR COLLECTOR
 - MNC MINOR COLLECTOR
 - PA PRINCIPAL ARTERIAL

STRUCTURES - SURFACE WATER NOTE:

STRUCTURES:
Town short structures (bridges or culverts from 4-feet to less than 20-feet) are drawn from the Vermont Online Bridge & Culvert Inventory Tool (VOBCIT) database.
NOTE: Town shorts are not consistently tagged within VOBCIT.

The surface waters are from the Vermont Hydrological Dataset (VHD). Only the named streams are shown.

DISCLAIMER:

The untraveled highways (laid-out town highways), discontinued highways, and legal trails shown hereon are those of which the Agency of Transportation has record; others may exist.

Highway and bridge data by the Agency of Transportation. All other data from the Vermont Center for Geographic Information.

Vermont State Plane Coordinate System
North American Datum of 1983
SPCS Zone Identifier: 4400
Geodetic Reference System 80
4,000-meter grid, Easting - Northing

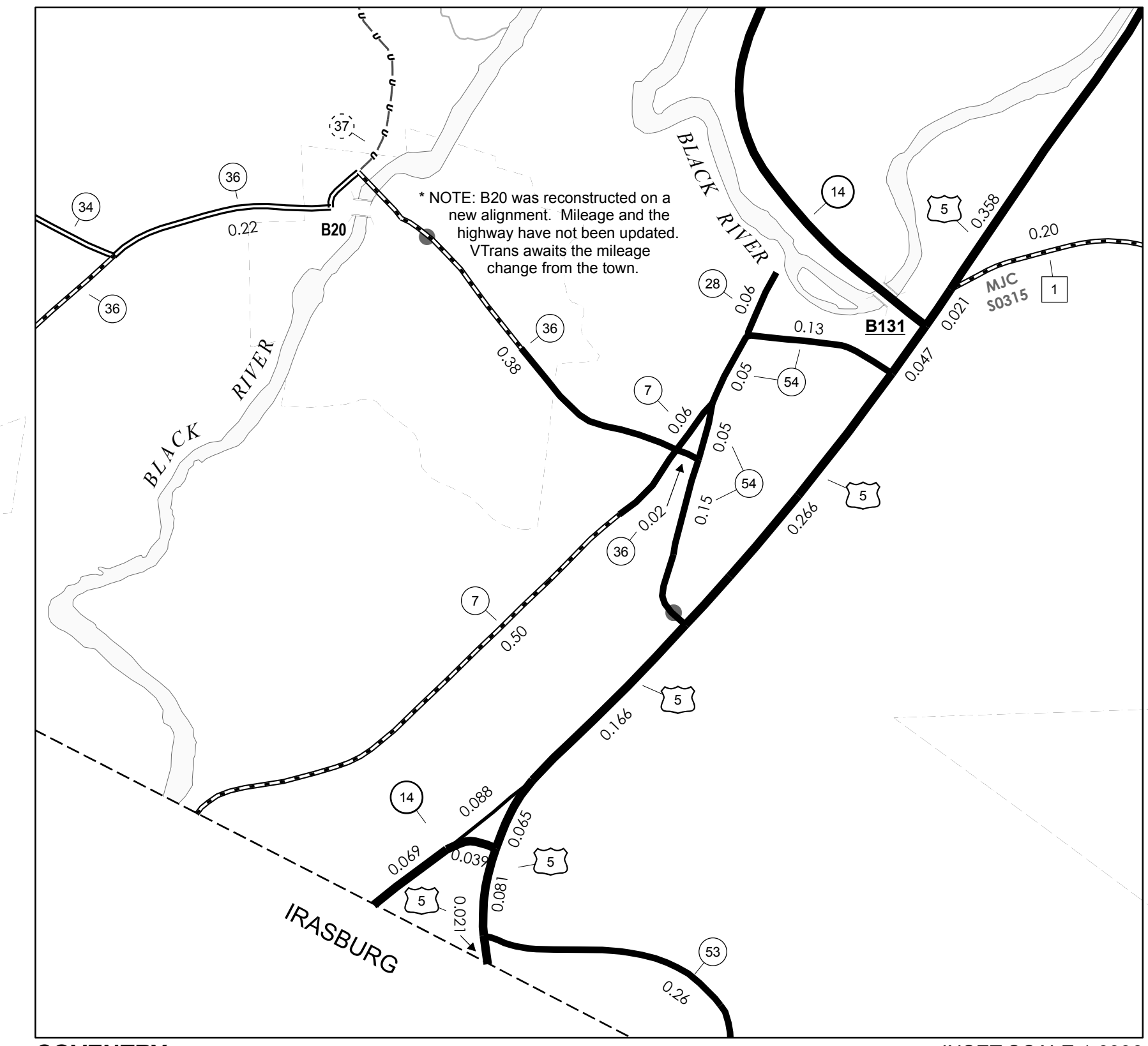
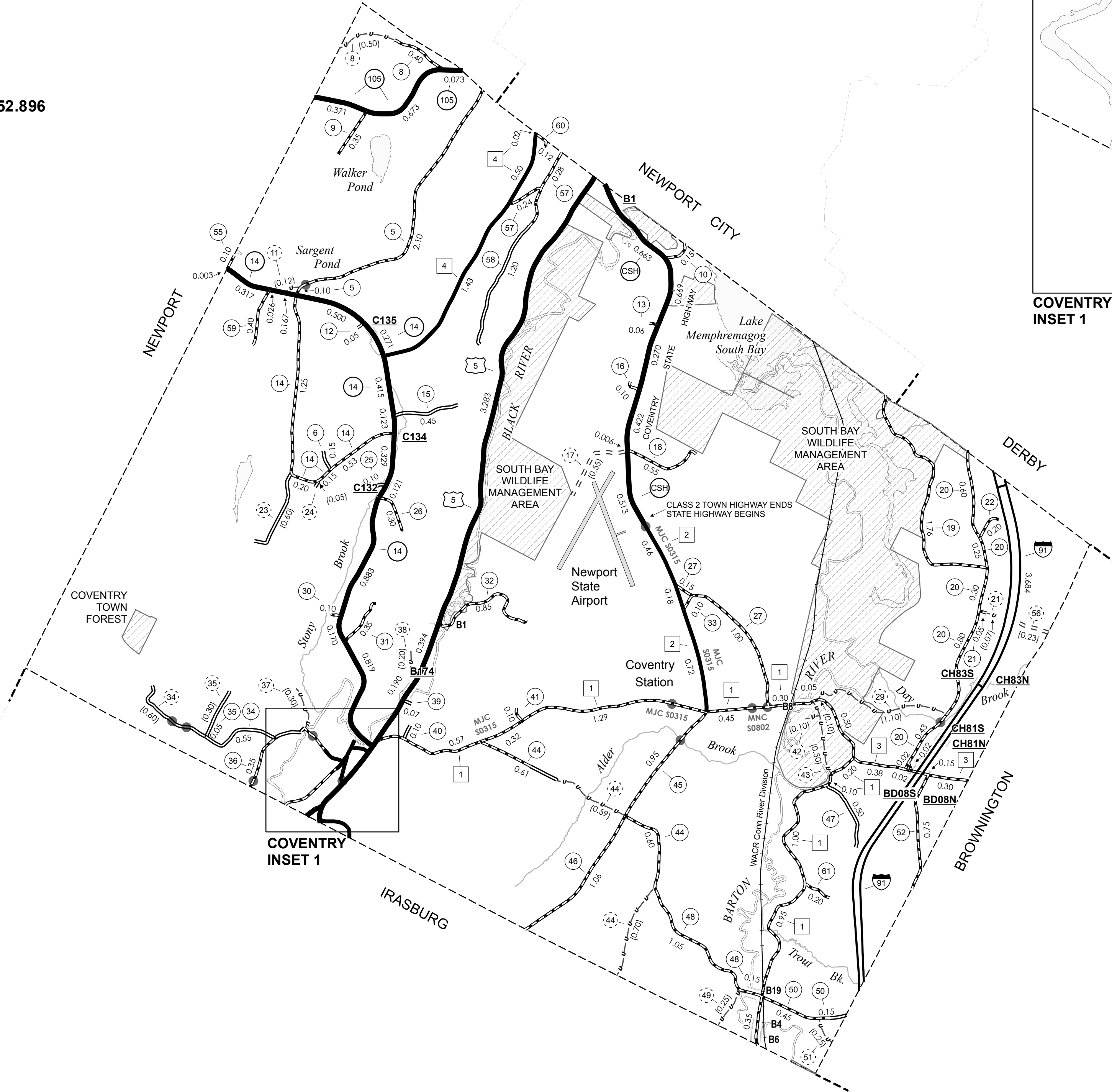

COVENTRY INSET 1 INSET SCALE 1:6336

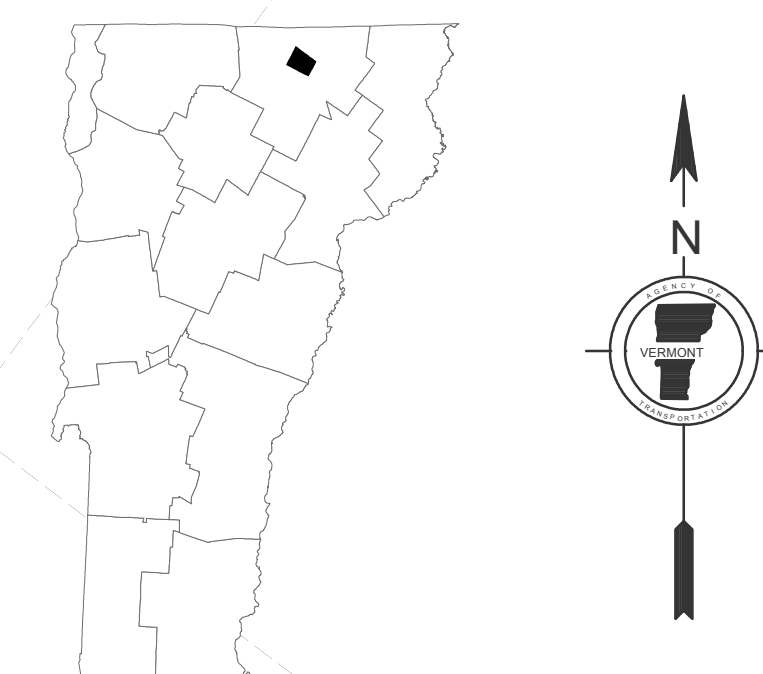
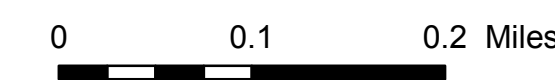

VERMONT GENERAL HIGHWAY MAP
Town of Coventry

ORLEANS COUNTY

Transportation District #9

Prepared by the
Vermont Agency of Transportation
Division of Planning, Outreach
and Community Affairs
in cooperation with
U.S. Department of Transportation
Federal Highway Administration

Mileage as of February 10, 2010
Map prepared June 24, 2010

SCALE 1:31,680

