

TOWN HWY. No.	LENGTH IN MILES CLASS 3	CLASS 4
6	4.50	
7		(0.15)
8	1.92	(0.25)
9		(0.30)
10	0.71	(0.44)
11	0.39	
12	3.25	
13	0.25	
14	0.51	
15	3.65	
16	0.84	
17	1.03	
18	1.69	(1.26)
19	0.13	
20	0.30	
21	0.25	
22		(0.10)
23	0.20	
24	0.14	(0.40)
25	1.11	
26	0.10	(0.35)
27	0.34	(0.84)
28	0.55	
30	3.27	
31	0.02	(0.52)
32		(0.25)
33	0.15	
34	0.45	
35		(0.50)
36		(1.00)
37	0.15	
38	0.24	
39	0.06	
40	0.05	
41	0.03	
42	0.31	
43	0.07	
44	0.07	
45	0.13	
46	0.22	
47	0.06	
48	1.75	
TOTAL	28.89	6.36

TOWN HWY. No.	LENGTH IN MILES "NOT UP TO STANDARD"
8	(0.05)
11	(0.10)
17	(0.29)
26	(0.15)
28	(0.11)
29	(0.05)
31	(0.36)
47	(0.02)
TOTAL	1.13

*The sections of the town highways listed above are legally Class 3, but have been deemed "Not Up To Standard" and are functionally Class 4 Town Highways

MILEAGE SUMMARY	
CLASS 2	
TH-1	1.400
TH-2	5.200
TH-3	2.700
TH-4	1.680
TOTAL CLASS 2	10.980
CLASS 3	
TOTAL CLASS 3	28.89
TOTAL TOWN	39.870
STATE HIGHWAY	
VT-5A	3.712
VT-58	3.362
TOTAL STATE HIGHWAY	7.074
TOTAL STATE	7.074
INTERSTATE	
I-91	0.759
TOTAL INTERSTATE	0.759
TOTAL INTERSTATE	0.759
TOTAL, TRAVELED HIGHWAYS, FEB. 10, 2018:	47.703
(Excludes Class 4 and Legal Trail Mileage)	

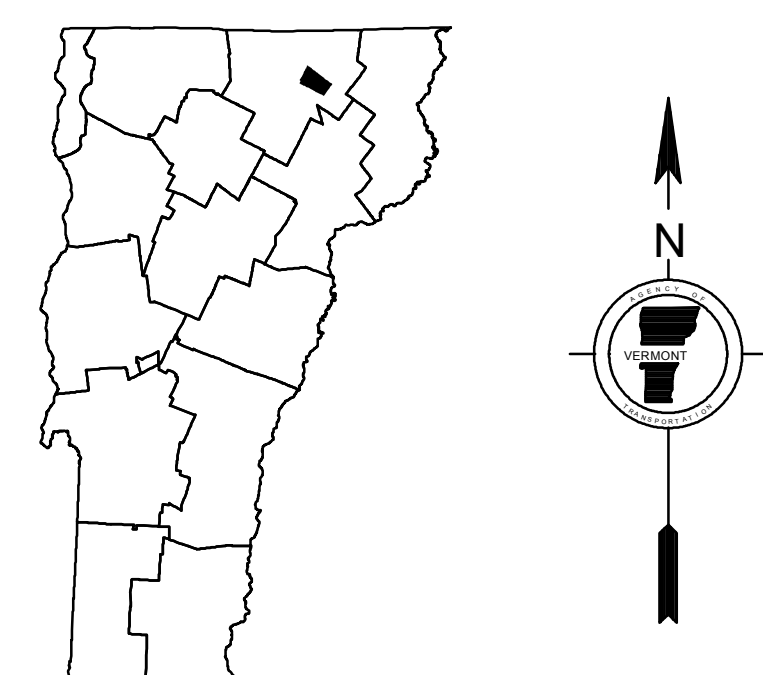
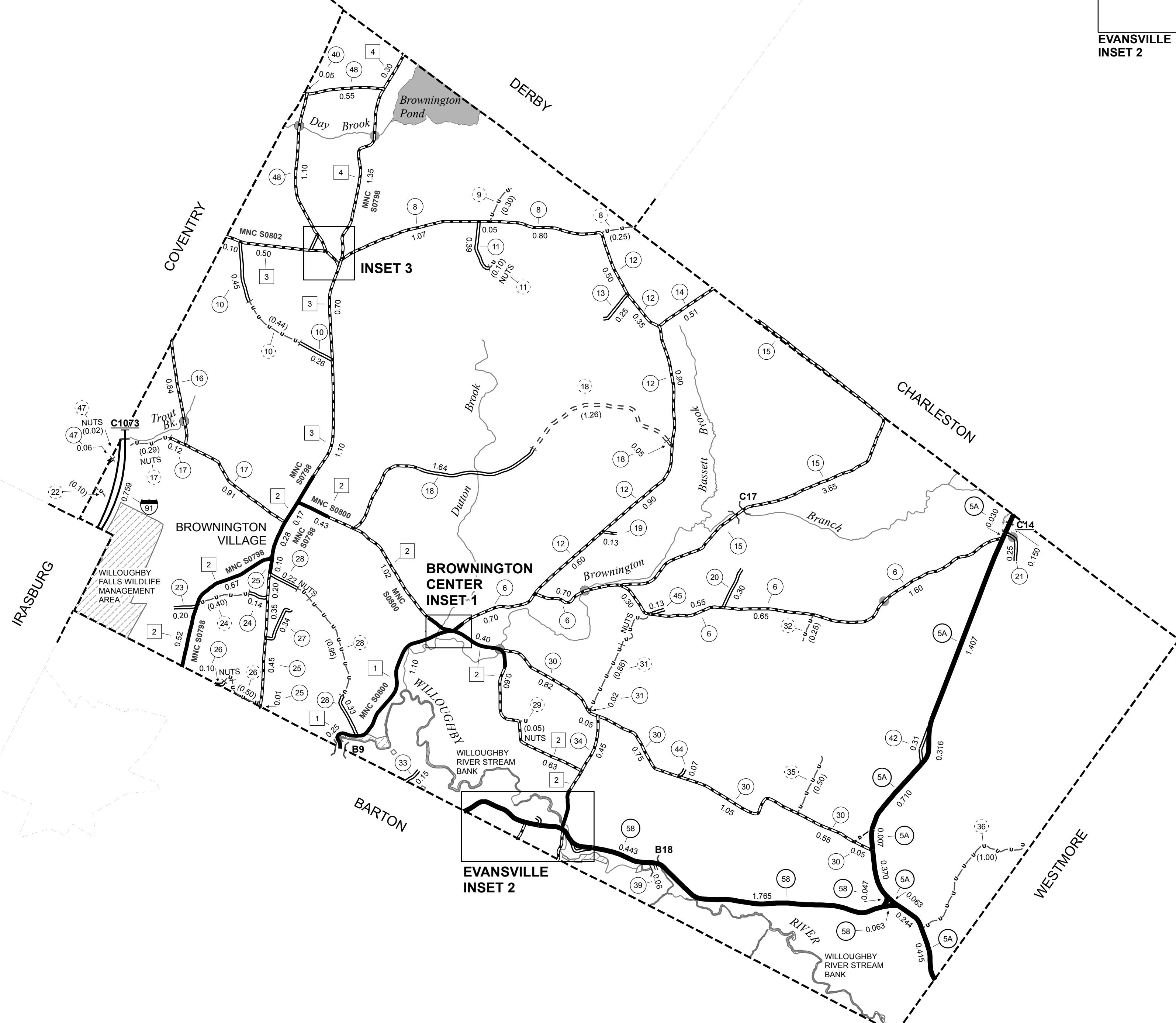
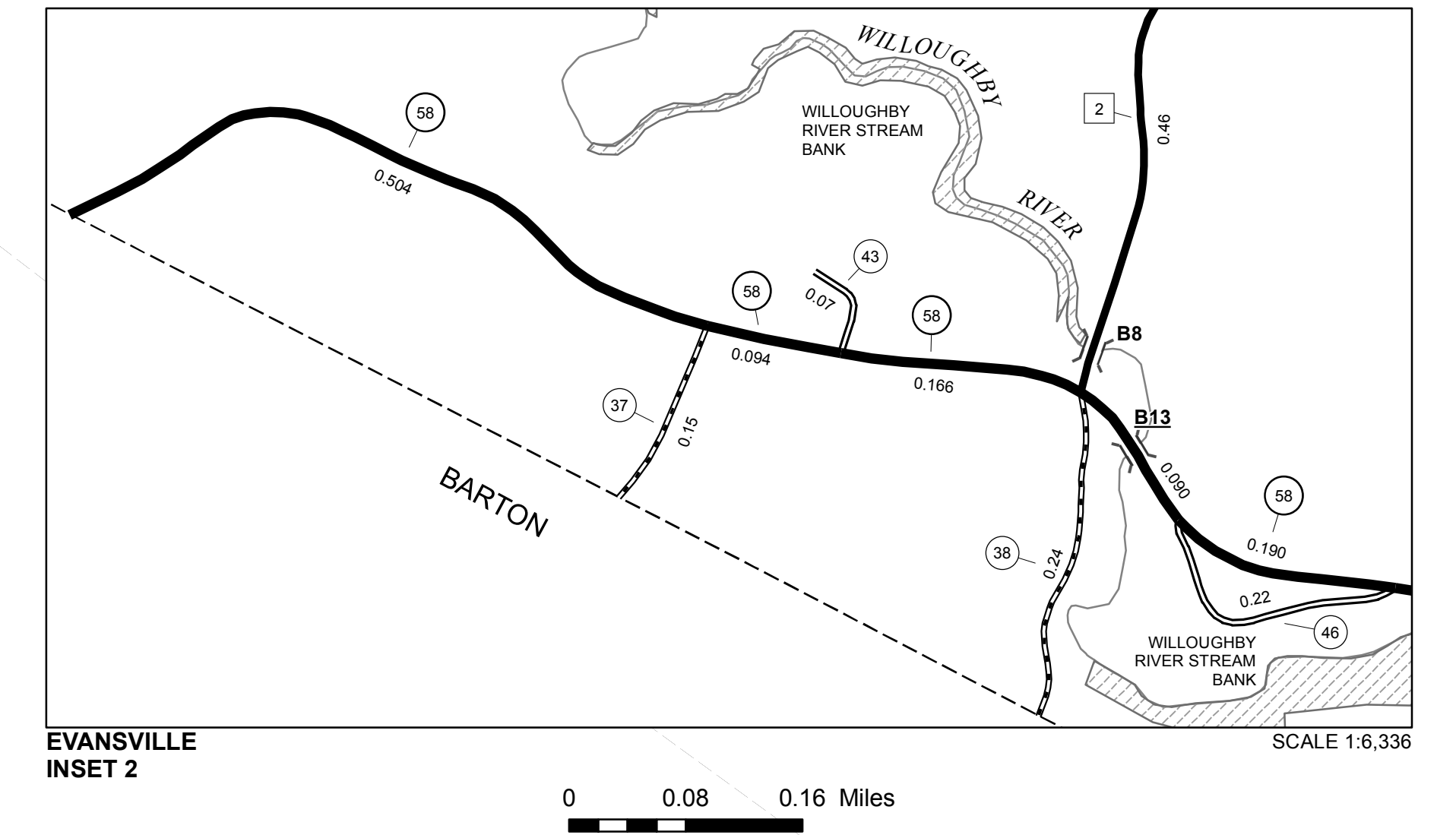
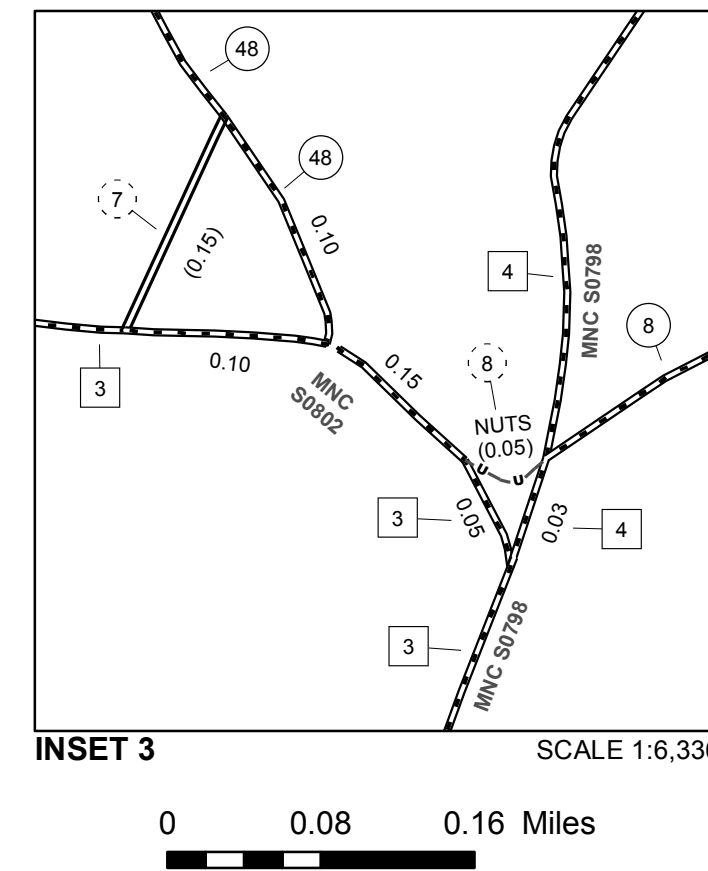
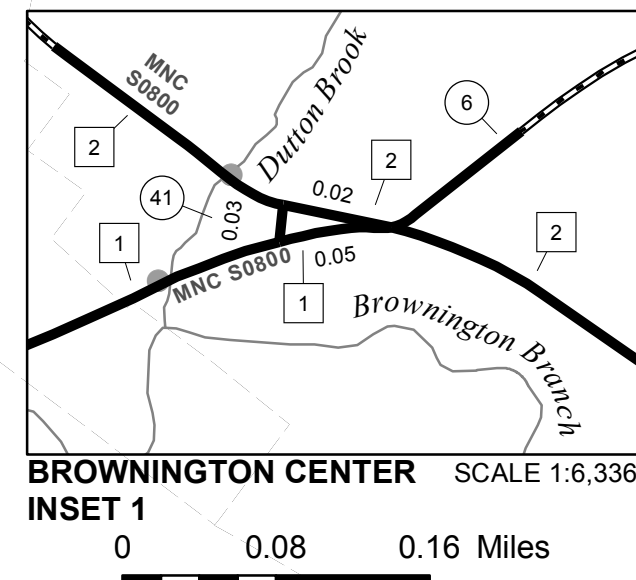

VERMONT GENERAL HIGHWAY MAP

Town of Brownington

ORLEANS COUNTY
Transportation District #9

Prepared by the
Vermont Agency of Transportation
Division of Policy, Planning and Intermodal Development
in cooperation with
U.S. Department of Transportation
Federal Highway Administration

Mileage as of February 10, 2018
Map prepared July 25, 2018

SCALE 1:31,680

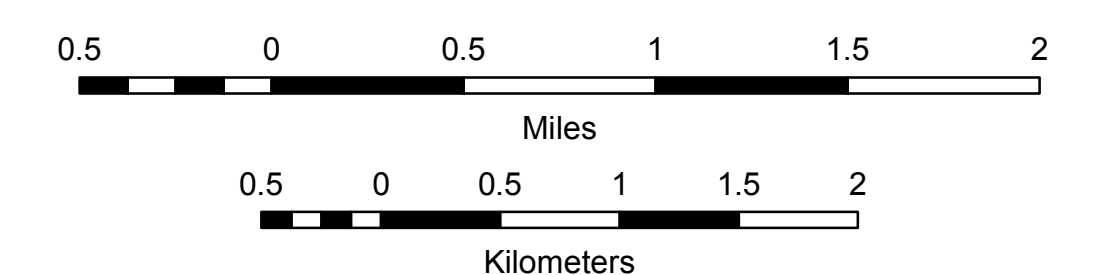

- HIGHWAYS**
 - INTERSTATE
 - U.S. ROUTE
 - STATE ROUTE
 - CLASS 1
 - CLASS 2
 - CLASS 3
 - CLASS 4
 - LEGAL TRAIL
 - PARK AND RIDE
- INTERSTATE OR DIVIDED HIGHWAY
- STATE - HARD SURFACE OR PAVED
- TOWN - HARD SURFACE OR PAVED
- GRAVEL
- SOIL OR GRADED AND DRAINED EARTH
- UNIMPROVED OR PRIMITIVE
- IMPASSABLE OR UNTRAVELED
- LEGAL TRAIL
- DISCONTINUED
- HIGHWAY CLASS CHANGE
- RAILROAD
- INACTIVE RAILROAD
- PUBLIC LAND - NATIONAL FOREST
- PUBLIC LAND - STATE/MUNICIPAL
- NFR NATIONAL FOREST ROAD
- SFH STATE FOREST HIGHWAY

- POLITICAL SUBDIVISIONS**
 - STATE BOUNDARY
 - COUNTY BOUNDARY
 - TOWN BOUNDARY
 - VILLAGE BOUNDARY
 - URBAN COMPACT BOUNDARY
 - WATER BODY
 - STREAM OR BROOK
- BRIDGE OR CULVERT**
 - BRIDGE OR CULVERT > 20'
 - BRIDGE OR CULVERT 6' - 20'
 - BIKE PATH STRUCTURE
 - VT CULVERTS BRIDGE
 - VT CULVERTS CULVERT > 6'
- FEDERAL CLASSIFICATION IDENTIFIER**
 - MA MINOR ARTERIAL
 - MJC MAJOR COLLECTOR
 - MNC MINOR COLLECTOR
 - PA PRINCIPAL ARTERIAL
- B34 / C34 STATE BRIDGE OR CULVERT IDENTIFIER**
- B34 / C34 TOWN BRIDGE OR CULVERT IDENTIFIER**

DISCLAIMER:
The untraveled highways (laid-out town highways), discontinued highways, and legal trails hereon are those of which the Agency of Transportation has record; others may exist.

Highway and bridge data by the Agency of Transportation, Town short structures drawn from the VTCULVERTS (formerly VOBCIT) online database. All other data from the Vermont Center for Geographic Information. Only named streams shown.