

TOWN HWY. No.	LENGTH IN MILES		TOWN ROAD NAME
	CLASS 3	CLASS 4	
27	0.45		NEW ST
30	0.25		OLD ST
31		(0.055)	LOCKE DR
<b>TOTAL</b>	<b>0.70</b>	<b>0.055</b>	

LEGAL TRAIL No.	LENGTH IN MILES	
	LEGAL TRAIL	
5	(0.005)	
<b>TOTAL</b>	<b>0.005</b>	

MILEAGE SUMMARY		
CLASS 2 TH-3	0.470	
	TOTAL CLASS 2	0.470
CLASS 3		
	TOTAL CLASS 3	0.70
	<b>TOTAL TOWN</b>	<b>1.170</b>
STATE HIGHWAY VT-14	1.600	
	TOTAL STATE HIGHWAY	1.600
	<b>TOTAL STATE</b>	<b>1.6</b>
<b>TOTAL, TRAVELED HIGHWAYS, FEB. 10, 2026:</b>		<b>2.770</b>
<small>(Excludes Class 4 and Legal Trail Mileage)</small>		

- HIGHWAYS**
- INTERSTATE
  - U.S. ROUTE
  - STATE ROUTE
  - CLASS 1
  - CLASS 2
  - CLASS 3
  - CLASS 4
  - LEGAL TRAIL
  - GRAVEL
  - SOIL OR GRADED AND DRAINED EARTH
  - UNIMPROVED OR PRIMITIVE
  - IMPASSABLE OR UNTRAVELED
  - LEGAL TRAIL
  - DISCONTINUED
  - HIGHWAY CLASS CHANGE
  - RAILROAD
  - INACTIVE RAILROAD
  - PUBLIC LAND - NATIONAL FOREST
  - PUBLIC LAND - STATE/MUNICIPAL
- POLITICAL SUBDIVISIONS**
- STATE BOUNDARY
  - COUNTY BOUNDARY
  - TOWN BOUNDARY
  - VILLAGE BOUNDARY
  - URBAN COMPACT BOUNDARY
  - WATER BODY
  - STREAM OR BROOK
- BRIDGE OR CULVERT**
- BRIDGE OR CULVERT > 20'
  - BRIDGE OR CULVERT 6' - 20'
  - BIKE PATH STRUCTURE
  - VT CULVERTS BRIDGE
  - VT CULVERTS CULVERT > 6'
- B34 / C34** STATE BRIDGE OR CULVERT IDENTIFIER
- B34 / C34** TOWN BRIDGE OR CULVERT IDENTIFIER
- NFR** NATIONAL FOREST ROAD
- ACE** ARMY CORPS OF ENGINEERS
- USGH** UNITED STATES GOV. HWY.
- P** PARK AND RIDE
- FEDERAL CLASSIFICATION IDENTIFIER**
- MA MINOR ARTERIAL
  - MJC MAJOR COLLECTOR
  - MNC MINOR COLLECTOR
  - PA PRINCIPAL ARTERIAL

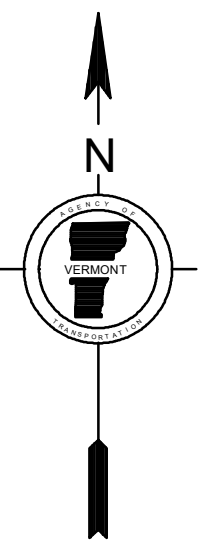
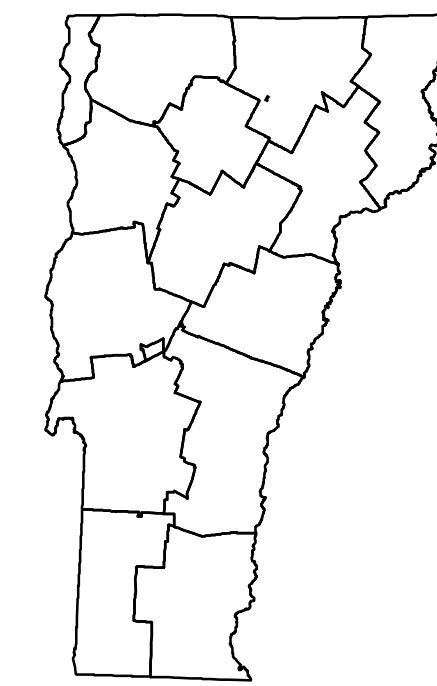
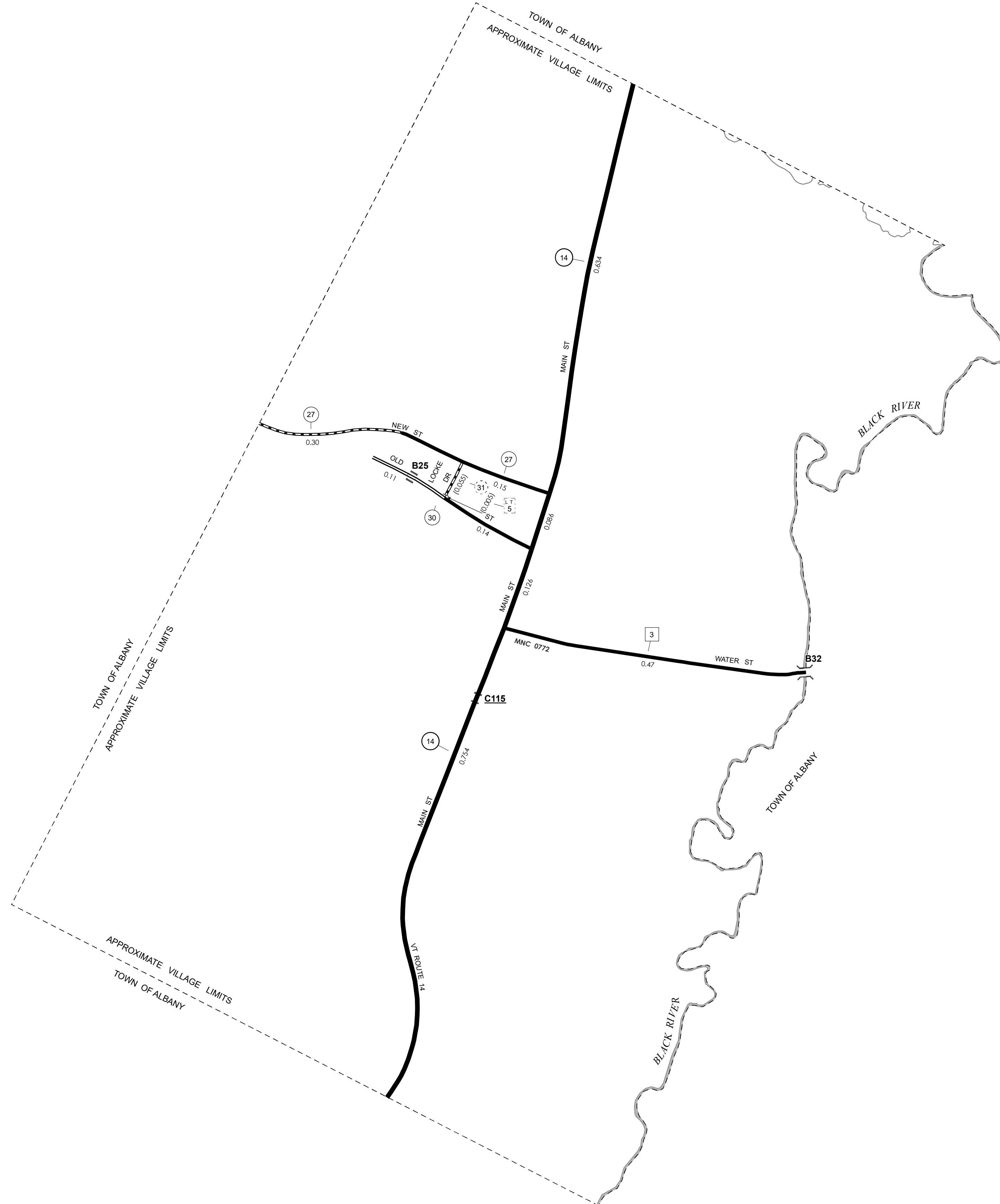

**VERMONT**  
**GENERAL HIGHWAY MAP**  
**Village of Albany**

ORLEANS COUNTY

Transportation District #9

Prepared by the  
 Vermont Agency of Transportation  
 Highway Division  
 in cooperation with

U.S. Department of Transportation  
 Federal Highway Administration

Mileage as of February 10, 2026  
 Map prepared May 13, 2026

SCALE 1:6,336

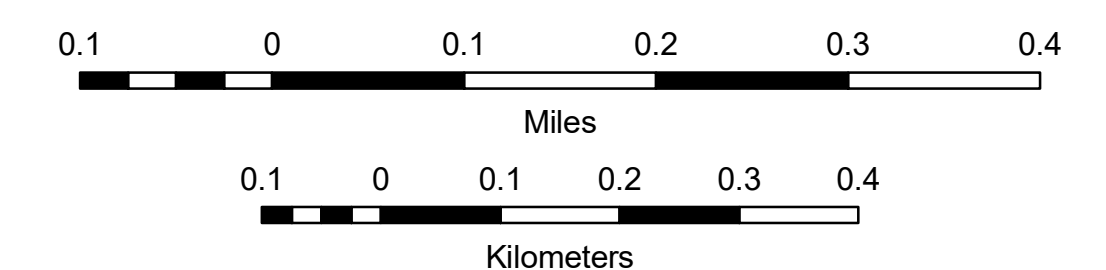

**DISCLAIMER:**  
 The untraveled highways (laid-out town highways), discontinued highways, and legal trails hereon are those of which the Agency of Transportation has record; others may exist.

Highway and bridge data by the Agency of Transportation. Town short structures drawn from the VTCULVERTS (formerly VOBCIT) online database. All other data from the Vermont Open Geodata Portal. Only named streams shown.

Accessibility Statement: The Agency of Transportation is committed to ensuring accessibility and digital accessibility for all. If you need language assistance, reasonable accommodation, or alternative format, please email johnathan.croft@vermont.gov.

Vermont State Plane Coordinate System  
 North American Datum of 1983  
 SPCS\_Zone\_Identifier: 4400  
 Geodetic Reference System: 80  
 2,000-meter grid, Easting - Northing