

TOWN HWY. No.	CLASS 3	CLASS 4	TOWN ROAD NAME
27	0.45		NEW ST
30	0.25		OLD ST
31		(0.055)	LOCKE DR
<b>TOTAL</b>	<b>0.70</b>	<b>0.055</b>	

LEGAL TRAIL No.	LENGTH IN MILES
5	(0.005)
<b>TOTAL</b>	<b>0.005</b>

MILEAGE SUMMARY			
CLASS 2 TH-3	0.470		0.470
CLASS 3		TOTAL CLASS 3	0.70
		<b>TOTAL TOWN</b>	<b>1.170</b>
STATE HIGHWAY VT-14	1.600	TOTAL STATE HIGHWAY	1.600
		<b>TOTAL STATE</b>	<b>1.6</b>
<b>TOTAL, TRAVELED HIGHWAYS, FEB. 10, 2023:</b>			<b>2.770</b>
<small>(Excludes Class 4 and Legal Trail Mileage)</small>			

- HIGHWAYS**
- INTERSTATE
  - U.S. ROUTE
  - STATE ROUTE
  - CLASS 1
  - CLASS 2
  - CLASS 3
  - CLASS 4
  - LEGAL TRAIL
  - GRAVEL
  - SOIL OR GRADED AND DRAINED EARTH
  - UNIMPROVED OR PRIMITIVE
  - IMPASSABLE OR UNTRAVELED
  - LEGAL TRAIL
  - DISCONTINUED
  - HIGHWAY CLASS CHANGE
  - RAILROAD
  - INACTIVE RAILROAD
  - PUBLIC LAND - NATIONAL FOREST
  - PUBLIC LAND - STATE/MUNICIPAL
- POLITICAL SUBDIVISIONS**
- STATE BOUNDARY
  - COUNTY BOUNDARY
  - TOWN BOUNDARY
  - VILLAGE BOUNDARY
  - URBAN COMPACT BOUNDARY
  - WATER BODY
  - STREAM OR BROOK
- BRIDGE OR CULVERT**
- BRIDGE OR CULVERT > 20'
  - BRIDGE OR CULVERT 6' - 20'
  - BIKE PATH STRUCTURE
  - VTCULVERTS BRIDGE
  - VTCULVERTS CULVERT > 6'
- B34 / C34** STATE BRIDGE OR CULVERT IDENTIFIER  
**B34 / C34** TOWN BRIDGE OR CULVERT IDENTIFIER  
**NFR** NATIONAL FOREST ROAD  
**USGH** UNITED STATES GOV. HWY.  
**P** PARK AND RIDE
- FEDERAL CLASSIFICATION IDENTIFIER**
- MA** MINOR ARTERIAL
  - MJC** MAJOR COLLECTOR
  - MNC** MINOR COLLECTOR
  - PA** PRINCIPAL ARTERIAL

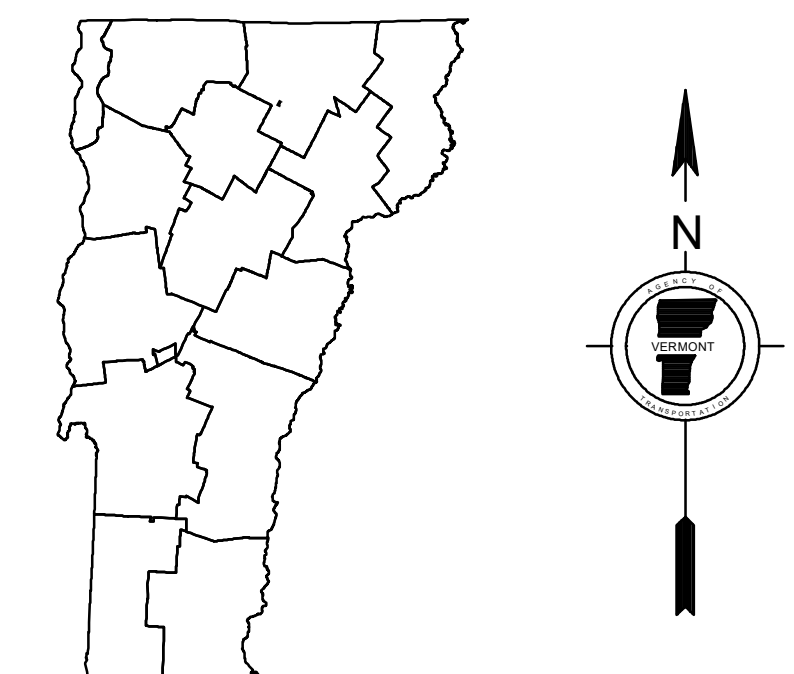
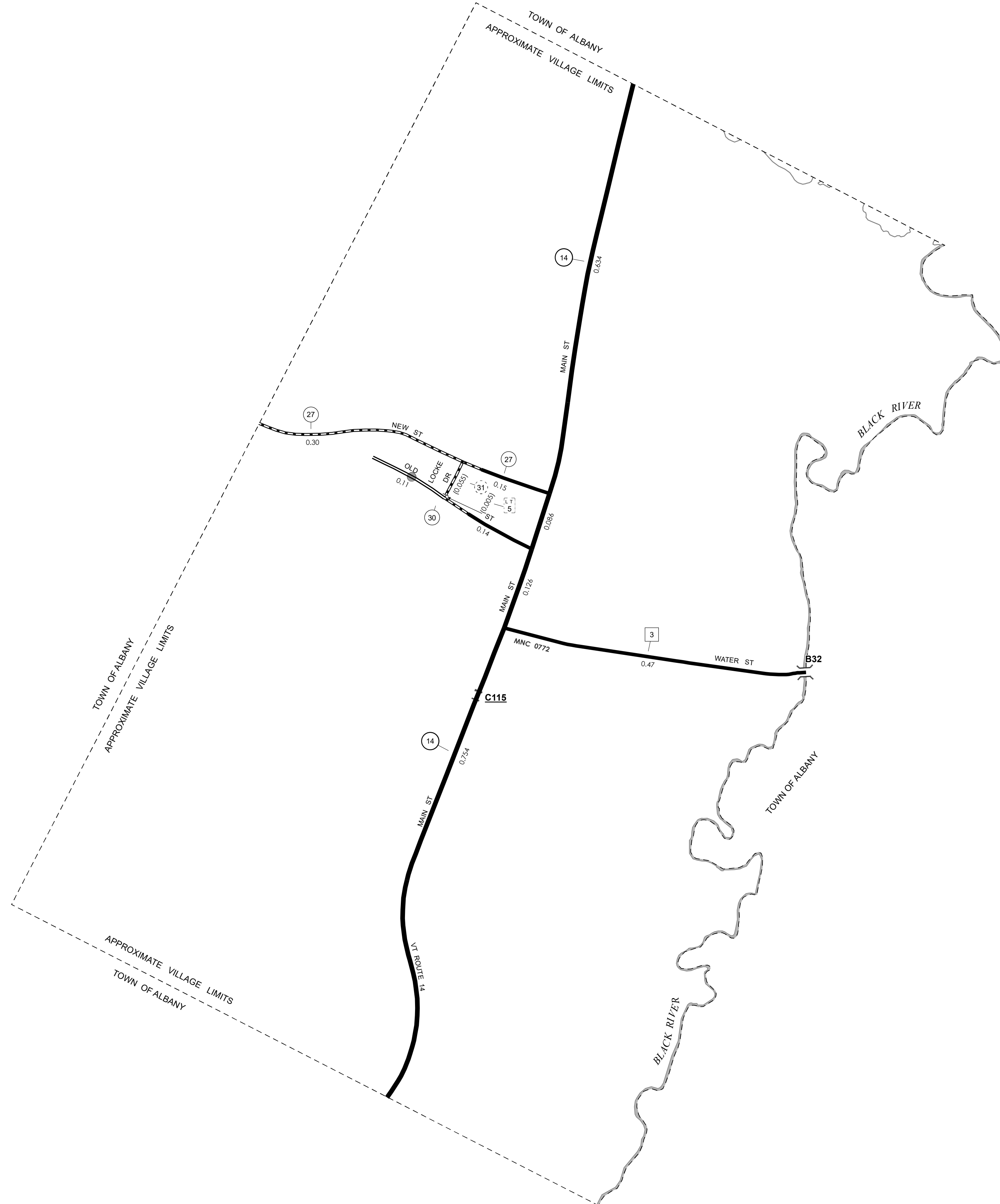

**VERMONT**  
**GENERAL HIGHWAY MAP**  
**Village of Albany**  
**ORLEANS COUNTY**  
 Transportation District #9  
 Prepared by the  
**Vermont Agency of Transportation**  
 Division of Policy, Planning and Intermodal Development  
 in cooperation with  
**U.S. Department of Transportation**  
**Federal Highway Administration**

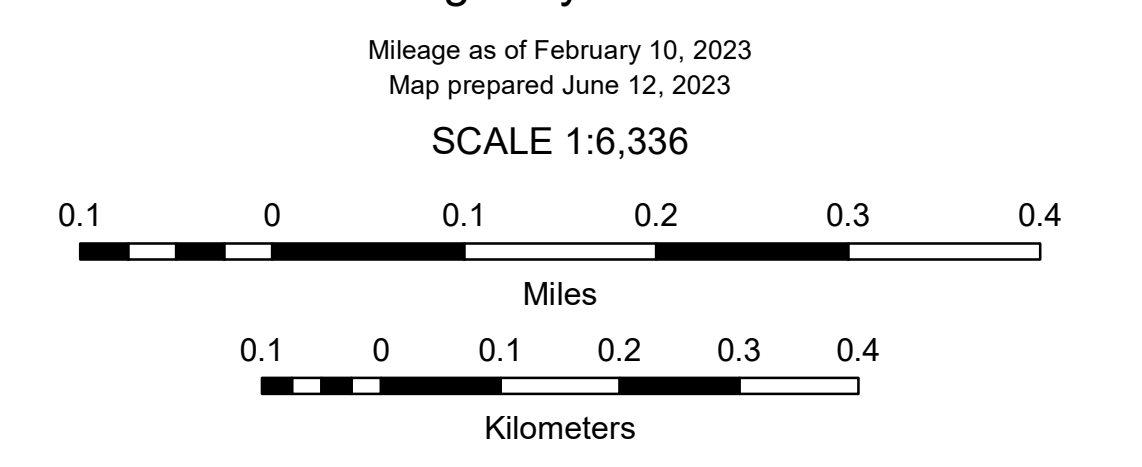

**DISCLAIMER:**  
 The untraveled highways (laid-out town highways), discontinued highways, and legal trails herein are those of which the Agency of Transportation has record; others may exist.

Highway and bridge data by the Agency of Transportation.  
 Town short structures drawn from the VTCULVERTS (formerly VOBCIT) online database. All other data from the Vermont Open Geodata Portal. Only named streams shown.

Vermont State Plane Coordinate System  
 North American Datum of 1983  
 SPCS\_Zone\_Identifier: 4400  
 Geodetic Reference System 80  
 2,000-meter grid, Easting - Northing