

488,000 492,000 496,000 500,000 504,000 508,000 512,000

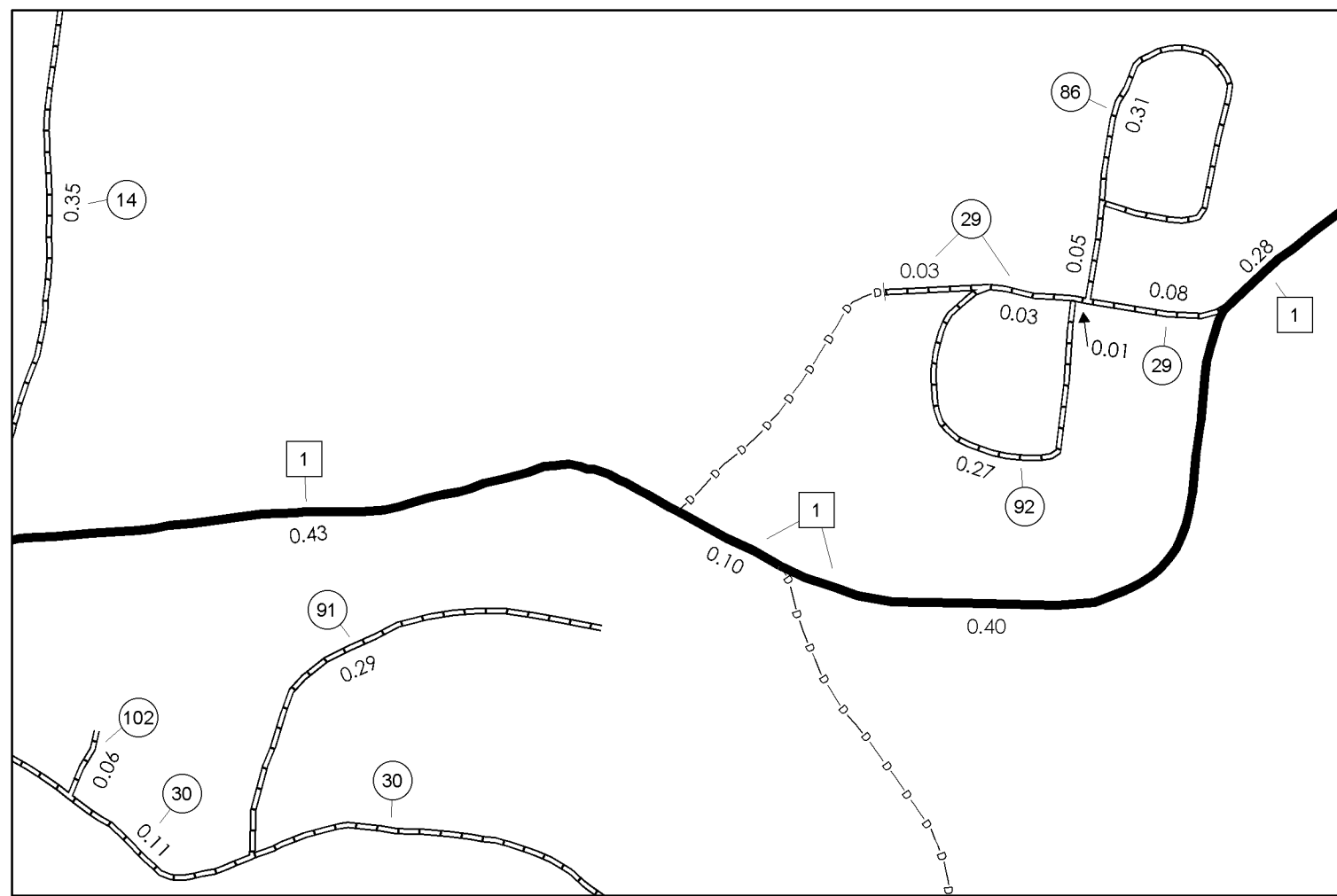

INSET 1

SCALE FOR INSETS 1:6336
0 0.1 0.2 Miles

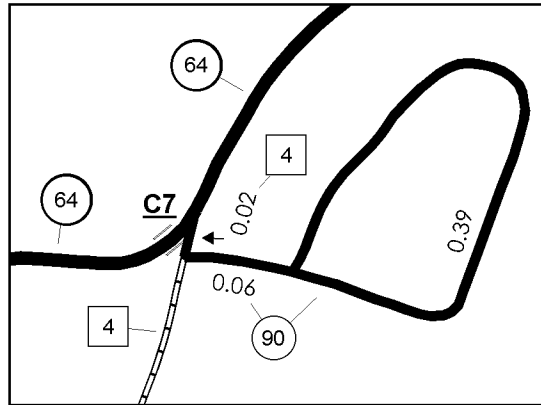

INSET 2

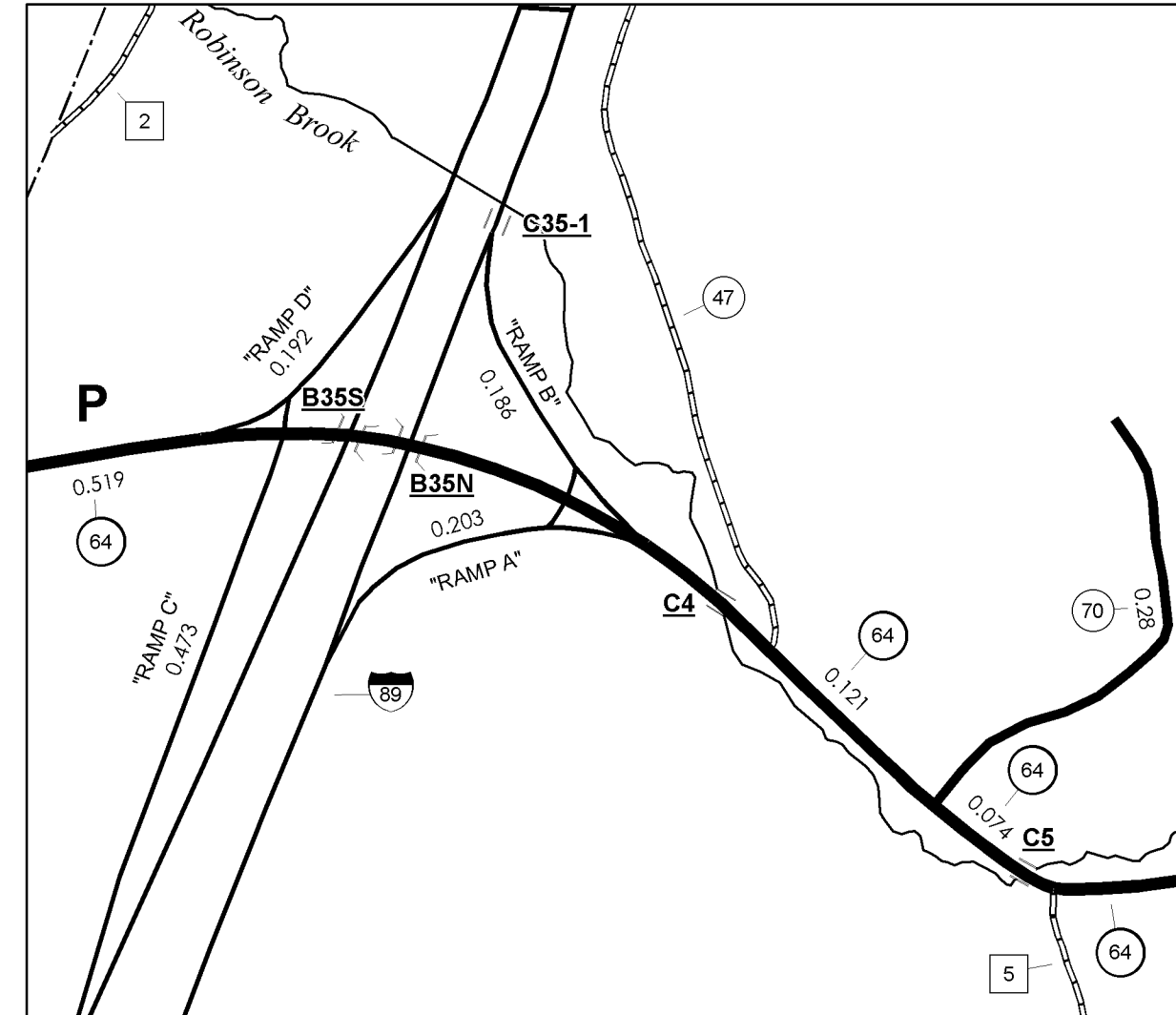

INSET 3

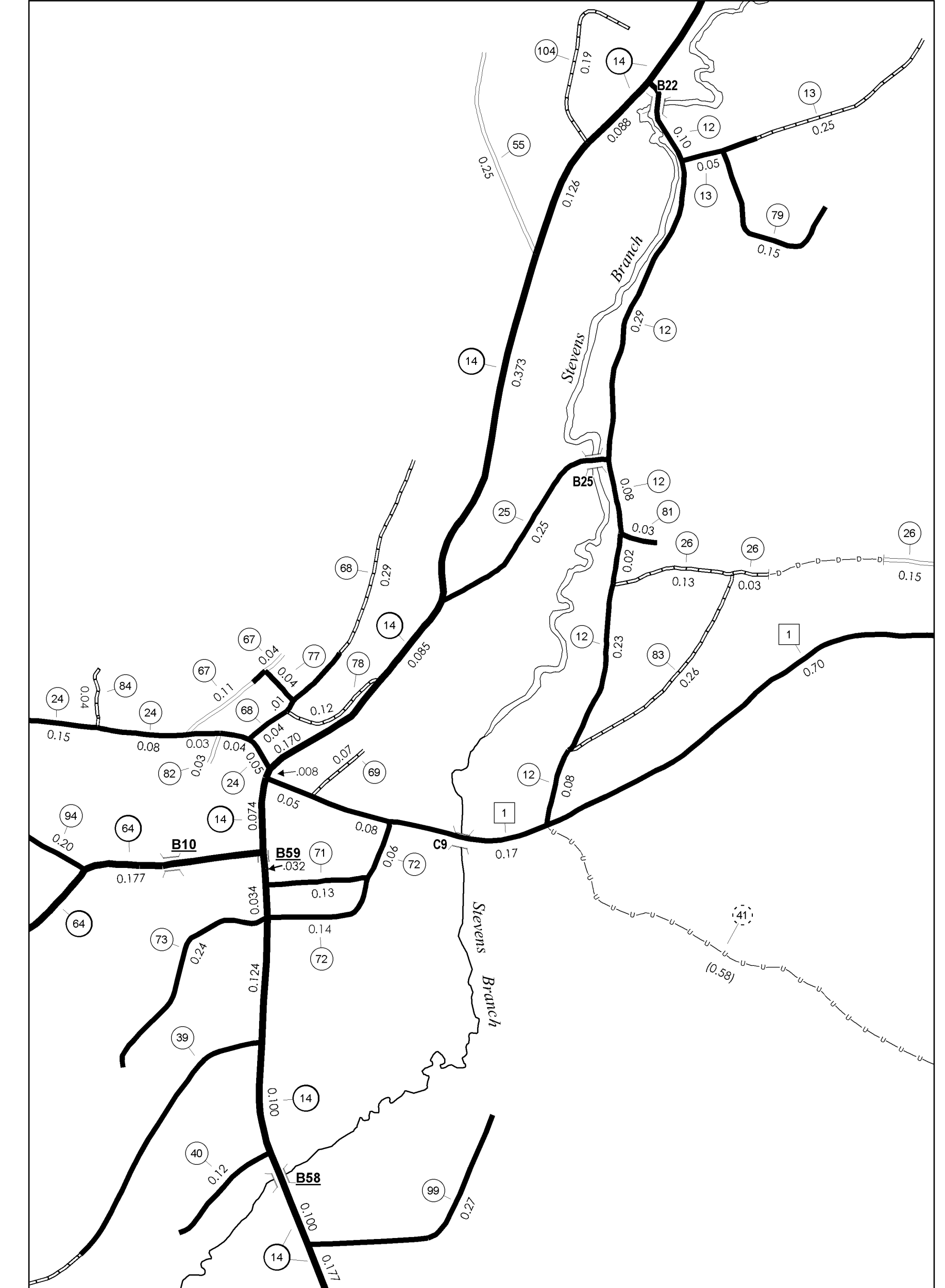

WILLIAMSTOWN INSET 4

TOWN HWY. CLASS NO.	LENGTH IN MILES CLASS 3	LENGTH IN MILES CLASS 4	LEGAL TRAIL NO.	LENGTH IN MILES
7	2.45	(1.55)	60	0.60
8	0.57		61	0.95 (0.25)
11	0.64		62	2.00
12	0.80		63	0.56 (0.49)
13	0.30		64	1.70
14	1.70		65	0.15 (0.45)
15	0.15		66	0.34
16	3.88		67	0.07
17	0.10		68	0.28
18	0.06		69	0.13
20	0.62		70	0.20
22		(0.65)	71	0.24
23	0.50	(1.10)	72	0.28
24	0.35		73	0.10
25	0.25		74	0.12 (0.10)
26	1.11		75	0.15 (0.08)
27		(0.52)	76	0.03
28	0.15		77	0.04
29	0.15		78	0.12
30	2.78		79	0.15
32	0.55		80	
33	1.52		81	0.03
34		(0.40)	82	0.03
35	0.10		83	0.26
36		(0.72)	84	0.04
37	0.46	(0.44)	85	0.19
39	2.10		86	0.36
40	0.12		87	0.53
41	0.22	(0.58)	88	0.16
42	2.00		89	0.10
43		(1.05)	90	0.45
45	1.30	(0.20)	91	0.29
46	0.91	(2.12)	92	0.27
47	1.58	(0.42)	93	0.95
49	0.40		94	2.88
50	1.88		95	0.05
51	0.14		96	0.08
52	0.66		97	0.12
53	1.00		98	0.10
54	2.03	(0.47)	99	0.27
55	0.25		100	0.20
56	0.85	(0.16)	101	0.13
* 56		(0.12)	102	0.06
57	0.47		103	0.10
58	0.31		104	0.19
TOTAL	51.16	11.87		

* This portion of town highway is Class 3, but is functionally Class 4

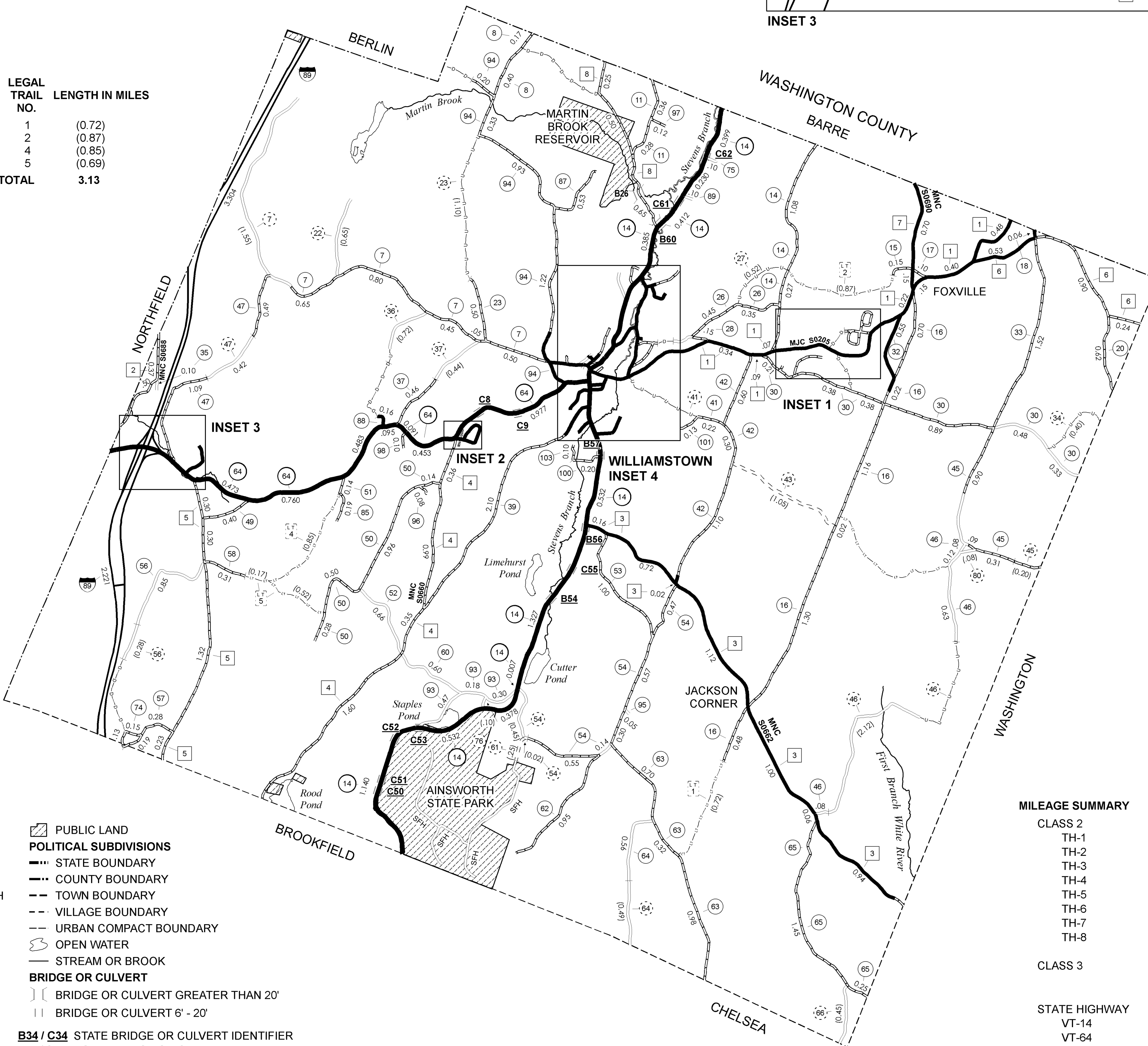

- HIWAYS**
- INTERSTATE OR DIVIDED HIGHWAY
 - STATE - HARD SURFACE OR PAVED
 - TOWN - HARD SURFACE OR PAVED
 - GRAVEL
 - SOIL OR GRADED AND DRAINED EARTH
 - UNIMPROVED OR PRIMITIVE
 - IMPASSABLE OR UNTRAVELED
 - LEGAL TRAIL
 - DISCONTINUED
 - HIGHWAY CLASS CHANGE
 - RAILROAD
 - PARK AND RIDE
- CLASS 1**
- CLASS 2**
- CLASS 3**
- CLASS 4**
- LEGAL TRAIL**
- FEDERAL CLASSIFICATION IDENTIFIER**
- FAU URBAN ARTERIAL OR COLLECTOR
 - MA MINOR ARTERIAL
 - MJC MAJOR COLLECTOR
 - MNC MINOR COLLECTOR
 - PA PRINCIPAL ARTERIAL

- PUBLIC LAND**
- POLITICAL SUBDIVISIONS**
- STATE BOUNDARY
 - COUNTY BOUNDARY
 - TOWN BOUNDARY
 - VILLAGE BOUNDARY
 - URBAN COMPACT BOUNDARY
 - OPEN WATER
 - STREAM OR BROOK
 - BRIDGE OR CULVERT
 - BRIDGE OR CULVERT GREATER THAN 20'
 - BRIDGE OR CULVERT 6' - 20'
- B34 / C34 STATE BRIDGE OR CULVERT IDENTIFIER**
- B34 / C34 TOWN BRIDGE OR CULVERT IDENTIFIER**

MILEAGE SUMMARY

CLASS 2	3.960
TH-1	0.870
TH-2	4.020
TH-3	3.320
TH-4	2.150
TH-5	1.670
TH-6	0.850
TH-7	1.400
TH-8	
TOTAL CLASS 2	18.240
CLASS 3	
TOTAL CLASS 3	51.160
TOTAL TOWN	69.400
STATE HIGHWAY	
VT-14	6.833
VT-64	4.223
TOTAL STATE HIGHWAY	11.056
TOTAL STATE	11.056
INTERSTATE	
I-89	5.525
TOTAL INTERSTATE	5.525
INTERSTATE - Ramp	
I-89	1.054
TOTAL INTERSTATE - Ramp	1.054
TOTAL INTERSTATE	6.579

TOTAL, TRAVELED HIGHWAYS, FEB. 10, 2008: 87.035
(Excludes Class 4 and Legal Trail Mileage)

VERMONT
GENERAL HIGHWAY MAP
Town of Williamstown
ORANGE COUNTY

Transportation District #6

Prepared by the
Vermont Agency of Transportation
Policy & Planning Division
in cooperation with
U.S. Department of Transportation
Federal Highway Administration

Mileage as of: Feb. 10, 2008
Map generated: October, 2008

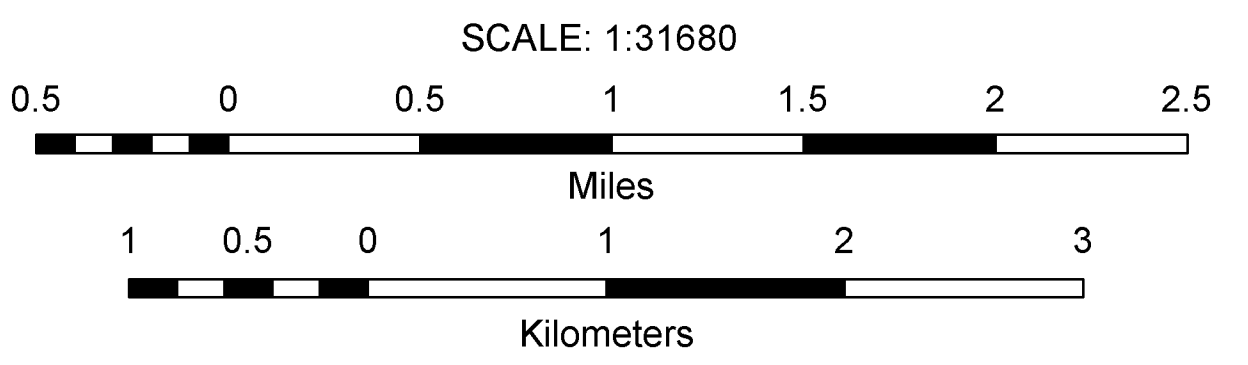

DISCLAIMER:
The untraveled highways (laid-out town highways), discontinued highways, and legal trails shown hereon are those of which the Agency of Transportation has record; others may exist.
Highway and bridge data by the Agency of Transportation, Policy & Planning Division. All other data from the Vermont Center for Geographic Information.

STRUCTURES - SURFACE WATER NOTE:
Town short structures (bridges or culverts from 6-feet to less than 20-feet) were not represented due to inconsistencies in the data.
The surface waters are from the Vermont Hydrological Dataset (VHD). Only the named streams are shown.

Vermont State Plane Coordinate System
North American Datum of 1983
SPCS Zone Identifier: 4400
Geodetic Reference System 80
4,000-meter grid, Easting - Northing