

TOWN HWY. No.	LENGTH IN MILES CLASS 3	CLASS 4
4	2.28	
5	5.20	
6	4.20	
7	2.80	
8		(0.35)
9	0.04	(0.50)
10	1.61	
11	1.15	
12	0.66	(0.60)
13	1.96	
14	0.85	
15	1.46	
16		(0.35)
17	0.84	
18	0.58	
19	0.65	
20	0.95	
21	0.95	
22	0.70	
23	2.34	(0.70)
24	2.91	(1.00)
25	0.17	
26	1.73	(0.34)
27	1.19	(0.77)
28	1.15	
29		(0.07)
30	0.25	(1.36)
31	1.07	
32	0.54	
33		(0.75)
34	2.13	
35	0.75	
36	0.68	
37	0.29	
38	0.20	
39	2.30	
40	1.75	
41		(0.28)
42	1.25	
43	0.32	(0.13)
44	0.49	(0.75)
45	0.40	(0.65)
46	1.35	
47		(1.18)
48	0.05	
49	0.10	
50	0.16	
51		(0.50)
52	0.06	
53	0.12	
54	0.11	
55		(0.19)
56	0.07	(0.04)
57	0.31	
58	0.02	
59	0.11	
60	0.12	
61		(0.05)
62	0.12	
63	0.12	
64	0.12	
65	0.35	
66	0.10	
67	0.50	(0.84)
68	0.50	(0.45)
69	0.30	
70	0.06	
71		(0.35)
72		(0.01)
73		(0.01)
74		(0.16)
75		
76		
77		
78		
TOTAL	51.85	12.38

MILEAGE SUMMARY

CLASS	TH-1	TH-2	TH-3	TOTAL CLASS	LENGTH
CLASS 2	4.630	5.790	5.320	TOTAL CLASS 2	15.740
CLASS 3				TOTAL CLASS 3	51.85
TOTAL TOWN					67.590
TOTAL STATE					0.000

TOTAL, TRAVELED HIGHWAYS, FEB. 10, 2014: 67.590 (Excludes Class 4, Legal Trail, and Unidentified Corridor Mileage)

TOWN HWY. No.	LENGTH IN MILES "NOT UP TO STANDARD"
19	(0.30)
46	(0.09)
59	(0.08)
TOTAL	0.47

* The sections of the town highways listed above are legally Class 3, but have been deemed "Not Up To Standard" and are functionally Class 4 Town Highways

LEGAL TRAIL No.	LENGTH IN MILES LEGAL TRAIL
1	(0.45)
TOTAL	0.45

DISCLAIMER: The untraveled highways (laid-out town highways), discontinued highways, and legal trails herein are those of which the Agency of Transportation has record; others may exist.

Highway and bridge data by the Agency of Transportation. Town short structures are drawn from the Vermont Online Bridge & Culvert Inventory Tool (VOBCIT) database. All other data from the Vermont Center for Geographic Information. Only named streams are shown.

- HIGHWAYS**
 - INTERSTATE
 - U.S. ROUTE
 - STATE ROUTE
 - CLASS 1
 - CLASS 2
 - CLASS 3
 - CLASS 4
 - LEGAL TRAIL
- INTERSTATE OR DIVIDED HIGHWAY
- STATE - HARD SURFACE OR PAVED
- TOWN - HARD SURFACE OR PAVED
- GRAVEL
- SOIL OR GRADED AND DRAINED EARTH
- UNIMPROVED OR PRIMITIVE
- IMPASSABLE OR UNTRAVELED
- LEGAL TRAIL
- DISCONTINUED
- HIGHWAY CLASS CHANGE
- RAILROAD
- INACTIVE RAILROAD
- NFR NATIONAL FOREST ROAD
- SFH STATE FOREST HIGHWAY
- PARK AND RIDE
- PUBLIC LAND - GREEN MOUNTAIN NATIONAL FOREST
- PUBLIC LAND - STATE/MUNICIPAL
- POLITICAL SUBDIVISIONS**
 - STATE BOUNDARY
 - COUNTY BOUNDARY
 - TOWN BOUNDARY
 - VILLAGE BOUNDARY
 - URBAN COMPACT BOUNDARY
 - WATER BODY
 - STREAM OR BROOK
 - BRIDGE OR CULVERT**
 - BRIDGE OR CULVERT > 20'
 - BRIDGE OR CULVERT 6' - 20'
 - VOBCIT BRIDGE
 - VOBCIT CULVERT > 6'
 - STATE BRIDGE OR CULVERT IDENTIFIER
 - TOWN BRIDGE OR CULVERT IDENTIFIER
- FEDERAL CLASSIFICATION IDENTIFIER
 - FAU URBAN ARTERIAL OR COLLECTOR
 - MA MINOR ARTERIAL
 - MJC MAJOR COLLECTOR
 - MNC MINOR COLLECTOR
 - PA PRINCIPAL ARTERIAL

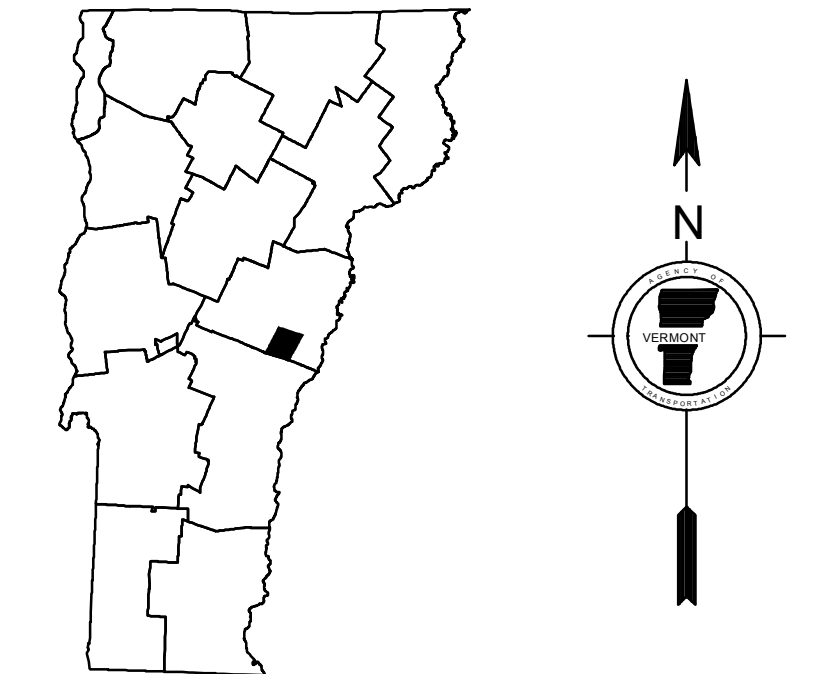
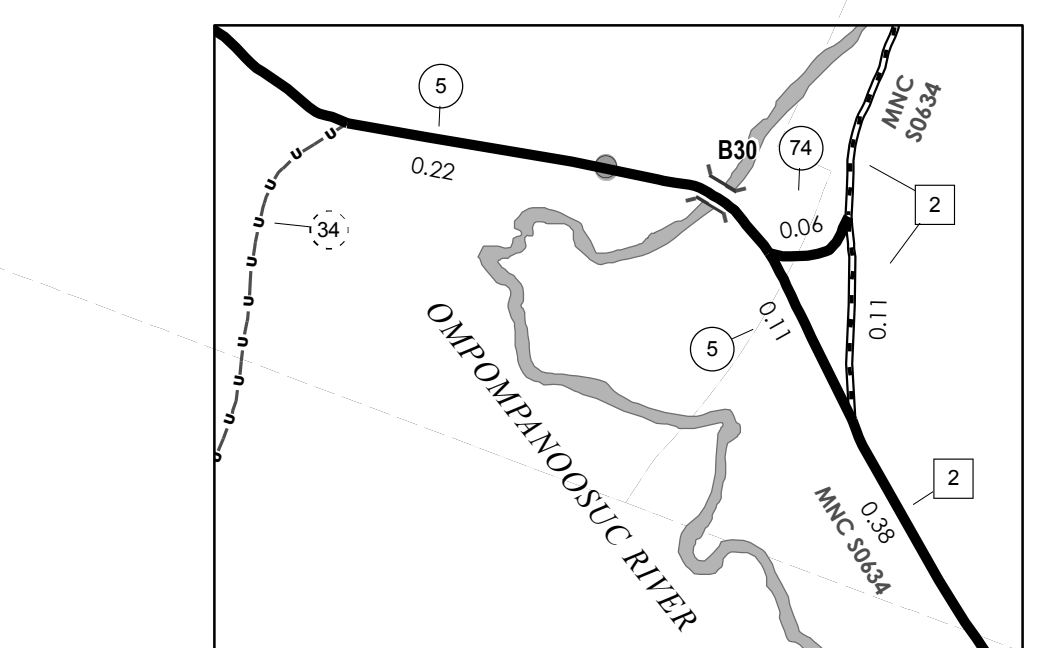
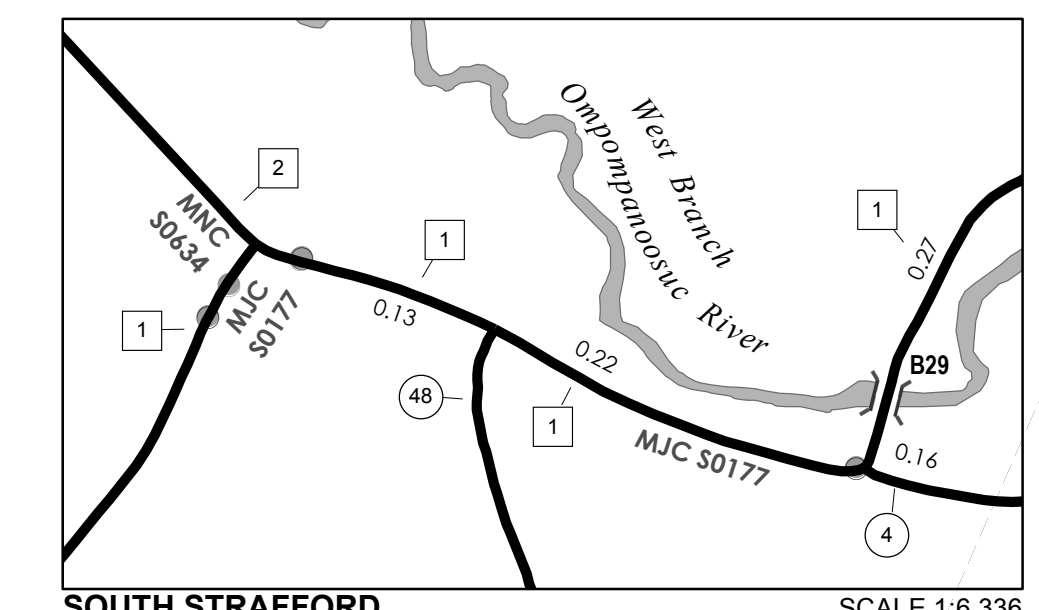
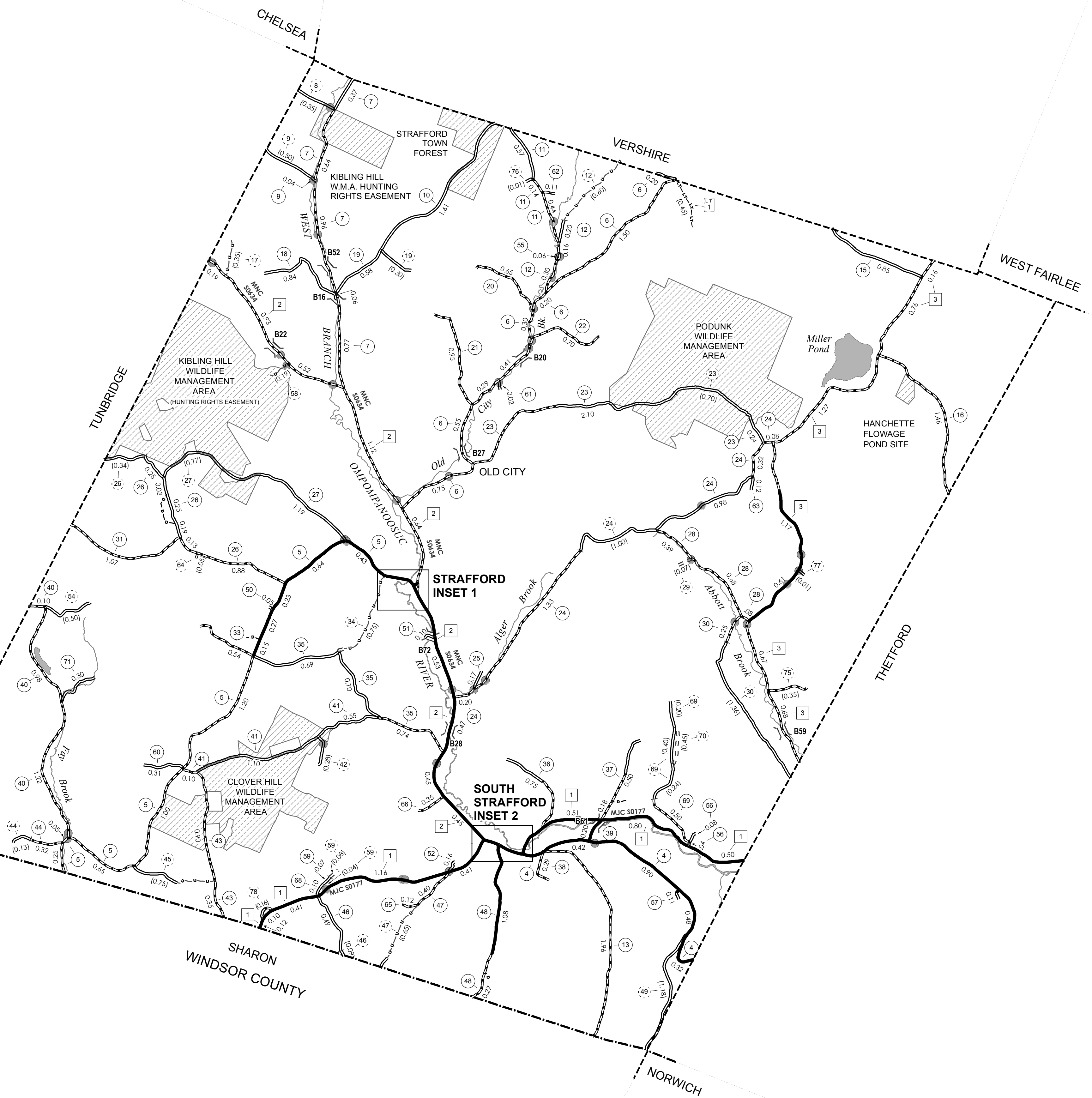

VERMONT
GENERAL HIGHWAY MAP
Town of Strafford

ORANGE COUNTY
Transportation District #4

Prepared by the
Vermont Agency of Transportation
Division of Policy, Planning and Intermodal Development
in cooperation with
U.S. Department of Transportation
Federal Highway Administration

Mileage as of February 10, 2014
Map prepared October 03, 2014
SCALE 1:31,680

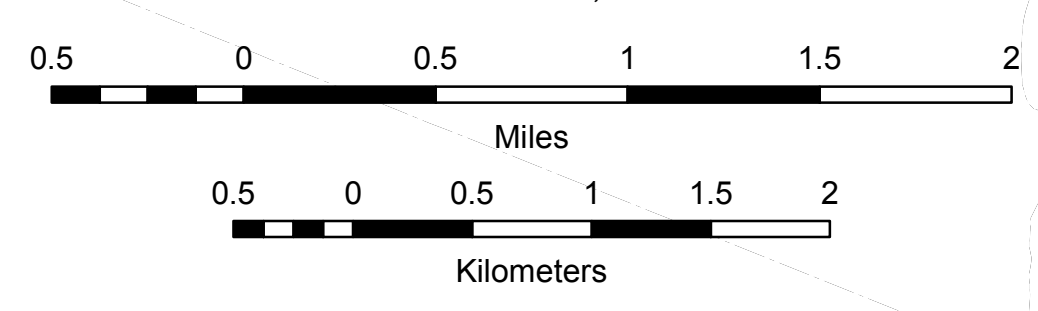

Vermont State Plane Coordinate System
North American Datum of 1983
SPCS_Zone_Identifier: 4400
Geodetic Reference System 80
4,000-meter grid, Easting - Northing