

TOWN HWY. No.	LENGTH IN MILES CLASS 3	LENGTH IN MILES CLASS 4	TOWN HWY. No.	LENGTH IN MILES CLASS 3	LENGTH IN MILES CLASS 4	TOWN HWY. No.	LENGTH IN MILES CLASS 3	LENGTH IN MILES CLASS 4
7		(0.21)	55	0.18		312	0.03	
8	0.93		56	0.59		314	0.04	
9	1.03		59	3.46		316	0.09	
10	0.10		60	0.55		318	0.77	
11	0.76		61	0.81	(0.09)	320		(0.25)
12	0.17		62	0.11	(0.45)	322	0.19	
13	0.56		63	0.16		324	0.08	
14	0.12		64	0.14		326	0.03	
15	1.05		65	0.15		328	0.12	
16	0.10		66	0.54		330	0.05	
17	0.07		67	1.06		332	0.14	
19	0.14		68	3.53		334	0.07	
20		(0.18)	70	0.10		336	0.13	
22	0.05		71	3.76		338	0.27	
23	0.08		72	2.65		340	0.05	
24	1.16		73	0.51		342	0.16	
25	0.17		74	2.12		344	0.35	
26	3.48		75	0.45		346	0.10	
27	2.42		76	0.14		348	0.12	
29	0.50		78	2.29		354	0.12	(0.14)
30	1.60		79	0.79		356	0.12	
31	1.07		80	0.10		358	0.36	
32	0.10		81	0.24		360	0.05	
33	1.54		83	0.21		362	0.31	
34	0.40		84	0.05		364	0.19	
35	0.25		85		(0.08)	366	0.53	
36	0.67		86		(0.15)	368	0.25	
37	0.10		87	0.13		372	0.23	
38	0.03		89	0.15		374	0.27	
39	0.08		90	1.00		376	0.17	
40	0.64		91	0.06		378	0.07	
41	0.30		92	0.23		380	0.04	
42	0.75		94	0.33		382	0.23	
43	1.19		95	0.08		384	0.18	
44	1.22		97	0.24		386	0.54	
45	0.83		98	0.16		390	0.10	
46	0.59		99	0.10		394	0.17	
47	0.40		100	0.27		396	0.04	
48	4.02		300	0.03		398	0.16	
49	0.27		302	0.11		400	0.14	
50	0.61		304	0.17		404	0.04	
51	1.70		305	0.61		406	0.61	
52	2.51		308	0.15		408	0.07	
53	1.48		308	0.06		410	0.12	
54	0.36		310	0.18		TOTAL	72.63	1.55

TOWN HWY. No.	LENGTH IN MILES "NOT UP TO STANDARD"	LEGAL TRAIL No.	LENGTH IN MILES LEGAL TRAIL
5	(0.59)	1	(0.97)
18	(0.19)	2	(0.62)
61	(0.06)	3	(0.05)
64	(0.04)	5	(0.40)
89	(0.10)	6	(1.42)
TOTAL	0.98	7	(1.02)
		8	(0.57)
		TOTAL	5.35

* The sections of the town highways listed above are legally Class 3, but have been deemed "Not Up To Standard" and are functionally Class 4 Town Highways

MILEAGE SUMMARY

CLASS 1		
TH-1	1.603	
TH-2	0.398	
TH-3	0.429	
TH-4	0.030	
TOTAL CLASS 1		2.460
CLASS 2		
TH-1	3.310	
TH-2	4.930	
TH-3	3.560	
TH-4	0.100	
TH-6	0.470	
TH-7	0.450	
TH-8	1.850	
TOTAL CLASS 2		14.670
CLASS 3		
TOTAL CLASS 3		72.63
TOTAL TOWN		89.760
STATE HIGHWAY		
VT-12	5.155	
VT-12A	0.877	
VT-14	7.734	
VT-66	7.192	
TOTAL STATE HIGHWAY		20.958
TOTAL STATE		20.958
INTERSTATE		
I-89	7.889	
TOTAL INTERSTATE		7.889
INTERSTATE - Ramps		
I-89	1.101	
TOTAL INTERSTATE - Ramps		1.101
TOTAL INTERSTATE		8.990

TOTAL, TRAVELED HIGHWAYS, FEB. 10, 2018: 119.708
(Excludes Class 4 and Legal Trail Mileage)

- HIGHWAYS**
- INTERSTATE OR DIVIDED HIGHWAY
 - STATE - HARD SURFACE OR PAVED
 - TOWN - HARD SURFACE OR PAVED
 - GRAVEL
 - SOIL OR GRADED AND DRAINED EARTH
 - UNIMPROVED OR PRIMITIVE
 - IMPASSABLE OR UNTRAVELED
 - LEGAL TRAIL
 - DISCONTINUED
 - CLASS 1
 - CLASS 2
 - CLASS 3
 - CLASS 4
 - RAILROAD
 - INACTIVE RAILROAD
 - PARK AND RIDE

- POLITICAL SUBDIVISIONS**
- STATE BOUNDARY
 - COUNTY BOUNDARY
 - TOWN BOUNDARY
 - VILLAGE BOUNDARY
 - URBAN COMPACT BOUNDARY
 - WATER BODY
 - STREAM OR BROOK
 - BRIDGE OR CULVERT
 - BRIDGE OR CULVERT > 20'
 - BRIDGE OR CULVERT 6' - 20'
 - BIKE PATH STRUCTURE
 - VT CULVERTS BRIDGE
 - VT CULVERTS CULVERT > 6'
 - STATE BRIDGE OR CULVERT IDENTIFIER
 - TOWN BRIDGE OR CULVERT IDENTIFIER

- FEDERAL CLASSIFICATION IDENTIFIER**
- MA MINOR ARTERIAL
 - MJC MAJOR COLLECTOR
 - MNC MINOR COLLECTOR
 - PA PRINCIPAL ARTERIAL

DISCLAIMER:
The untraveled highways (laid-out town highways), discontinued highways, and legal trails hereon are those of which the Agency of Transportation has record; others may exist.

Highway and bridge data by the Agency of Transportation. Town short structures drawn from the VTCULVERTS (formerly VOBCT) online database. All other data from the Vermont Center for Geographic Information. Only named streams shown.

Vermont State Plane Coordinate System
North American Datum of 1983
SPCS_Zone_Identifier: 4400
Geodetic Reference System 80
4,000-meter grid, Easting - Northing

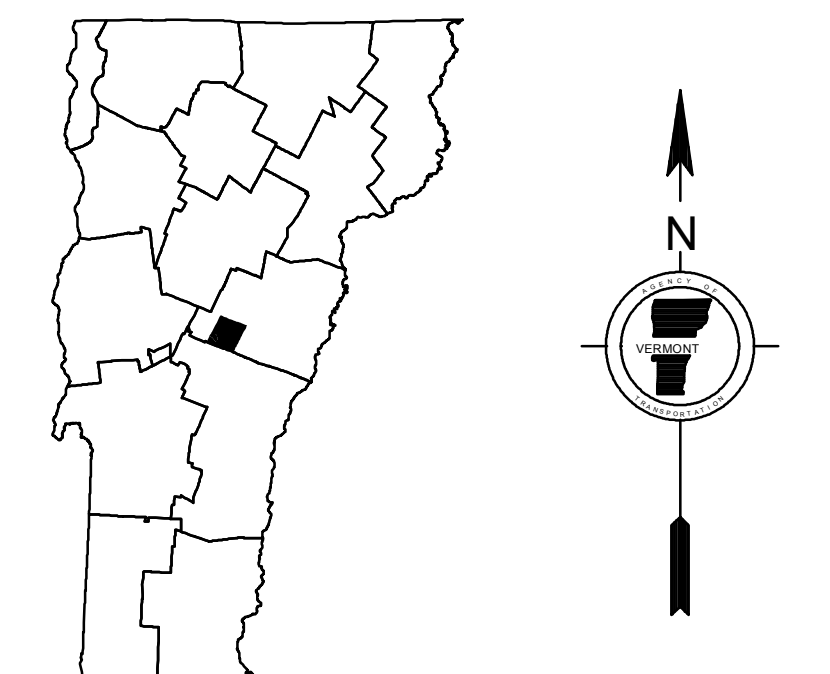
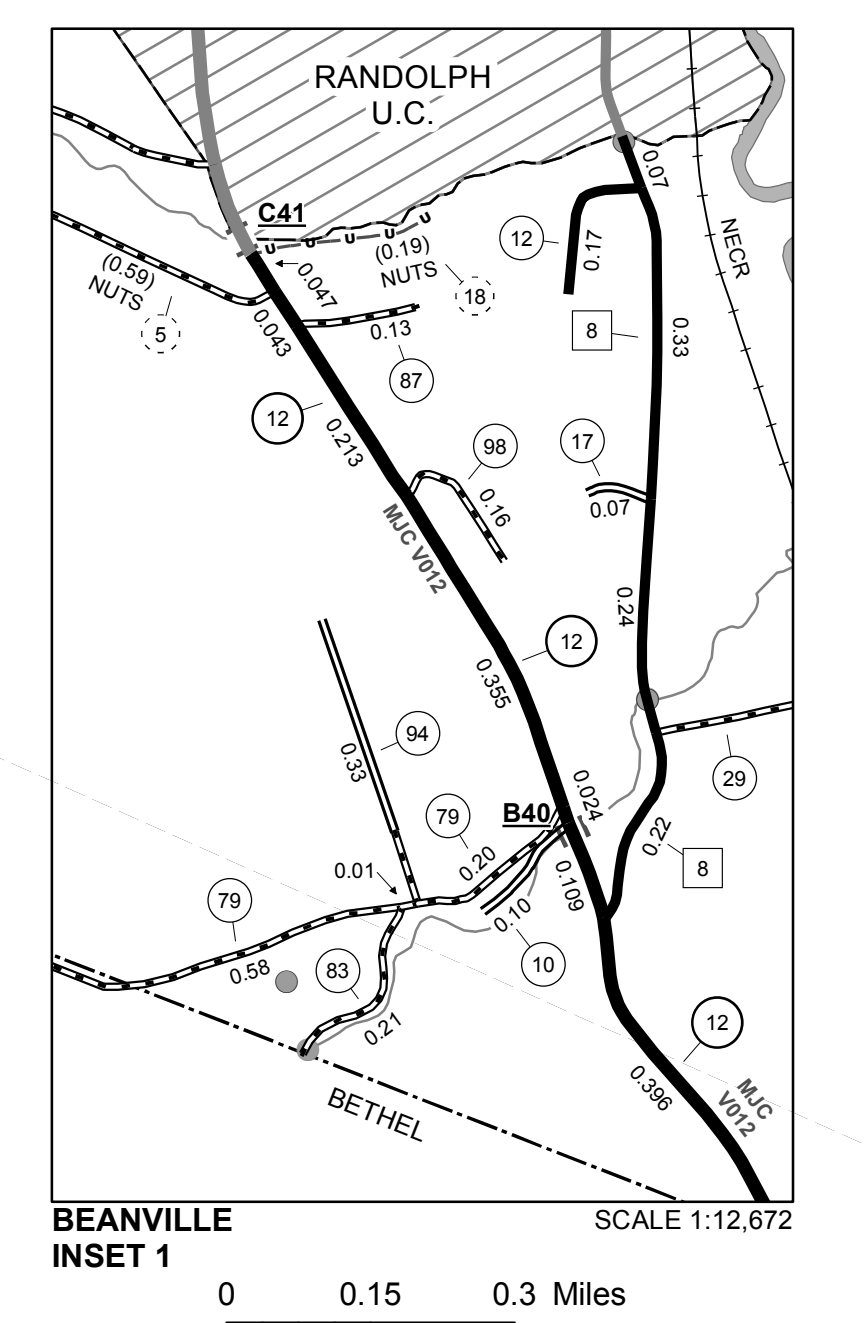
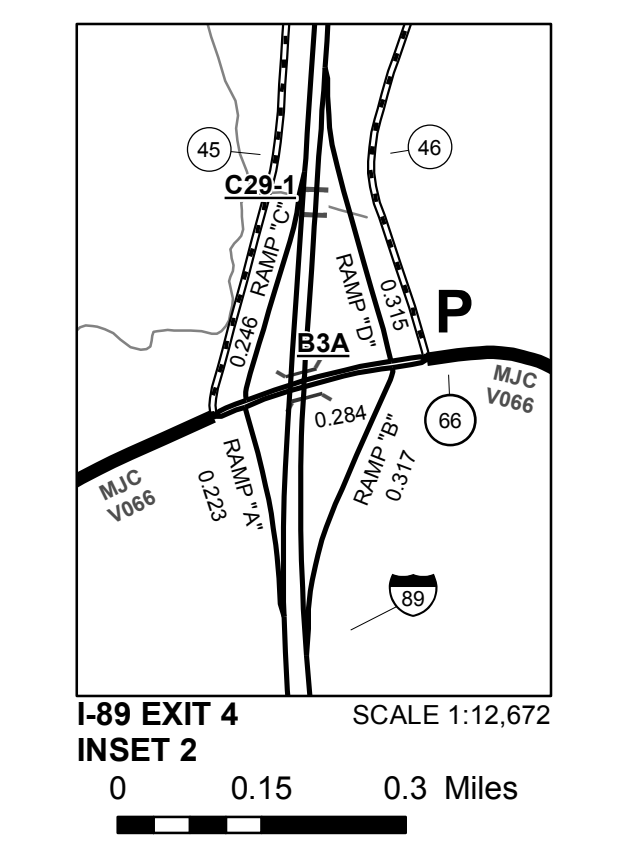
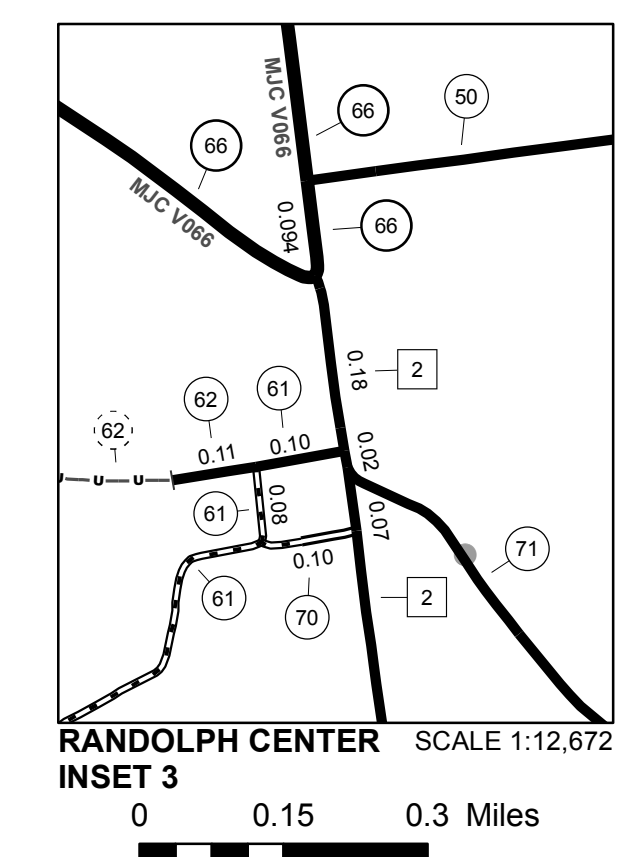
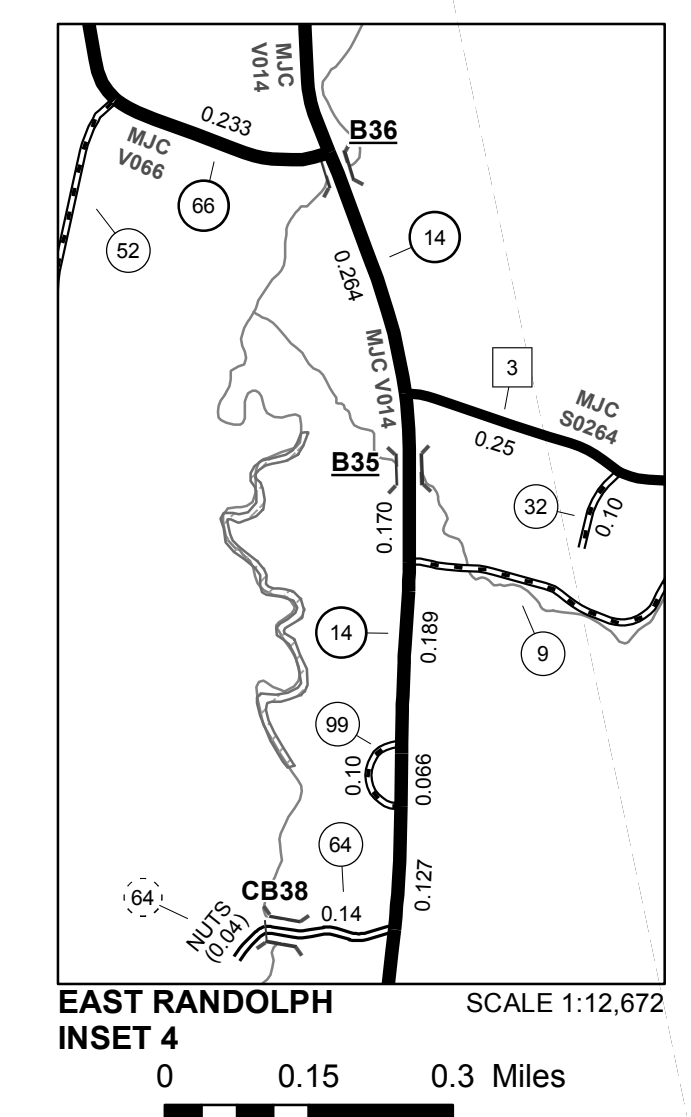
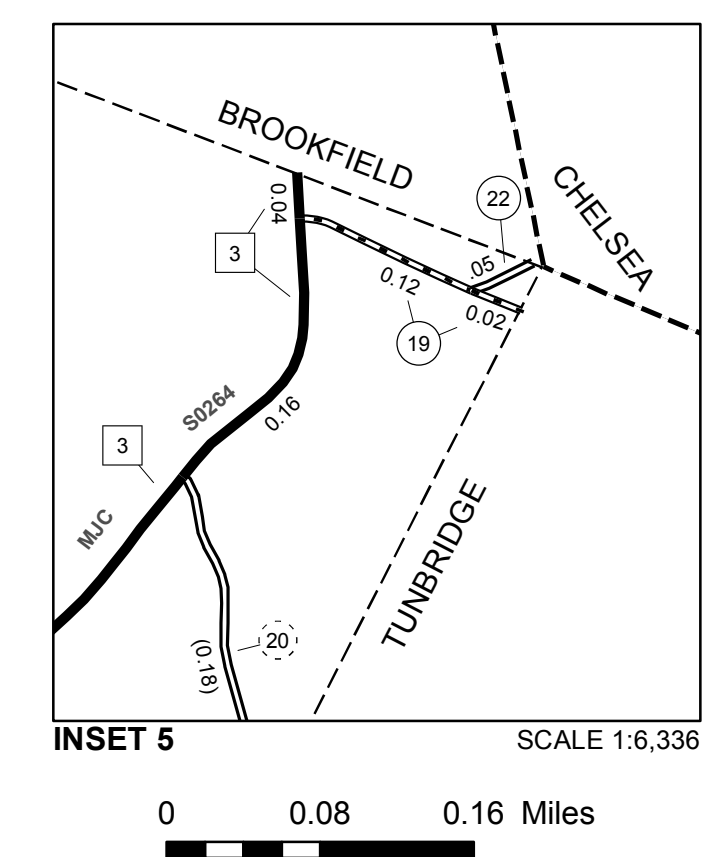

VERMONT GENERAL HIGHWAY MAP
Town of Randolph
ORANGE COUNTY
Transportation District #4

Prepared by the
Vermont Agency of Transportation
Division of Policy, Planning and Intermodal Development
in cooperation with
U.S. Department of Transportation
Federal Highway Administration

Mileage as of February 10, 2018
Map prepared July 25, 2018
SCALE 1:31,680

