

TOWN HWY. No.	LENGTH IN MILES CLASS 3	LENGTH IN MILES CLASS 4
7	0.24	
10	2.88	
11		(0.19)
12	2.16	(0.50)
13	1.40	
14		(0.50)
15	0.19	(1.61)
16	0.15	
17	2.55	
18	0.10	
19	4.00	
20		(0.10)
21	0.40	
22	3.30	
23		(0.80)
24	1.13	
26	0.24	
27	0.95	
28	0.52	
31	2.35	
32	1.26	(0.69)
33	0.15	(0.42)
34	1.78	(1.12)
35	3.74	
36	0.30	
37	0.47	(0.30)
38	0.64	(0.30)
39	0.62	(0.55)
40	0.12	
41	0.20	(0.50)
42		(0.25)
43	0.06	(0.64)
44	0.38	
45	0.27	
46		(1.30)
47	0.80	
48	2.55	
49	0.05	
50	0.50	
51	0.23	
52	0.55	
53		(0.50)
54	0.41	(0.54)
55		(0.10)
56	0.05	
57	0.48	(0.32)
58	0.35	
59	0.71	(0.51)
61	0.12	
62		(0.12)
63	0.08	(0.07)
64		
65	1.18	
66	0.07	
67		(0.15)
68	0.08	(0.10)
69		
70		
71	0.07	(0.05)
74	1.00	
75		(0.20)
76		(0.35)
<b>TOTAL</b>	<b>41.83</b>	<b>12.78</b>

**MILEAGE SUMMARY**

CLASS 2		
TH-1	3.840	
TH-2	3.250	
TH-3	3.250	
TH-4	0.750	
TH-5	0.480	
TH-6	1.200	
TH-7	2.120	
TH-8	0.950	
TH-9	3.330	
<b>TOTAL CLASS 2</b>	<b>19.180</b>	
CLASS 3		
<b>TOTAL CLASS 3</b>	<b>41.83</b>	
<b>TOTAL TOWN</b>	<b>61.010</b>	
STATE HIGHWAY		
VT-12	5.525	
VT-14	6.877	
VT-65	5.222	
<b>TOTAL STATE HIGHWAY</b>	<b>17.424</b>	
<b>TOTAL STATE</b>	<b>17.424</b>	
INTERSTATE		
I-89	6.166	
<b>TOTAL INTERSTATE</b>	<b>6.166</b>	
<b>TOTAL INTERSTATE</b>	<b>6.166</b>	
<b>TOTAL, TRAVELED HIGHWAYS, FEB. 10, 2014:</b>	<b>84.600</b>	

*(Excludes Class 4, Legal Trail, and Unidentified Corridor Mileage)*

TOWN HWY. No.	LENGTH IN MILES "NOT UP TO STANDARD"
59	(0.02)
<b>TOTAL</b>	<b>0.02</b>

\* The sections of the town highways listed above are legally Class 3, but have been deemed "Not Up To Standard" and are functionally Class 4 Town Highways

LEGAL TRAIL No.	LENGTH IN MILES LEGAL TRAIL
1	(0.60)
2	(0.98)
3	(0.30)
<b>TOTAL</b>	<b>1.88</b>

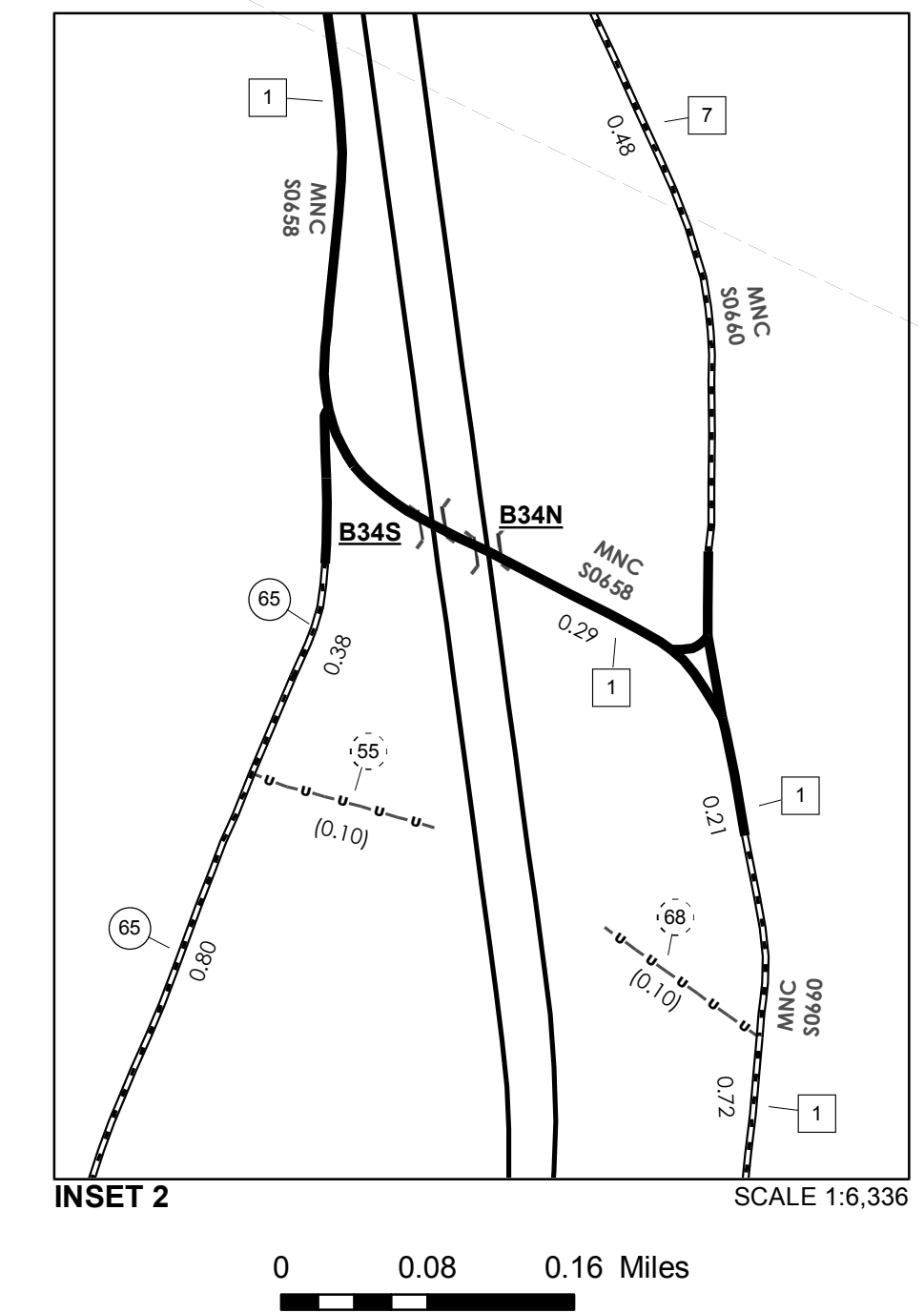
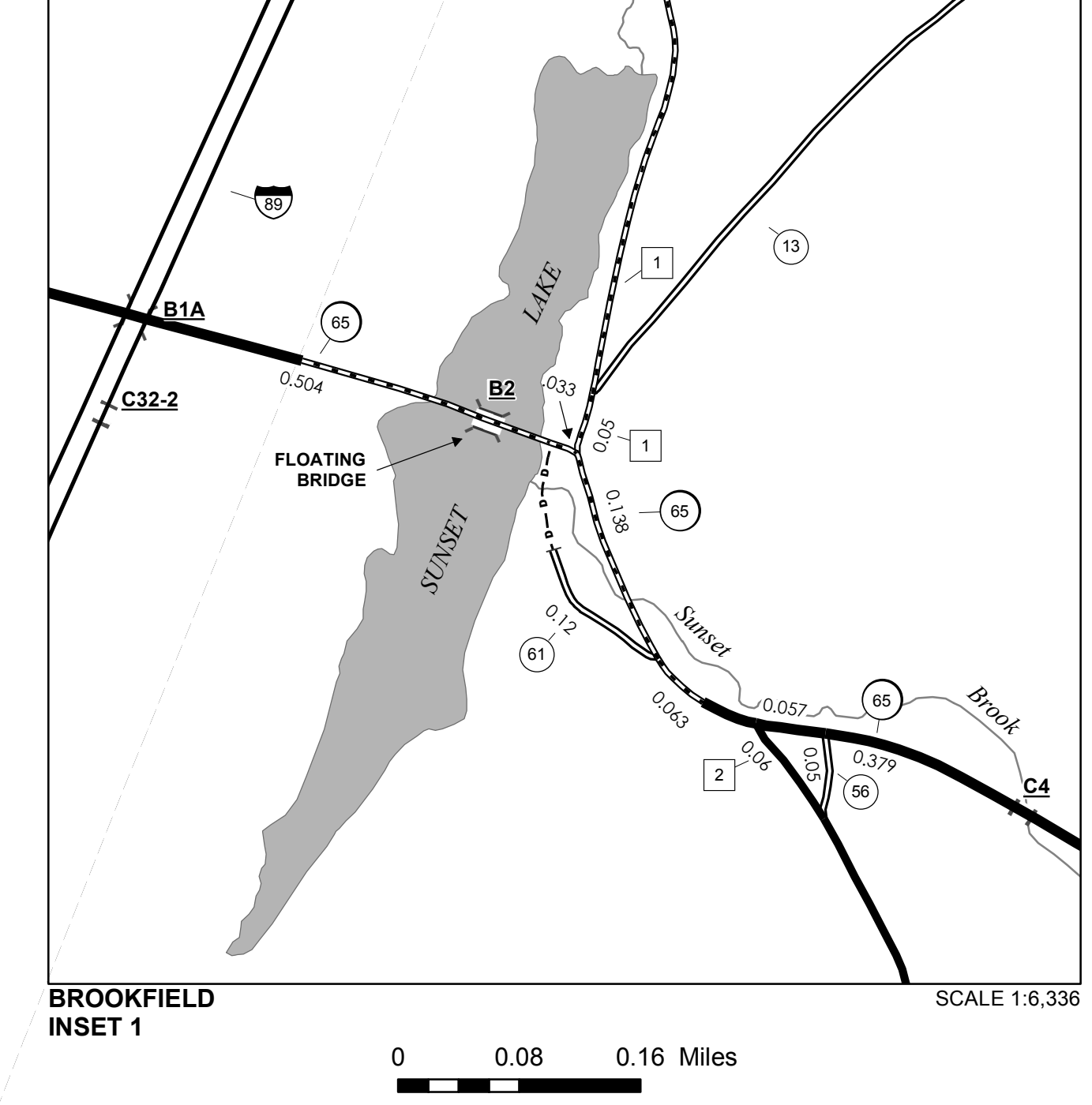
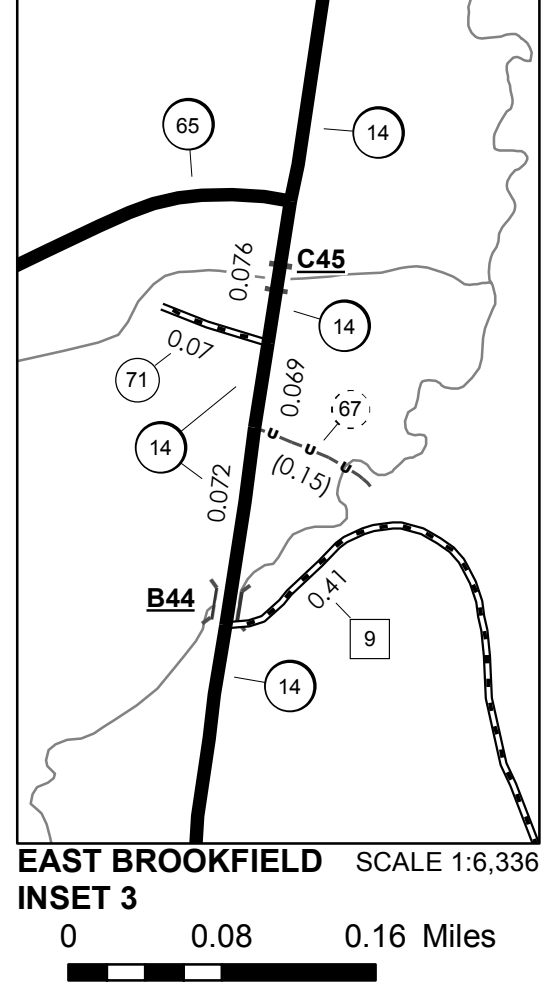
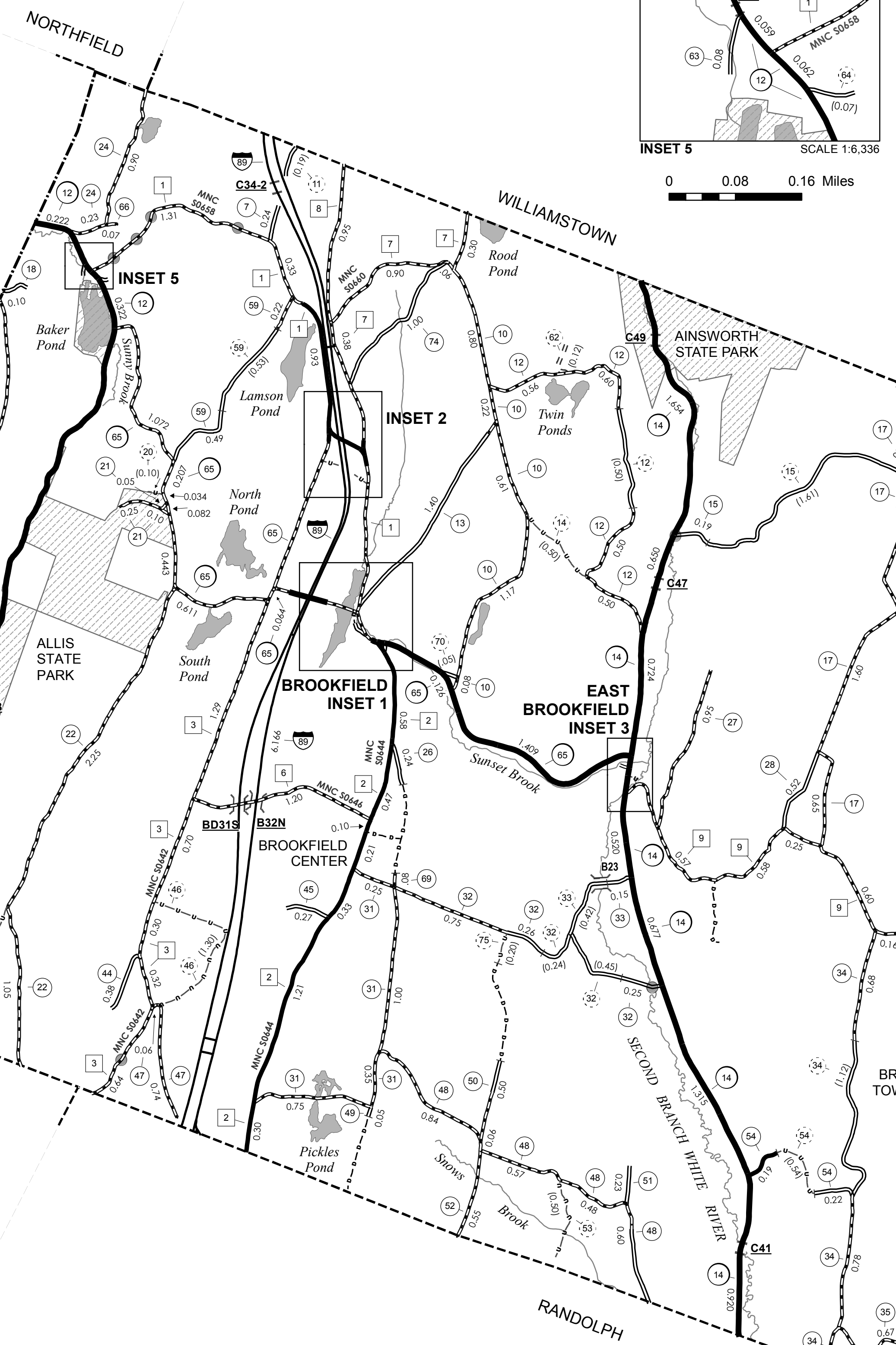
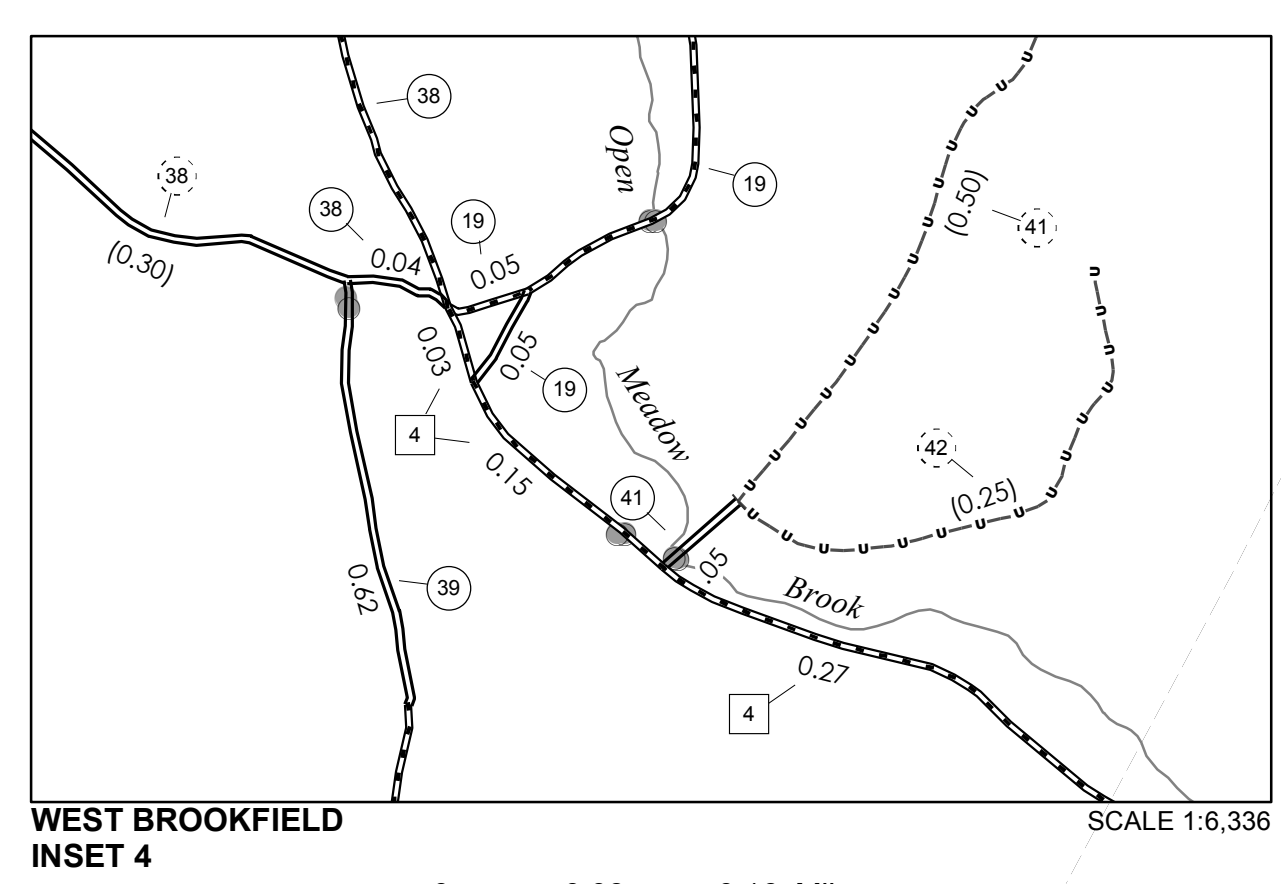

- HIGHWAYS**
- INTERSTATE
  - U.S. ROUTE
  - STATE ROUTE
  - CLASS 1
  - CLASS 2
  - CLASS 3
  - CLASS 4
  - LEGAL TRAIL
- INTERSTATE OR DIVIDED HIGHWAY  
STATE - HARD SURFACE OR PAVED  
TOWN - HARD SURFACE OR PAVED  
GRAVEL  
SOIL OR GRADED AND DRAINED EARTH  
UNIMPROVED OR PRIMITIVE  
IMPASSABLE OR UNTRAVELED  
LEGAL TRAIL  
DISCONTINUED  
HIGHWAY CLASS CHANGE  
RAILROAD  
INACTIVE RAILROAD  
NFR NATIONAL FOREST ROAD  
SFH STATE FOREST HIGHWAY  
P PARK AND RIDE
- PUBLIC LAND - GREEN MOUNTAIN NATIONAL FOREST**  
PUBLIC LAND - STATE/MUNICIPAL
- POLITICAL SUBDIVISIONS**  
STATE BOUNDARY  
COUNTY BOUNDARY  
TOWN BOUNDARY  
VILLAGE BOUNDARY  
URBAN COMPACT BOUNDARY  
WATER BODY  
STREAM OR BROOK
- BRIDGE OR CULVERT**  
BRIDGE OR CULVERT > 20'  
BRIDGE OR CULVERT 6' - 20'  
VOBCIT BRIDGE  
VOBCIT CULVERT > 6'
- FEDERAL CLASSIFICATION IDENTIFIER**  
FAU URBAN ARTERIAL OR COLLECTOR  
MA MINOR ARTERIAL  
MJC MAJOR COLLECTOR  
MNC MINOR COLLECTOR  
PA PRINCIPAL ARTERIAL
- B34 / C34 STATE BRIDGE OR CULVERT IDENTIFIER**  
**B34 / C34 TOWN BRIDGE OR CULVERT IDENTIFIER**

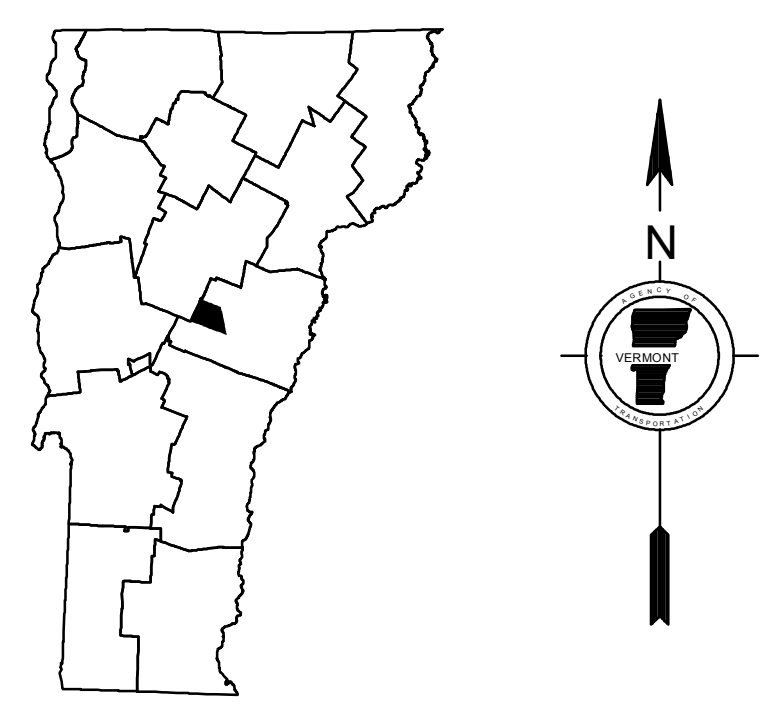

Vermont State Plane Coordinate System  
North American Datum of 1983  
SPCS\_Zone\_Identifier: 4400  
Geodetic Reference System 80  
4,000-meter grid, Easting - Northing

**DISCLAIMER:**  
The untraveled highways (laid-out town highways), discontinued highways, and legal trails hereon are those of which the Agency of Transportation has record; others may exist.

Highway and bridge data by the Agency of Transportation. Town short structures are drawn from the Vermont Online Bridge & Culvert Inventory Tool (VOBCIT) database. All other data from the Vermont Center for Geographic Information. Only named streams are shown.

**VERMONT GENERAL HIGHWAY MAP**  
**Town of Brookfield**  
ORANGE COUNTY  
Transportation District #6

Prepared by the  
Vermont Agency of Transportation  
Division of Policy, Planning and Intermodal Development  
in cooperation with  
U.S. Department of Transportation  
Federal Highway Administration

Mileage as of February 10, 2014  
Map prepared October 02, 2014  
SCALE 1:31,680