

TOWN HWY. No.	LENGTH IN MILES CLASS 3	LENGTH IN MILES CLASS 4
7	0.24	
10	2.88	
11		(0.19)
12	2.16	(0.50)
13	1.40	
14		(0.50)
15	0.19	(1.61)
16	0.15	
17	2.55	
18	0.10	
19	4.00	
20		(0.10)
21	0.40	
22	3.30	
23		(0.80)
24	1.13	
26	0.24	
27	0.95	
28	0.52	
31	2.35	
32	1.26	(0.69)
33	0.15	(0.42)
34	1.78	(1.12)
35	3.74	
36	0.30	
37	0.47	(0.30)
38	0.64	(0.30)
39	0.62	(0.55)
40	0.12	
41	0.20	(0.50)
42		(0.25)
43	0.06	(0.64)
44	0.38	
45	0.27	
46		(1.30)
47	0.80	
48	2.55	
49	0.05	
50	0.50	
51	0.23	
52	0.55	
53		(0.50)
54	0.41	(0.54)
55		(0.10)
56	0.05	
57	0.48	(0.32)
58	0.35	
59	0.71	(0.51)
61	0.12	
62		(0.12)
63	0.08	
64		(0.07)
65	1.18	
66	0.07	
67		(0.15)
68		(0.10)
69	0.08	
70		(0.05)
71	0.07	
74	1.00	
75		(0.20)
76		(0.35)
TOTAL	41.83	12.78

MILEAGE SUMMARY

CLASS 2		
TH-1	3.840	
TH-2	3.250	
TH-3	3.250	
TH-4	0.750	
TH-5	0.480	
TH-6	1.200	
TH-7	2.120	
TH-8	0.950	
TH-9	3.330	
TOTAL CLASS 2	19.180	
CLASS 3		
TOTAL CLASS 3	41.83	
TOTAL TOWN	61.010	
STATE HIGHWAY		
VT-12	5.525	
VT-14	6.877	
VT-65	5.222	
TOTAL STATE HIGHWAY	17.424	
TOTAL STATE	17.424	
INTERSTATE		
I-89	6.166	
TOTAL INTERSTATE	6.166	
TOTAL INTERSTATE	6.166	
TOTAL, TRAVELED HIGHWAYS, FEB. 10, 2013:	84.600	

(Excludes Class 4, Legal Trail, and Unidentified Corridor Mileage)

TOWN HWY. No.	LENGTH IN MILES "NOT UP TO STANDARD"
59	(0.02)
TOTAL	0.02

* The sections of the town highways listed above are legally Class 3, but have been deemed "Not Up To Standard" and are functionally Class 4 Town Highways

LEGAL TRAIL No.	LENGTH IN MILES LEGAL TRAIL
1	(0.60)
2	(0.98)
3	(0.30)
TOTAL	1.88

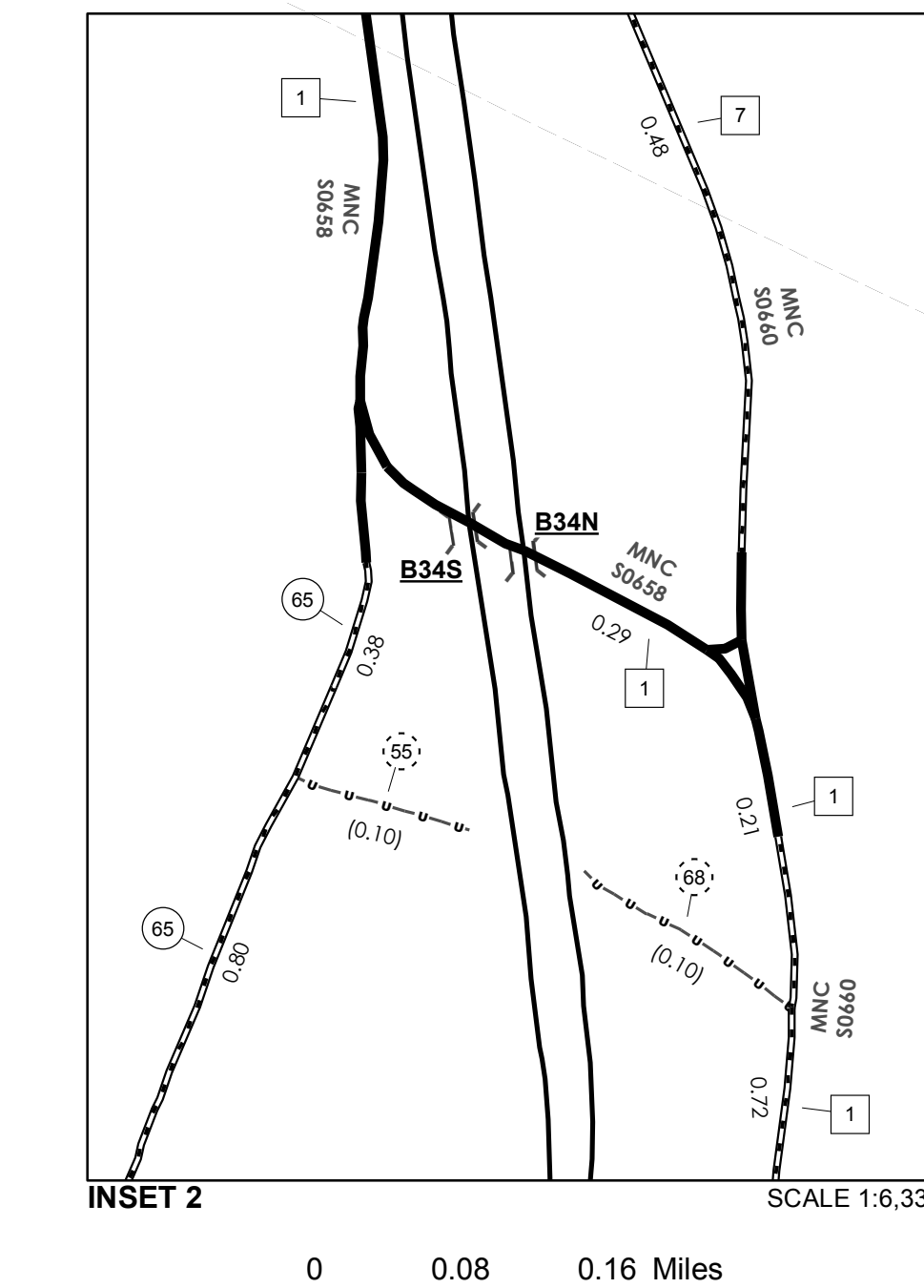
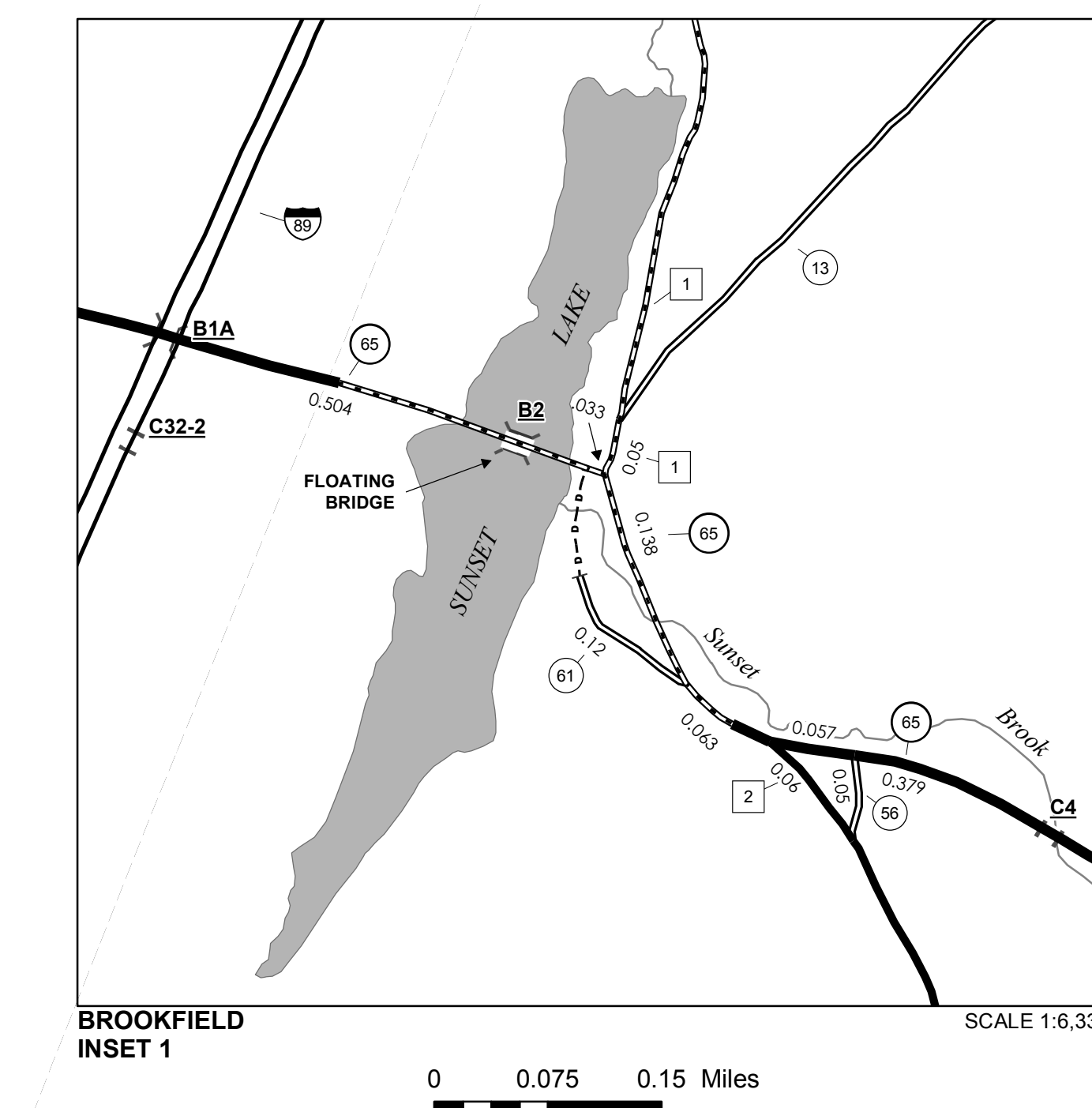
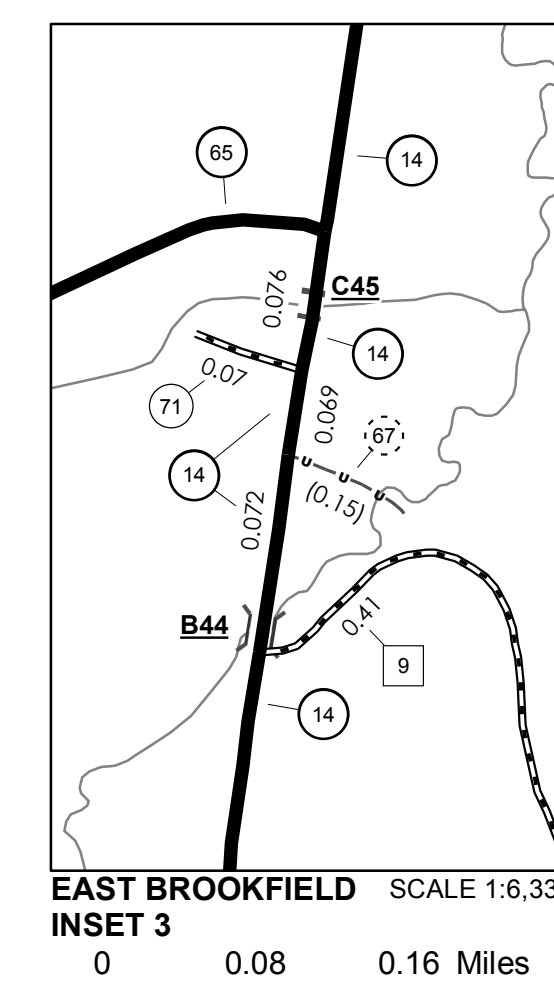
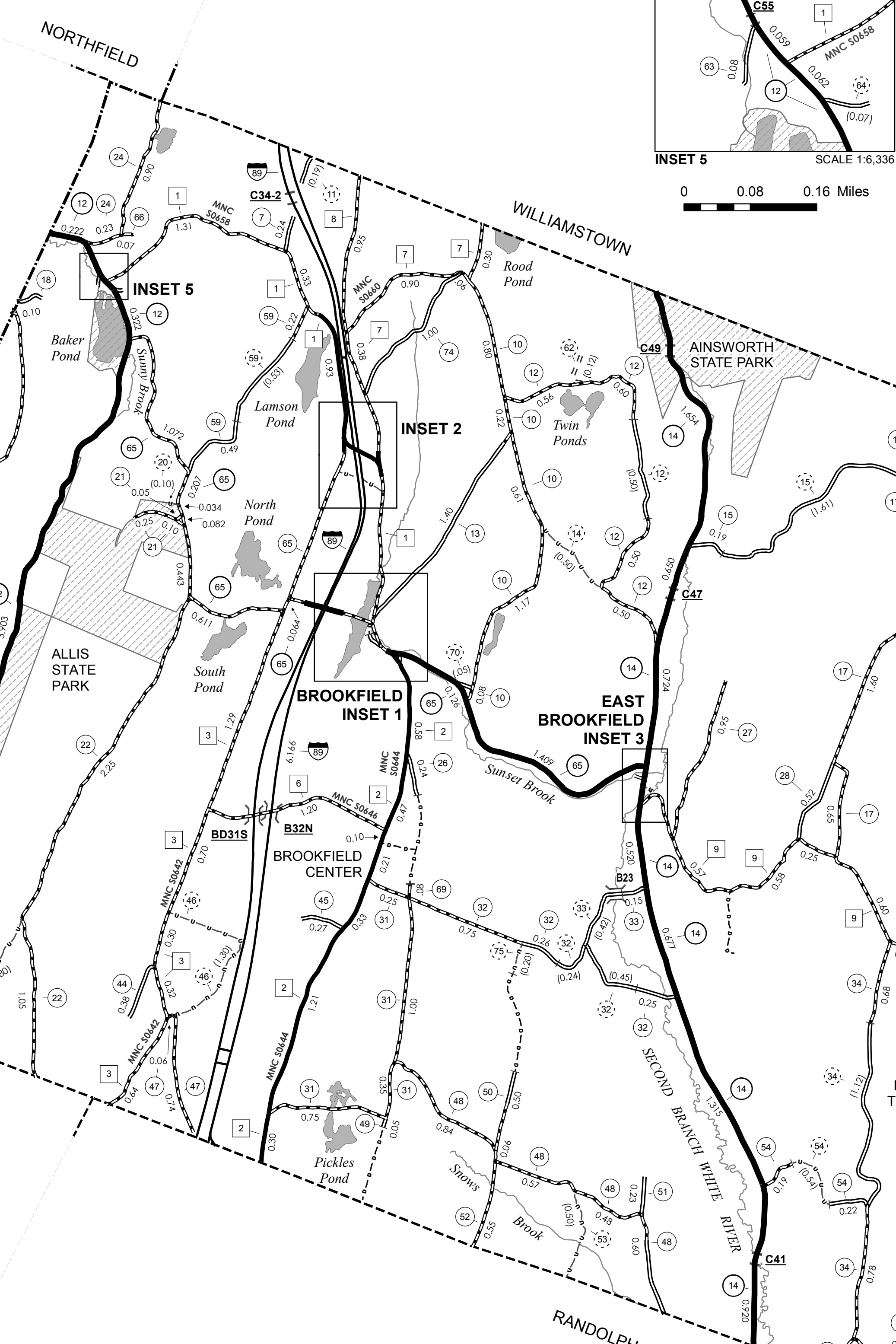
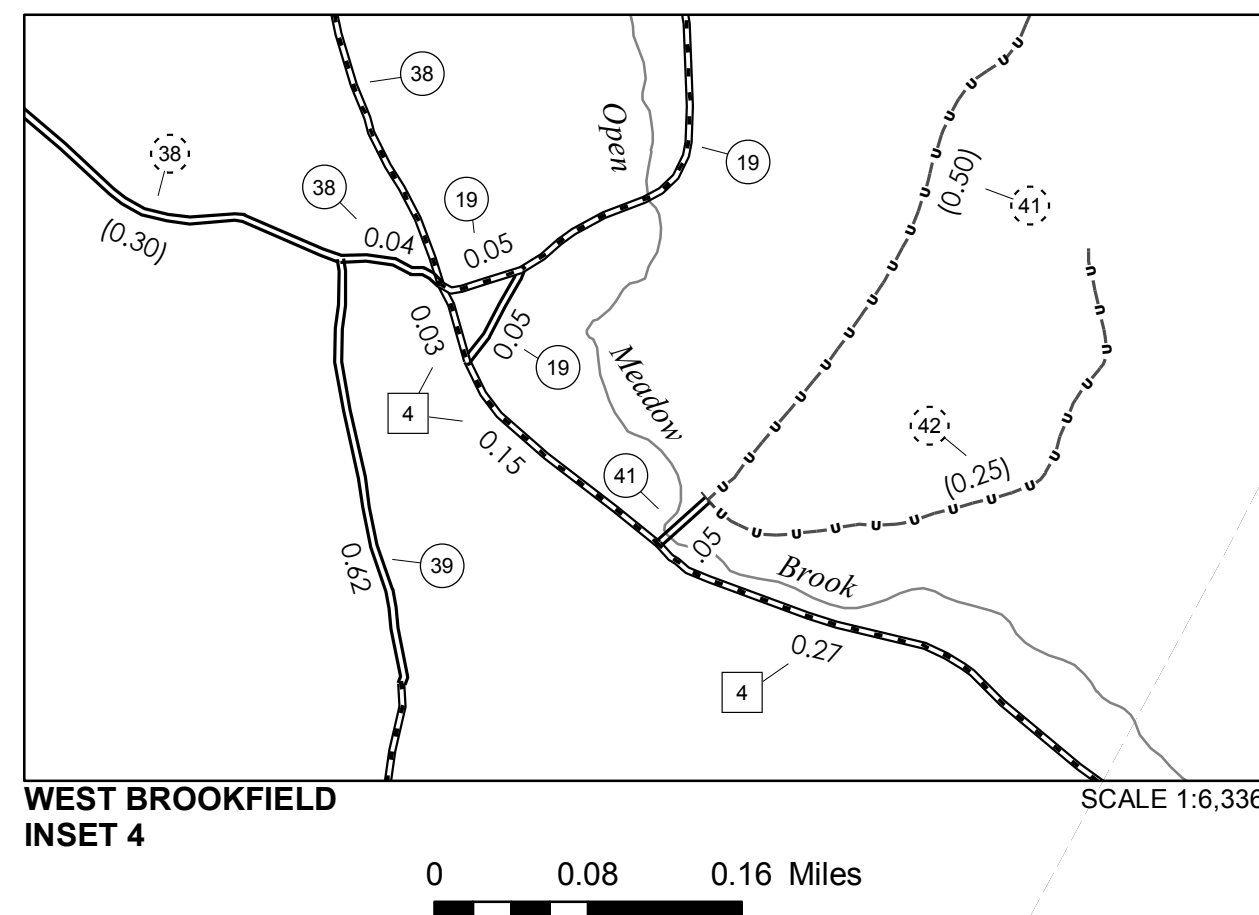

- HIGHWAYS**
- INTERSTATE
 - U.S. ROUTE
 - STATE ROUTE
 - CLASS 1
 - CLASS 2
 - CLASS 3
 - CLASS 4
 - LEGAL TRAIL
- INTERSTATE OR DIVIDED HIGHWAY
STATE - HARD SURFACE OR PAVED
TOWN - HARD SURFACE OR PAVED
GRAVEL
SOIL OR GRADED AND DRAINED EARTH
UNIMPROVED OR PRIMITIVE
IMPASSABLE OR UNTRAVELED
LEGAL TRAIL
DISCONTINUED
HIGHWAY CLASS CHANGE
RAILROAD
INACTIVE RAILROAD
NFR NATIONAL FOREST ROAD
SFH STATE FOREST HIGHWAY
P PARK AND RIDE
- PUBLIC LAND - GREEN MOUNTAIN NATIONAL FOREST**
PUBLIC LAND - STATE/MUNICIPAL
- POLITICAL SUBDIVISIONS**
- STATE BOUNDARY
 - COUNTY BOUNDARY
 - TOWN BOUNDARY
 - VILLAGE BOUNDARY
 - URBAN COMPACT BOUNDARY
 - WATER BODY
 - STREAM OR BROOK
- BRIDGE OR CULVERT**
- BRIDGE OR CULVERT GREATER THAN 20'
 - BRIDGE OR CULVERT 6' - 20'
- FEDERAL CLASSIFICATION IDENTIFIER**
- FAU URBAN ARTERIAL OR COLLECTOR
 - MA MINOR ARTERIAL
 - MJC MAJOR COLLECTOR
 - MNC MINOR COLLECTOR
 - PA PRINCIPAL ARTERIAL
- B34 / C34** STATE BRIDGE OR CULVERT IDENTIFIER
B34 / C34 TOWN BRIDGE OR CULVERT IDENTIFIER

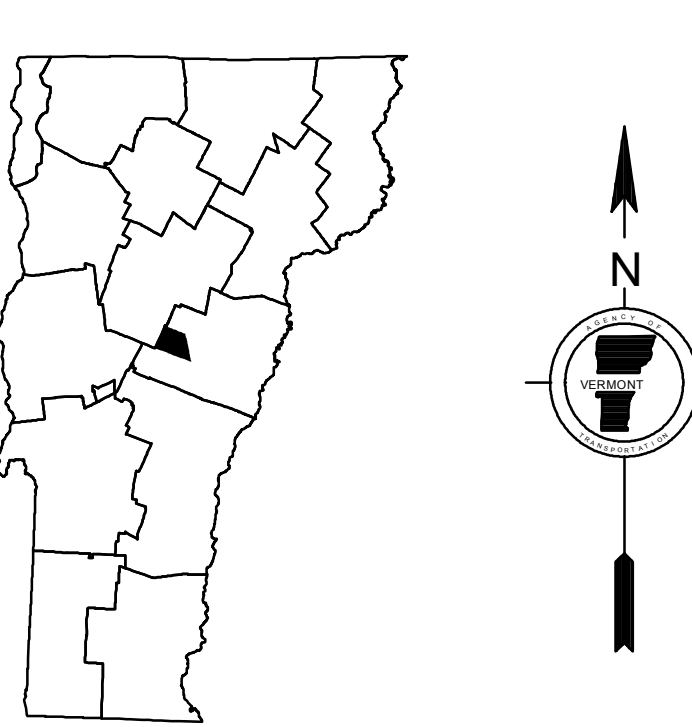

DISCLAIMER:
The untraveled highways (laid-out town highways), discontinued highways, and legal trails hereon are those of which the Agency of Transportation has record; others may exist.

Highway and bridge data by the Agency of Transportation. All other data from the Vermont Center for Geographic Information. Only named streams are shown.

Vermont State Plane Coordinate System
North American Datum of 1983
SPCS_Zone_Identifier: 4400
Geodetic Reference System 80
4,000-meter grid, Easting - Northing

VERMONT GENERAL HIGHWAY MAP
Town of Brookfield
ORANGE COUNTY
Transportation District #6

Prepared by the
Vermont Agency of Transportation
Division of Policy, Planning and Intermodal Development
in cooperation with
U.S. Department of Transportation
Federal Highway Administration

Mileage as of February 10, 2013
Map prepared October 09, 2013
SCALE 1:31,680