

476,000 480,000 484,000 488,000 492,000 496,000 500,000

MILEAGE SUMMARY

CLASS 1			
TH-1	0.950		
TH-2	0.746		
TH-3	1.126		
TOTAL CLASS 1	2.822		
CLASS 2			
TH-2	2.470		
TH-3	0.450		
TH-4	1.410		
TH-5	5.880		
TH-6	5.200		
TOTAL CLASS 2	15.410		
CLASS 3			
TOTAL CLASS 3	72.760		
TOTAL TOWN	90.992		
STATE HIGHWAY			
VT-12	2.181		
VT-15	4.367		
VT-15A	1.464		
VT-100	5.265		
TOTAL STATE HIGHWAY	13.277		
TOTAL STATE	13.277		

TOTAL, TRAVELED HIGHWAYS, FEB. 10, 2008: 104.269
(Excludes Class 4 and Legal Trail Mileage)

- HIGHWAYS**
- INTERSTATE
 - U.S. ROUTE
 - STATE ROUTE
 - CLASS 1
 - CLASS 2
 - CLASS 3
 - CLASS 4
 - LEGAL TRAIL
- PARK AND RIDE**
- FEDERAL CLASSIFICATION IDENTIFIER
 - FAU URBAN ARTERIAL OR COLLECTOR
 - MA MINOR ARTERIAL
 - MJC MAJOR COLLECTOR
 - MNC MINOR COLLECTOR
 - PA PRINCIPAL ARTERIAL
- INTERSTATE OR DIVIDED HIGHWAY**
- STATE - HARD SURFACE OR PAVED**
- TOWN - HARD SURFACE OR PAVED**
- GRAVEL
- SOIL OR GRADED AND DRAINED EARTH
- UNIMPROVED OR PRIMITIVE
- IMPASSABLE OR UNTRAVELED
- LEGAL TRAIL
- DISCONTINUED
- HIGHWAY CLASS CHANGE
- RAILROAD
- INACTIVE RAILROAD
- PUBLIC LAND**
- POLITICAL SUBDIVISIONS**
- STATE BOUNDARY
 - COUNTY BOUNDARY
 - TOWN BOUNDARY
 - VILLAGE BOUNDARY
 - URBAN COMPACT BOUNDARY
- OPEN WATER
- STREAM OR BROOK
- BRIDGE OR CULVERT**
- BRIDGE OR CULVERT GREATER THAN 20'
 - BRIDGE OR CULVERT 6' - 20'
- B34 / C34 STATE BRIDGE OR CULVERT IDENTIFIER**
- B34 / C34 TOWN BRIDGE OR CULVERT IDENTIFIER**

TOWN HWY. NO.	LENGTH IN MILES CLASS 3	LENGTH IN MILES CLASS 4						
-	7.74		42		(0.20)	79		0.11
6	0.32		43	1.10	(2.50)	80		0.54
7	3.05		44	0.15		82		0.08
8	0.10		45	0.45		83		0.25
9	0.45		46		(0.45)	84		0.12
10	0.65		47		(0.47)	85		0.44
11	0.95		48		(0.23)	86		0.15
12	0.35		49	0.33	(0.97)	87		0.16
13	0.40		50	2.90		88		0.18
14	1.05		51		(0.20)	89		0.26
15	0.10		52	1.60		90		0.16
16	0.82		53	0.06	(0.34)	91		0.12
17	0.09		54	1.56		92		0.11
18	1.50		55	0.55		93	1.05	
19	0.10		56	0.60		96	1.18	
20	0.10		56		(0.50)	97	0.12	
21	0.47	(0.28)	57	1.50		98	0.37	
22	0.75	(0.45)	58	0.35		99	0.18	
23	3.65		59	0.69		100	0.20	
24		(0.24)	59		(0.46)	101	0.11	
25	0.85		60	3.25		102	0.10	
26	0.03		61	0.40	(0.49)	103	0.07	
27	0.78	(0.60)	61		(0.45)	104	0.15	
27		(0.12)	62		(0.25)	105	0.31	
28	0.45		63	0.35		106	0.40	
29	0.38	(0.82)	64	1.52		107	0.25	
30	6.25		65	0.15		108	0.07	
31	0.35		66	0.10		109	0.28	
32	0.55		67	0.61		110	0.10	
33	0.55		68		(0.10)	111	0.20	
34	0.10		69		(0.30)	112	0.15	
35	0.15		70	0.10	(0.15)	113	0.13	
36	0.75		71	0.70		114	0.20	
37	2.10		72	1.20		115	0.22	
38	0.10		73	0.15		116	0.40	
39	1.56		74	1.49		117	0.22	
40	1.15		77	0.22		118	0.47	
41	1.75		78	0.08		119	0.09	
						120	0.41	
TOTAL	72.76	10.57						

* This portion of town highway is Class 3, but is functionally Class 4

DISCLAIMER:

The untraveled highways (laid-out town highways), discontinued highways, and legal trails shown hereon are those of which the Agency of Transportation has record; others may exist.

Highway and bridge data by the Agency of Transportation, Policy & Planning Division. All other data from the Vermont Center for Geographic Information.

STRUCTURES - SURFACE WATER NOTE:

Town short structures (bridges or culverts from 6-feet to less than 20-feet) were not represented due to inconsistencies in the data.

The surface waters are from the Vermont Hydrological Dataset (VHD). Only the named streams are shown.

Vermont State Plane Coordinate System
North American Datum of 1983
SPCS Zone Identifier: 4400
Geodetic Reference System 80
4,000-meter grid, Easting - Northing

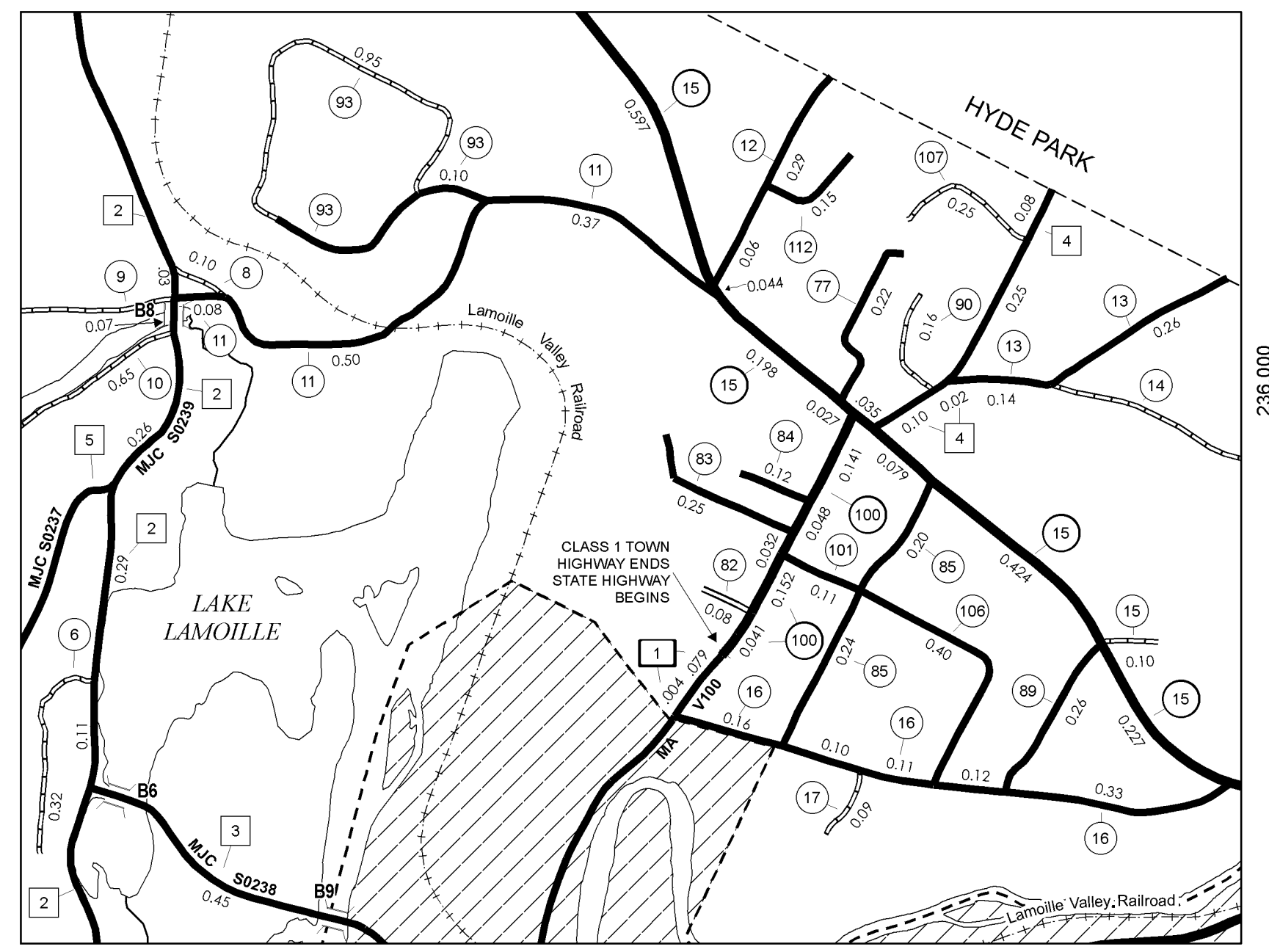
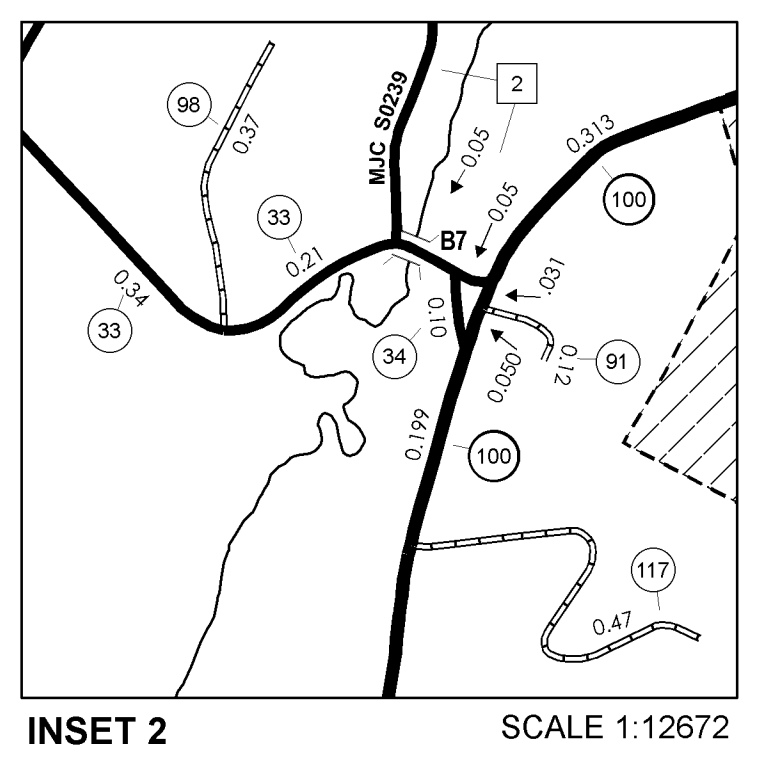

SCALE FOR INSETS 1:12672
0 0.2 0.4 Miles

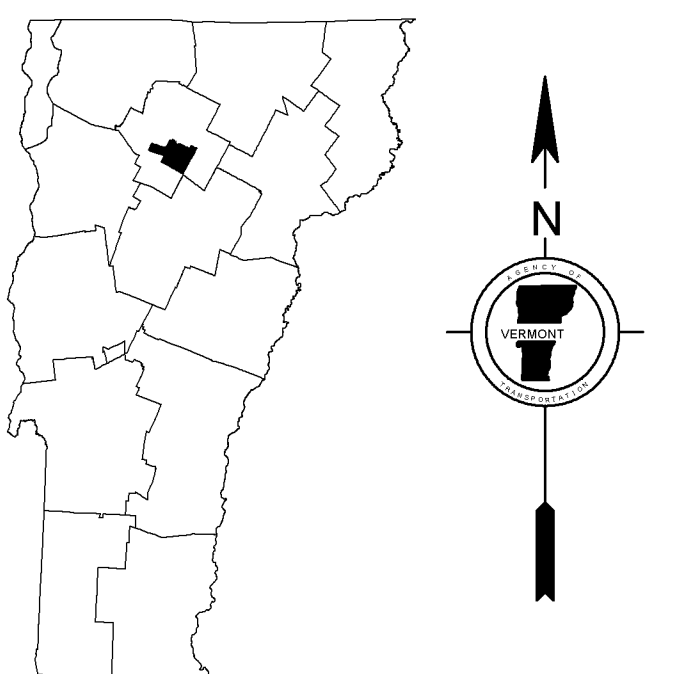
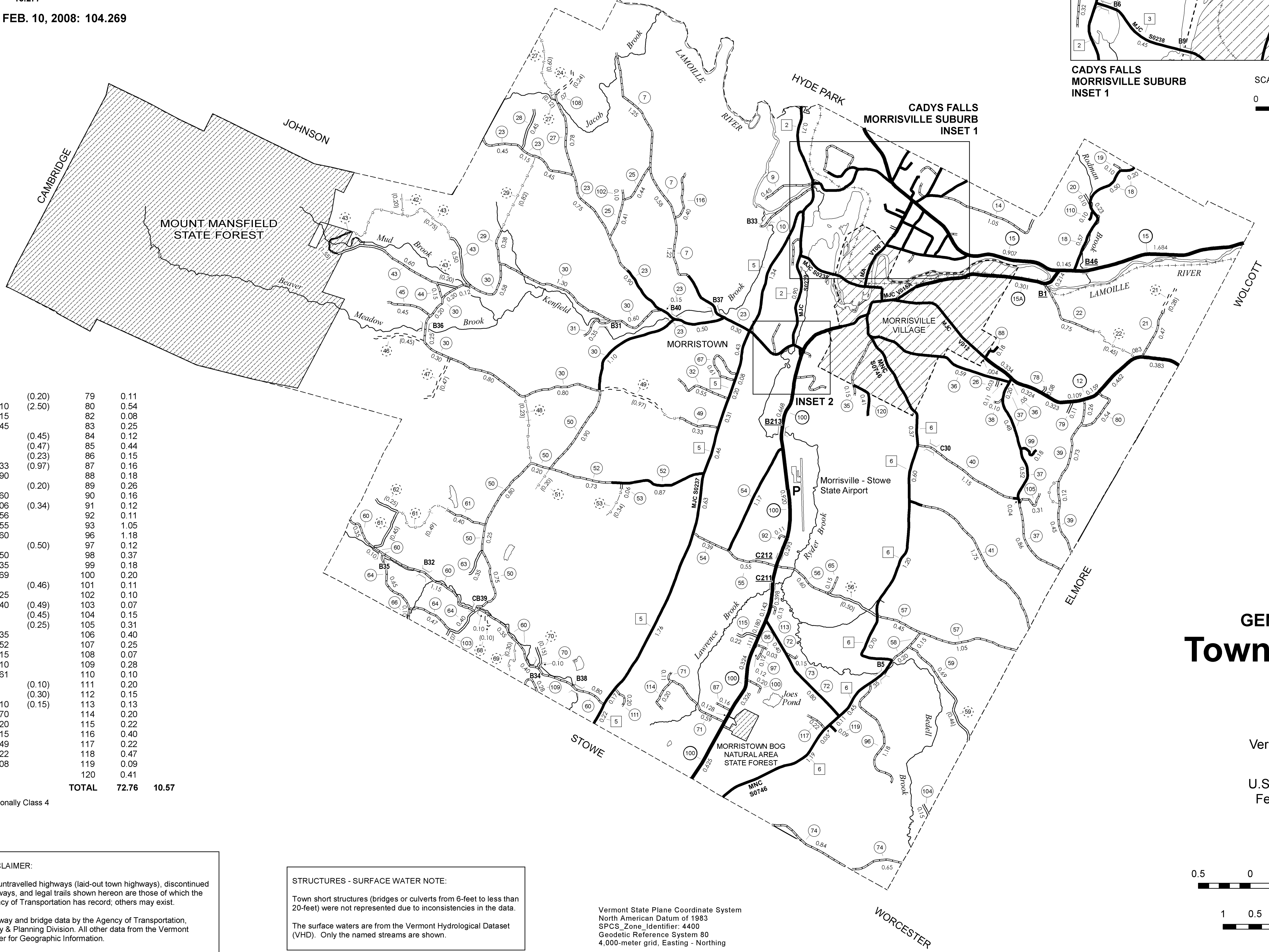

VERMONT GENERAL HIGHWAY MAP
Town of Morrystown
LAMOILLE COUNTY

Transportation District #6

Prepared by the
Vermont Agency of Transportation
Policy & Planning Division
in cooperation with
U.S. Department of Transportation
Federal Highway Administration

Mileage as of: February 10, 2008
Map generated: September, 2008

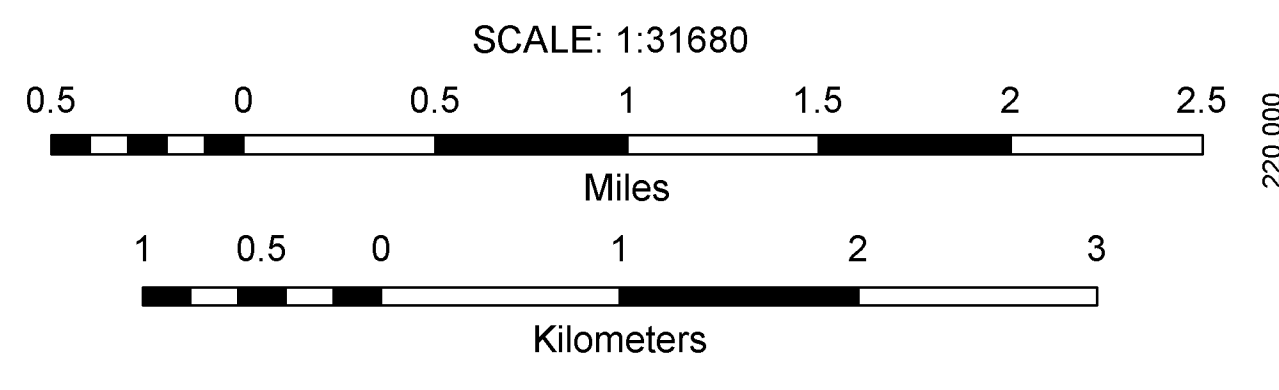

476,000 480,000 484,000 488,000 492,000 496,000 500,000

