

MILEAGE SUMMARY

CLASS 2			
TH-1	7.040		
TH-2	0.280		
TH-3	4.530		
TH-4	1.200		
TH-5	0.300		
TH-6	0.170		
TOTAL CLASS 2		13.520	
CLASS 3			
TOTAL CLASS 3		50.16	
TOTAL TOWN		63.680	
STATE HIGHWAY			
VT-15	2.955		
VT-100	6.527		
VT-100C	0.087		
TOTAL STATE HIGHWAY		9.569	
STATE HIGHWAY - Ramps			
VT-15	0.033		
TOTAL STATE HIGHWAY - Ramps		0.033	
TOTAL STATE		9.602	
TOTAL, TRAVELED HIGHWAYS, FEB. 10, 2022:		73.282	

(Excludes Class 4 and Legal Trail Mileage)

TOWN HWY. No.	LENGTH IN MILES CLASS 3	LENGTH IN MILES CLASS 4
6	4.50	
7	7.80	
8	0.25	
9		(0.33)
10	1.65	
11		(0.20)
12		(0.50)
13	2.70	
14	0.32	
15	0.22	(1.98)
16	1.71	
17	0.33	
18	0.16	
19	0.16	
21	0.45	
22		(0.44)
23		(0.25)
25	0.26	(0.14)
26	2.50	
29	0.23	(0.07)
30	0.58	(0.32)
31	0.80	(0.40)
32	0.20	
33	0.15	
34	0.09	
35	0.45	
36	1.40	
37	0.40	
38	0.35	
39	0.22	
40	0.75	
41	0.45	
42		(0.05)
43	0.04	
44	0.70	
45		(0.10)
46	1.75	
47	0.15	
48	0.20	
49	1.00	
50	3.35	(0.38)
51	0.05	(0.10)
52	0.08	
53	1.80	
54	0.15	
55	0.32	
56	0.15	(0.20)
57	0.50	
58	1.30	
59	0.85	(0.47)
60	0.74	
61	0.15	
62	0.10	(0.04)
63	0.34	
64	0.08	
65	0.10	
66	0.20	
67	0.12	(0.08)
68	0.09	
69	0.06	
70	0.08	(0.06)
71		(0.13)
72	0.12	(0.13)
74	0.12	(0.54)
75	0.55	(0.30)
76		
77	0.21	
78	0.57	(0.11)
79	0.36	
80	0.17	
81	0.62	
82	0.12	
83	0.11	
84	0.18	
86	0.15	
87	0.41	
88	0.96	
89	0.31	
90	0.18	
91	0.40	
92	0.15	
93	0.42	
94	0.10	
95	0.23	
96	0.12	
97	0.19	
TOTAL	50.16	7.19

TOWN HWY. No.	LENGTH IN MILES "NOT UP TO STANDARD"
31	(0.02)
TOTAL	0.02

* The sections of the town highways listed above are legally Class 3, but have been deemed "Not Up To Standard" and are functionally Class 4 Town Highways

DISCLAIMER:
The untraveled highways (laid-out town highways), discontinued highways, and legal trails herein are those of which the Agency of Transportation has record; others may exist.

Highway and bridge data by the Agency of Transportation. Town short structures drawn from the VTCULVERTS (formerly VOBCIT) online database. All other data from the Vermont Open Geodata Portal. Only named streams shown.

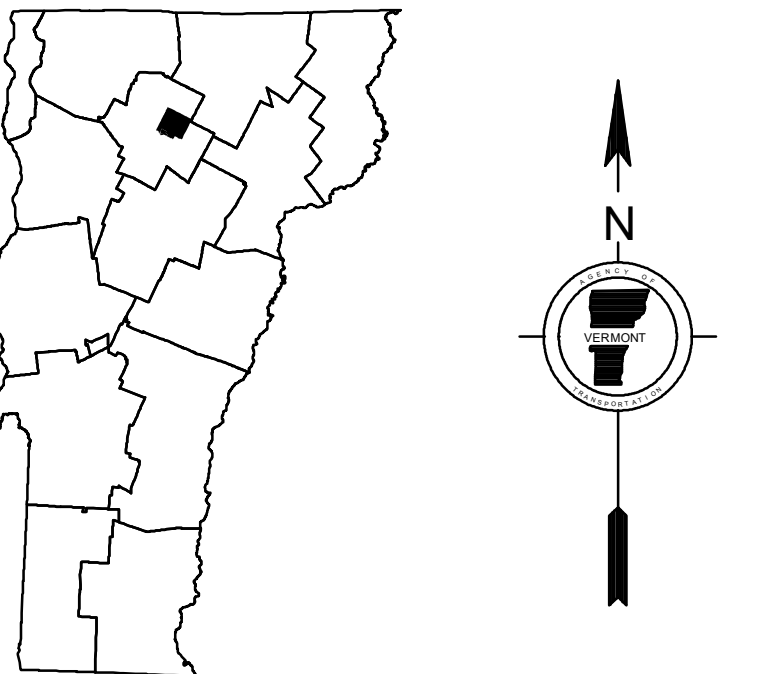
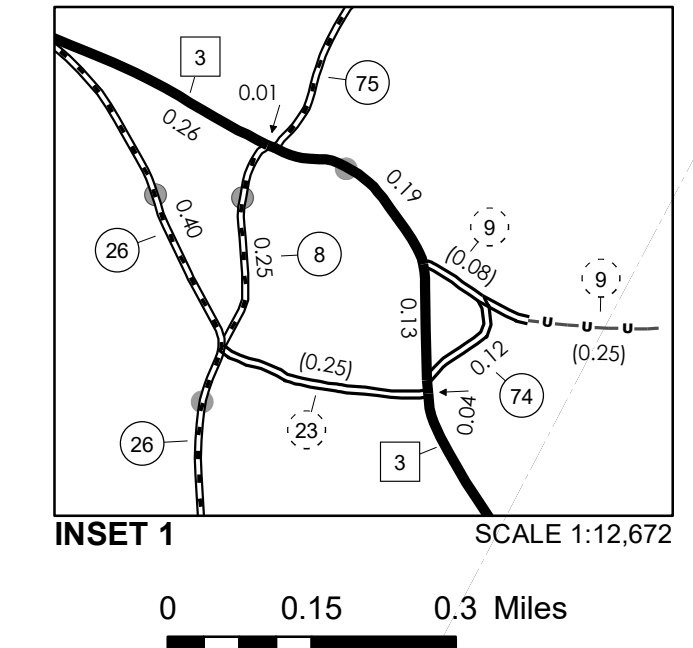
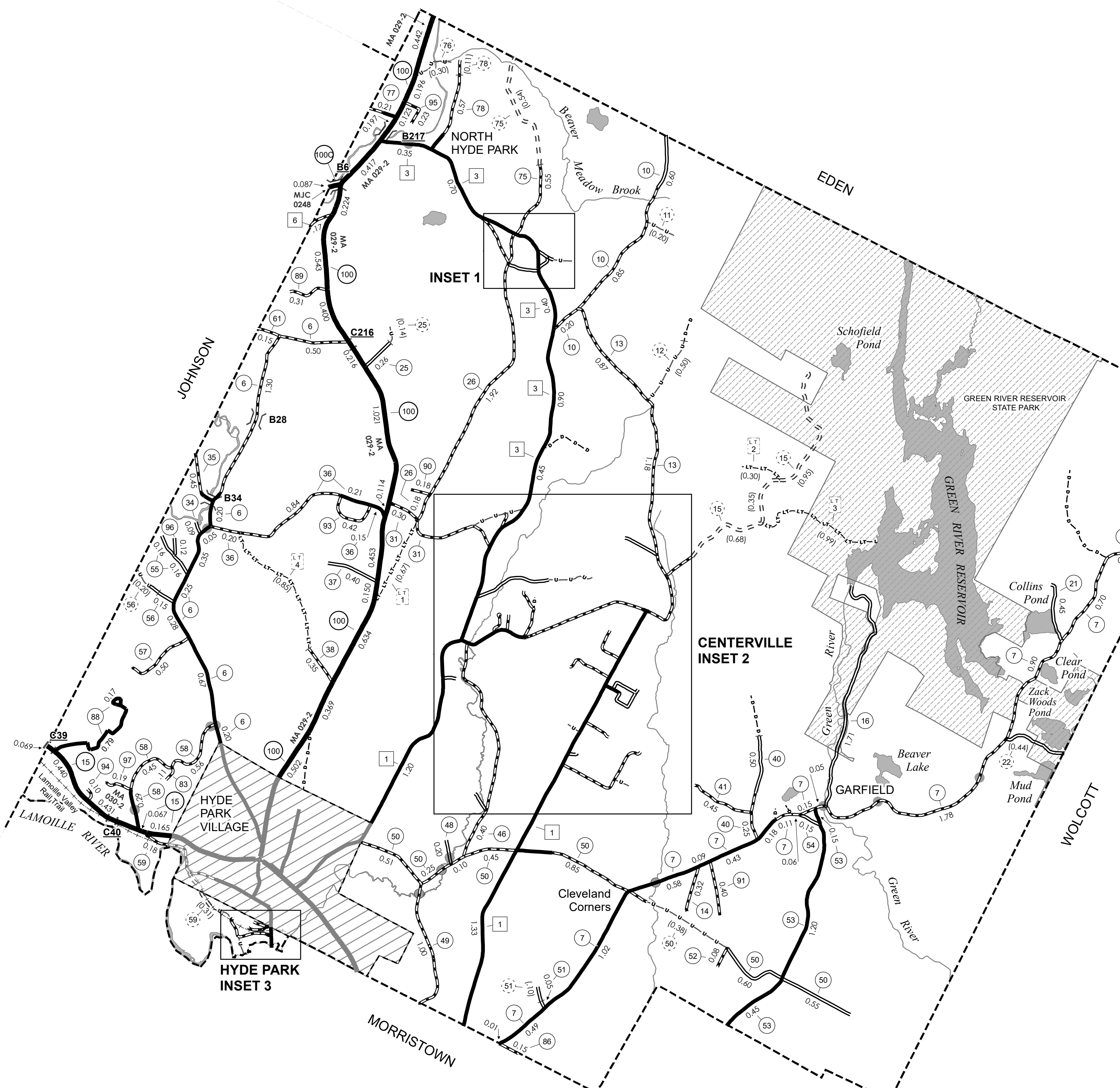
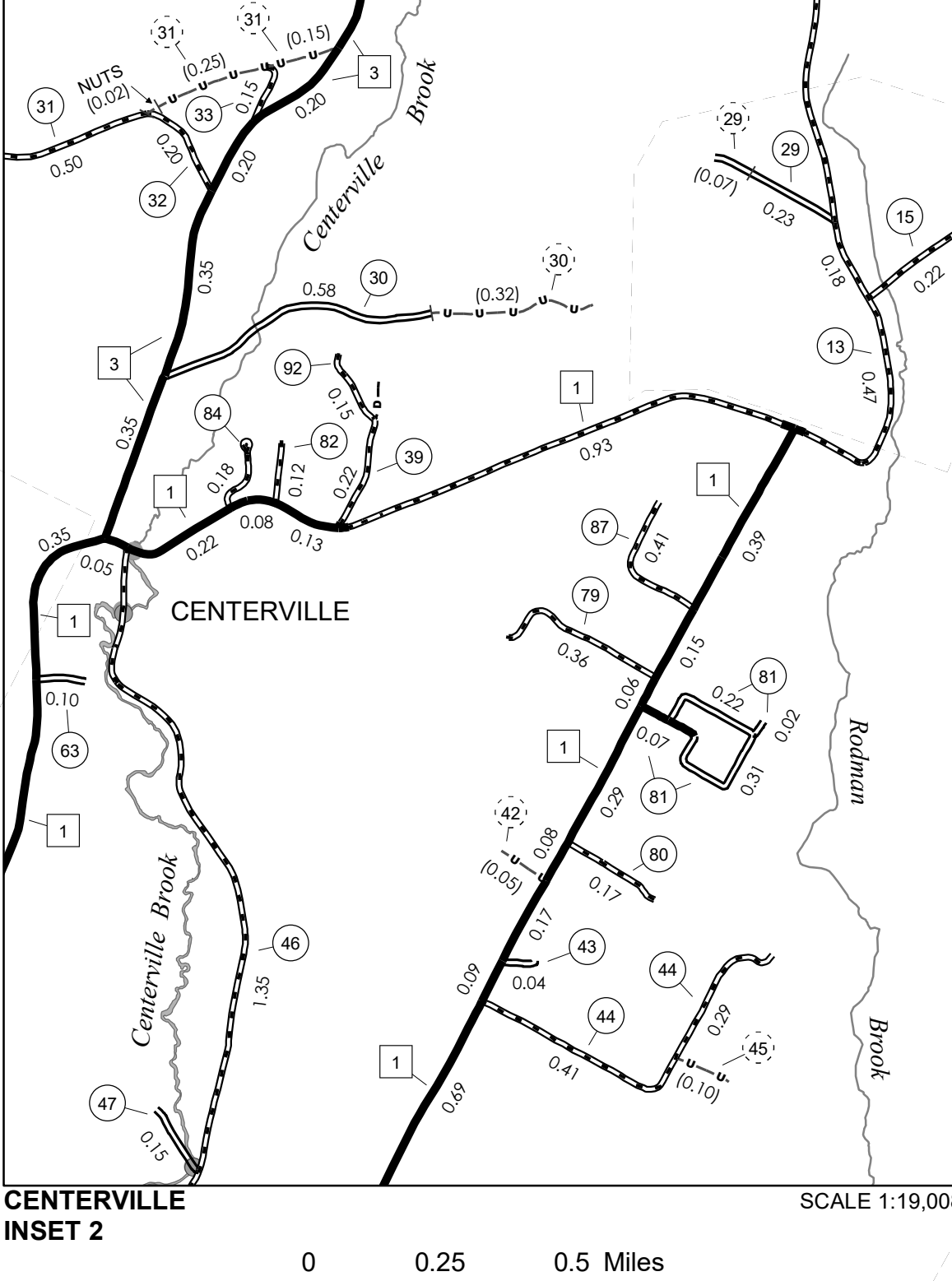
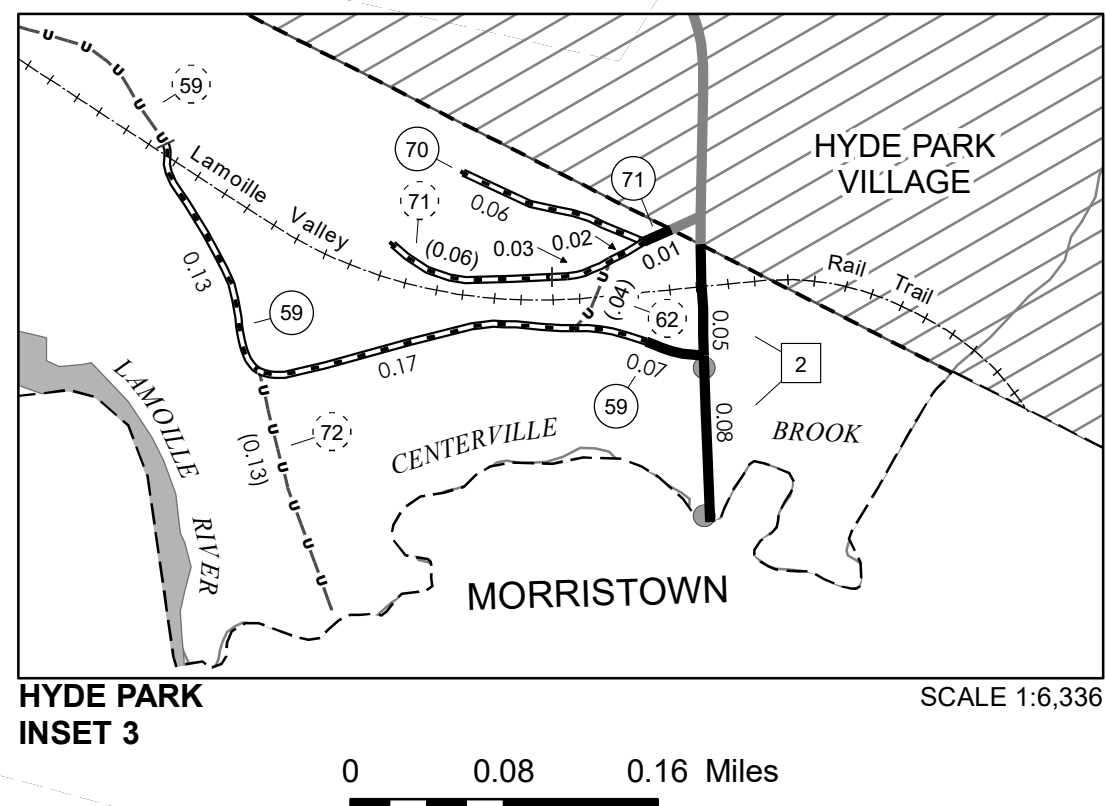

VERMONT
GENERAL HIGHWAY MAP
Town of Hyde Park

LAMOILLE COUNTY

Transportation District #8

Prepared by the
Vermont Agency of Transportation
Division of Policy, Planning and Intermodal Development
in cooperation with
U.S. Department of Transportation
Federal Highway Administration

Mileage as of February 10, 2022
Map prepared June 13, 2022

SCALE 1:31,680

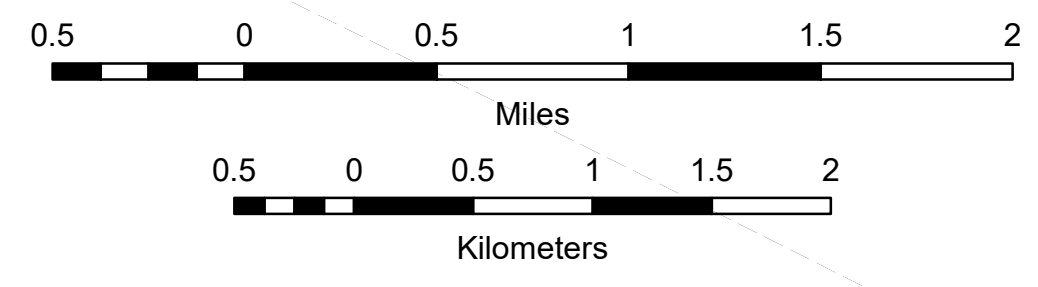

- HIGHWAYS**
- INTERSTATE
 - U.S. ROUTE
 - STATE ROUTE
 - CLASS 1
 - CLASS 2
 - CLASS 3
 - CLASS 4
 - LEGAL TRAIL
 - PARK AND RIDE
- BRIDGE OR CULVERT**
- BRIDGE OR CULVERT > 20'
 - BRIDGE OR CULVERT 6' - 20'
 - BIKE PATH STRUCTURE
 - VTCULVERTS BRIDGE
 - VTCULVERTS CULVERT > 6'
 - B34 / C34 STATE BRIDGE OR CULVERT IDENTIFIER
 - B34 / C34 TOWN BRIDGE OR CULVERT IDENTIFIER
- POLITICAL SUBDIVISIONS**
- STATE BOUNDARY
 - COUNTY BOUNDARY
 - TOWN BOUNDARY
 - VILLAGE BOUNDARY
 - URBAN COMPACT BOUNDARY
 - WATER BODY
 - STREAM OR BROOK
- FEDERAL CLASSIFICATION IDENTIFIER**
- MA MINOR ARTERIAL
 - MJC MAJOR COLLECTOR
 - MNC MINOR COLLECTOR
 - PA PRINCIPAL ARTERIAL
- OTHER FEATURES**
- INTERSTATE OR DIVIDED HIGHWAY
 - STATE - HARD SURFACE OR PAVED
 - TOWN - HARD SURFACE OR PAVED
 - GRAVEL
 - SOIL OR GRADED AND DRAINED EARTH
 - UNIMPROVED OR PRIMITIVE
 - IMPASSABLE OR UNTRAVELED
 - LEGAL TRAIL
 - DISCONTINUED
 - HIGHWAY CLASS CHANGE
 - RAILROAD
 - INACTIVE RAILROAD
 - PUBLIC LAND - NATIONAL FOREST
 - PUBLIC LAND - STATE/MUNICIPAL
 - NATIONAL FOREST ROAD
 - UNITED STATES GOV. HWY.

Vermont State Plane Coordinate System
North American Datum of 1983
SPCS_Zone_Identifier: 4400
Geodetic Reference System 80
4,000-meter grid, Easting - Northing