

TOWN HWY. No.	LENGTH IN MILES CLASS 3	LENGTH IN MILES CLASS 4
6	4.50	
7	7.80	
8	0.25	
9		(0.33)
10	1.65	
11		(0.20)
12		(0.50)
13	2.70	
14	0.32	
15	0.22	(1.98)
16	1.71	
17	0.50	
18	0.16	
19	0.16	
21	0.45	
22		(0.44)
23		(0.25)
25	0.26	(0.14)
26	2.50	
27		(0.05)
29	0.23	(0.07)
30	0.58	(0.32)
31	0.80	(0.40)
32	0.20	
33	0.15	
34	0.09	
35	0.45	
36	1.40	
37	0.40	
38	0.35	(0.85)
39	0.27	(0.03)
40	0.75	
41	0.45	
42		(0.05)
43	0.04	
44	0.70	
46		(0.10)
47	1.75	
48	0.15	
49	1.00	
50	3.35	(0.38)
51	0.05	(0.10)
52	0.08	
53	1.80	
54	0.15	
55	0.32	
56	0.15	(0.20)
57	0.50	
58	1.30	
59	0.94	(0.55)
60	0.74	
61	0.15	
62		(0.04)
63	0.10	
64	0.35	
65	0.08	
66	0.10	
67	0.20	
68	0.12	(0.08)
69	0.09	
70	0.06	
71	0.14	
72		(0.06)
73	0.12	(0.05)
74	0.12	
75	0.55	(0.54)
76		(0.30)
77	0.21	
78	0.57	
79	0.36	(0.11)
80	0.17	
81	0.62	
82	0.12	
83	0.11	
84	0.18	
86	0.15	
87	0.41	
88	0.73	
89	0.31	
90	0.18	
91	0.40	
92	0.09	
93	0.42	
94	0.10	
95	0.23	
96	0.12	
98	0.02	
TOTAL	50.06	8.12

MILEAGE SUMMARY

CLASS 2	LENGTH	TOTAL CLASS 2
TH-1	7.350	
TH-2	0.280	
TH-3	4.530	
TH-4	1.200	
TH-5	0.300	
TH-6	0.170	
TOTAL CLASS 2		13.830

CLASS 3	LENGTH	TOTAL CLASS 3
VT-15	2.955	
VT-100	6.527	
VT-100C	0.087	
TOTAL STATE HIGHWAY		9.569

STATE HIGHWAY - Ramps	LENGTH	TOTAL STATE HIGHWAY - Ramps
VT-15	0.033	
TOTAL STATE HIGHWAY - Ramps		0.033
TOTAL STATE		9.602

TOTAL, TRAVELED HIGHWAYS, FEB. 10, 2017: 73.492
(Excludes Class 4 and Legal Trail Mileage)

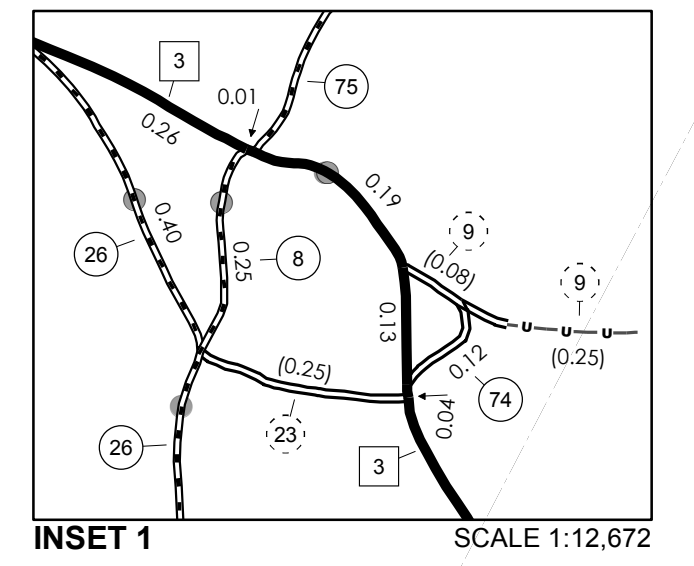
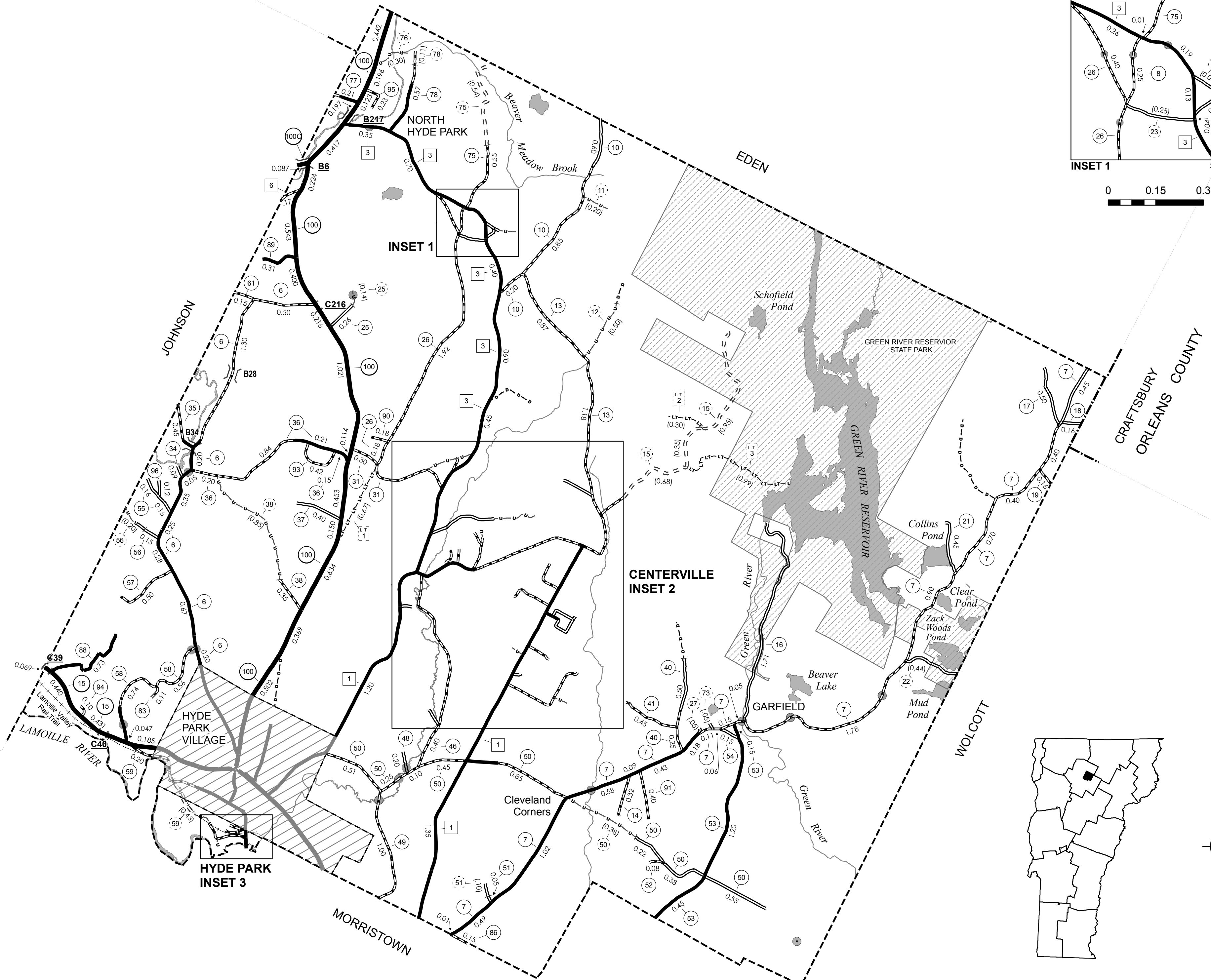
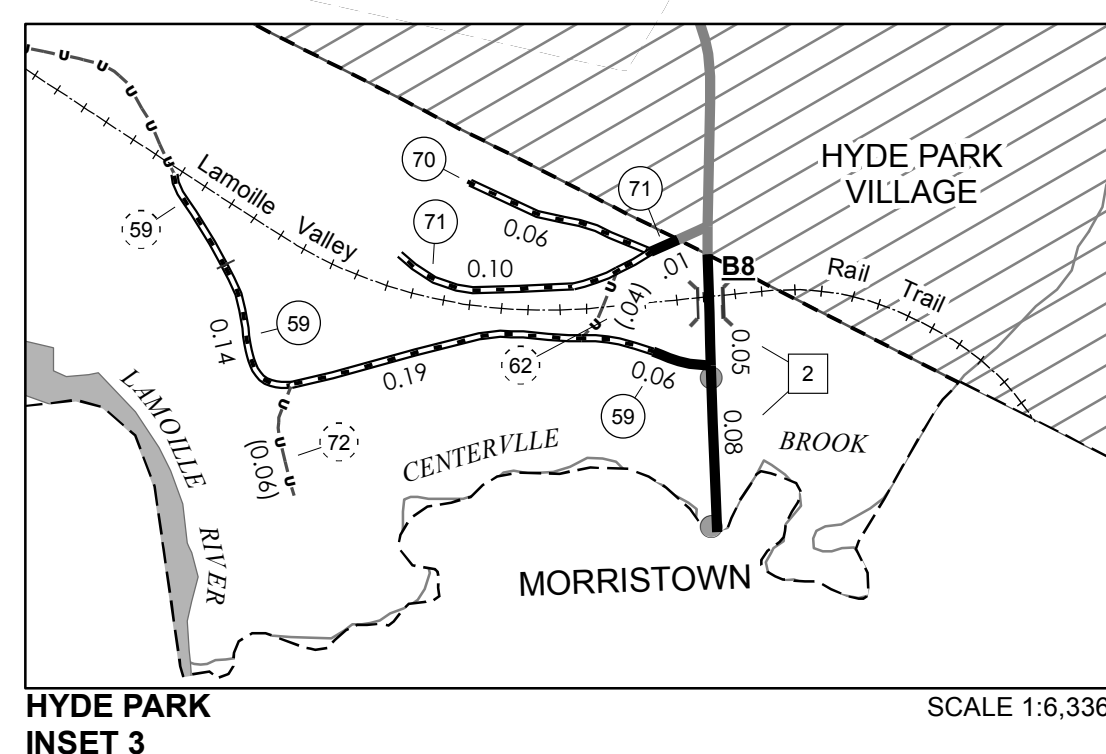
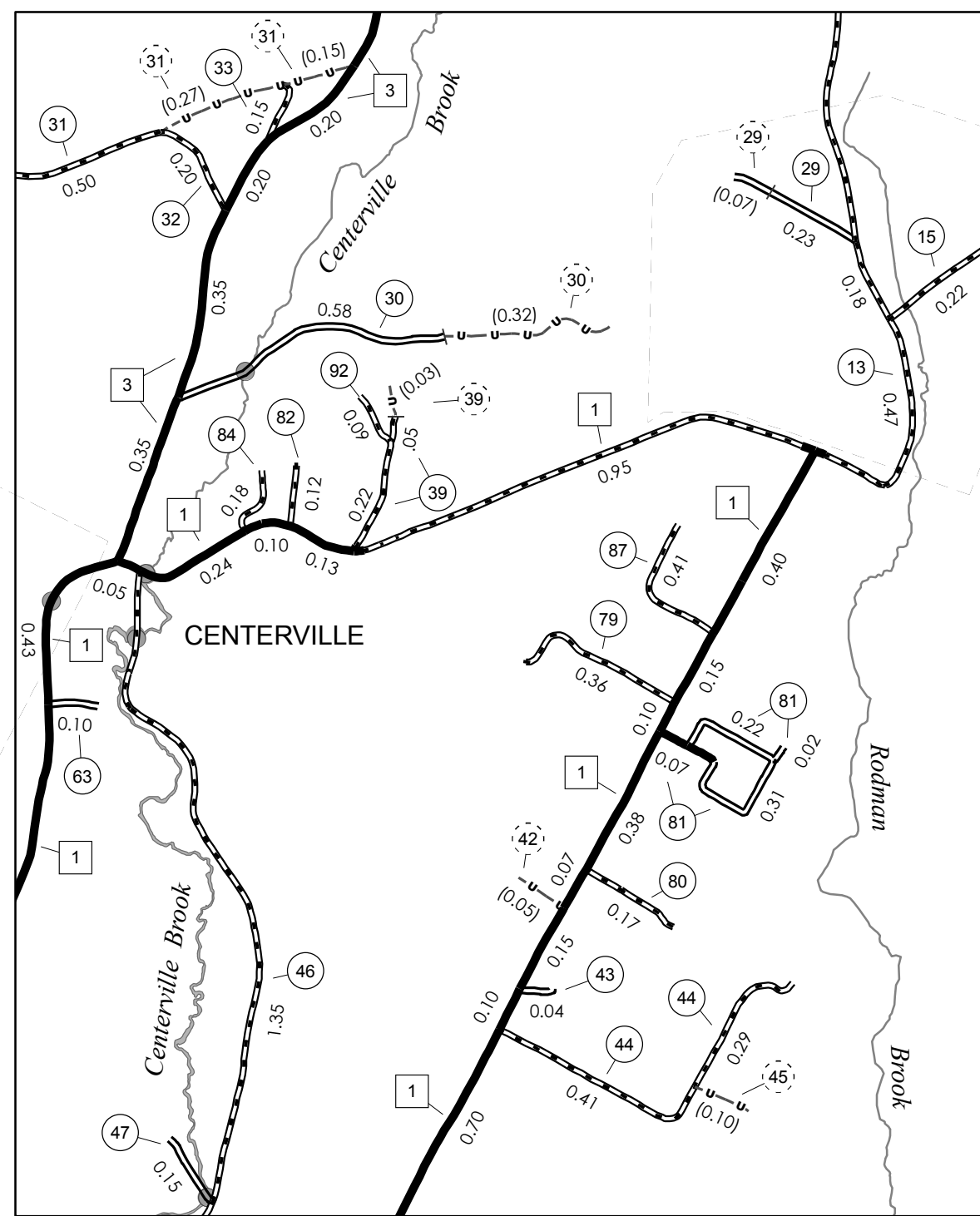

0 0.15 0.3 Miles

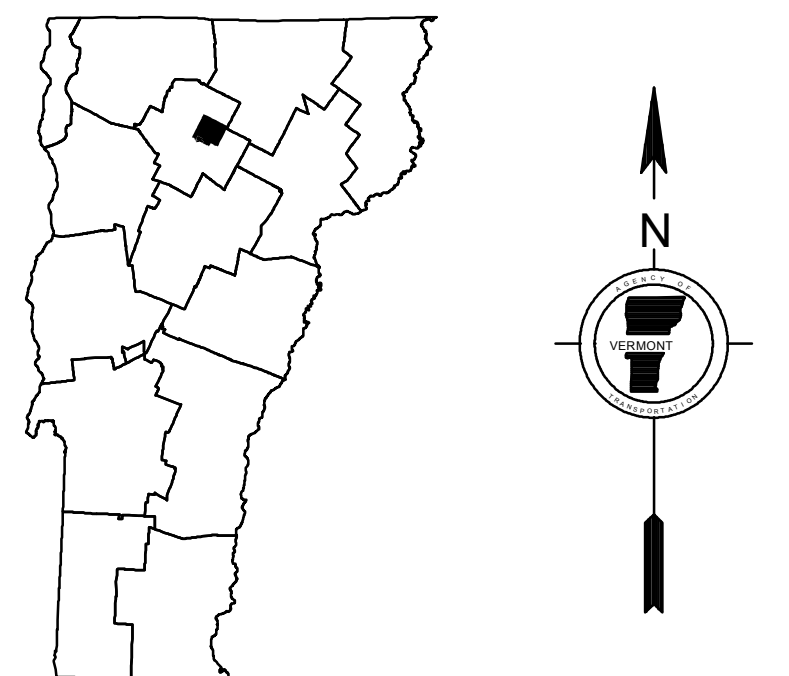

VERMONT
GENERAL HIGHWAY MAP
Town of Hyde Park

LAMOILLE COUNTY

Transportation District #8

Prepared by the
Vermont Agency of Transportation
Division of Policy, Planning and Intermodal Development
in cooperation with

U.S. Department of Transportation
Federal Highway Administration

Mileage as of February 10, 2017
Map prepared June 23, 2017

SCALE 1:31,680

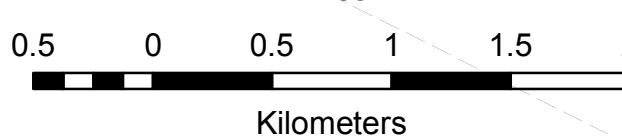
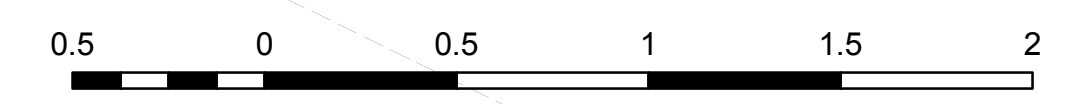

TOWN HWY. No.	LENGTH IN MILES "NOT UP TO STANDARD"
31	(0.02)
TOTAL	0.02

* The sections of the town highways listed above are legally Class 3, but have been deemed "Not Up to Standard" and are functionally Class 4 Town Highways

LEGAL TRAIL No.	LENGTH IN MILES
1	(0.67)
2	(0.30)
3	(0.99)
TOTAL	1.96

DISCLAIMER:
The untraveled highways (laid-out town highways), discontinued highways, and legal trails hereon are those of which the Agency of Transportation has record; others may exist.

Highway and bridge data by the Agency of Transportation. Town street structures drawn from the Vermont Online Bridge & Culvert Inventory Tool (VOBCIT) database. All other data from the Vermont Center for Geographic Information. Only named streams shown.

Vermont State Plane Coordinate System
North American Datum of 1983
SPCS_Zone_Identifier: 4400
Geodetic Reference System 80
4,000-meter grid, Easting - Northing

- HIGHWAYS**
- INTERSTATE
 - U.S. ROUTE
 - STATE ROUTE
 - CLASS 1
 - CLASS 2
 - CLASS 3
 - CLASS 4
 - LEGAL TRAIL
 - PARK AND RIDE
- BRIDGE OR CULVERT**
- BRIDGE OR CULVERT > 20'
 - BRIDGE OR CULVERT 6' - 20'
 - BIKE PATH STRUCTURE
 - VOBCIT BRIDGE
 - VOBCIT CULVERT > 6'
 - B34 / C34 STATE BRIDGE OR CULVERT IDENTIFIER
 - B34 / C34 TOWN BRIDGE OR CULVERT IDENTIFIER
- POLITICAL SUBDIVISIONS**
- STATE BOUNDARY
 - COUNTY BOUNDARY
 - TOWN BOUNDARY
 - VILLAGE BOUNDARY
 - URBAN COMPACT BOUNDARY
 - WATER BODY
 - STREAM OR BROOK
- FEDERAL CLASSIFICATION IDENTIFIER**
- MA MINOR ARTERIAL
 - MJC MAJOR COLLECTOR
 - MNC MINOR COLLECTOR
 - PA PRINCIPAL ARTERIAL
- OTHER FEATURES**
- INTERSTATE OR DIVIDED HIGHWAY
 - STATE - HARD SURFACE OR PAVED
 - TOWN - HARD SURFACE OR PAVED
 - GRAVEL
 - SOIL OR GRADED AND DRAINED EARTH
 - UNIMPROVED OR PRIMITIVE
 - IMPASSABLE OR UNTRAVELED
 - LEGAL TRAIL
 - DISCONTINUED
 - HIGHWAY CLASS CHANGE
 - RAILROAD
 - INACTIVE RAILROAD
 - PUBLIC LAND - NATIONAL FOREST
 - PUBLIC LAND - STATE/MUNICIPAL
 - NFR NATIONAL FOREST ROAD
 - SFH STATE FOREST HIGHWAY