

TOWN HWY. NO.	LENGTH IN MILES CLASS 3	LENGTH IN MILES CLASS 4	
6	4.500		51 0.050 (0.100)
7	7.800		52 0.080
8	0.250		53 1.800
9		(0.330)	54 0.150
10	1.650		55 0.100
11		(0.200)	56 0.150 (0.200)
12		(0.500)	57 0.500
13	2.700		58 1.300
14	0.320		59 0.940 (0.550)
15	0.220	(1.980)	60 0.740 (0.560)
16	1.710		61 0.150
17	0.500		62
18	0.160		63 0.100 (0.040)
19	0.160		64 0.350
21	0.450		65 0.080
22		(0.440)	66 0.100
23		(0.250)	67 0.200
25	0.260	(0.140)	68 0.260
26	2.500		69 0.090
27		(0.050)	70 0.060
29	0.230	(0.070)	71 0.140
30	0.580	(0.320)	72
31	0.800	(0.400)	73
31		(0.020)	74 0.120
32	0.200		75 0.550 (0.540)
33	0.150		76 0.300 (0.300)
34	0.090		77 0.210
35	0.450		78 0.570 (0.110)
36	1.400		79 0.360
37	0.400		80 0.170
38	0.350	(0.850)	81 0.620
39	0.270	(0.030)	82 0.120
40	0.750		83 0.110
41	0.450		84 0.180
42		(0.050)	86 0.150
43	0.040		87 0.410
44	0.700		88 0.730
45		(0.100)	89 0.310
46	1.750		90 0.180
47	0.150		91 0.400
48	0.200		92 0.090
49	1.000		93 0.420
50	3.350	(0.380)	TOTAL 49.530 8.620

* This portion of town highway is Class 3, but is functionally Class 4

MILEAGE SUMMARY

CLASS 2		
TH-1	7.350	
TH-2	0.280	
TH-3	4.530	
TH-4	1.200	
TH-5	0.290	
TH-6	0.170	
TOTAL CLASS 2	13.820	
CLASS 3		
TOTAL CLASS 3	49.530	
TOTAL TOWN	63.350	
STATE HIGHWAY		
VT-15	2.892	
VT-100	6.513	
VT-100C	0.087	
TOTAL STATE HIGHWAY	9.492	
TOTAL STATE	9.492	

TOTAL, TRAVELED HIGHWAYS, FEB. 10, 2008: 72.842
(Excludes Class 4 and Legal Trail Mileage)

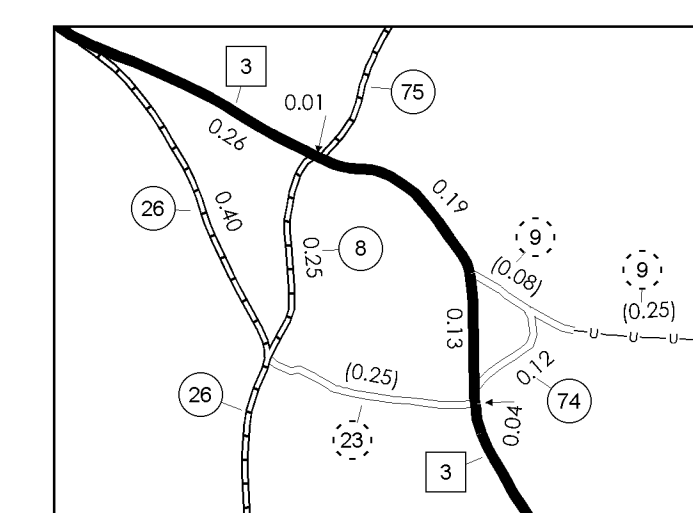

INSET 1 SCALE 1:12672

0 0.2 0.4 Miles

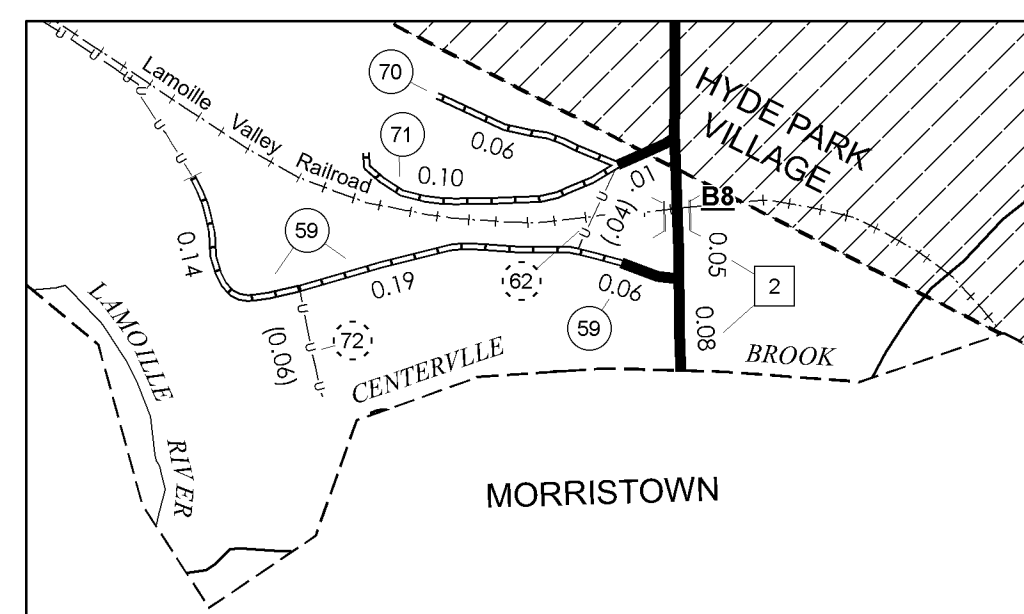
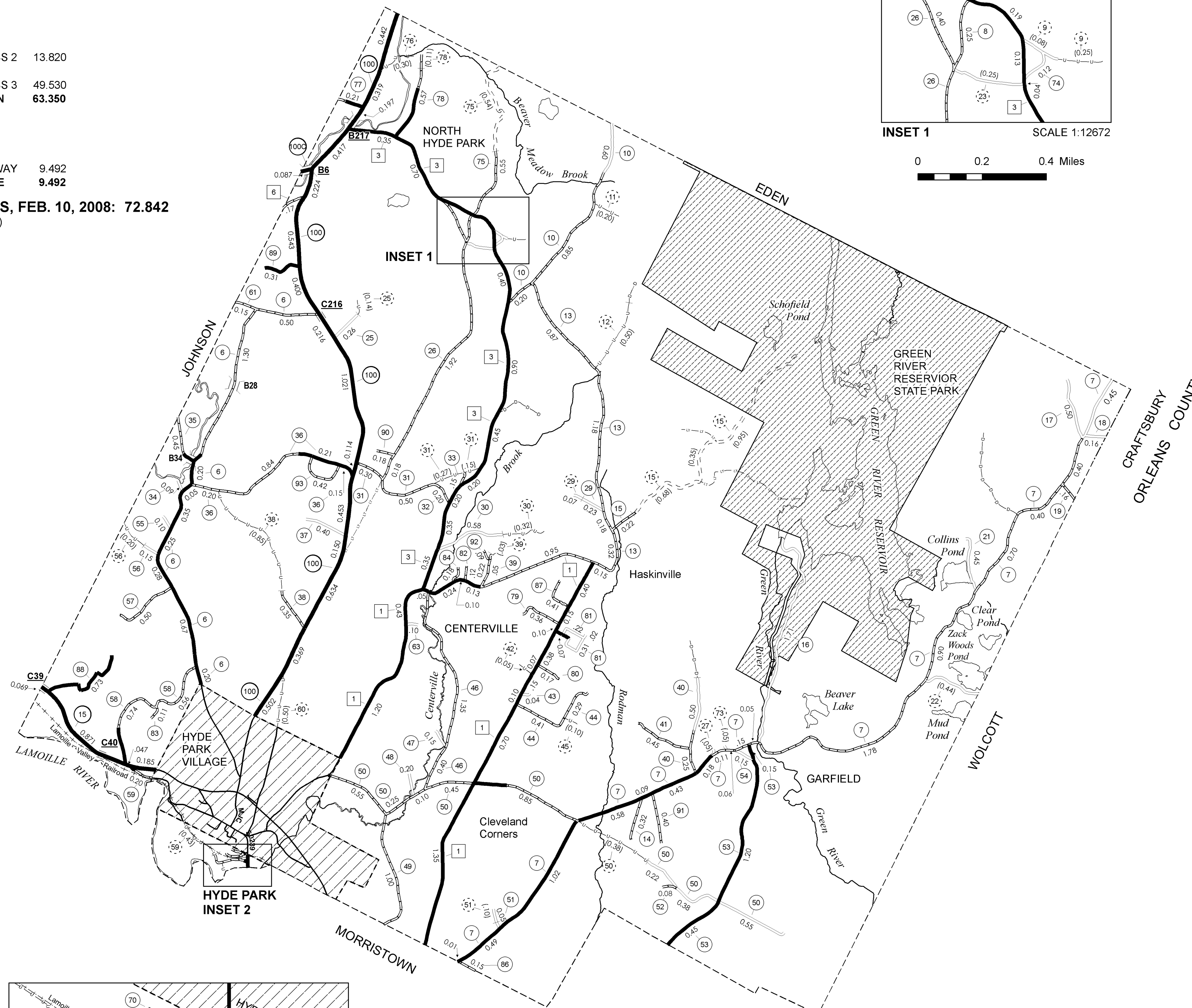

HYDE PARK INSET 2 SCALE 1:6336

0 0.1 0.2 Miles

- HIGHWAYS**
- ACL
 - INTERSTATE
 - U.S. ROUTE
 - STATE ROUTE
 - CLASS 1
 - CLASS 2
 - CLASS 3
 - CLASS 4
 - LEGAL TRAIL
 - INTERSTATE OR DIVIDED HIGHWAY
 - STATE - HARD SURFACE OR PAVED
 - TOWN - HARD SURFACE OR PAVED
 - GRAVEL
 - SOIL OR GRADED AND DRAINED EARTH
 - UNIMPROVED OR PRIMITIVE
 - IMPASSABLE OR UNTRAVELED
 - LEGAL TRAIL
 - DISCONTINUED
 - HIGHWAY CLASS CHANGE
 - RAILROAD
 - INACTIVE RAILROAD

- PUBLIC LAND**
- POLITICAL SUBDIVISIONS**
- STATE BOUNDARY
 - COUNTY BOUNDARY
 - TOWN BOUNDARY
 - VILLAGE BOUNDARY
 - URBAN COMPACT BOUNDARY
 - OPEN WATER
 - STREAM OR BROOK
 - BRIDGE OR CULVERT**
 - BRIDGE OR CULVERT GREATER THAN 20'
 - BRIDGE OR CULVERT 6' - 20'

B34 / C34 STATE BRIDGE OR CULVERT IDENTIFIER
B34 / C34 TOWN BRIDGE OR CULVERT IDENTIFIER

- FEDERAL CLASSIFICATION IDENTIFIER**
- FAU URBAN ARTERIAL OR COLLECTOR
 - MA MINOR ARTERIAL
 - MJC MAJOR COLLECTOR
 - MNC MINOR COLLECTOR
 - PA PRINCIPAL ARTERIAL

DISCLAIMER:
The untraveled highways (laid-out town highways), discontinued highways, and legal trails shown hereon are those of which the Agency of Transportation has record; others may exist.
Highway and bridge data by the Agency of Transportation, Policy & Planning Division. All other data from the Vermont Center for Geographic Information.

Vermont State Plane Coordinate System
North American Datum of 1983
SPCS Zone Identifier: 4400
Geodetic Reference System 90
4,000-meter grid, Easting - Northing

STRUCTURES - SURFACE WATER NOTE:
Town short structures (bridges or culverts from 6-feet to less than 20-feet) were not represented due to inconsistencies in the data.
The surface waters are from the Vermont Hydrological Dataset (VHD). Only the named streams are shown.

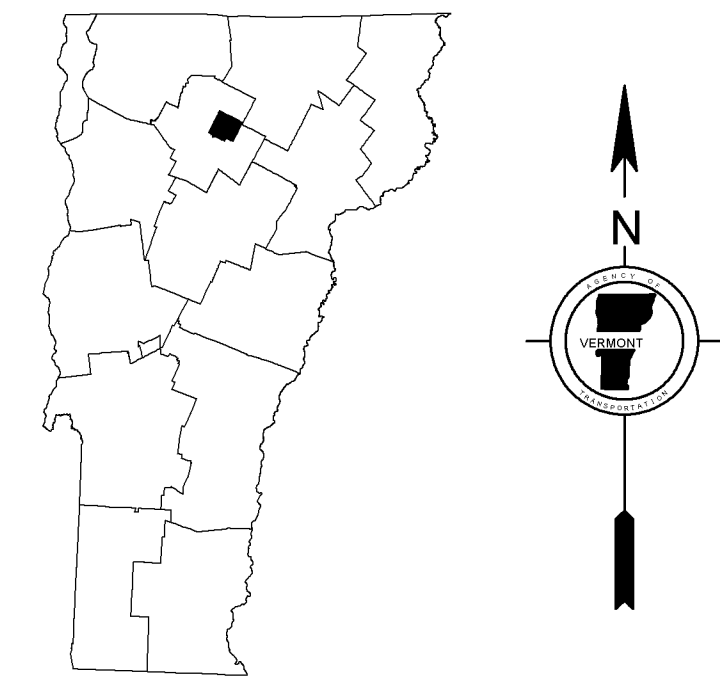

VERMONT
GENERAL HIGHWAY MAP
Town of Hyde Park
LAMOILLE COUNTY

Transportation District #8

Prepared by the
Vermont Agency of Transportation
Policy & Planning Division
in cooperation with
U.S. Department of Transportation
Federal Highway Administration

Mileage as of: Feb. 10, 2008
Map generated: September, 2008

