

MILEAGE SUMMARY

CLASS 2		
TH-1	1,350	
TH-2	0,570	
TOTAL CLASS 2	1,920	
CLASS 3		
TOTAL CLASS 3	1,47	
TOTAL TOWN	3,390	
STATE HIGHWAY		
VT-15	1,100	
TOTAL STATE HIGHWAY	1,100	
TOTAL STATE	1,1	

TOTAL, TRAVELED HIGHWAYS, FEB. 10, 2023: 4.490
(Excludes Class 4 and Legal Trail Mileage)

TOWN HWY. No.	LENGTH IN MILES CLASS 3	LENGTH IN MILES CLASS 4	TOWN ROAD NAME
10	0.10		BARTLETT HILL RD
28	0.10		WILLIAMSON RD
38	0.09		RAILROAD ST
38	0.05		VILLAGE RESERVOIR RD
43	0.25		BRYCE RD
61	0.35		N MAIN ST
62	0.15		S MAIN ST
63	0.08		S MAIN ST
65	0.23		OLD ROUTE 15
70	0.06		S MAIN ST
77	0.01		S MAIN ST
TOTAL	1.47	0.00	

- HIGHWAYS**
- INTERSTATE
 - U.S. ROUTE
 - STATE ROUTE
 - CLASS 1
 - CLASS 2
 - CLASS 3
 - CLASS 4
 - LEGAL TRAIL
 - GRAVEL
 - SOIL OR GRADED AND DRAINED EARTH
 - UNIMPROVED OR PRIMITIVE
 - IMPASSABLE OR UNTRAVELED
 - LEGAL TRAIL
 - DISCONTINUED
 - HIGHWAY CLASS CHANGE
 - RAILROAD
 - INACTIVE RAILROAD
 - PUBLIC LAND - NATIONAL FOREST
 - PUBLIC LAND - STATE/MUNICIPAL
- POLITICAL SUBDIVISIONS**
- STATE BOUNDARY
 - COUNTY BOUNDARY
 - TOWN BOUNDARY
 - VILLAGE BOUNDARY
 - URBAN COMPACT BOUNDARY
 - WATER BODY
 - STREAM OR BROOK
- BRIDGE OR CULVERT**
- BRIDGE OR CULVERT > 20'
 - BRIDGE OR CULVERT 6' - 20'
 - BIKE PATH STRUCTURE
 - VCULVERTS BRIDGE
 - VCULVERTS CULVERT > 6'
- B34 / C34** STATE BRIDGE OR CULVERT IDENTIFIER
B34 / C34 TOWN BRIDGE OR CULVERT IDENTIFIER
NFR NATIONAL FOREST ROAD
USGH UNITED STATES GOV. HWY.
P PARK AND RIDE
FEDERAL CLASSIFICATION IDENTIFIER
MA MINOR ARTERIAL
MJC MAJOR COLLECTOR
MNC MINOR COLLECTOR
PA PRINCIPAL ARTERIAL

DISCLAIMER:
The untraveled highways (laid-out town highways), discontinued highways, and legal trails hereon are those of which the Agency of Transportation has record; others may exist.

Highway and bridge data by the Agency of Transportation. Town short structures drawn from the VCULVERTS (formerly VOBCIT) online database. All other data from the Vermont Open Geodata Portal. Only named streams shown.

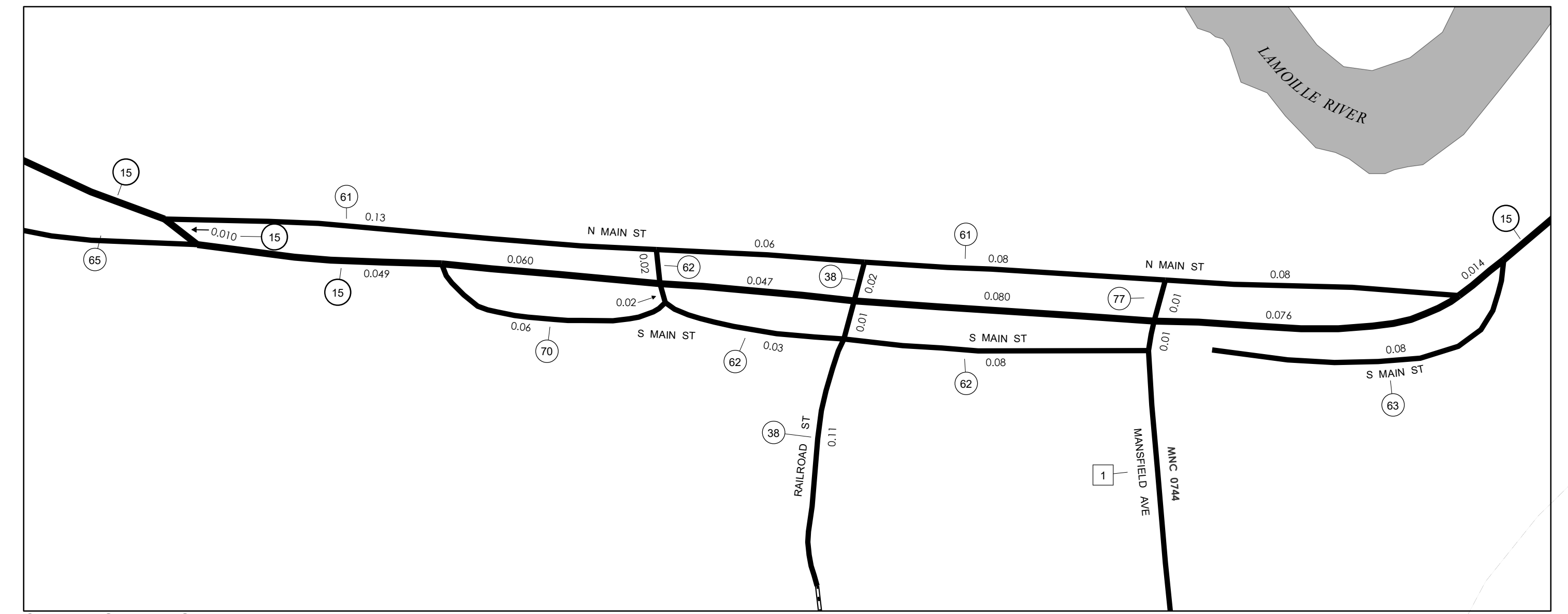
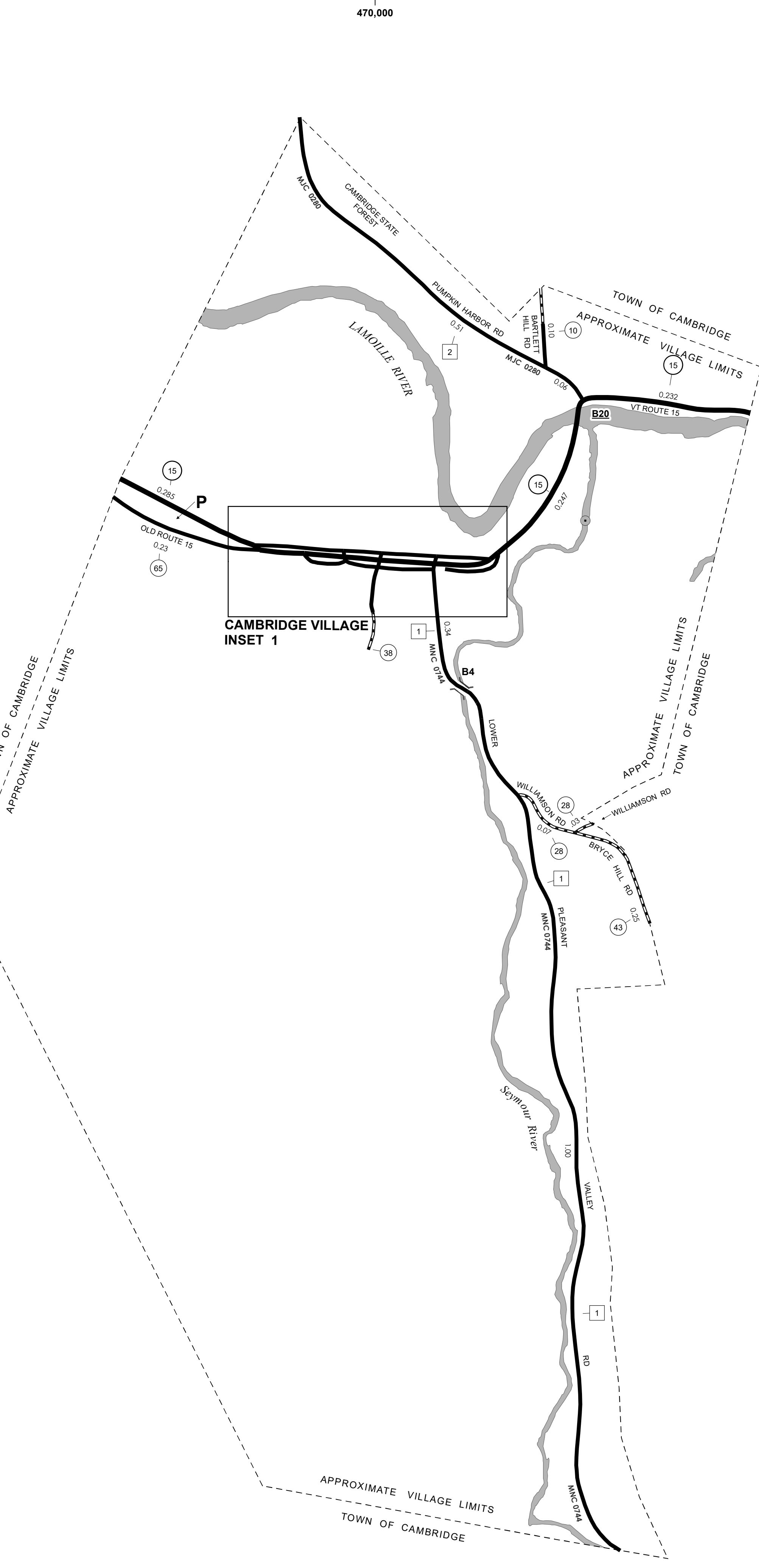

CAMBRIDGE VILLAGE INSET 1 SCALE 1:1,584

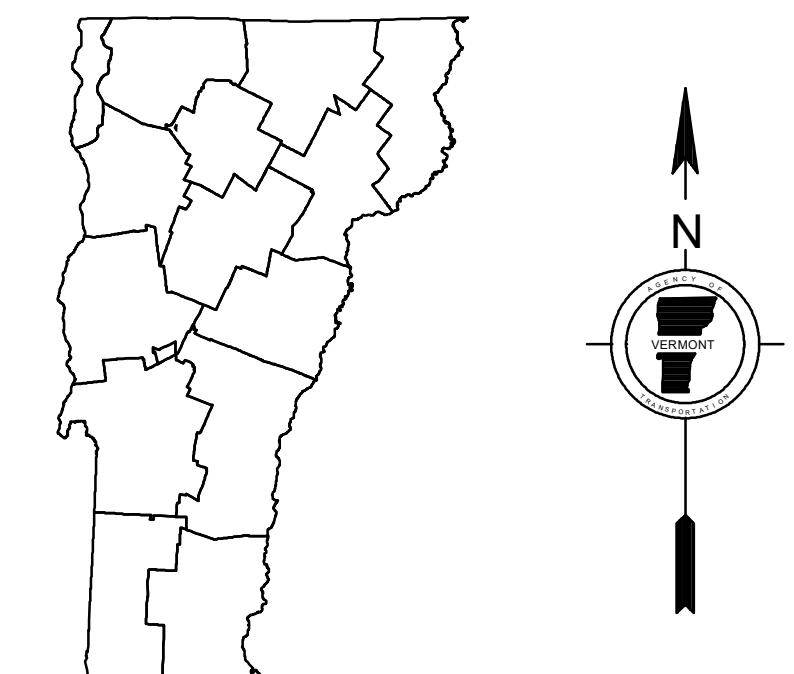
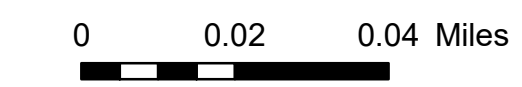

VERMONT GENERAL HIGHWAY MAP
Village of Cambridge

LAMOILLE COUNTY
 Transportation District #8
 Prepared by the
 Vermont Agency of Transportation
 Division of Policy, Planning and Intermodal Development
 in cooperation with
 U.S. Department of Transportation
 Federal Highway Administration

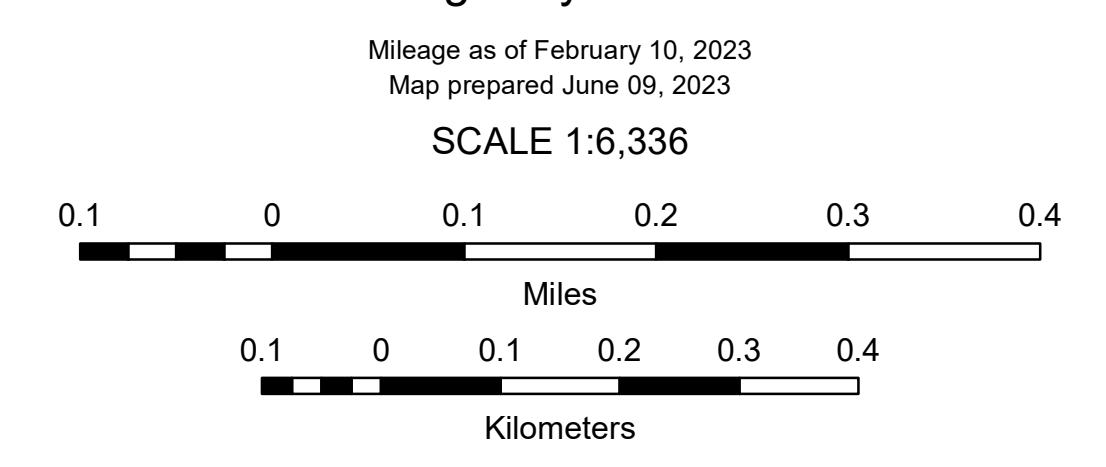

Vermont State Plane Coordinate System
 North American Datum of 1983
 SPCS Zone Identifier: 4400
 Geodetic Reference System 80
 2,000-meter grid, Easting - Northing