

MILEAGE SUMMARY

CLASS 2		
TH-1	1,350	
TH-2	0,570	
TOTAL CLASS 2	1,920	
CLASS 3		
TOTAL CLASS 3	1,47	
TOTAL TOWN	3,390	
STATE HIGHWAY		
VT-15	1,084	
TOTAL STATE HIGHWAY	1,084	
TOTAL STATE	1,084	

TOTAL, TRAVELED HIGHWAYS, FEB. 10, 2014: 4.474
(Excludes Class 4, Legal Trail, and Unidentified Corridor Mileage)

TOWN HWY. No.	LENGTH IN MILES CLASS 3	LENGTH IN MILES CLASS 4	TOWN ROAD NAME
10	0.10		BARTLETT HILL RD
28	0.10		WILLIAMSON RD
38	0.08		RAILROAD ST
38	0.06		VILLAGE RESERVOIR RD
43	0.25		BRYCE RD
61	0.35		N MAIN ST
62	0.15		S MAIN ST
63	0.08		S MAIN ST
65	0.23		OLD ROUTE 15
70	0.06		S MAIN ST
77	0.01		S MAIN ST
TOTAL	1.47	0.00	

- HIGHWAYS**
- INTERSTATE
 - U.S. ROUTE
 - STATE ROUTE
 - CLASS 1
 - CLASS 2
 - CLASS 3
 - CLASS 4
 - LEGAL TRAIL
 - GRAVEL
 - SOIL OR GRADED AND DRAINED EARTH
 - UNIMPROVED OR PRIMITIVE
 - IMPASSABLE OR UNTRAVELED
 - LEGAL TRAIL
 - DISCONTINUED
 - HIGHWAY CLASS CHANGE
 - RAILROAD
 - INACTIVE RAILROAD
 - PUBLIC LAND - GREEN MOUNTAIN NATIONAL FOREST
 - PUBLIC LAND - STATE/MUNICIPAL
- POLITICAL SUBDIVISIONS**
- STATE BOUNDARY
 - COUNTY BOUNDARY
 - TOWN BOUNDARY
 - VILLAGE BOUNDARY
 - URBAN COMPACT BOUNDARY
 - WATER BODY
 - STREAM OR BROOK
- BRIDGE OR CULVERT**
- BRIDGE OR CULVERT > 20'
 - BRIDGE OR CULVERT 6' - 20'
 - VOBCIT BRIDGE
 - VOBCIT CULVERT > 6'
- B34 / C34 STATE BRIDGE OR CULVERT IDENTIFIER**
- B34 / C34 TOWN BRIDGE OR CULVERT IDENTIFIER**
- NFR NATIONAL FOREST ROAD**
- SFH STATE FOREST HIGHWAY**
- P PARK AND RIDE**
- FEDERAL CLASSIFICATION IDENTIFIER**
- FAU URBAN ARTERIAL OR COLLECTOR
 - MA MINOR ARTERIAL
 - MJC MAJOR COLLECTOR
 - MNC MINOR COLLECTOR
 - PA PRINCIPAL ARTERIAL

DISCLAIMER:
The untraveled highways (laid-out town highways), discontinued highways, and legal trails hereon are those of which the Agency of Transportation has record; others may exist.

Highway and bridge data by the Agency of Transportation. Town short structures are drawn from the Vermont Online Bridge & Culvert Inventory Tool (VOBCIT) database. All other data from the Vermont Center for Geographic Information. Only named streams are shown.

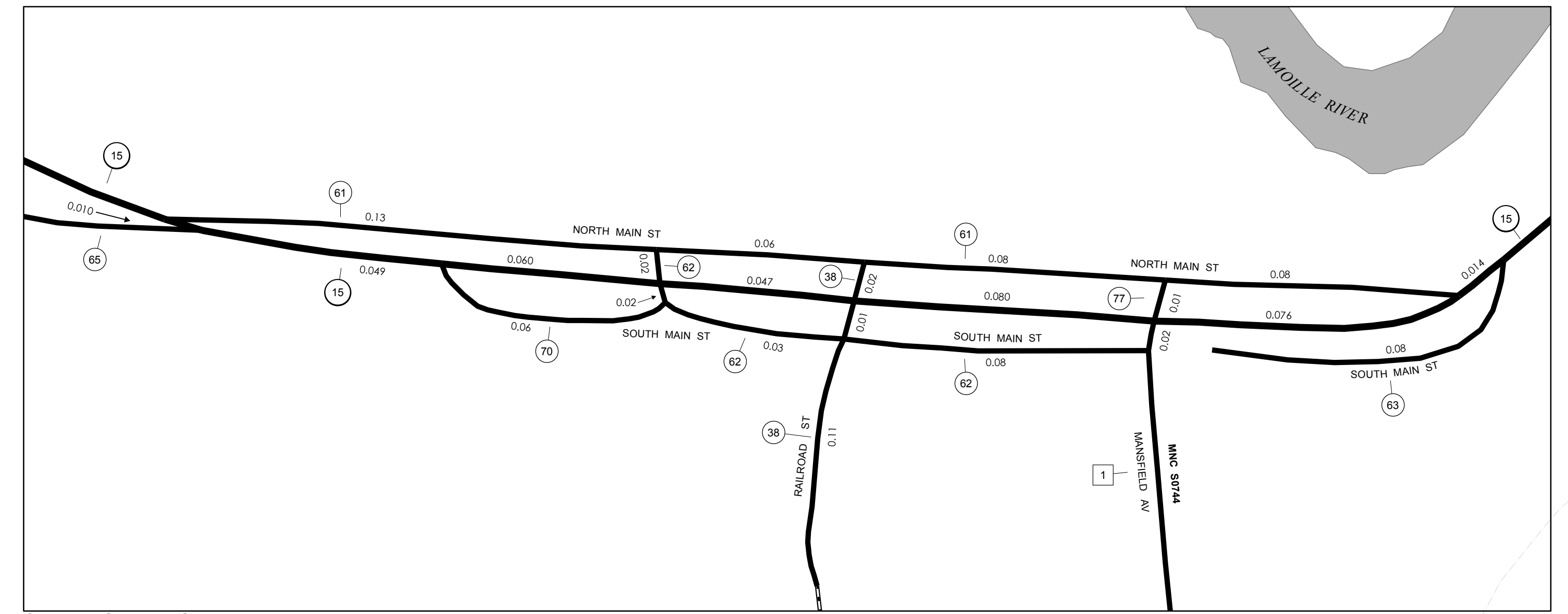
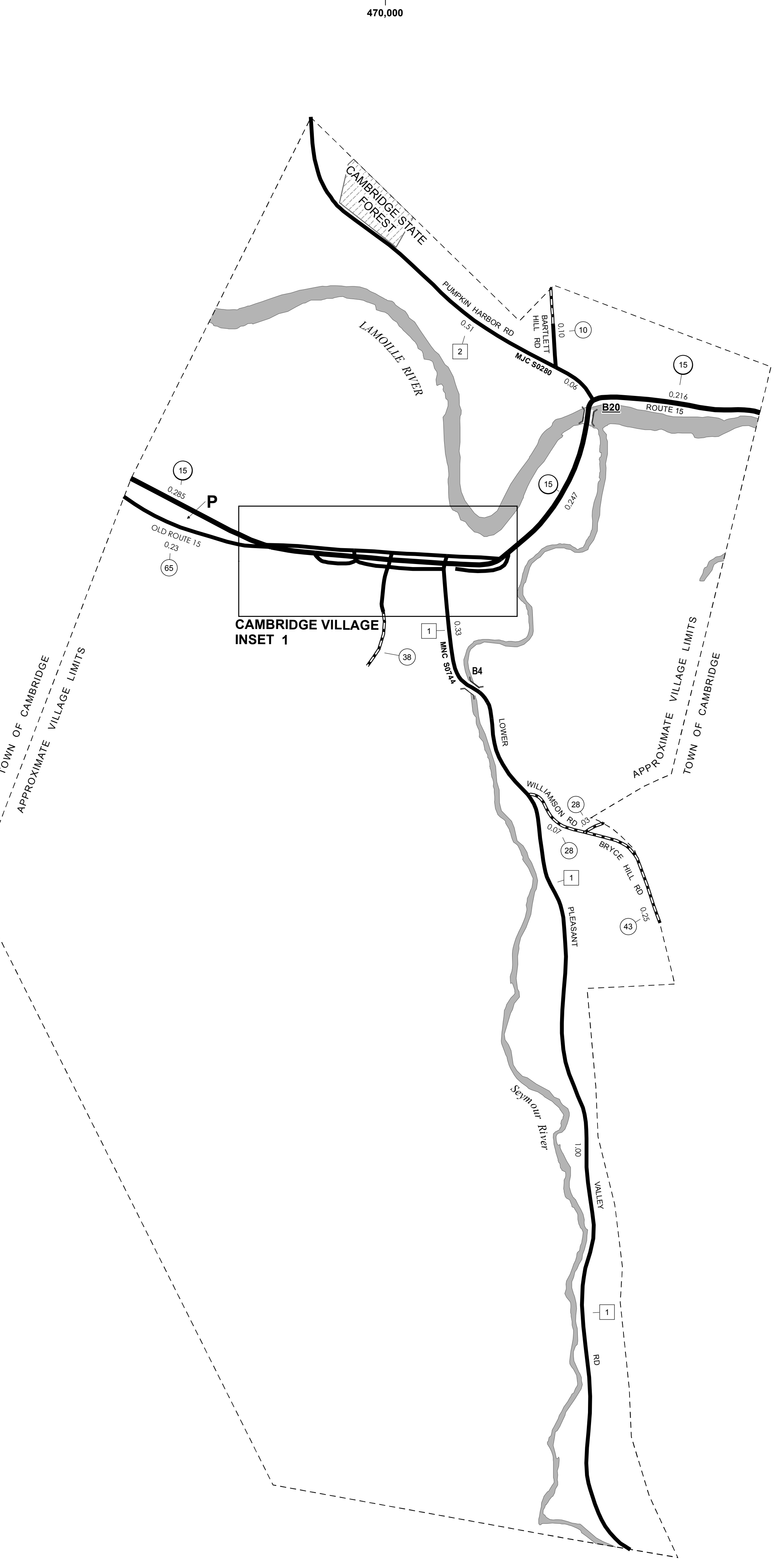

CAMBRIDGE VILLAGE INSET 1 SCALE 1:1,584

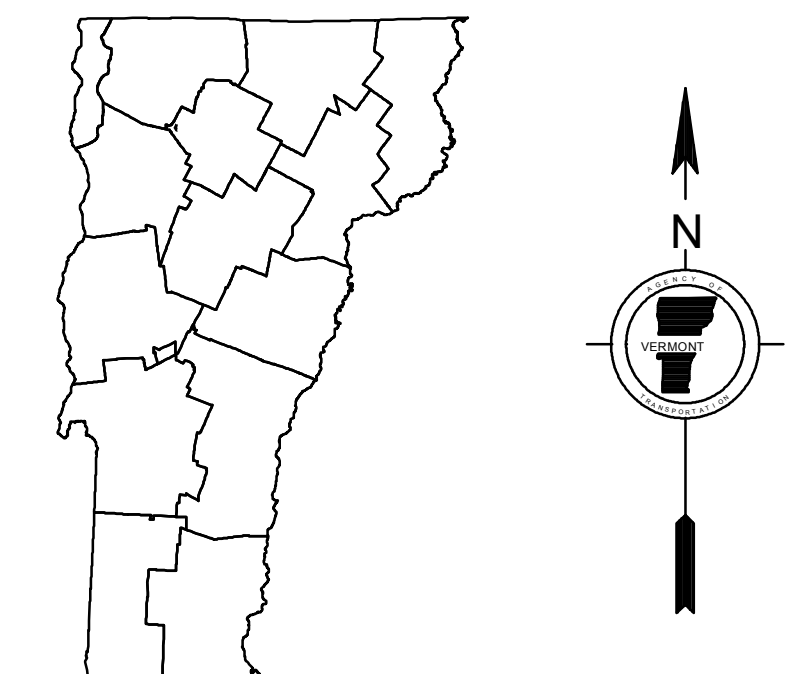
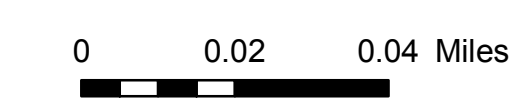

VERMONT GENERAL HIGHWAY MAP
Village of Cambridge

LAMOILLE COUNTY
Transportation District #8
Prepared by the
Vermont Agency of Transportation
Division of Policy, Planning and Intermodal Development
in cooperation with
U.S. Department of Transportation
Federal Highway Administration

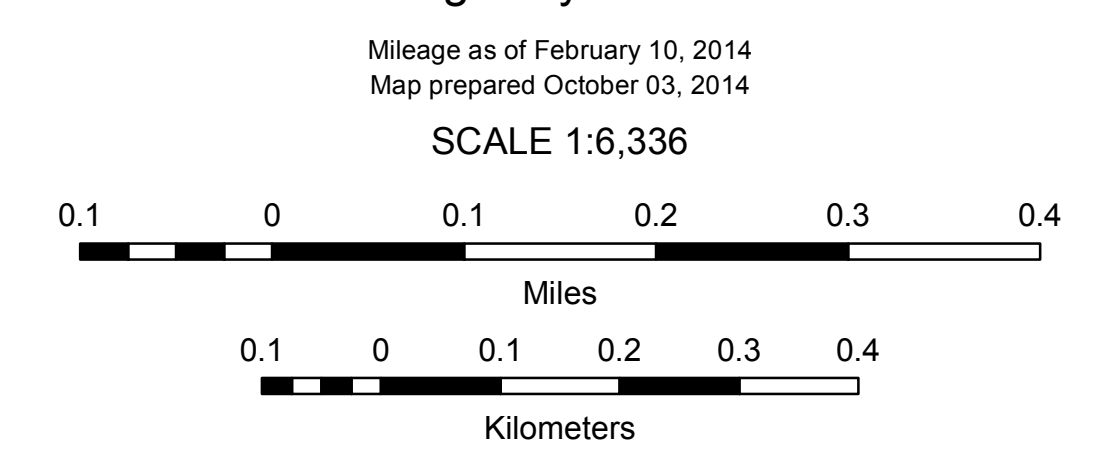

Vermont State Plane Coordinate System
North American Datum of 1983
SPCS_Zone_Identifier: 4400
Geodetic Reference System 80
2,000-meter grid, Easting - Northing