

TOWN HWY NO.	LENGTH IN MILES CLASS 3	CLASS 4
31	0.100	
53	0.220	
54	0.050	
55	0.300	
73	0.080	
79	0.660	
80	0.110	
83	0.100	
85	0.110	
TOTAL	1.730	0.000

MILEAGE SUMMARY

CLASS 1 TOWN HIGHWAYS:		
TOTAL, CLASS 1 TOWN HWYS.		0.000
CLASS 2 TOWN HIGHWAYS:		
NO. 5	0.440	
TOTAL, CLASS 2 TOWN HWYS.		0.440
CLASS 3 TOWN HIGHWAYS:		
TOTAL, CLASS 3 TOWN HWYS.		1.730
TOTAL, TOWN HWYS.		2.170
STATE HIGHWAYS:		
TOTAL, INTERSTATE HWYS.		0.000
STATE HWY. 15	0.829	
STATE HWY. 108	1.533	
TOTAL, NON-INTERSTATE HWYS.		2.362
TOTAL, STATE HWYS.		2.362
TOTAL, TRAVELLED HWYS., FEB. 10, 1993 (EXCLUDES CLASS 4 MILEAGE)		4.532

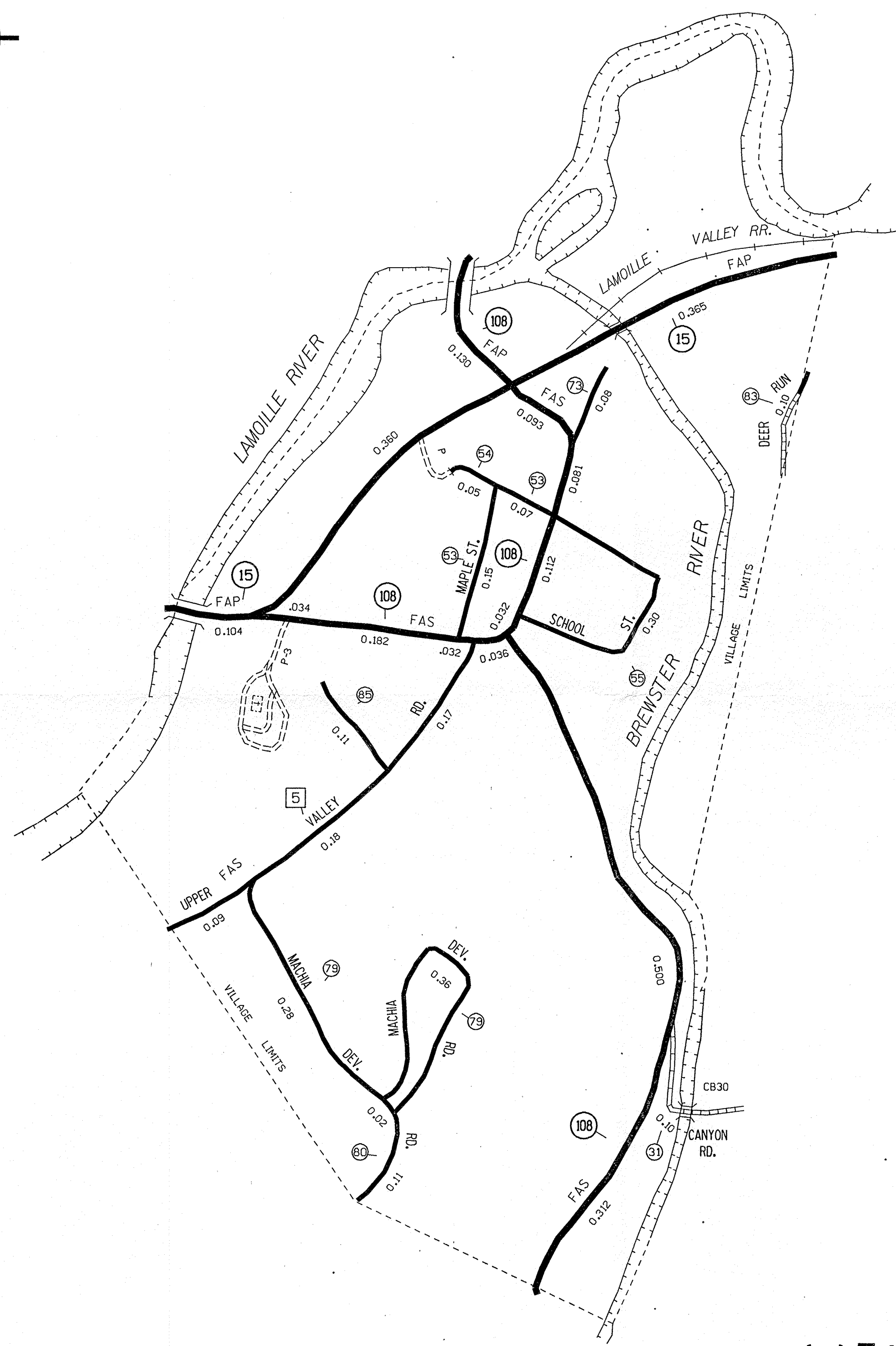

- HIGHWAYS**
- INTERSTATE
 - STATE HIGHWAY SYSTEM
 - TOWN HIGHWAY SYSTEM
 - IMPASSABLE OR UNTRAVELLED
 - DISCONTINUED
 - LEGAL TRAIL
 - FOOT TRAIL
 - 89 INTERSTATE NUMBERED ROUTE
 - 2 U.S. NUMBERED ROUTE
 - 3 STATE NUMBERED ROUTE
 - 7 INTERCHANGE NUMBER
 - 4 CLASS 1 TOWN HIGHWAY
 - 2 CLASS 2 TOWN HIGHWAY
 - 2 CLASS 3 TOWN HIGHWAY
 - 6 CLASS 4 TOWN HIGHWAY
 - FAP FEDERAL AID PRIMARY HIGHWAY SYSTEM
 - FAS FEDERAL AID SECONDARY HIGHWAY SYSTEM
 - FCA FULLY CONTROLLED ACCESS
 - NFR NATIONAL FOREST ROAD
 - SFH STATE FOREST HIGHWAY

- POLITICAL SUBDIVISIONS**
- STATE BOUNDARY
 - COUNTY BOUNDARY
 - TOWN BOUNDARY
 - CITY BOUNDARY
 - VILLAGE BOUNDARY
 - URBAN COMPACT BOUNDARY

- MISCELLANEOUS**
- DM

- ROAD SURFACE TYPES**
- BRIDGE OR CULVERT LESS THAN 6' SPAN
 - BRIDGE OR CULVERT 6' TO 20' SPAN
 - BRIDGE (GREATER THAN 20' SPAN)
 - COVERED BRIDGE

- NATURAL FEATURES**
- SINGLE LINE STREAM
 - OPEN WATER
 - SWAMP

- ROAD SURFACE TYPES**
- STATE SURFACED
 - OTHER SURFACED
 - STATE GRAVEL
 - OTHER GRAVEL
 - SOIL SURFACED
 - GRADED AND DRAINED
 - UNIMPROVED
 - PRIMITIVE

- OTHER TRANSPORTATION**
- RAILROAD
 - AIRPORT TERMINAL

GENERAL HIGHWAY MAP

VILLAGE OF JEFFERSONVILLE

PREPARED BY THE
VERMONT AGENCY OF TRANSPORTATION
PLANNING DIVISION

