

TOWN HWY. No.	LENGTH IN MILES CLASS 3	CLASS 4
2	1.95	
3	1.20	
4		(0.28)
5	0.04	
6	2.13	(0.15)
7	0.40	(0.10)
8	4.35	
9		(0.57)
10	1.27	(1.03)
11	0.20	
12	0.21	
13		(0.63)
<b>TOTAL</b>	<b>11.75</b>	<b>2.76</b>

LEGAL TRAIL No.	LENGTH IN MILES LEGAL TRAIL
1	(0.14)
<b>TOTAL</b>	<b>0.14</b>

MILEAGE SUMMARY CLASS 3		
STATE HIGHWAY	TOTAL CLASS 3	11.75
VT-109	TOTAL TOWN	11.750
VT-118		
	TOTAL STATE HIGHWAY	9.734
	TOTAL STATE	9.734

**TOTAL, TRAVELED HIGHWAYS, FEB. 10, 2014: 21.484**  
 (Excludes Class 4, Legal Trail, and Unidentified Corridor Mileage)

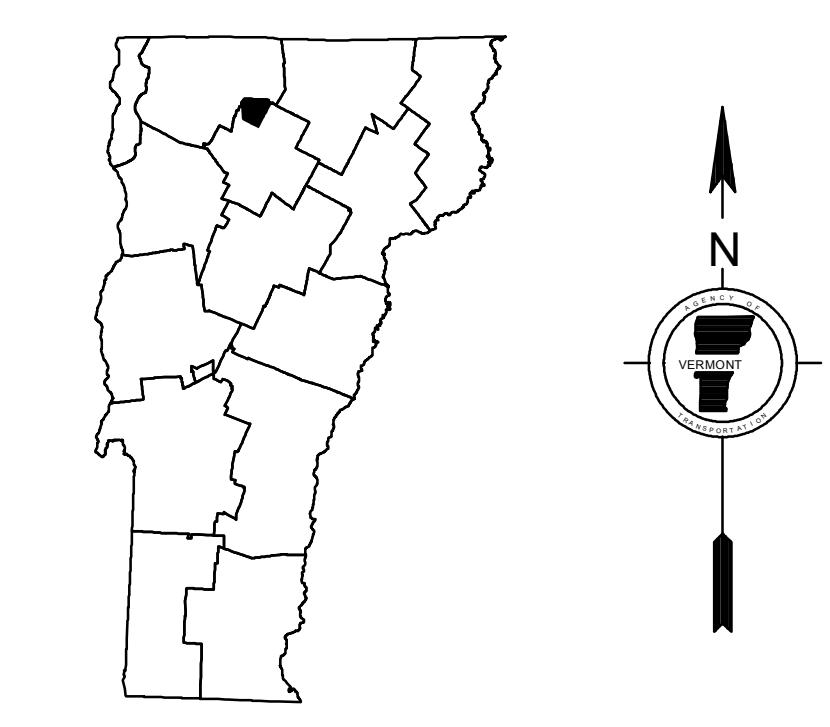
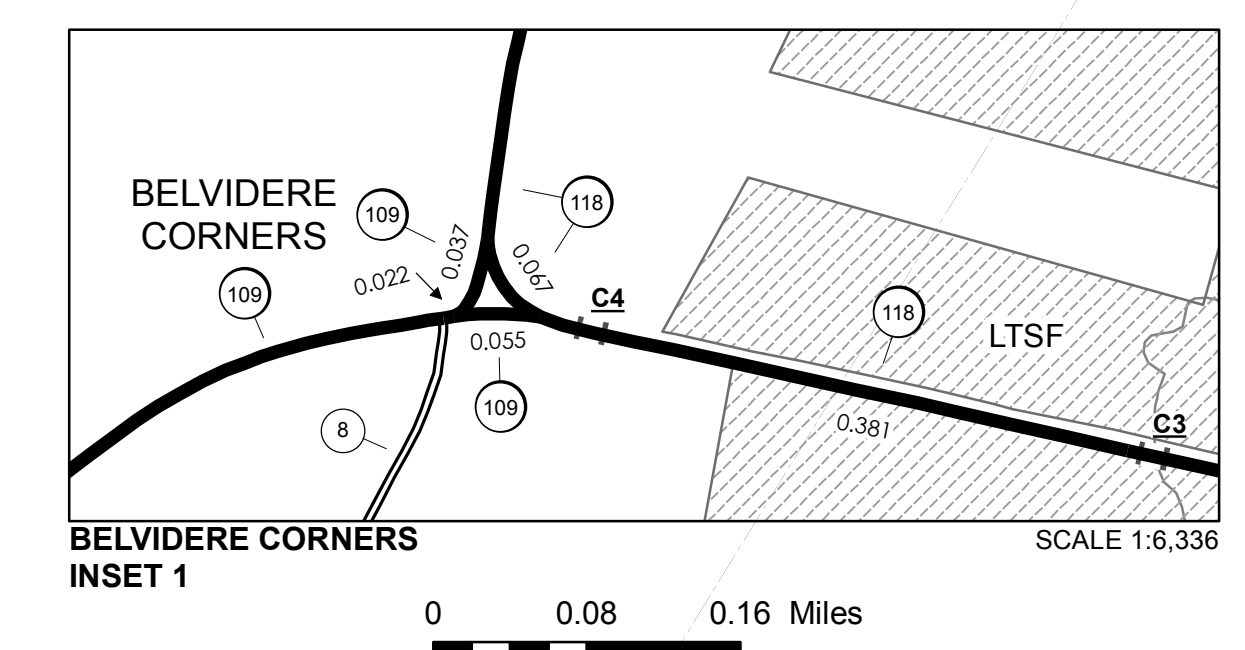

**VERMONT**  
**GENERAL HIGHWAY MAP**  
**Town of Belvidere**  
 LAMOILLE COUNTY

Transportation District #8  
 Prepared by the  
**Vermont Agency of Transportation**  
 Division of Policy, Planning and Intermodal Development  
 in cooperation with  
**U.S. Department of Transportation**  
**Federal Highway Administration**

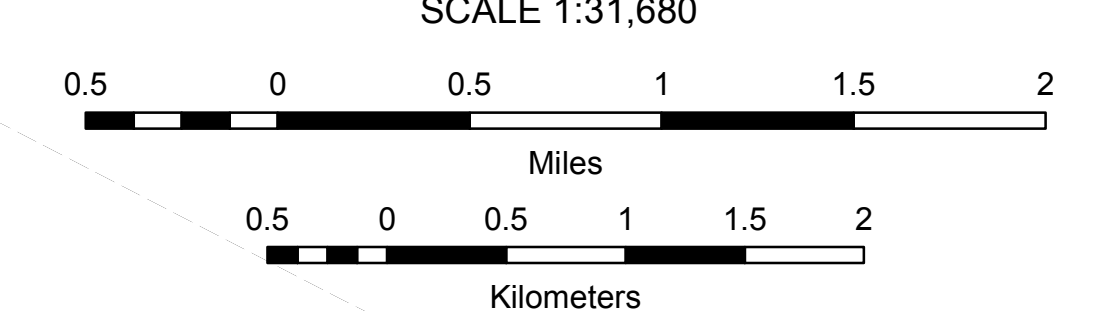

**DISCLAIMER:**  
 The untraveled highways (laid-out town highways), discontinued highways, and legal trails hereon are those of which the Agency of Transportation has record; others may exist.  
 Highway and bridge data by the Agency of Transportation. Town short structures are drawn from the Vermont Online Bridge & Culvert Inventory Tool (VOBCIT) database. All other data from the Vermont Center for Geographic Information. Only named streams are shown.

- HIGHWAYS**
- INTERSTATE
- U.S. ROUTE
- STATE ROUTE
- CLASS 1
- CLASS 2
- CLASS 3
- CLASS 4
- LEGAL TRAIL
- INTERSTATE OR DIVIDED HIGHWAY
- STATE - HARD SURFACE OR PAVED
- TOWN - HARD SURFACE OR PAVED
- GRAVEL
- SOIL OR GRADED AND DRAINED EARTH
- UNIMPROVED OR PRIMITIVE
- IMPASSABLE OR UNTRAVELED
- LEGAL TRAIL
- DISCONTINUED
- HIGHWAY CLASS CHANGE
- RAILROAD
- INACTIVE RAILROAD
- NATIONAL FOREST ROAD
- STATE FOREST HIGHWAY
- PARK AND RIDE
- PUBLIC LAND - GREEN MOUNTAIN NATIONAL FOREST
- PUBLIC LAND - STATE/MUNICIPAL
- POLITICAL SUBDIVISIONS**
- STATE BOUNDARY
- COUNTY BOUNDARY
- TOWN BOUNDARY
- VILLAGE BOUNDARY
- URBAN COMPACT BOUNDARY
- WATER BODY
- STREAM OR BROOK
- BRIDGE OR CULVERT**
- BRIDGE OR CULVERT > 20'
- BRIDGE OR CULVERT 6' - 20'
- VOBCIT BRIDGE
- VOBCIT CULVERT > 6'
- STATE BRIDGE OR CULVERT IDENTIFIER
- TOWN BRIDGE OR CULVERT IDENTIFIER
- FEDERAL CLASSIFICATION IDENTIFIER**
- FAU URBAN ARTERIAL OR COLLECTOR
- MA MINOR ARTERIAL
- MJC MAJOR COLLECTOR
- MNC MINOR COLLECTOR
- PA PRINCIPAL ARTERIAL

Vermont State Plane Coordinate System  
 North American Datum of 1983  
 SPCS\_Zone\_Identifier: 4400  
 Geodetic Reference System 80  
 4,000-meter grid, Easting - Northing