

- HIGHWAYS**
- INTERSTATE
 - U.S. ROUTE
 - STATE ROUTE
 - CLASS 1
 - CLASS 2
 - CLASS 3
 - CLASS 4
 - LEGAL TRAIL
 - INTERSTATE OR DIVIDED HIGHWAY
 - STATE - HARD SURFACE OR PAVED
 - TOWN - HARD SURFACE OR PAVED
 - GRAVEL
 - SOIL OR GRADED AND DRAINED EARTH
 - UNIMPROVED OR PRIMITIVE
 - IMPASSABLE OR UNTRAVELED
 - LEGAL TRAIL
 - DISCONTINUED
 - HIGHWAY CLASS CHANGE
 - RAILROAD
 - PUBLIC LAND
- POLITICAL SUBDIVISIONS**
- STATE BOUNDARY
 - COUNTY BOUNDARY
 - TOWN BOUNDARY
 - VILLAGE BOUNDARY
 - URBAN COMPACT BOUNDARY
 - OPEN WATER
 - STREAM OR BROOK
- BRIDGE OR CULVERT**
- BRIDGE OR CULVERT GREATER THAN 20'
 - BRIDGE OR CULVERT 6' - 20'
- B34 / C34 STATE BRIDGE OR CULVERT IDENTIFIER**
B34 / C34 TOWN BRIDGE OR CULVERT IDENTIFIER
- P PARK AND RIDE**
- FEDERAL CLASSIFICATION IDENTIFIER**
- FAU URBAN ARTERIAL OR COLLECTOR
 - MA MINOR ARTERIAL
 - MJC MAJOR COLLECTOR
 - MNC MINOR COLLECTOR
 - PA PRINCIPAL ARTERIAL

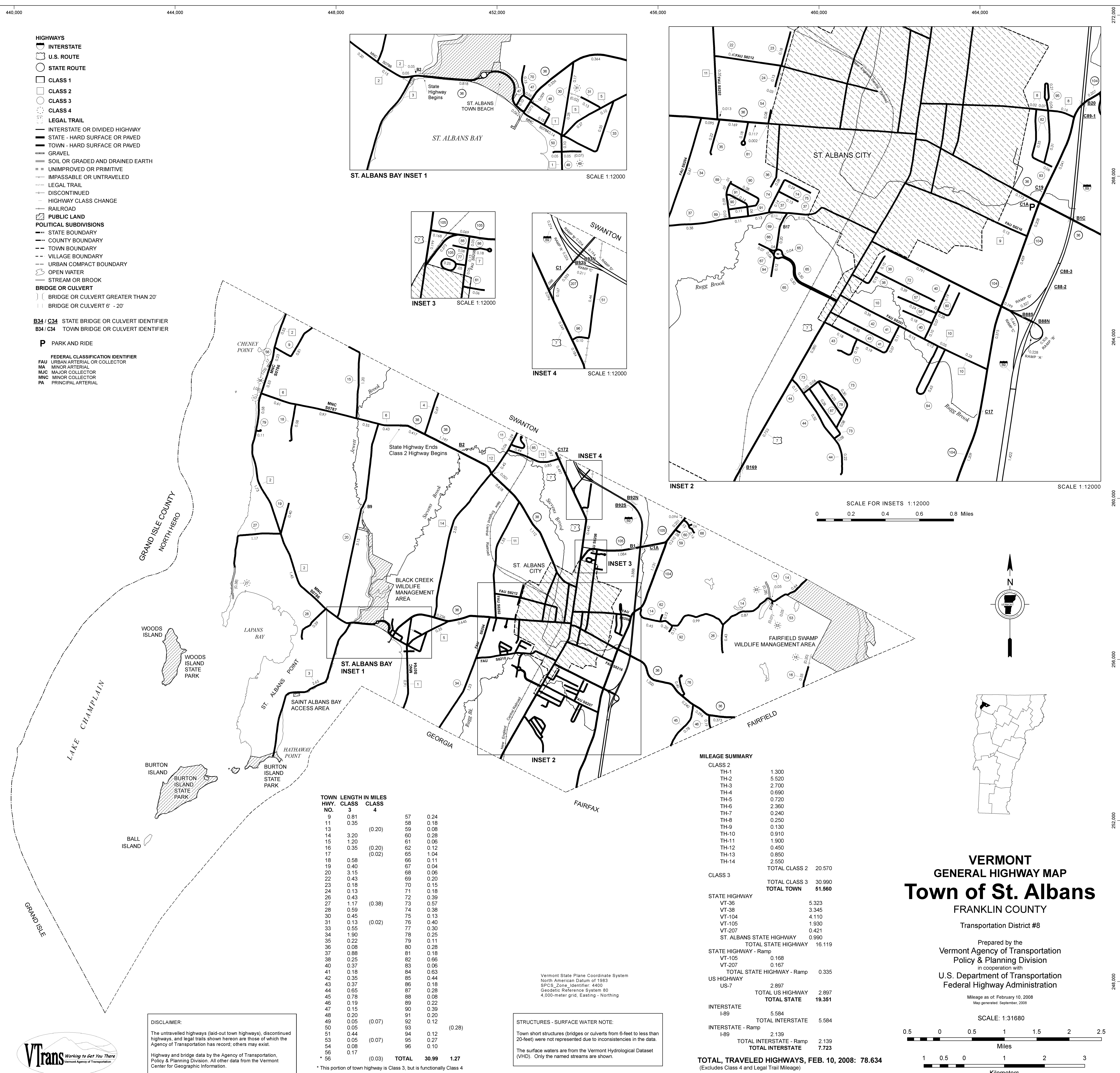
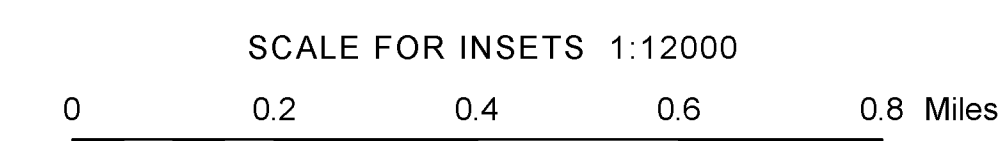
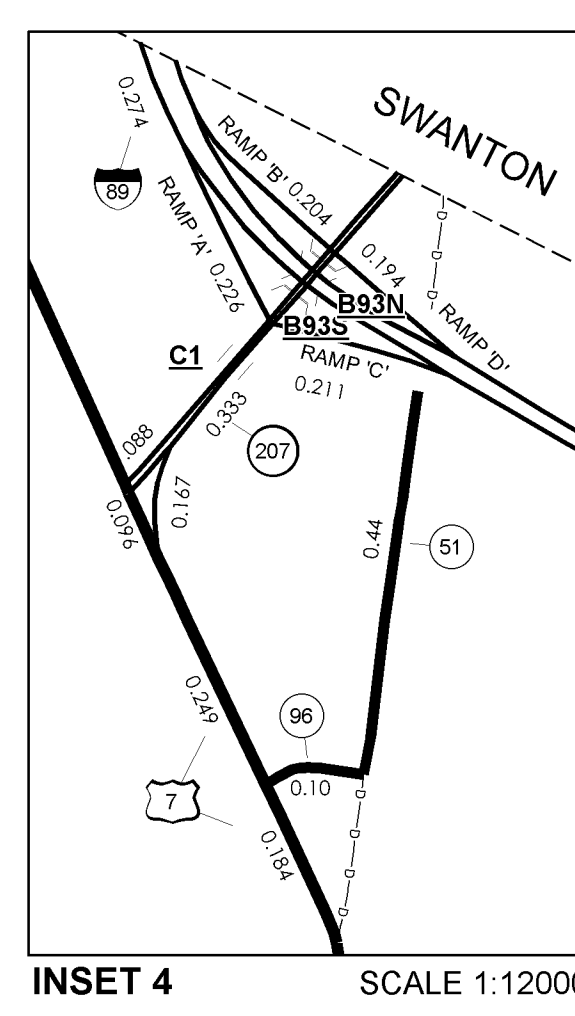
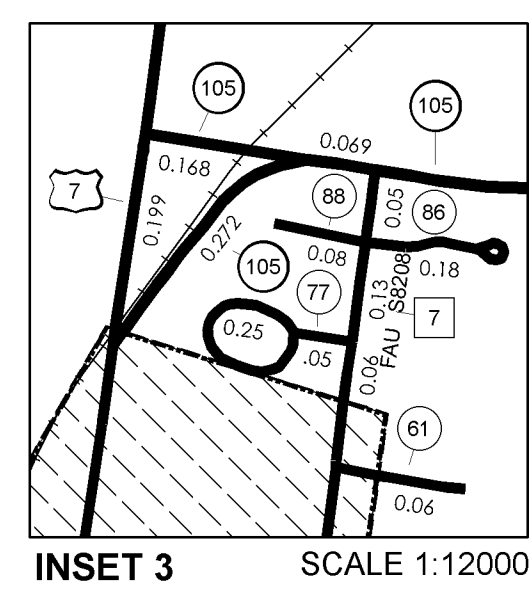
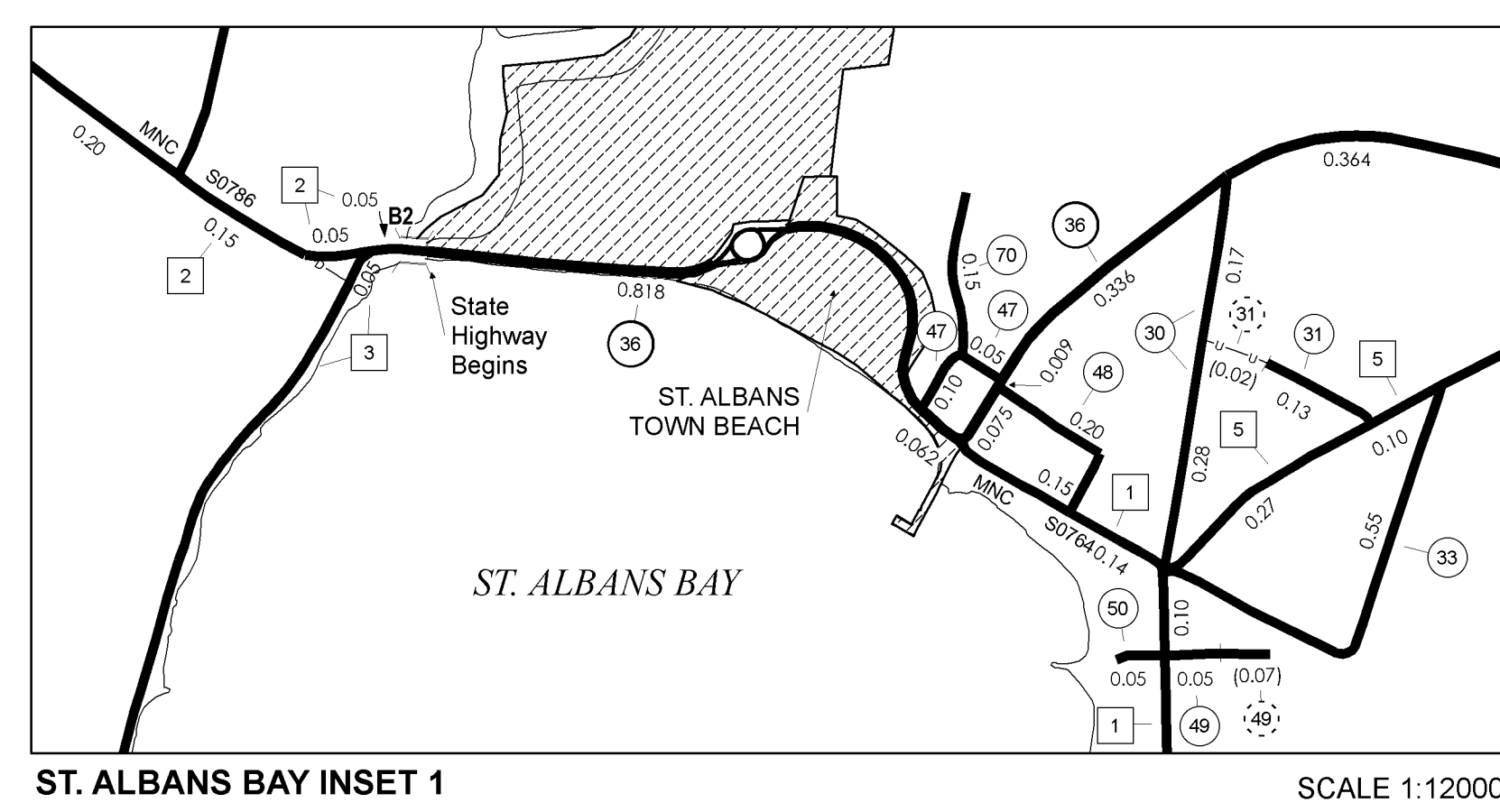

TOWN HWY. NO.	CLASS 3	CLASS 4	LENGTH IN MILES
9	0.81		57 0.24
11	0.35		58 0.18
13		(0.20)	59 0.08
14	3.20		60 0.28
15	1.20		61 0.06
16	0.35	(0.20)	62 0.12
17		(0.02)	65 1.04
18	0.58		66 0.11
19	0.40		67 0.04
20	3.15		68 0.06
22	0.43		69 0.20
23	0.18		70 0.15
24	0.13		71 0.18
26	0.43		72 0.39
27	1.17	(0.38)	73 0.57
28	0.59		74 0.38
30	0.45		75 0.13
31	0.13	(0.02)	76 0.40
33	0.55		77 0.30
34	1.90		78 0.25
35	0.22		79 0.11
36	0.08		80 0.28
37	0.88		81 0.18
38	0.25		82 0.66
40	0.37		83 0.06
41	0.18		84 0.63
42	0.35		85 0.44
43	0.37		86 0.18
44	0.65		87 0.28
45	0.78		88 0.08
46	0.19		89 0.22
47	0.15		90 0.39
48	0.20		91 0.20
49	0.05	(0.07)	92 0.12
50	0.05		93 (0.28)
51	0.44		94 0.12
53	0.05	(0.07)	95 0.27
54	0.08		96 0.10
56	0.17		
* 56		(0.03)	TOTAL 30.99 1.27

* This portion of town highway is Class 3, but is functionally Class 4

STRUCTURES - SURFACE WATER NOTE:
 Town short structures (bridges or culverts from 6-feet to less than 20-feet) were not represented due to inconsistencies in the data.
 The surface waters are from the Vermont Hydrological Dataset (VHD). Only the named streams are shown.

MILEAGE SUMMARY

CLASS 2	
TH-1	1.300
TH-2	5.520
TH-3	2.700
TH-4	0.690
TH-5	0.720
TH-6	2.380
TH-7	0.240
TH-8	0.250
TH-9	0.130
TH-10	0.910
TH-11	1.900
TH-12	0.450
TH-13	0.850
TH-14	2.550
TOTAL CLASS 2	20.570
CLASS 3	
TOTAL CLASS 3	30.990
TOTAL TOWN	51.560
STATE HIGHWAY	
VT-36	5.323
VT-38	3.345
VT-104	4.110
VT-105	1.930
VT-207	0.421
ST. ALBANS STATE HIGHWAY	0.990
TOTAL STATE HIGHWAY	16.119
STATE HIGHWAY - Ramp	
VT-105	0.168
VT-207	0.167
TOTAL STATE HIGHWAY - Ramp	0.335
US HIGHWAY	
US-7	2.897
TOTAL US HIGHWAY	2.897
TOTAL STATE	19.351
INTERSTATE	
I-89	5.584
TOTAL INTERSTATE	5.584
INTERSTATE - Ramp	
I-89	2.139
TOTAL INTERSTATE - Ramp	2.139
TOTAL INTERSTATE	7.723
TOTAL, TRAVELED HIGHWAYS, FEB. 10, 2008: 78.634	
(Excludes Class 4 and Legal Trail Mileage)	

VERMONT GENERAL HIGHWAY MAP
Town of St. Albans
 FRANKLIN COUNTY
 Transportation District #8

Prepared by the
 Vermont Agency of Transportation
 Policy & Planning Division
 in cooperation with
 U.S. Department of Transportation
 Federal Highway Administration

Mileage as of: February 10, 2008
 Map generated: September, 2008

SCALE: 1:31680

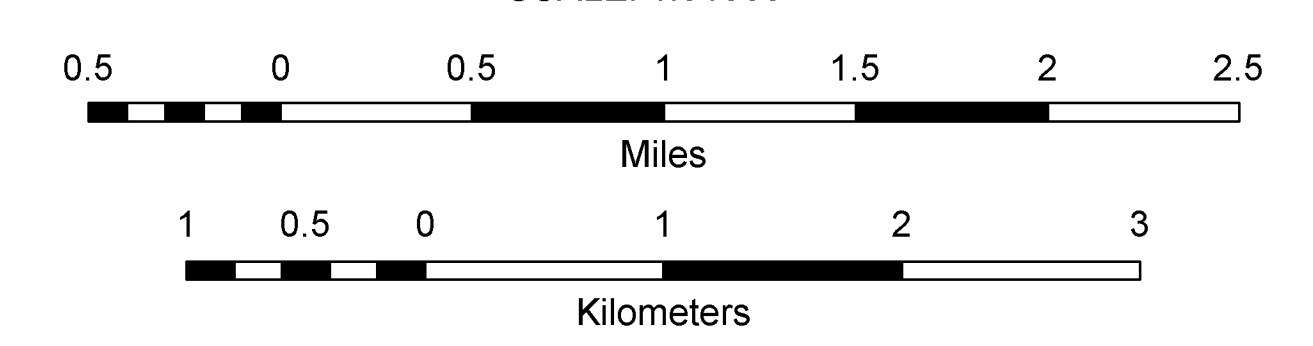

DISCLAIMER:
 The untraveled highways (laid-out town highways), discontinued highways, and legal trails shown hereon are those of which the Agency of Transportation has record; others may exist.
 Highway and bridge data by the Agency of Transportation, Policy & Planning Division. All other data from the Vermont Center for Geographic Information.

