

TOWN HWY. No.	LENGTH IN MILES CLASS 3	LENGTH IN MILES CLASS 4
7	2.42	
8	0.70	
9	1.00	
10	0.20	
11	3.15	
12	0.60	
13	0.10	
14	0.20	
15	0.20	
16	0.42	
17	0.10	
18	4.02	
19	0.08	
20	0.10	
21	2.55	
22		(0.60)
23	3.20	
24	0.44	(0.26)
25	0.55	
26	0.15	
27	0.61	
28	0.40	
29	0.22	
30	0.70	
31	2.24	
32	0.76	
33		(0.40)
34	1.74	(0.06)
35	0.15	
36		(0.90)
37		(0.10)
38	0.10	
39		(0.07)
40	0.13	
41	3.00	
42	1.20	
43	0.20	
44	0.48	
45	0.14	
46	0.04	
47	0.07	
48	0.26	
49	0.29	
50	0.05	
51	0.08	
52	0.33	
53	0.19	
54	0.25	
55	0.25	
56	0.19	
57	0.24	
58	0.10	
59	0.13	
60	0.05	
61	0.09	
62	0.06	
63	0.09	
64	0.05	
65	0.14	
66	0.05	
67	0.11	
68	0.36	
69	0.09	
70	0.06	
71	0.11	
72	0.07	
73	0.08	
74	0.14	
75	0.29	
76	0.26	
77	0.17	
78	0.22	
79	0.17	
80	0.03	
81	0.04	
82	0.18	
83	0.13	(0.03)
84	0.34	
85	0.06	
86	0.08	
TOTAL	38.24	2.42

MILEAGE SUMMARY			
CLASS 1			
TH-1	0.982		
TH-2	1.822		
TOTAL CLASS 1	2.804		
CLASS 2			
TH-1	1.900		
TH-2	5.330		
TH-3	1.150		
TOTAL CLASS 2	8.380		
CLASS 3			
TOTAL CLASS 3	38.24		
TOTAL TOWN	49.424		
STATE HIGHWAY			
VT-105	8.248		
VT-105A	1.799		
TOTAL STATE HIGHWAY	10.047		
TOTAL STATE	10.047		

TOTAL, TRAVELED HIGHWAYS, FEB. 10, 2014: 59.471
 (Excludes Class 4, Legal Trail, and Unidentified Corridor Mileage)

TOWN HWY. No.	LENGTH IN MILES "NOT UP TO STANDARD"
7	(0.05)
12	(0.02)
TOTAL	0.07

*The sections of the town highways listed above are legally Class 3, but have been deemed "Not Up To Standard" and are functionally Class 4 Town Highways

LEGAL TRAIL No.	LENGTH IN MILES LEGAL TRAIL
1	(0.28)
TOTAL	0.28

DISCLAIMER:
 The untraveled highways (laid-out town highways), discontinued highways, and legal trails hereon are those of which the Agency of Transportation has record; others may exist.

Highway and bridge data by the Agency of Transportation. Town short structures are drawn from the Vermont Online Bridge & Culvert Inventory Tool (VOBCIT) database. All other data from the Vermont Center for Geographic Information. Only named streams are shown.

Vermont State Plane Coordinate System
 North American Datum of 1983
 SPCS_Zone_Identifier: 4400
 Geodetic Reference System 80
 4,000-meter grid, Easting - Northing

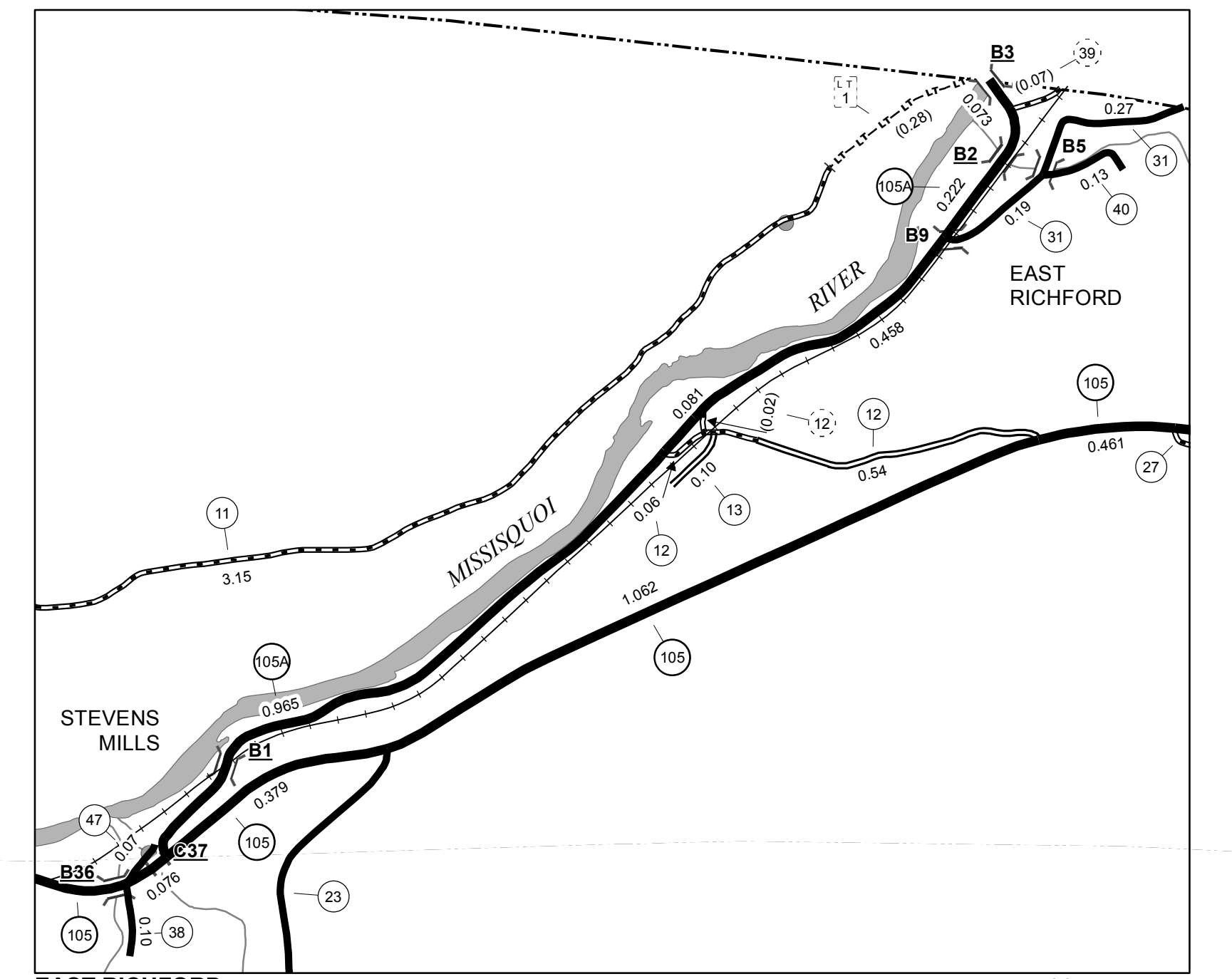

EAST RICHFORD STEVENS MILLS INSET 1
 SCALE 1:12,672

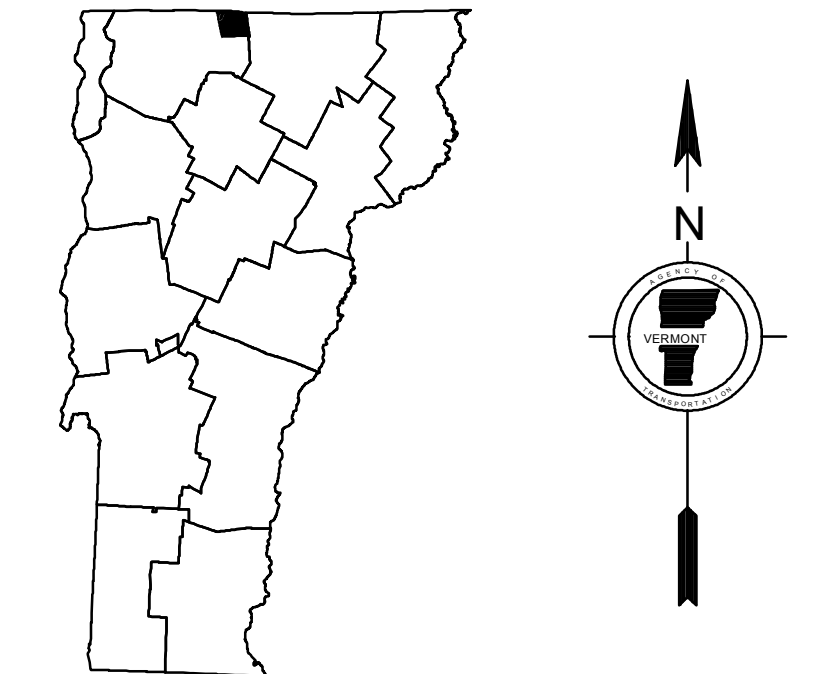
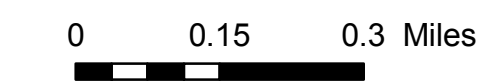

VERMONT GENERAL HIGHWAY MAP
Town of Richford

FRANKLIN COUNTY

Transportation District #8

Prepared by the
 Vermont Agency of Transportation
 Division of Policy, Planning and Intermodal Development
 in cooperation with
 U.S. Department of Transportation
 Federal Highway Administration

Mileage as of February 10, 2014
 Map prepared October 08, 2014

SCALE 1:31,680

