

TOWN HWY. No.	LENGTH IN MILES CLASS 3	CLASS 4
6	3.85	
7	0.05	
8	1.50	
9	1.43	
10	2.80	
11		(0.98)
12	1.43	
13	1.45	(0.70)
14	0.80	
15	1.90	(0.74)
16	0.30	
17	1.65	
18	0.92	
21	0.15	(2.20)
22	2.20	
23	0.13	(0.37)
24	0.55	
25	0.70	
26	0.70	
29	2.79	
30	0.27	
31	1.10	
32	1.10	
34	0.23	
37	2.18	
38	0.11	
TOTAL	30.29	4.99

TOWN HWY. No.	LENGTH IN MILES "NOT UP TO STANDARD"
9	(0.04)
35	(0.08)
TOTAL	0.12

* The sections of the town highways listed above are legally Class 3, but have been deemed "Not Up To Standard" and are functionally Class 4 Town Highways

LEGAL TRAIL No.	LENGTH IN MILES LEGAL TRAIL
1	(0.90)
2	(0.30)
TOTAL	1.20

MILEAGE SUMMARY		
CLASS 2		
TH-1	4.650	
TH-2	0.580	
TH-3	3.620	
TH-4	0.900	
TH-5	1.900	
TH-6	2.150	
TOTAL CLASS 2	13.800	
CLASS 2 - Ramps		
TH-1	0.030	
TOTAL CLASS 2 - Ramps	0.030	
CLASS 3		
TOTAL CLASS 3	30.29	
TOTAL TOWN	44.120	
STATE HIGHWAY		
VT-120	8.505	
VT-236	4.945	
TOTAL STATE HIGHWAY	13.450	
TOTAL STATE	13.450	

TOTAL, TRAVELED HIGHWAYS, FEB. 10, 2020: 57.570
(Excludes Class 4 and Legal Trail Mileage)

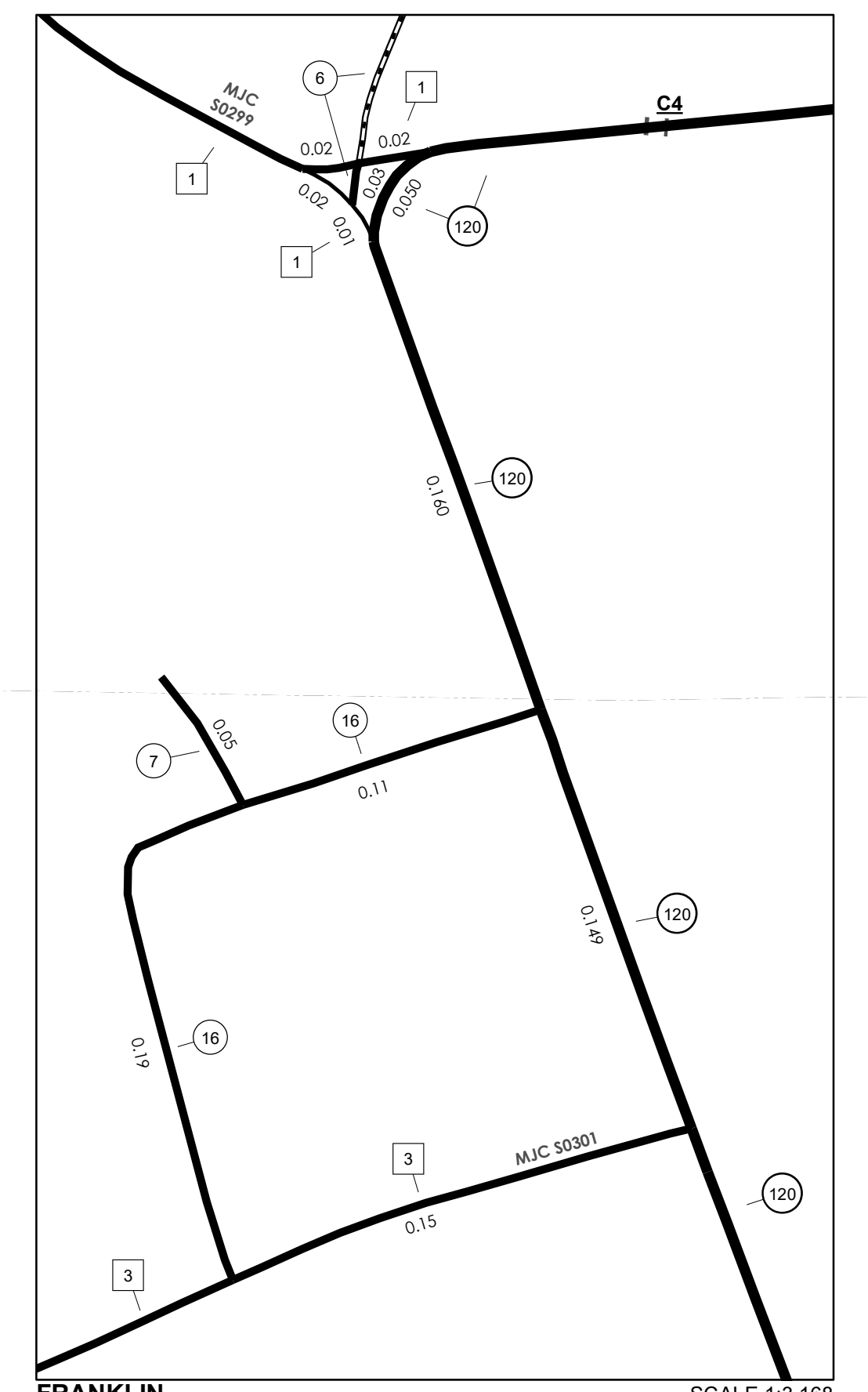

SCALE 1:3,168
0 0.04 0.08 Miles

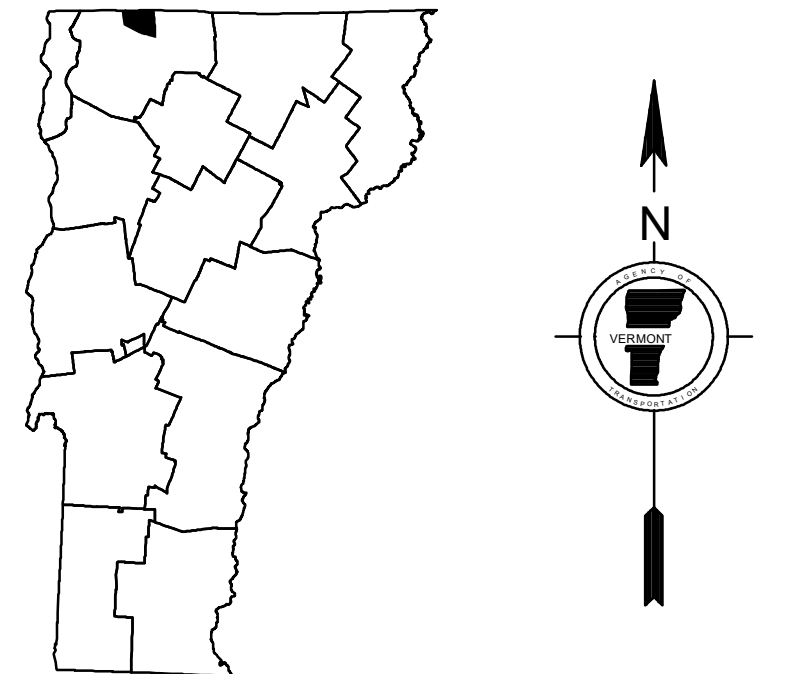

VERMONT GENERAL HIGHWAY MAP

Town of Franklin

FRANKLIN COUNTY

Transportation District #8

Prepared by the Vermont Agency of Transportation
Division of Policy, Planning and Intermodal Development
in cooperation with

U.S. Department of Transportation
Federal Highway Administration

Mileage as of February 10, 2020
Map prepared July 15, 2020

SCALE 1:31,680

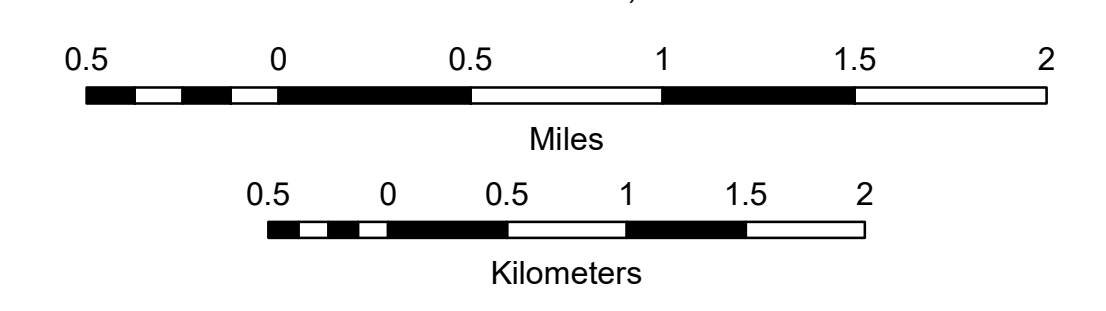

HIGHWAYS	INTERSTATE OR DIVIDED HIGHWAY	POLITICAL SUBDIVISIONS
INTERSTATE	STATE - HARD SURFACE OR PAVED	STATE BOUNDARY
U.S. ROUTE	TOWN - HARD SURFACE OR PAVED	COUNTY BOUNDARY
STATE ROUTE	GRAVEL	TOWN BOUNDARY
CLASS 1	SOIL OR GRADED AND DRAINED EARTH	VILLAGE BOUNDARY
CLASS 2	UNIMPROVED OR PRIMITIVE	URBAN COMPACT BOUNDARY
CLASS 3	IMPASSABLE OR UNTRAVELED	WATER BODY
CLASS 4	LEGAL TRAIL	STREAM OR BROOK
LEGAL TRAIL	DISCONTINUED	BRIDGE OR CULVERT
PARK AND RIDE	HIGHWAY CLASS CHANGE	BRIDGE OR CULVERT > 20'
	RAILROAD	BRIDGE OR CULVERT 6' - 20'
	INACTIVE RAILROAD	BIKE PATH STRUCTURE
	PUBLIC LAND - NATIONAL FOREST	VT CULVERTS BRIDGE
	PUBLIC LAND - STATE/MUNICIPAL	VT CULVERTS CULVERT > 6'
	NATIONAL FOREST ROAD	B34 / C34 STATE BRIDGE OR CULVERT IDENTIFIER
	STATE FOREST HIGHWAY	B34 / C34 TOWN BRIDGE OR CULVERT IDENTIFIER

DISCLAIMER:
The untraveled highways (laid-out town highways), discontinued highways, and legal trails herein are those of which the Agency of Transportation has record; others may exist.

Highway and bridge data by the Agency of Transportation. Town short structures drawn from the VT CULVERTS (formerly VOBCT) online database. All other data from the Vermont Open Geodata Portal. Only named streams shown.

Vermont State Plane Coordinate System
North American Datum of 1983
SPCS_Zone_Identifier: 4400
Geodetic Reference System 80
4,000-meter grid, Easting - Northing