

TOWN HWY. No.	LENGTH IN MILES CLASS 3	CLASS 4	TOWN HWY. No.	LENGTH IN MILES CLASS 3	CLASS 4
5	0.42		47	0.22	
6	0.93	(0.55)	48		(0.60)
8		(0.20)	49	0.30	
10	0.15		50	4.00	
11	3.10		51	0.05	(0.68)
12	0.12		52	1.26	
13	4.08		53	1.61	
14	0.95		54		(0.40)
15	0.30		56	1.00	
16		(0.75)	57	2.50	
17	1.91		58	0.35	
18		(0.30)	59	2.15	
19		(1.80)	60	0.50	
20	0.46	(0.19)	61	0.30	
21	0.95		62	2.82	(0.63)
22	2.13		63	0.29	(0.61)
23	0.32		64		(0.50)
24	2.01	(0.59)	65	2.14	
25	3.60		66	0.51	
26		(0.35)	67	0.40	
27	0.30		68	0.42	(0.20)
28	2.25		69	2.10	
29	1.75		70	0.70	
30	2.51		71	0.40	
31	0.48	(0.52)	72	0.10	(0.22)
32	2.60		74	0.13	
33	3.30		75	0.18	
34	0.89	(0.96)	76	0.09	
35	2.30		77	0.34	
36	0.50		78	0.08	
37	1.53		79	0.11	
38	0.65		80	0.12	
39	1.45		81	0.05	
40	1.47		82	0.10	
41	0.45	(0.95)	83	0.15	
42	1.00	(1.25)	84	0.06	
43	0.60		85	0.08	
44	0.40		87	0.03	
45	0.30	(0.40)	88	0.10	
46			TOTAL	71.90	12.65

TOTAL LENGTH IN MILES "NOT UP TO STANDARD"
 13 (0.23)
 51 (0.12)
 68 (0.24)
 73 (0.17)
TOTAL 0.76

*The sections of the town highways listed above are legally Class 3, but have been deemed "Not Up To Standard" and are functionally Class 4 Town Highways

MILEAGE SUMMARY

CLASS	LENGTH	TOTAL
CLASS 2		
TH-1	8.720	
TH-2	4.700	
TH-3	1.100	
TH-4	4.330	
TH-5	1.100	
TH-6	1.800	
TOTAL CLASS 2		21.750
CLASS 3		
TOTAL CLASS 3		71.90
TOTAL TOWN		93.650
STATE HIGHWAY		
VT-36	9.989	
VT-104	0.111	
TOTAL STATE HIGHWAY		10.100
TOTAL STATE		10.100
INTERSTATE		
I-89	0.207	
TOTAL INTERSTATE		0.207
TOTAL, TRAVELED HIGHWAYS, FEB. 10, 2014: 103.957		

(Excludes Class 4, Legal Trail, and Unidentified Corridor Mileage)

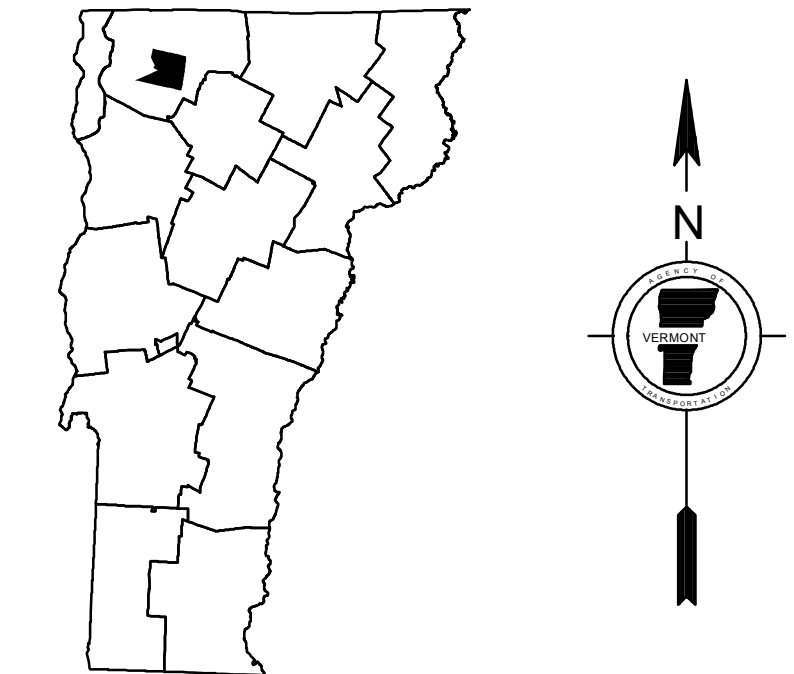
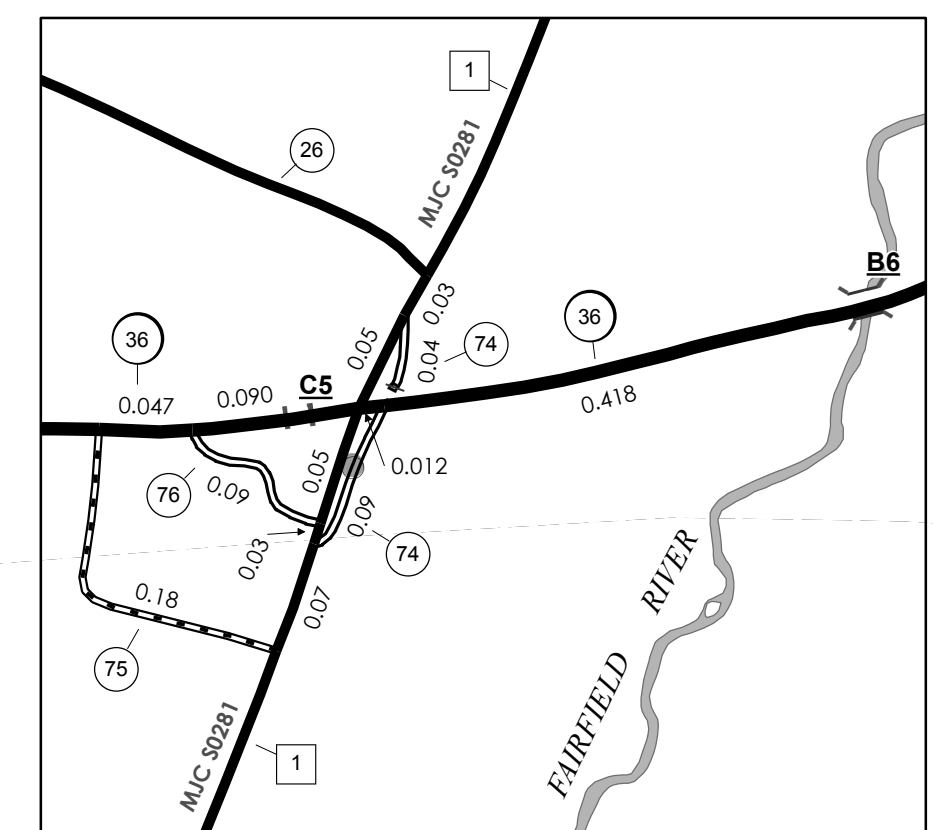
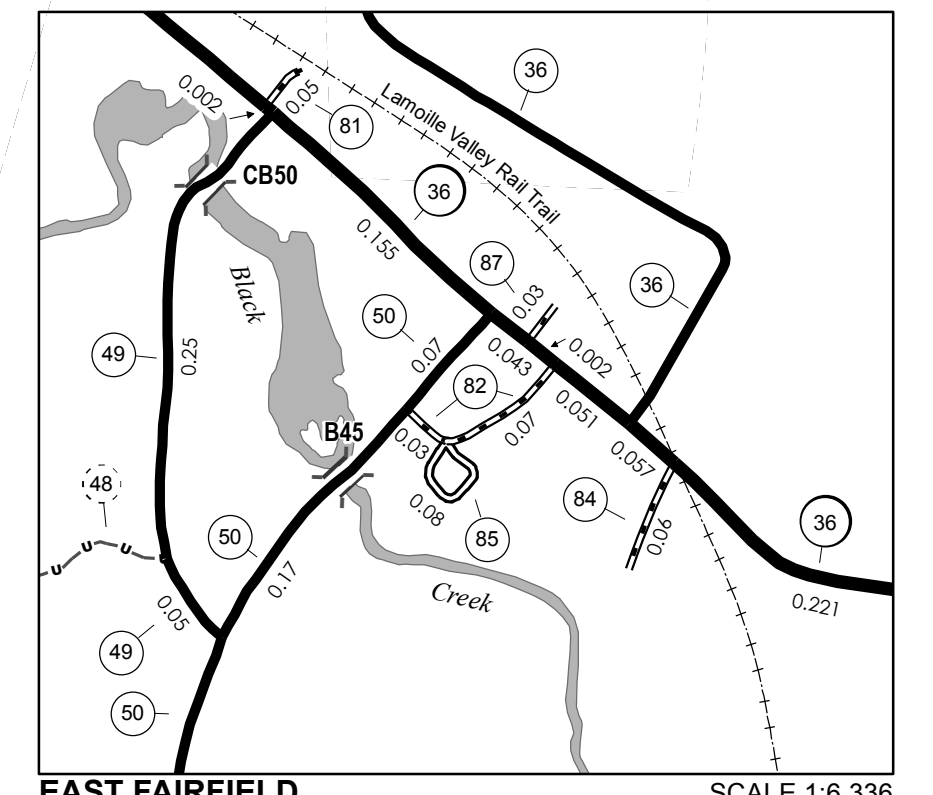

VERMONT GENERAL HIGHWAY MAP
Town of Fairfield
 FRANKLIN COUNTY
 Transportation District #8
 Prepared by the
 Vermont Agency of Transportation
 Division of Policy, Planning and Intermodal Development
 in cooperation with
 U.S. Department of Transportation
 Federal Highway Administration

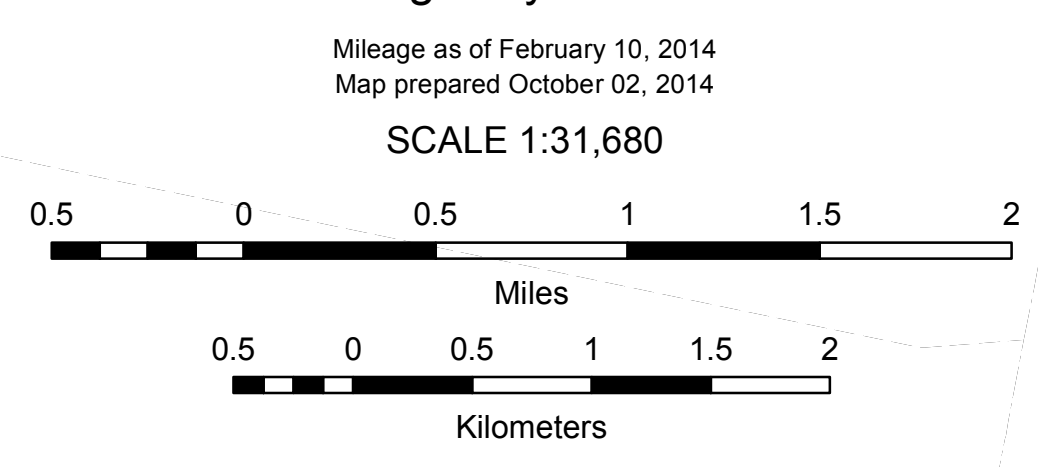

DISCLAIMER:
 The untraveled highways (laid-out town highways), discontinued highways, and legal trails hereon are those of which the Agency of Transportation has record; others may exist.

Highway and bridge data by the Agency of Transportation. Town short structures are drawn from the Vermont Online Bridge & Culvert Inventory Tool (VOBCIT) database. All other data from the Vermont Center for Geographic Information. Only named streams are shown.

Vermont State Plane Coordinate System
 North American Datum of 1983
 SPCS_Zone_Identifier: 4400
 Geodetic Reference System 80
 4,000-meter grid, Easting - Northing