

TOWN HWY. No.	LENGTH IN MILES CLASS 3	LENGTH IN MILES CLASS 4	TOWN HWY. No.	LENGTH IN MILES CLASS 3	LENGTH IN MILES CLASS 4
5	0.42		47	0.22	
6	0.93	(0.55)	48	0.30	(0.60)
8		(0.20)	49	0.30	
10			50	4.00	
11	0.15		51	0.05	(0.68)
12	3.10		52	1.26	
13	0.12		53	1.61	
14	4.08		54		(0.40)
15	0.95		56	1.00	
16	0.30		57	2.50	
17		(0.75)	58	0.35	
18	1.91		59	2.15	
19		(0.30)	60	0.50	
20		(1.80)	61	0.30	
21	0.46	(0.19)	62	2.82	(0.63)
22	0.95		63	0.29	(0.61)
23	2.13		64		(0.50)
24	0.32		65	2.14	
25	2.01	(0.59)	66	0.51	
26	3.60		67	0.40	
27		(0.35)	68	0.42	(0.20)
28	0.30		69	2.10	
29	2.25		70	0.70	
30	1.75		71	0.40	
31	2.51		72	0.10	(0.22)
32	0.48	(0.52)	74	0.13	
33	2.60		75	0.18	
34	3.30		76	0.09	
35	0.89	(0.96)	77	0.34	
36	2.30		78	0.08	
37	0.50		79	0.11	
38	1.53		80	0.12	
39	0.65		81	0.05	
40	1.45		82	0.10	
41	1.47		83	0.15	
42	0.45	(0.95)	84	0.06	
43	1.00	(1.25)	85	0.08	
44	0.60		87	0.03	
45	0.40		88	0.10	
46	0.30	(0.40)	TOTAL	71.90	12.65

TOTAL 0.76

*The sections of the town highways listed above are legally Class 3, but have been deemed "Not Up To Standard" and are functionally Class 4 Town Highways

MILEAGE SUMMARY

CLASS 2		
TH-1	8.720	
TH-2	4.700	
TH-3	1.100	
TH-4	4.330	
TH-5	1.100	
TH-6	1.800	
TOTAL CLASS 2		21.750
CLASS 3		
TOTAL CLASS 3		71.90
TOTAL TOWN		93.650
STATE HIGHWAY		
VT-36	9.989	
VT-104	0.111	
TOTAL STATE HIGHWAY		10.100
TOTAL STATE		10.100
INTERSTATE		
I-89	0.207	
TOTAL INTERSTATE		0.207
TOTAL INTERSTATE		0.207
TOTAL, TRAVELED HIGHWAYS, FEB. 10, 2013:		103.957
<small>(Excludes Class 4, Legal Trail, and Unidentified Corridor Mileage)</small>		

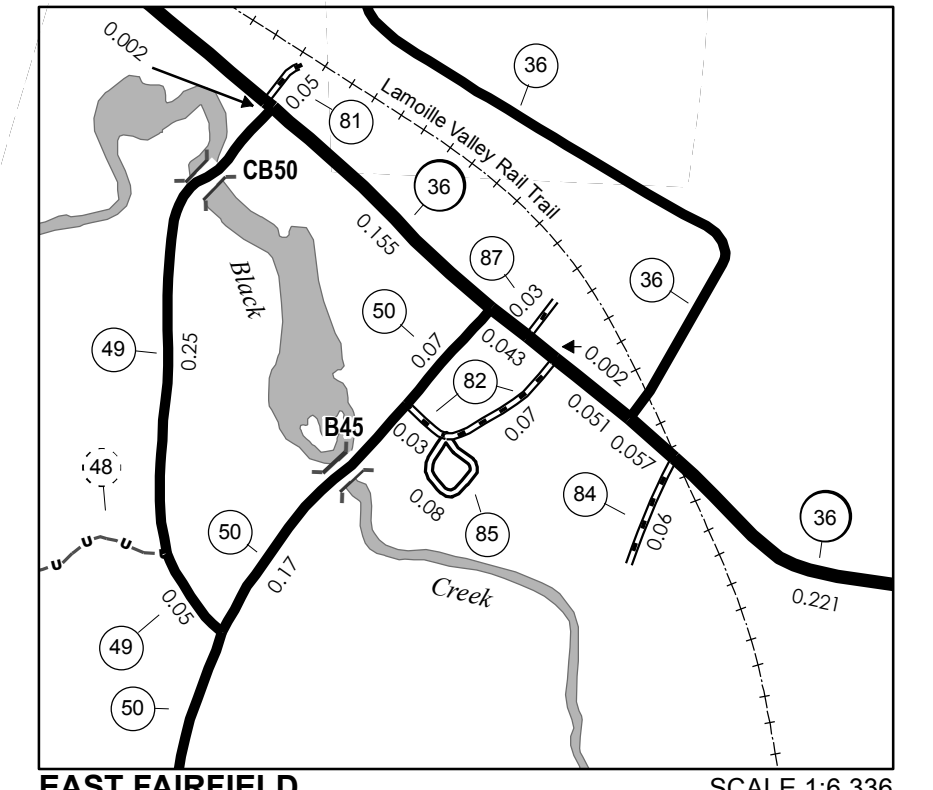

EAST FAIRFIELD INSET 2
SCALE 1:6,336
0 0.08 0.16 Miles

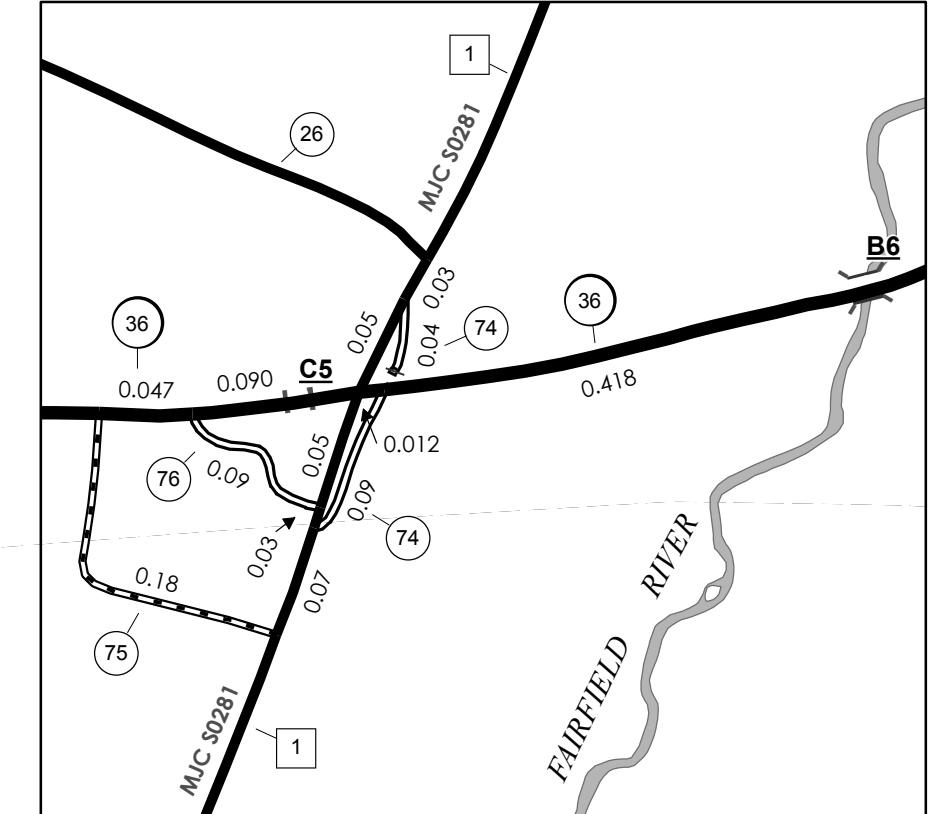

FAIRFIELD INSET 1
SCALE 1:6,336
0 0.08 0.16 Miles

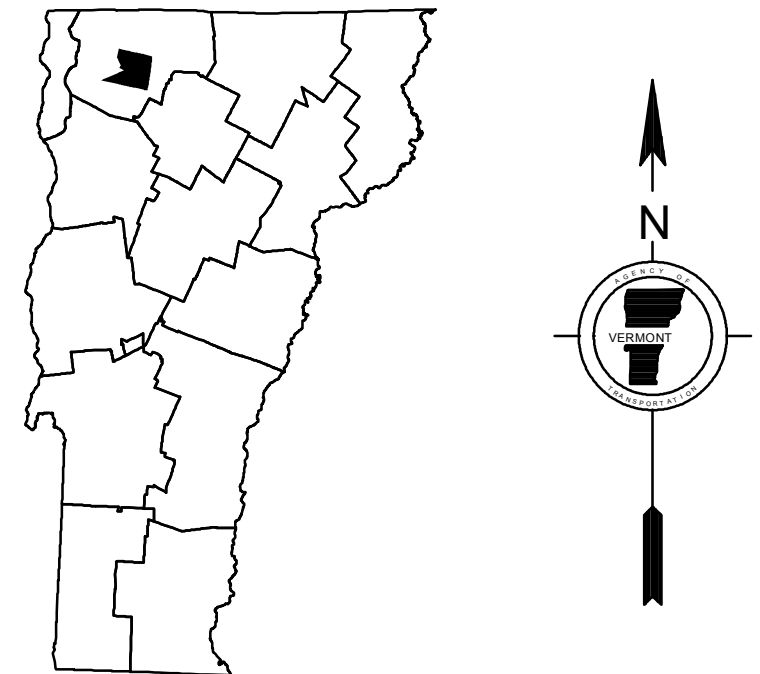

VERMONT
GENERAL HIGHWAY MAP
Town of Fairfield
FRANKLIN COUNTY
Transportation District #8
Prepared by the
Vermont Agency of Transportation
Division of Policy, Planning and Intermodal Development
in cooperation with
U.S. Department of Transportation
Federal Highway Administration

Mileage as of February 10, 2013
Map prepared October 02, 2013
SCALE 1:31,680
0.5 0 0.5 1 1.5 2
Miles
0.5 0 0.5 1 1.5 2
Kilometers

DISCLAIMER:
The untraveled highways (laid-out town highways), discontinued highways, and legal trails hereon are those of which the Agency of Transportation has record; others may exist.
Highway and bridge data by the Agency of Transportation. All other data from the Vermont Center for Geographic Information. Only named streams are shown.

Vermont State Plane Coordinate System
North American Datum of 1983
SPCS_Zone_Identifier: 4400
Geodetic Reference System 80
4,000-meter grid, Easting - Northing