

TOWN HWY. No.	LENGTH IN MILES CLASS 3	LENGTH IN MILES CLASS 4	TOWN HWY. No.	LENGTH IN MILES CLASS 3	LENGTH IN MILES CLASS 4
6	0.66		36	0.30	
7	0.70		37	1.47	
9	0.65		38		(0.63)
10	2.61		39	3.80	
11	2.36		40	0.42	(1.18)
12	0.70		41	0.60	
13	3.30		42	0.40	
14	0.60		43	0.10	
15	2.60		44	0.55	
16	1.15		45	0.30	
17	2.25		46	0.70	
18		(0.15)	47	0.30	
19		(0.63)	48	0.05	
20	0.70		49	0.15	
21	2.60		50	0.21	
22	0.28	(1.07)	51	1.86	
23	0.25		52	0.70	
24	0.65		53	0.15	
25	3.73		54	0.05	
26	0.50		55	0.43	
27		(0.45)	56	0.30	
28	2.05		57	0.10	
29	2.50		58	0.05	
30	0.25		59	0.42	
31	1.05		60	0.46	
32	0.65		61	0.12	
33	1.92	(0.50)	62	0.04	
34	0.08		63	0.06	
35	1.30		64		(0.59)
TOTAL			50.18		5.20

MILEAGE SUMMARY

CLASS 2	LENGTH IN MILES	TOTAL CLASS 2
TH-1	5.200	
TH-2	3.620	
TH-3	0.030	
TH-4	0.570	
TH-5	1.900	
TOTAL CLASS 2		11.320

CLASS 3	LENGTH IN MILES	TOTAL CLASS 3
TOTAL CLASS 3		50.18
TOTAL TOWN		61.500

STATE HIGHWAY	LENGTH IN MILES	TOTAL STATE HIGHWAY
VT-104	14.185	
VT-104A	1.185	
VT-128	0.787	
TOTAL STATE HIGHWAY		16.137

INTERSTATE	LENGTH IN MILES	TOTAL INTERSTATE
I-89	1.240	
TOTAL INTERSTATE		1.240

TOTAL, TRAVELED HIGHWAYS, FEB. 10, 2018: 78.877
(Excludes Class 4 and Legal Trail Mileage)

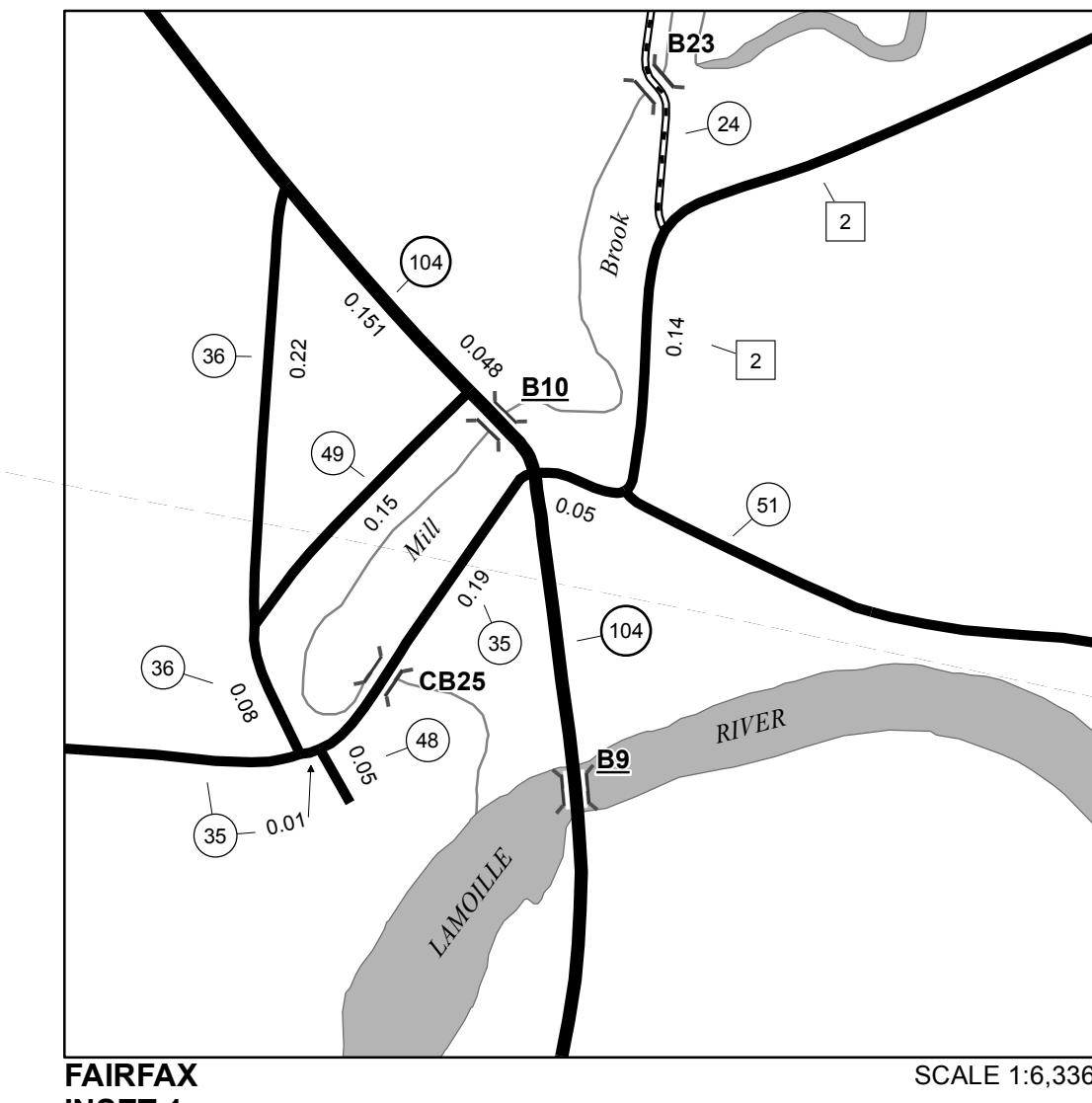

SCALE 1:6,336
0 0.08 0.16 Miles

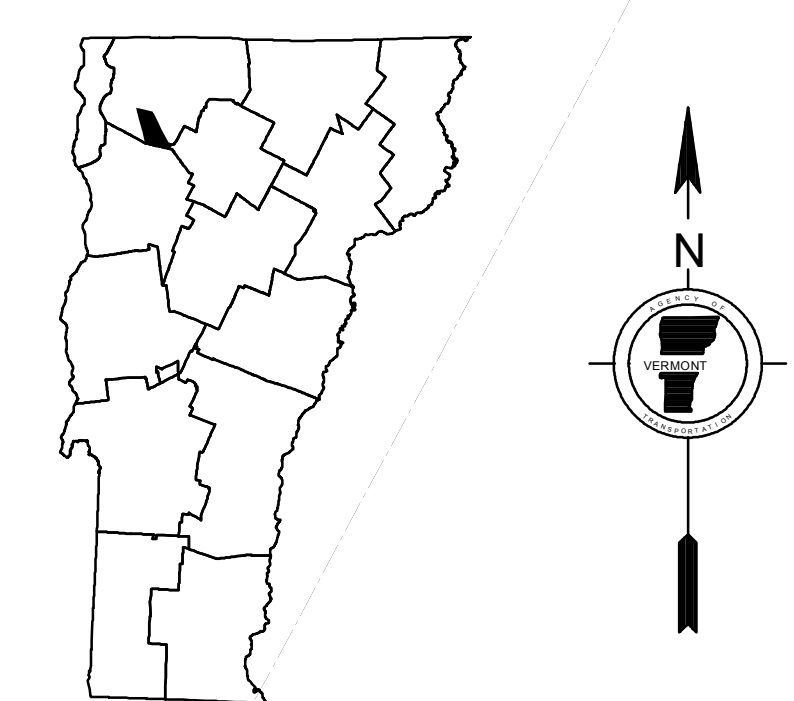

VERMONT
GENERAL HIGHWAY MAP
Town of Fairfax
FRANKLIN COUNTY
Transportation District #8
Prepared by the
Vermont Agency of Transportation
Division of Policy, Planning and Intermodal Development
in cooperation with
U.S. Department of Transportation
Federal Highway Administration

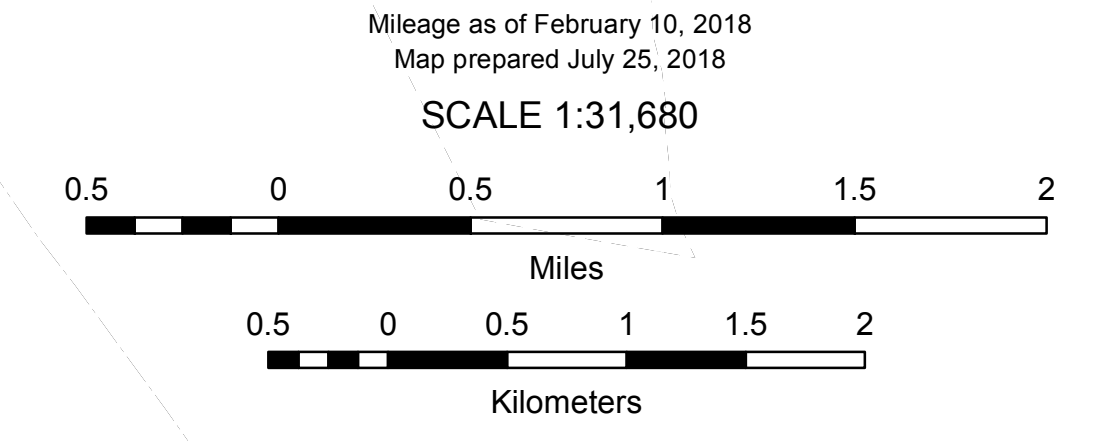

- HIGHWAYS**
- INTERSTATE
 - U.S. ROUTE
 - STATE ROUTE
 - CLASS 1
 - CLASS 2
 - CLASS 3
 - CLASS 4
 - LEGAL TRAIL
 - PARK AND RIDE
 - INTERSTATE OR DIVIDED HIGHWAY
 - STATE - HARD SURFACE OR PAVED
 - TOWN - HARD SURFACE OR PAVED
 - GRAVEL
 - SOIL OR GRADED AND DRAINED EARTH
 - UNIMPROVED OR PRIMITIVE
 - IMPASSABLE OR UNTRAVELED
 - LEGAL TRAIL
 - DISCONTINUED
 - HIGHWAY CLASS CHANGE
 - RAILROAD
 - INACTIVE RAILROAD
 - PUBLIC LAND - NATIONAL FOREST
 - PUBLIC LAND - STATE/MUNICIPAL
 - NATIONAL FOREST ROAD
 - STATE FOREST HIGHWAY
- POLITICAL SUBDIVISIONS**
- STATE BOUNDARY
 - COUNTY BOUNDARY
 - TOWN BOUNDARY
 - VILLAGE BOUNDARY
 - URBAN COMPACT BOUNDARY
 - WATER BODY
 - STREAM OR BROOK
- BRIDGE OR CULVERT**
- BRIDGE OR CULVERT > 20'
 - BRIDGE OR CULVERT 6' - 20'
 - BIKE PATH STRUCTURE
 - VT CULVERTS BRIDGE
 - VT CULVERTS CULVERT > 6'
 - STATE BRIDGE OR CULVERT IDENTIFIER
 - TOWN BRIDGE OR CULVERT IDENTIFIER
- FEDERAL CLASSIFICATION IDENTIFIER**
- MA MINOR ARTERIAL
 - MJC MAJOR COLLECTOR
 - MNC MINOR COLLECTOR
 - PA PRINCIPAL ARTERIAL

DISCLAIMER:
The untraveled highways (laid-out town highways), discontinued highways, and legal trails herein are those of which the Agency of Transportation has record; others may exist.

Highway and bridge data by the Agency of Transportation. Town short structures drawn from the VTCULVERTS (formerly VOBCIT) online database. All other data from the Vermont Center for Geographic Information. Only named streams shown.

Vermont State Plane Coordinate System
North American Datum of 1983
SPCS_Zone_Identifier: 4400
Geodetic Reference System 80
4,000-meter grid, Easting - Northing