

TOWN HWY. NO.	LENGTH IN MILES CLASS 3	LENGTH IN MILES CLASS 4
8	2.640	(0.060)
9	2.890	(0.040)
9		(0.070)
10		(0.430)
11	1.590	(0.360)
12	0.300	
13		(0.750)
14	1.840	(0.150)
15	2.400	
16		(0.250)
17	1.500	
18	0.030	
19	0.090	
20		(0.050)
21	0.070	
22	0.300	
23	0.600	
24	1.550	
25	0.300	(0.950)
26	2.250	
27	0.430	
28		(0.700)
29	3.490	
30	0.200	
31	0.410	
32		(1.000)
33	0.500	(0.800)
34	2.500	
35	0.350	
36	3.720	
37	0.200	(0.800)
38	0.650	(1.700)
38		(0.050)
39	0.100	
40	1.500	
41		(0.150)
42	1.430	(1.040)
43	0.480	
45	0.100	
46	0.630	
47	0.520	
TOTAL	35.560	9.350

* This portion of town highway is Class 3, but is functionally Class 4

MILEAGE SUMMARY

CLASS 2		
TH-1	0.300	
TH-3	6.380	
TH-4	4.120	
TH-5	4.100	
TH-6	0.200	
TH-7	0.550	
TOTAL CLASS 2	15.650	
CLASS 3		
TOTAL CLASS 3	35.560	
TOTAL TOWN	51.210	
STATE HIGHWAY		
VT-105	3.700	
VT-108	6.905	
VT-118	1.565	
VT-120	0.389	
TOTAL STATE HIGHWAY	12.559	
TOTAL STATE	12.559	

TOTAL, TRAVELED HIGHWAYS, FEB. 10, 2007: 63.769
(Excludes Class 4 and Legal Trail Mileage)

- HIGHWAYS**
- INTERSTATE
- U.S. ROUTE
- STATE ROUTE
- CLASS 1
- CLASS 2
- CLASS 3
- CLASS 4
- LEGAL TRAIL
- INTERSTATE OR DIVIDED HIGHWAY
- STATE - HARD SURFACE OR PAVED
- TOWN - HARD SURFACE OR PAVED
- GRAVEL
- SOIL OR GRADED AND DRAINED EARTH
- UNIMPROVED OR PRIMITIVE
- IMPASSABLE OR UNTRAVELED
- LEGAL TRAIL
- DISCONTINUED
- HIGHWAY CLASS CHANGE
- RAILROAD
- PUBLIC LAND
- POLITICAL SUBDIVISIONS**
- STATE BOUNDARY
- COUNTY BOUNDARY
- TOWN BOUNDARY
- VILLAGE BOUNDARY
- URBAN COMPACT BOUNDARY
- WATER BODIES**
- OPEN WATER
- SWAMP
- STREAM OR BROOK
- BRIDGE OR CULVERT**
- BRIDGE OR CULVERT GREATER THAN 20'
- BRIDGE OR CULVERT 6' - 20'
- B34 STATE BRIDGE IDENTIFIER
- B34 TOWN BRIDGE IDENTIFIER
- FEDERAL CLASSIFICATION IDENTIFIER**
- FAU URBAN ARTERIAL OR COLLECTOR
- MA MINOR ARTERIAL
- MJC MAJOR COLLECTOR
- MINC MINOR COLLECTOR
- PA PRINCIPAL ARTERIAL

DISCLAIMER:

The untraveled highways (laid-out town highways), discontinued highways, and legal trails shown hereon are those of which the Agency of Transportation has record; others may exist.

Highway and bridge data by the Agency of Transportation, Policy & Planning Division. All other data from the Vermont Center for Geographic Information.

Vermont State Plane Coordinate System
North American Datum of 1983
SPCS_Zone_Identifier: 4400
Geodetic Reference System 80
4,000-meter grid, Easting - Northing

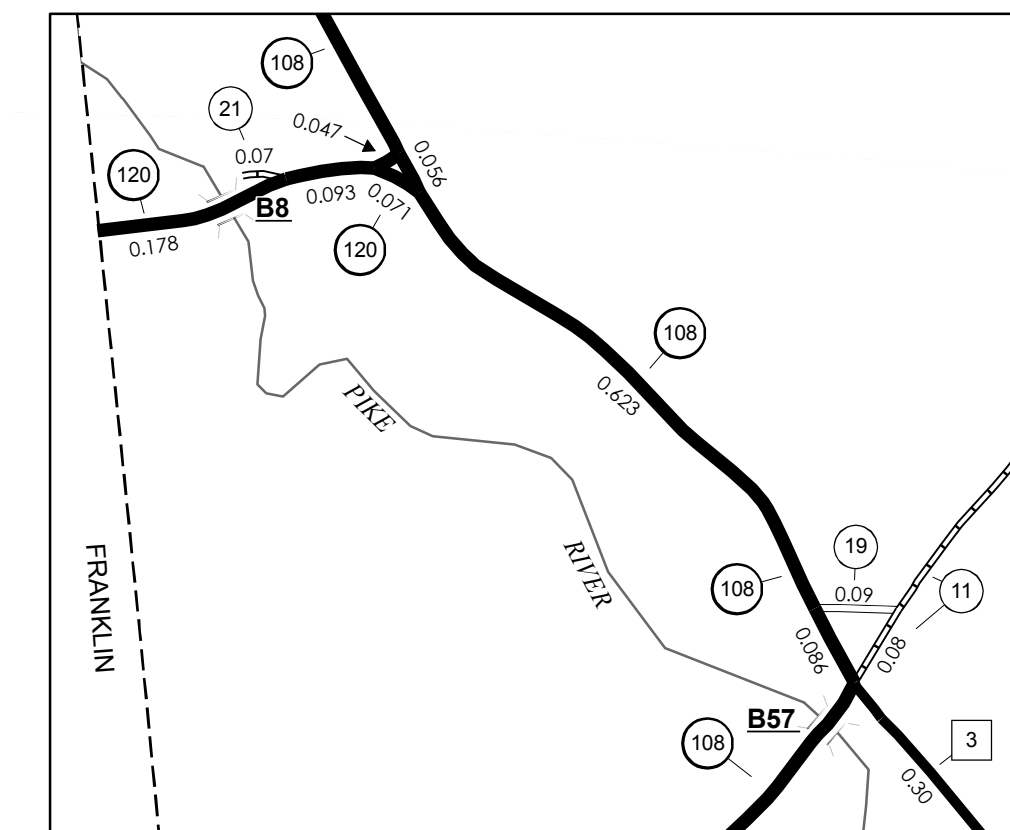
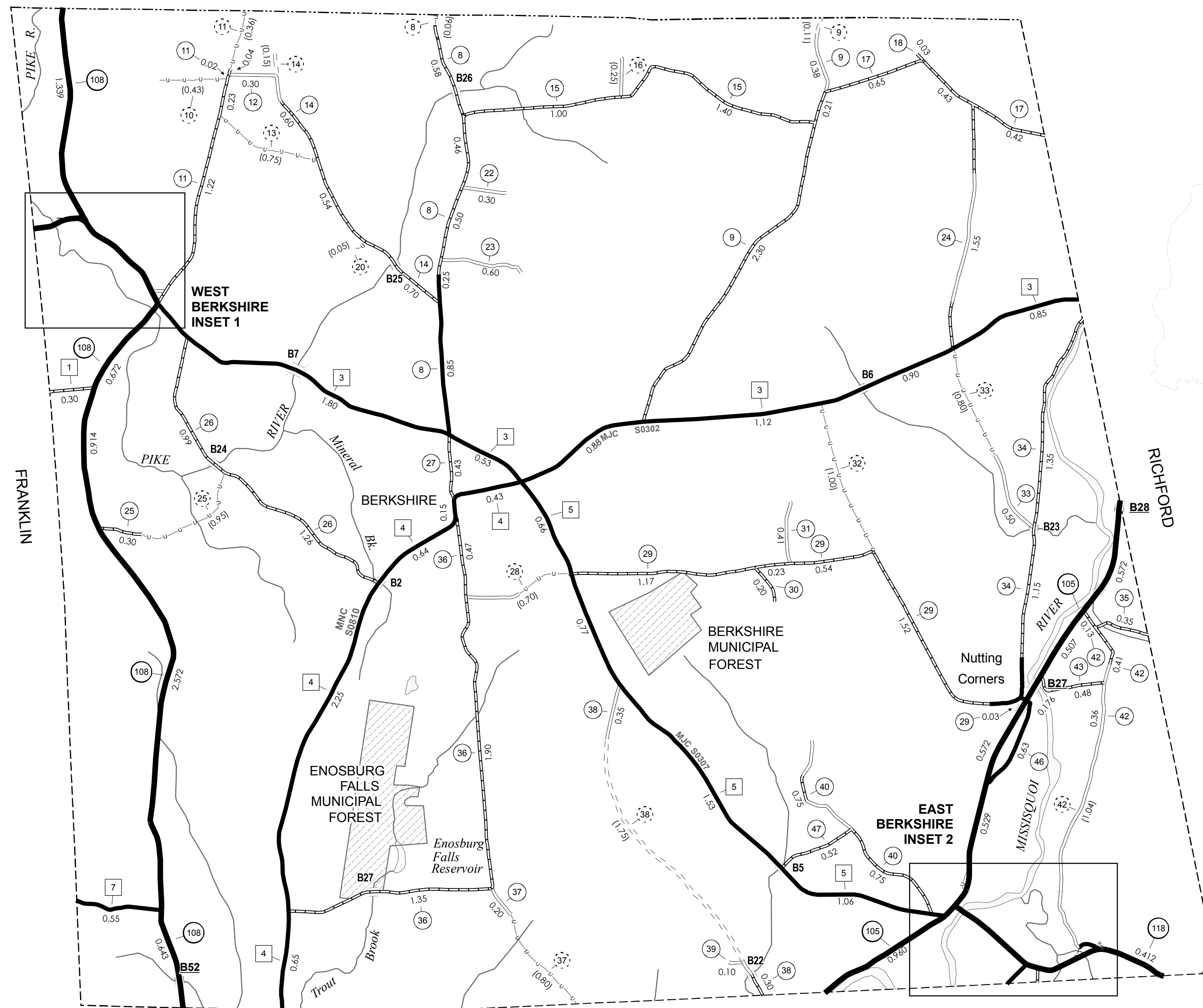

WEST BERKSHIRE INSET 1 SCALE 1:12672

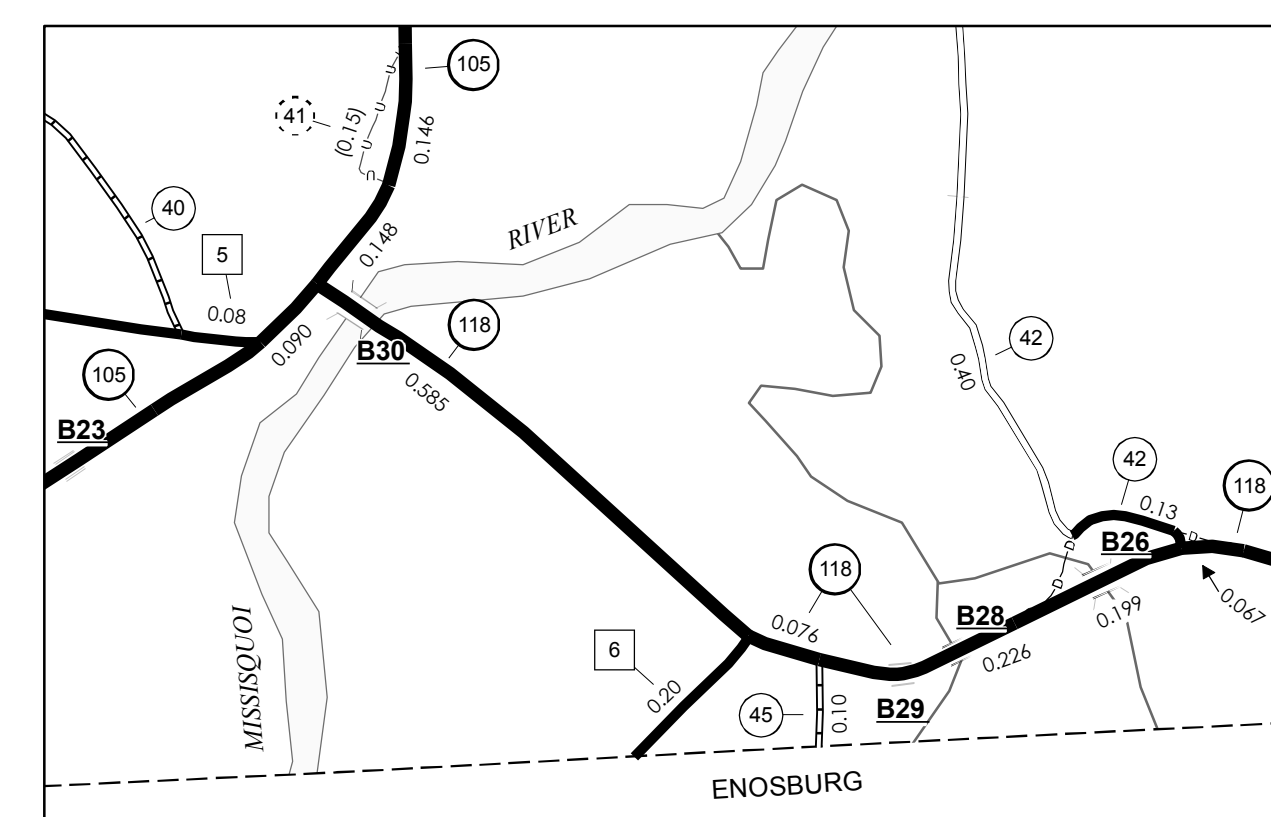
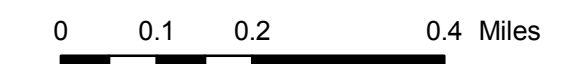

EAST BERKSHIRE INSET 2 SCALE 1:12672

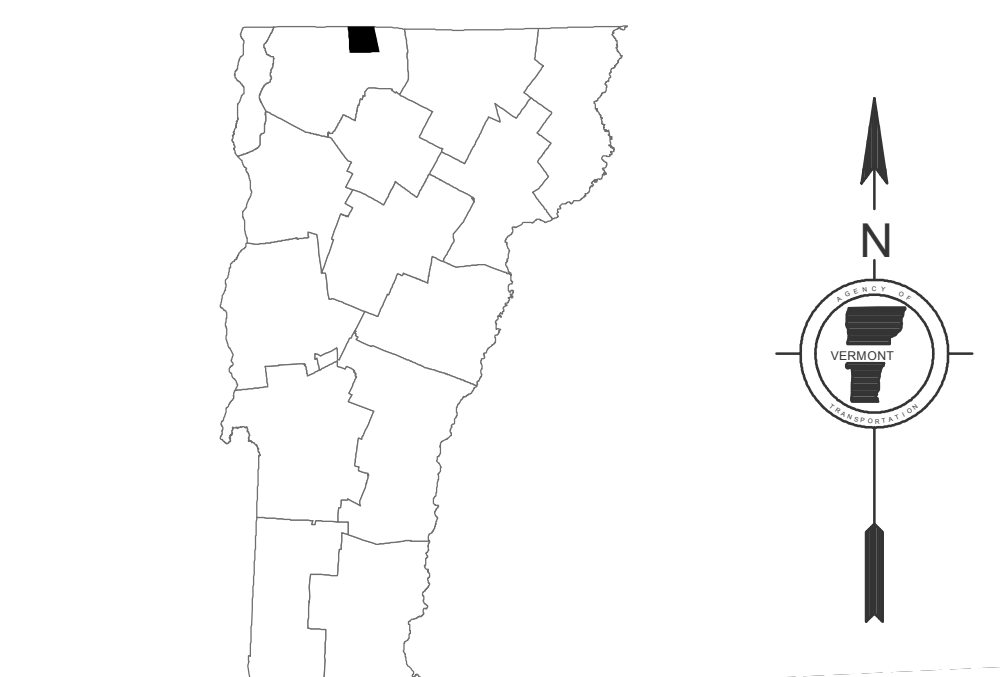
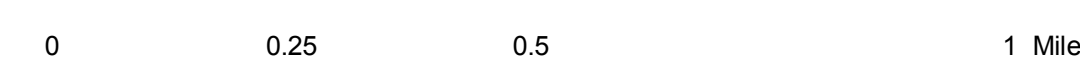

VERMONT
GENERAL HIGHWAY MAP
Town of Berkshire
FRANKLIN COUNTY

Transportation District #8

Prepared by the
Vermont Agency of Transportation
Policy & Planning Division
in cooperation with
U.S. Department of Transportation
Federal Highway Administration

Mileage as of: Feb. 10, 2007
Map generated: October, 2007

SCALE: 1:31680

