

464,000 468,000 472,000 476,000 480,000 484,000 488,000

TOWN HWY. NO.	LENGTH IN MILES CLASS 3	LENGTH IN MILES CLASS 4
4	0.350	
5	0.450	
6	0.790	
7	0.330	
8	3.200	
9	0.250	
10	1.700	
11	0.200	
13	0.510	(1.540)
14	1.480	(1.380)
15	0.640	
17		(0.650)
18	0.360	(0.140)
19	0.130	(0.620)
20	3.090	
21	0.150	
22	0.220	(0.680)
23	0.900	
25	1.800	
26		(0.200)
27	0.650	(0.180)
28	1.100	
29	1.030	
30	0.100	
31	0.300	
32	1.580	(0.120)
33	0.290	(0.790)
34	2.060	
35	1.300	(1.550)
36	0.200	
37	2.850	
38	2.280	
39	0.480	(0.720)
40	0.110	(1.290)
42	0.240	
43	0.140	
44	0.380	
45	0.170	
TOTAL	31.810	9.860

MILEAGE SUMMARY

CLASS 2		
TH-1	2.550	
TH-2	6.810	
TOTAL CLASS 2	9.360	
CLASS 3		
TOTAL CLASS 3	31.810	
TOTAL TOWN	41.170	
STATE HIGHWAY		
VT-36	2.507	
VT-108	8.032	
TOTAL STATE HIGHWAY	10.539	
TOTAL STATE	10.539	

TOTAL, TRAVELED HIGHWAYS, FEB. 10, 2008: 51.709
(Excludes Class 4 and Legal Trail Mileage)

- HIGHWAYS**
- INTERSTATE
 - U.S. ROUTE
 - STATE ROUTE
 - CLASS 1
 - CLASS 2
 - CLASS 3
 - CLASS 4
 - LEGAL TRAIL
 - INTERSTATE OR DIVIDED HIGHWAY
 - STATE - HARD SURFACE OR PAVED
 - TOWN - HARD SURFACE OR PAVED
 - GRAVEL
 - SOIL OR GRADED AND DRAINED EARTH
 - UNIMPROVED OR PRIMITIVE
 - IMPASSABLE OR UNTRAVELED
 - LEGAL TRAIL
 - DISCONTINUED
 - HIGHWAY CLASS CHANGE
 - RAILROAD

- PUBLIC LAND**
- POLITICAL SUBDIVISIONS**
- STATE BOUNDARY
 - COUNTY BOUNDARY
 - TOWN BOUNDARY
 - VILLAGE BOUNDARY
 - URBAN COMPACT
 - OPEN WATER
 - STREAM OR BROOK
 - BRIDGE OR CULVERT
 - BRIDGE OR CULVERT GREATER THAN 20'
 - BRIDGE OR CULVERT 6' - 20'
- B34 / C34 STATE BRIDGE OR CULVERT IDENTIFIER**
B34 / C34 TOWN BRIDGE OR CULVERT IDENTIFIER
- FEDERAL CLASSIFICATION IDENTIFIER**
- FAU URBAN ARTERIAL OR COLLECTOR
 - MA MINOR ARTERIAL
 - MJC MAJOR COLLECTOR
 - MNC MINOR COLLECTOR
 - PA PRINCIPAL ARTERIAL

DISCLAIMER:
The untraveled highways (laid-out town highways), discontinued highways, and legal trails shown hereon are those of which the Agency of Transportation has record; others may exist.
Highway and bridge data by the Agency of Transportation, Policy & Planning Division. All other data from the Vermont Center for Geographic Information.

STRUCTURES - SURFACE WATER NOTE:
Town short structures (bridges or culverts from 6-feet to less than 20-feet) were not represented due to inconsistencies in the data.
The surface waters are from the Vermont Hydrological Dataset (VHD). Only the named streams are shown.

Vermont State Plane Coordinate System
North American Datum of 1983
SPCS Zone Identifier: 4400
Geodetic Reference System 80
4,000-meter grid, Easting - Northing

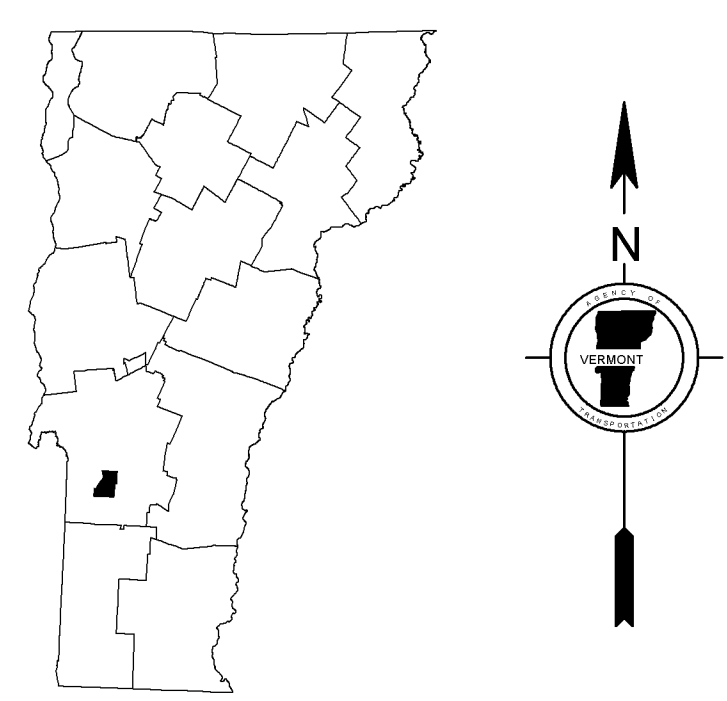
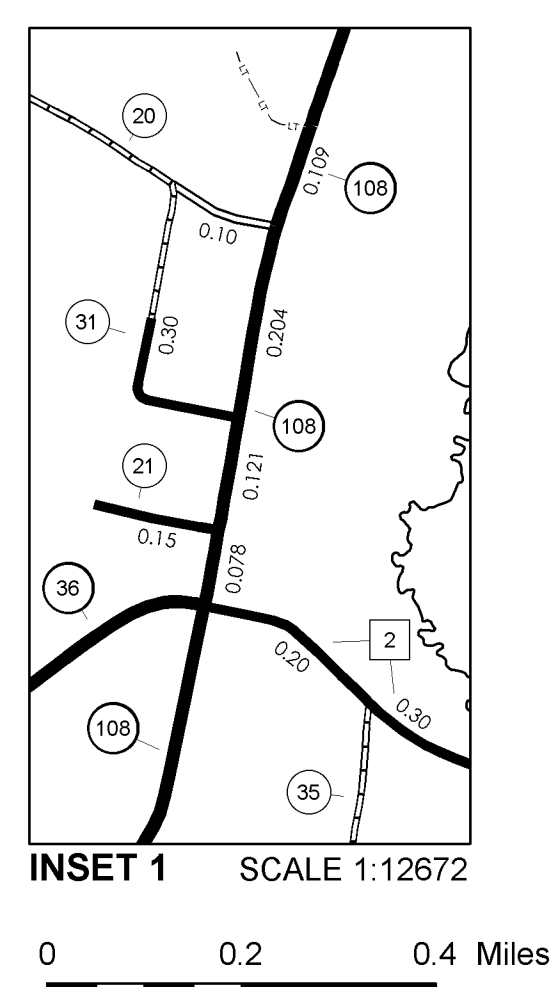
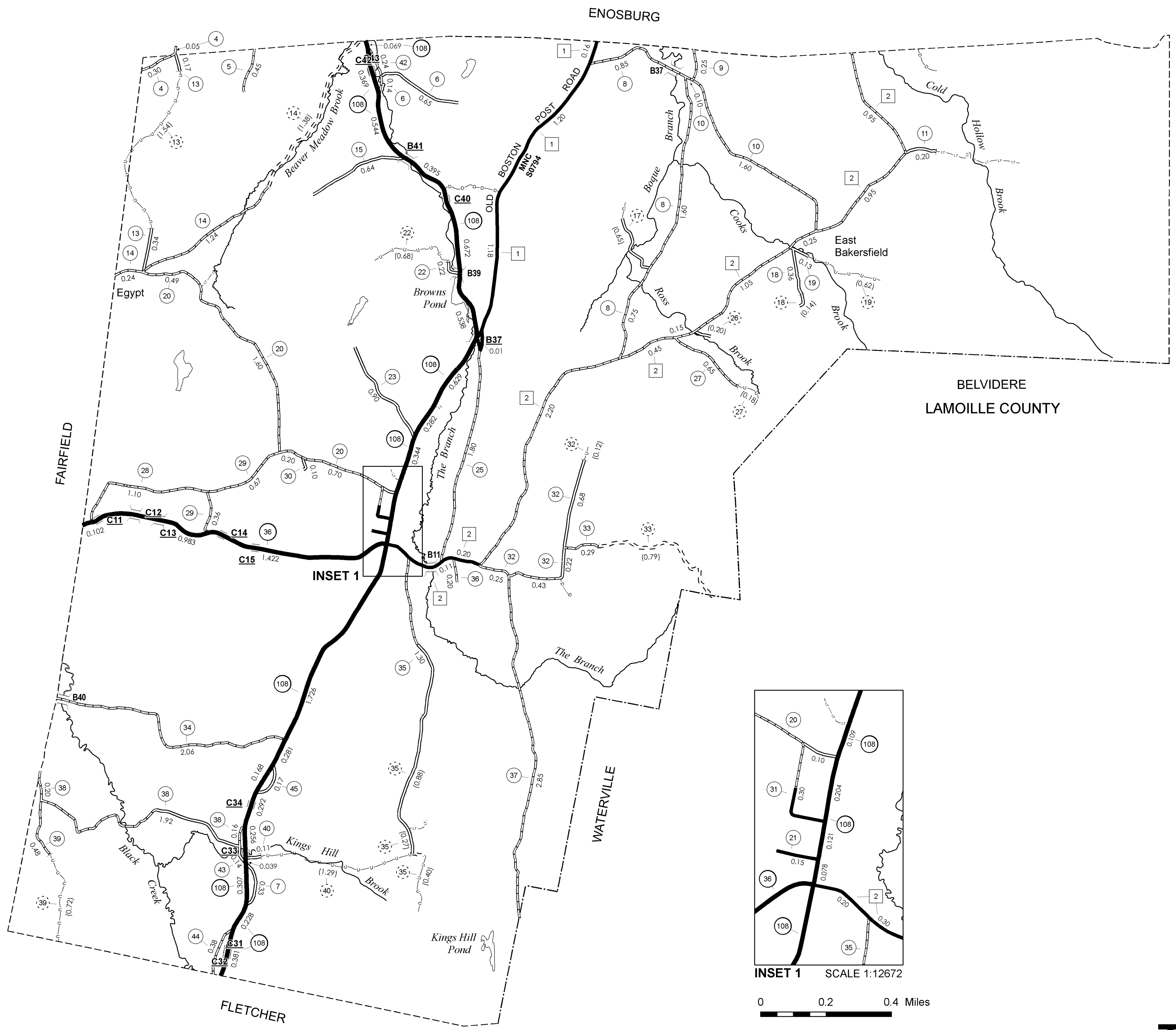

VERMONT
GENERAL HIGHWAY MAP
Town of Bakersfield
FRANKLIN COUNTY

Transportation District #8

Prepared by the
Vermont Agency of Transportation
Policy & Planning Division
in cooperation with
U.S. Department of Transportation
Federal Highway Administration

Mileage as of: February 10, 2008
Map generated: September, 2008

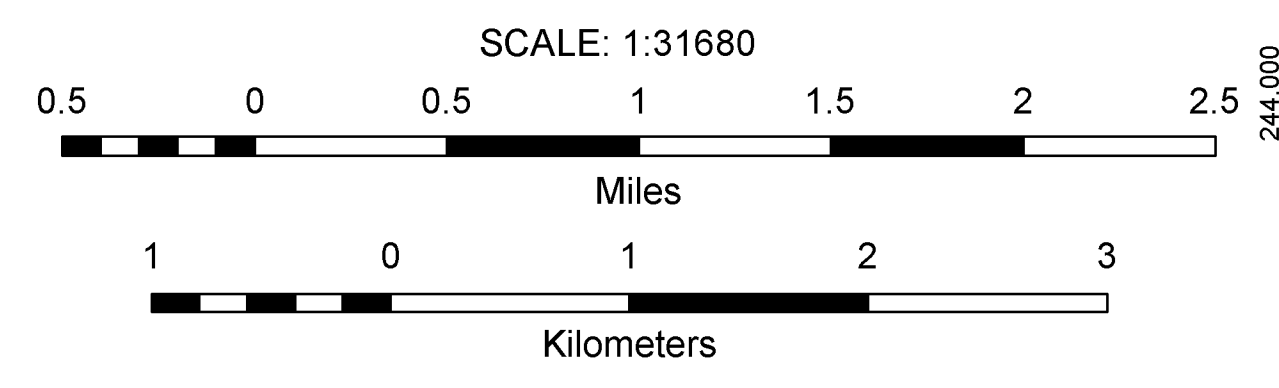

464,000 468,000 472,000 476,000 480,000 484,000 488,000

