

TOWN HWY. No.	CLASS 3	CLASS 4	LENGTH IN MILES
1	0.40		
2	0.12		
3	0.15	(0.50)	
5		(0.60)	
6		(1.03)	
7		(1.42)	
8	0.05		
9	0.18		
10		(0.36)	
11		(0.08)	
12		(0.37)	
13	0.03		
14	0.05		
<b>TOTAL</b>	<b>0.98</b>	<b>4.36</b>	

TOWN HWY. No.	LENGTH IN MILES "NOT UP TO STANDARD"
10	(0.04)
13	(0.07)
<b>TOTAL</b>	<b>0.11</b>

\* The sections of the town highways listed above are legally Class 3, but have been deemed "Not Up to Standard" and are functionally Class 4 Town Highways

**MILEAGE SUMMARY**

CLASS 3	TOTAL CLASS 3	0.98
<b>TOTAL TOWN</b>	<b>0.980</b>	
STATE HIGHWAY		
VT-114	9.982	
VT-147	0.178	
NSH-NSH	0.573	
<b>TOTAL STATE HIGHWAY</b>	<b>10.733</b>	
<b>TOTAL STATE</b>	<b>10.733</b>	
<b>TOTAL, TRAVELED HIGHWAYS, FEB. 10, 2017:</b>	<b>11.713</b>	

(Excludes Class 4 and Legal Trail Mileage)

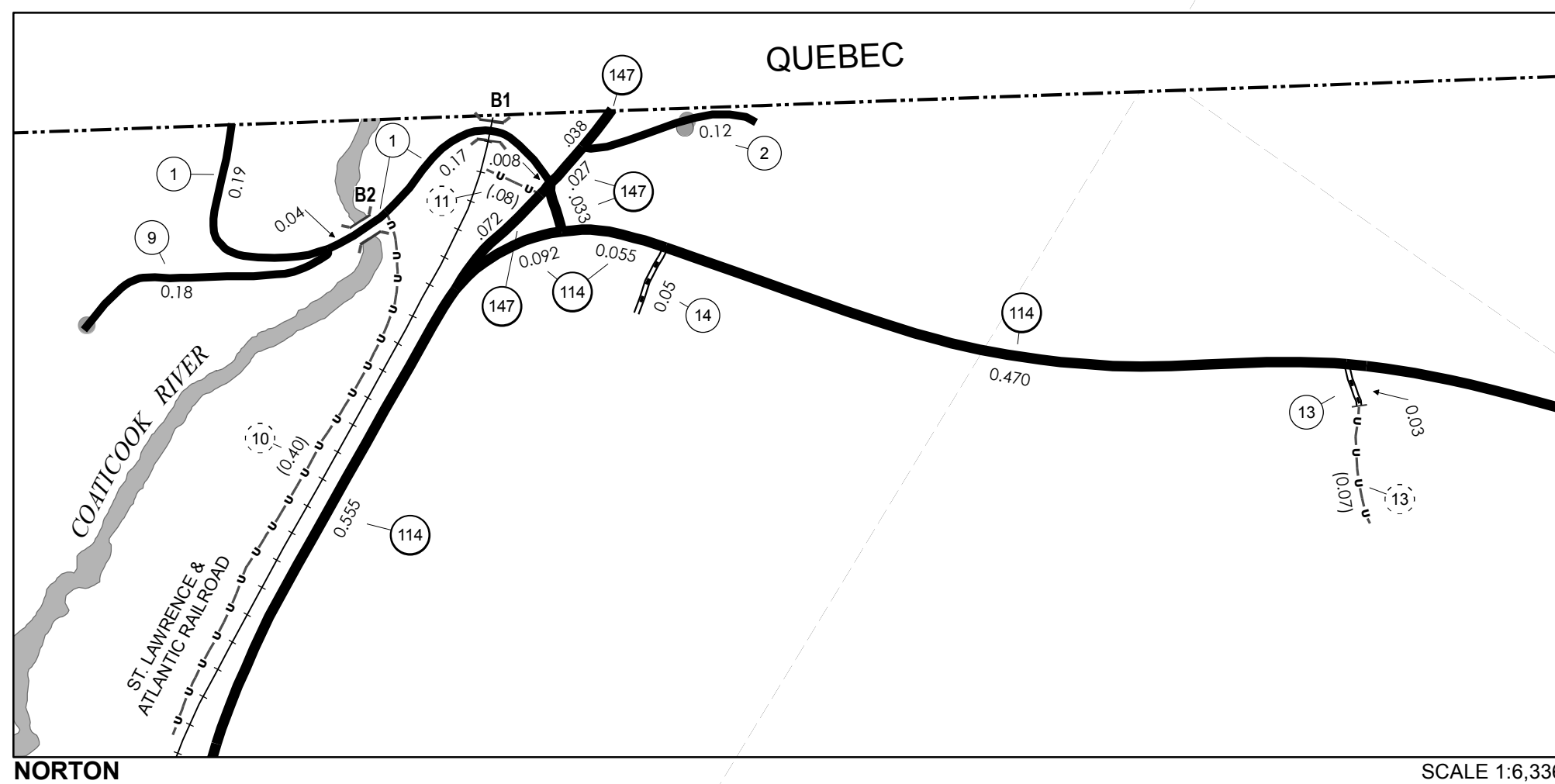

0 0.08 0.16 Miles

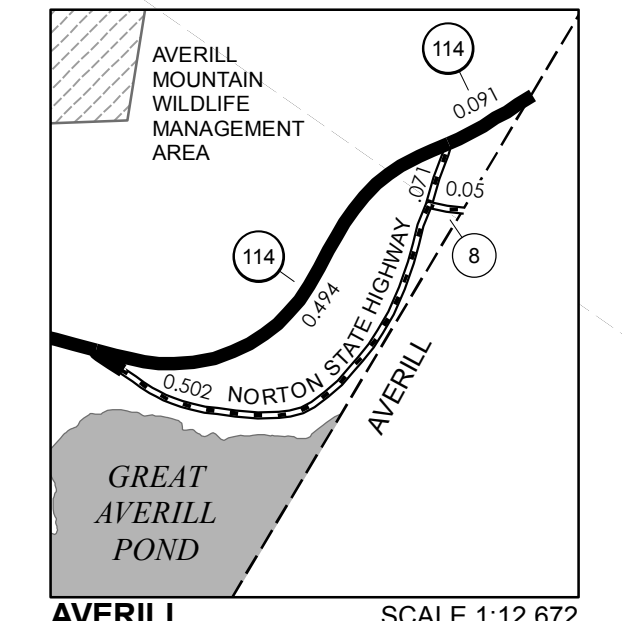

SCALE 1:12,672

0 0.15 0.3 Miles

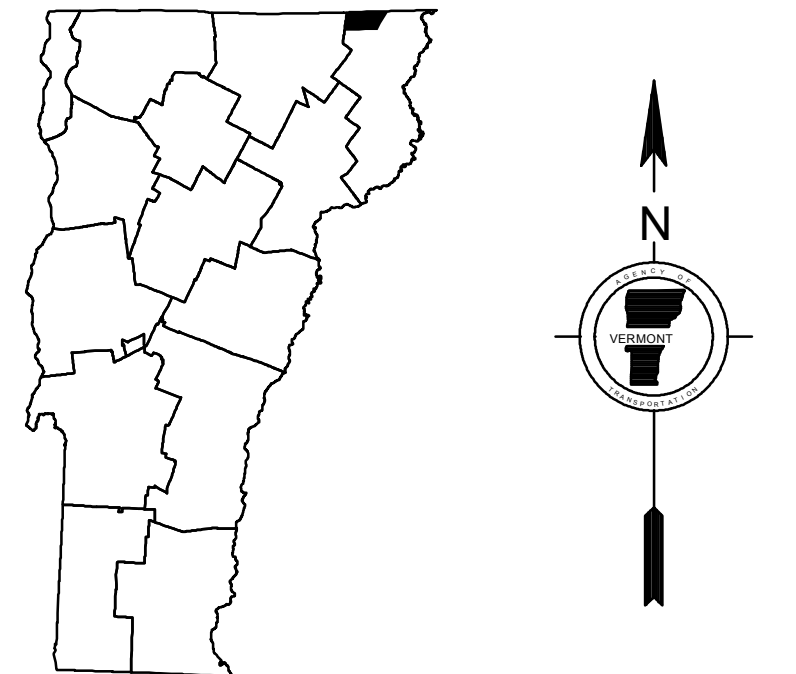

**VERMONT**  
**GENERAL HIGHWAY MAP**  
**Town of Norton**  
**ESSEX COUNTY**

Transportation District #9  
 Prepared by the  
**Vermont Agency of Transportation**  
 Division of Policy, Planning and Intermodal Development  
 in cooperation with  
**U.S. Department of Transportation**  
**Federal Highway Administration**

Mileage as of February 10, 2017  
 Map prepared June 23, 2017  
**SCALE 1:31,680**

0.5 0 0.5 1 1.5 2  
 Miles

0.5 0 0.5 1 1.5 2  
 Kilometers

**DISCLAIMER:**  
 The untraveled highways (laid-out town highways), discontinued highways, and legal trails herein are those of which the Agency of Transportation has record; others may exist.

Highway and bridge data by the Agency of Transportation. Town short structures drawn from the Vermont Online Bridge & Culvert Inventory Tool (VOBCIT) database. All other data from the Vermont Center for Geographic Information. Only named streams shown.

Vermont State Plane Coordinate System  
 North American Datum of 1983  
 SPCS\_Zone\_Identifier: 4400  
 Geodetic Reference System 80  
 4,000-meter grid, Easting - Northing