

TOWN HWY. No.	LENGTH IN MILES CLASS 3	CLASS 4
4	3.69	(0.07)
6	1.20	
7	0.47	
8	0.63	
10	1.31	(0.42)
11	0.67	
12	1.71	
13	0.24	
14	2.70	
15	0.13	
16	0.65	
17	0.70	
18	0.65	
19	0.46	
20	0.30	
21	1.40	
22	0.27	(0.53)
23	0.90	
24	0.85	(0.10)
25	0.53	
26	2.10	
27		(0.55)
28	0.25	
29	0.45	
30	0.04	
31	0.20	
32	0.15	
33	0.13	
34	0.36	
35	0.07	
36	0.43	
37	0.45	
38	0.36	
39	0.25	
40	0.22	
41	0.34	
42	0.10	
43	0.15	
44	0.30	
45	0.29	
46	0.22	
47	0.38	
48	0.16	
49	0.24	
50	0.18	
51	0.11	
52	0.62	
53	0.18	
54	0.28	
55	0.30	
56	0.18	
57	0.46	
58	0.51	
59	0.10	
61	0.12	
62	0.66	
63	0.10	
64	0.08	
65	0.30	
66	0.14	
67	0.62	
68	0.36	
69	0.16	
70	0.21	
71	0.28	
72	0.33	
73	0.28	
74	0.06	
75	0.38	
76	1.01	
77	0.45	
78	0.39	
79	0.18	
80	0.52	
81	0.14	
82	0.43	
83	0.31	
84	0.71	
85	0.29	
86	0.13	
87	0.67	
88	1.13	
89	0.17	
90	0.14	
91	0.05	
92	0.61	
93	0.36	
94	0.82	
95	0.16	
96	0.13	
97	0.37	
98	0.36	
99	0.13	
100	0.14	
101	0.30	
102	0.16	
103	0.12	
104	0.27	
105	0.30	
106	0.30	
107	0.62	
108	0.58	
109	0.44	
110	0.21	
111	0.21	
112	1.02	
113	0.47	
114	0.77	
115	0.79	
116	0.19	
117	0.39	
118	0.10	
119	0.50	
120	0.12	
121	0.06	
122	0.19	
TOTAL	52.41	1.67

TOWN HWY. No.	LENGTH IN MILES "NOT UP TO STANDARD"	LEGAL TRAIL No.	LENGTH IN MILES LEGAL TRAIL
10	(0.29)		
25	(0.07)	1	(0.80)
60	(0.39)		
TOTAL	0.75		0.80

*The sections of the town highways listed above are legally Class 3, but have been deemed "Not Up To Standard" and are functionally Class 4 Town Highways

B34 / C34 STATE BRIDGE OR CULVERT IDENTIFIER
B34 / C34 TOWN BRIDGE OR CULVERT IDENTIFIER

MILEAGE SUMMARY

CLASS 2	7.700
TH-1	1.050
TH-2	2.100
TH-3	2.950
TH-4	3.880
TH-5	1.600
TH-6	1.600
TOTAL CLASS 2	19.280
CLASS 3	0.929
TOTAL CLASS 3	52.41
TOTAL TOWN	71.690
STATE HIGHWAY	5.940
VT-2A	0.417
TOTAL STATE HIGHWAY	6.357
US HIGHWAY	5.897
US-2	5.897
TOTAL US HIGHWAY	5.897
TOTAL STATE	12.254
INTERSTATE	5.459
I-89	5.459
TOTAL INTERSTATE	5.459
INTERSTATE - Ramps	0.929
I-89	0.929
TOTAL INTERSTATE - Ramps	0.929
TOTAL INTERSTATE	6.388

TOTAL, TRAVELED HIGHWAYS, FEB. 10, 2012: 90.332
(Excludes Class 4, Legal Trail, and Unidentified Corridor Mileage)

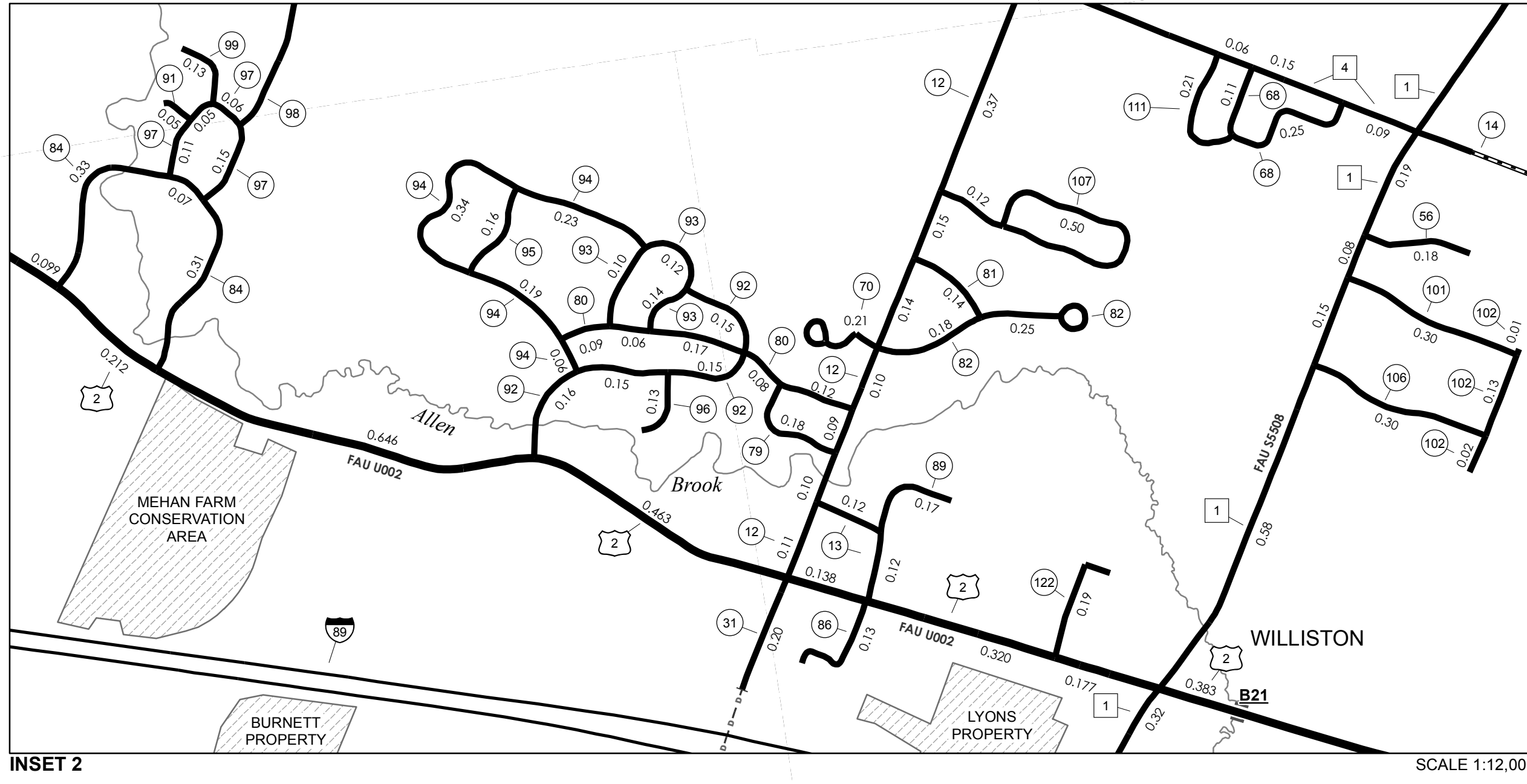
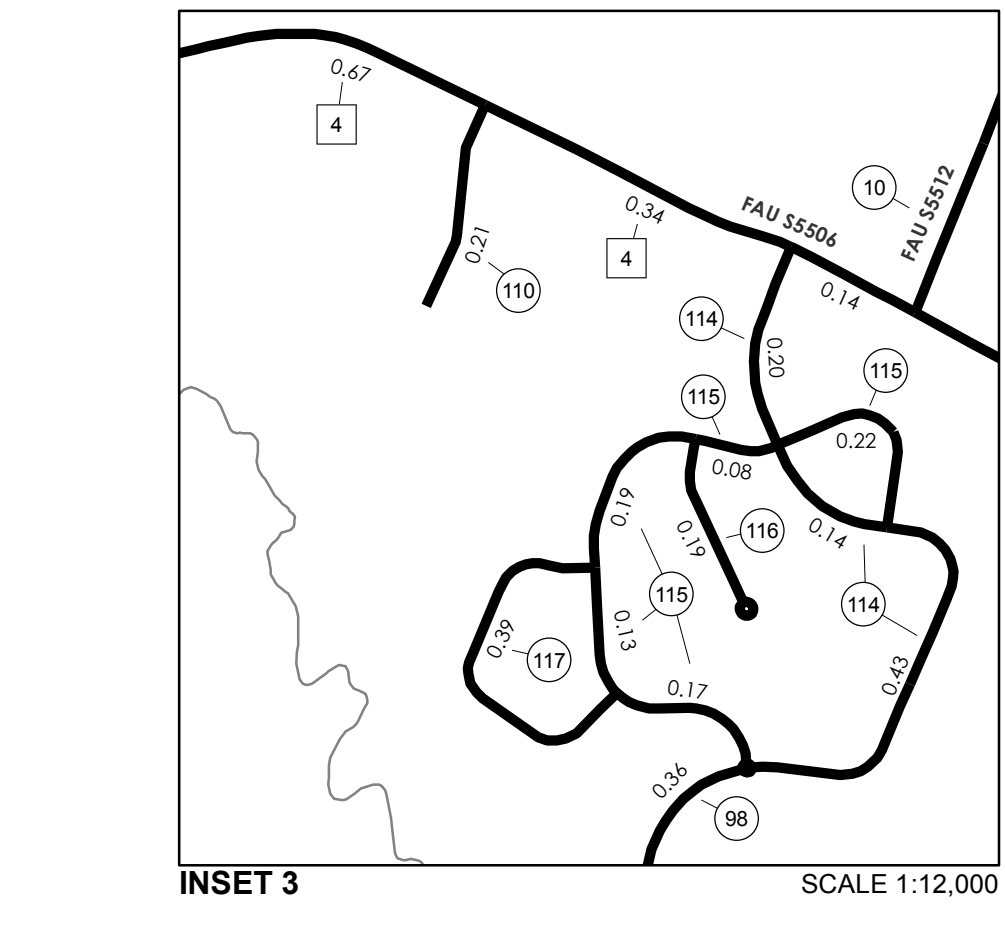
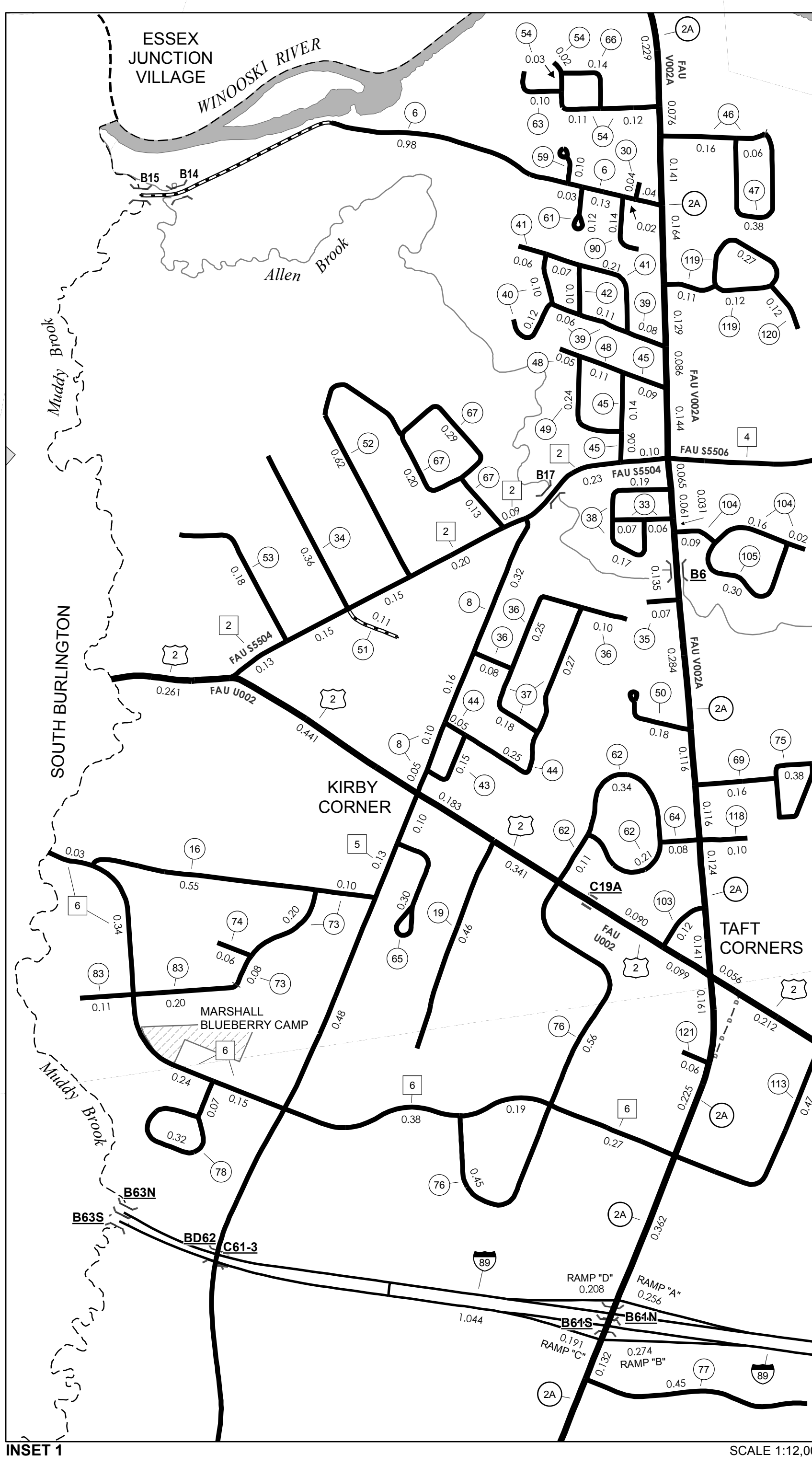

DISCLAIMER:
The untraveled highways (laid-out town highways), discontinued highways, and legal trails herein are those of which the Agency of Transportation has record; others may exist.
Highway and bridge data by the Agency of Transportation. All other data from the Vermont Center for Geographic Information. Only named streams are shown.

VERMONT GENERAL HIGHWAY MAP
Town of Williston
CHITTENDEN COUNTY
Transportation District #5
Prepared by the Vermont Agency of Transportation
Division of Policy, Planning and Intermodal Development
in cooperation with
U.S. Department of Transportation
Federal Highway Administration
Mileage as of February 10, 2012
Map prepared September 26, 2012
SCALE 1:31,680