

TOWN HWY. No.	LENGTH IN MILES CLASS 3	LENGTH IN MILES CLASS 4	TOWN HWY. No.	LENGTH IN MILES CLASS 3	LENGTH IN MILES CLASS 4
2	2.49		35	0.95	
3	7.11		36	1.35	
4	6.52	(0.15)	37	1.67	(1.04)
5	0.55		38		(0.11)
6	0.31	(0.40)	40	1.48	
7	0.30		41	0.09	
8	0.30		42	0.61	(0.07)
9	0.90		43	0.30	
10	0.45		44	0.70	
11		(0.25)	45	0.40	
13	0.19		46	0.01	
14	0.30		47	0.06	
15	0.15	(1.10)	48	0.18	
17	0.88	(0.27)	49	0.04	
18	0.36		50	0.01	
19	0.25		51	0.10	
21	0.99		52	0.95	
22	0.10		53	0.98	
23	0.17	(0.33)	54	0.70	
24	3.50	(0.31)	55	0.13	
25	0.24		56	0.27	
26	0.75	(1.30)	57	0.22	
27	0.82		58	0.29	
28	0.10		59	0.35	
30	1.55		60	0.15	
31	0.06		61	0.35	
32		(0.73)	62	0.44	
33	1.15		63	0.29	
34	0.06				
			TOTAL	43.32	6.06

TOWN HWY. No.	LENGTH IN MILES "NOT UP TO STANDARD"
2	(0.33)
20	(0.14)
TOTAL	0.47

* The sections of the town highways listed above are legally Class 3, but have been deemed "Not Up To Standard" and are functionally Class 4 Town Highways

LEGAL TRAIL No.	LENGTH IN MILES LEGAL TRAIL
1	(0.55)
2	(0.05)
TOTAL	0.60

MILEAGE SUMMARY		
CLASS 2		
TH-1	8.750	
	TOTAL CLASS 2	8.750
CLASS 3		
	TOTAL CLASS 3	43.32
	TOTAL TOWN	52.070
STATE HIGHWAY		
VT-15	4.944	
	TOTAL STATE HIGHWAY	4.944
	TOTAL STATE	4.944

TOTAL, TRAVELED HIGHWAYS, FEB. 10, 2024: 57.014
(Excludes Class 4 and Legal Trail Mileage)

- HIGHWAYS**
 - INTERSTATE
 - U.S. ROUTE
 - STATE ROUTE
 - CLASS 1
 - CLASS 2
 - CLASS 3
 - CLASS 4
 - LEGAL TRAIL
 - PARK AND RIDE
- INTERSTATE OR DIVIDED HIGHWAY
- STATE - HARD SURFACE OR PAVED
- TOWN - HARD SURFACE OR PAVED
- GRAVEL
- SOIL OR GRADED AND DRAINED EARTH
- UNIMPROVED OR PRIMITIVE
- IMPASSABLE OR UNTRAVELED
- LEGAL TRAIL
- DISCONTINUED
- HIGHWAY CLASS CHANGE
- RAILROAD
- INACTIVE RAILROAD
- PUBLIC LAND - NATIONAL FOREST
- PUBLIC LAND - STATE/MUNICIPAL
- NFR NATIONAL FOREST ROAD
- ACE ARMY CORPS OF ENGINEERS
- USGH UNITED STATES GOV. HWY.

- POLITICAL SUBDIVISIONS**
 - STATE BOUNDARY
 - COUNTY BOUNDARY
 - TOWN BOUNDARY
 - VILLAGE BOUNDARY
 - URBAN COMPACT BOUNDARY
 - WATER BODY
 - STREAM OR BROOK
- BRIDGE OR CULVERT**
 - BRIDGE OR CULVERT > 20'
 - BRIDGE OR CULVERT 6' - 20'
 - BIKE PATH STRUCTURE
 - VTCULVERTS BRIDGE
 - VTCULVERTS CULVERT > 6'
- STATE BRIDGE OR CULVERT IDENTIFIER**
- TOWN BRIDGE OR CULVERT IDENTIFIER**

- FEDERAL CLASSIFICATION IDENTIFIER**
 - MA MINOR ARTERIAL
 - MJC MAJOR COLLECTOR
 - MNC MINOR COLLECTOR
 - PA PRINCIPAL ARTERIAL

Vermont State Plane Coordinate System
North American Datum of 1983
SPCS_Zone_Identifier: 4400
Geodetic Reference System 80
4,000-meter grid, Easting - Northing

DISCLAIMER:
The untraveled highways (laid-out town highways), discontinued highways, and legal trails herein are those of which the Agency of Transportation has record; others may exist.

Highway and bridge data by the Agency of Transportation.
Town short structures drawn from the VTCULVERTS (formerly VOBCIT) online database. All other data from the Vermont Open Geodata Portal. Only named streams shown.

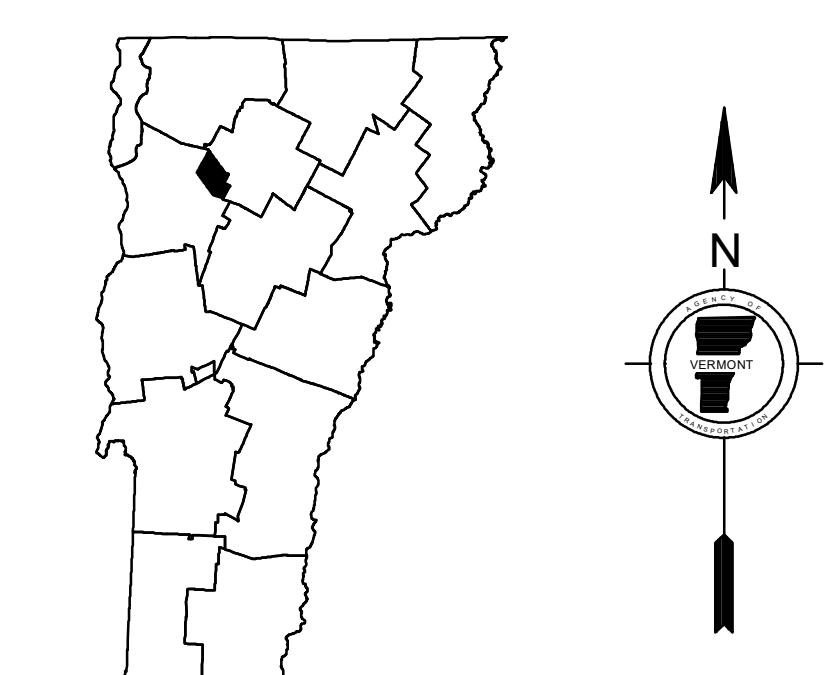
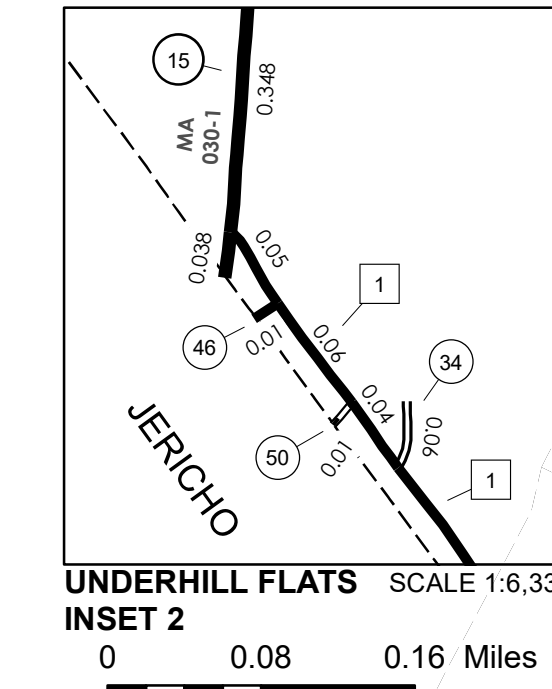
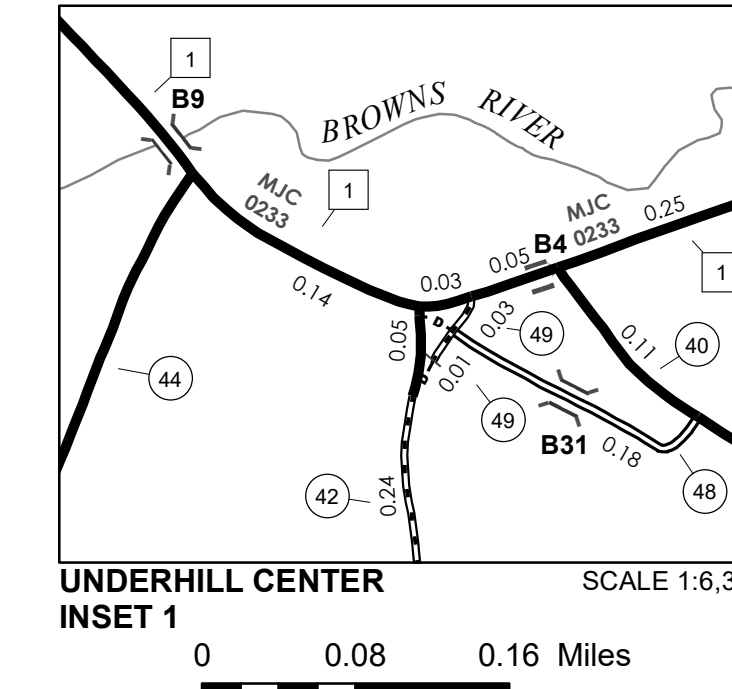

VERMONT
GENERAL HIGHWAY MAP
Town of Underhill
CHITTENDEN COUNTY
Transportation District #5
Prepared by the
Vermont Agency of Transportation
Division of Policy, Planning and Intermodal Development
in cooperation with
U.S. Department of Transportation
Federal Highway Administration
Mileage as of February 10, 2024
Map prepared July 18, 2024
SCALE 1:31,680

0.5 0 0.5 1 1.5 2
Miles
0.5 0 0.5 1 1.5 2
Kilometers