

TOWN HWY. No.	LENGTH IN MILES CLASS 3	CLASS 4
4	0.07	
7	3.35	
8	2.25	
9	2.70	
12	2.55	(0.22)
14	2.80	
15	0.10	
16	1.35	(0.75)
17	1.20	
18	0.50	(0.30)
19	0.80	
20	1.40	(0.70)
21	0.30	
22	0.30	
23	0.10	
24	0.30	
25		(0.45)
29	0.67	
30	3.10	
31	0.27	
32	0.15	
33	0.40	(0.45)
34	0.33	
35	0.13	
36	0.30	
37	0.14	
38	0.19	
39	0.07	
40	0.54	
41	0.11	
42	0.19	
43	0.23	(0.05)
44	0.11	
45	0.13	
46	0.09	
47	0.12	
48	0.19	
49	0.17	
50	0.26	
51	0.36	
52	0.16	
53	0.12	
54	0.07	
55	0.33	
56	0.84	
57	0.45	
58	0.09	
59	0.10	
60	0.25	
61	0.95	
62	0.07	
63	0.19	
64	0.16	
65	0.05	
<b>TOTAL</b>	<b>32.15</b>	<b>2.92</b>

**MILEAGE SUMMARY**

CLASS 2	4.720	
TH-1	3.900	
TH-2	3.880	
TH-3	2.330	
TH-4	0.200	
TH-5	0.800	
<b>TOTAL CLASS 2</b>	<b>15.630</b>	
CLASS 3		32.15
<b>TOTAL CLASS 3</b>	<b>47.780</b>	
STATE HIGHWAY VT-117	0.748	
<b>TOTAL STATE HIGHWAY</b>	<b>0.748</b>	
US HIGHWAY US-2	6.379	
<b>TOTAL US HIGHWAY</b>	<b>6.379</b>	
<b>TOTAL STATE</b>	<b>7.127</b>	
INTERSTATE I-89	6.142	
<b>TOTAL INTERSTATE</b>	<b>6.142</b>	
INTERSTATE - Ramps I-89	1.058	
<b>TOTAL INTERSTATE - Ramps</b>	<b>1.058</b>	
<b>TOTAL, TRAVELED HIGHWAYS, FEB. 10, 2012:</b>	<b>62.107</b>	

(Excludes Class 4, Legal Trail, and Unidentified Corridor Mileage)

TOWN HWY. No.	LENGTH IN MILES "NOT UP TO STANDARD"
31	(0.19)
<b>TOTAL</b>	<b>0.19</b>

\*The sections of the town highways listed above are legally Class 3, but have been deemed "Not Up To Standard" and are functionally Class 4 Town Highways

LEGAL TRAIL No.	LENGTH IN MILES LEGAL TRAIL
1	(0.40)
2	(0.25)
5	(0.18)
<b>TOTAL</b>	<b>0.83</b>

- HIGHWAYS**
- INTERSTATE OR DIVIDED HIGHWAY
  - STATE - HARD SURFACE OR PAVED
  - TOWN - HARD SURFACE OR PAVED
  - GRAVEL
  - SOIL OR GRADED AND DRAINED EARTH
  - UNIMPROVED OR PRIMITIVE
  - IMPASSABLE OR UNTRAVELED
  - LEGAL TRAIL
  - DISCONTINUED
  - HIGHWAY CLASS CHANGE
  - RAILROAD
  - INACTIVE RAILROAD
  - P PARK AND RIDE

- POLITICAL SUBDIVISIONS**
- STATE BOUNDARY
  - COUNTY BOUNDARY
  - TOWN BOUNDARY
  - VILLAGE BOUNDARY
  - URBAN COMPACT BOUNDARY
  - WATER BODY
  - STREAM OR BROOK
  - BRIDGE OR CULVERT**
  - BRIDGE OR CULVERT GREATER THAN 20'
  - BRIDGE OR CULVERT 6' - 20'
  - B34 / C34 STATE BRIDGE OR CULVERT IDENTIFIER
  - B34 / C34 TOWN BRIDGE OR CULVERT IDENTIFIER

- FEDERAL CLASSIFICATION IDENTIFIER**
- FAU URBAN ARTERIAL OR COLLECTOR
  - MA MINOR ARTERIAL
  - MJC MAJOR COLLECTOR
  - MNC MINOR COLLECTOR
  - PA PRINCIPAL ARTERIAL

**DISCLAIMER:**  
The untraveled highways (laid-out town highways), discontinued highways, and legal trails herein are those of which the Agency of Transportation has record; others may exist.  
Highway and bridge data by the Agency of Transportation. All other data from the Vermont Center for Geographic Information. Only named streams are shown.

Vermont State Plane Coordinate System  
North American Datum of 1983  
SPCS\_Zone\_Identifier: 4400  
Geoid Reference System 80  
4,000-meter grid, Easting - Northing

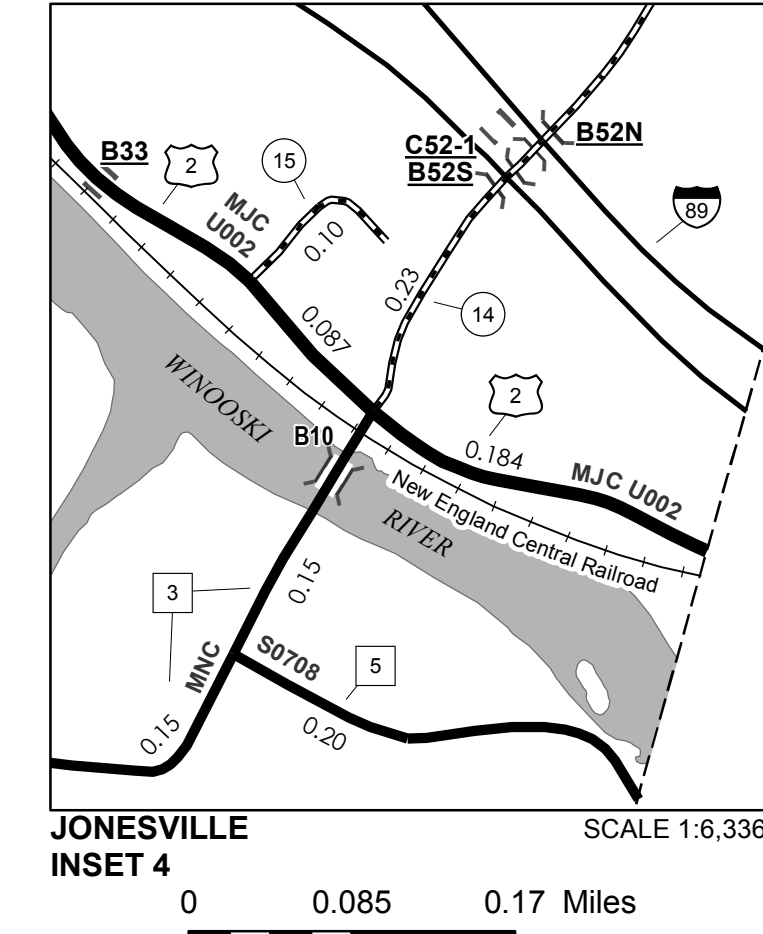
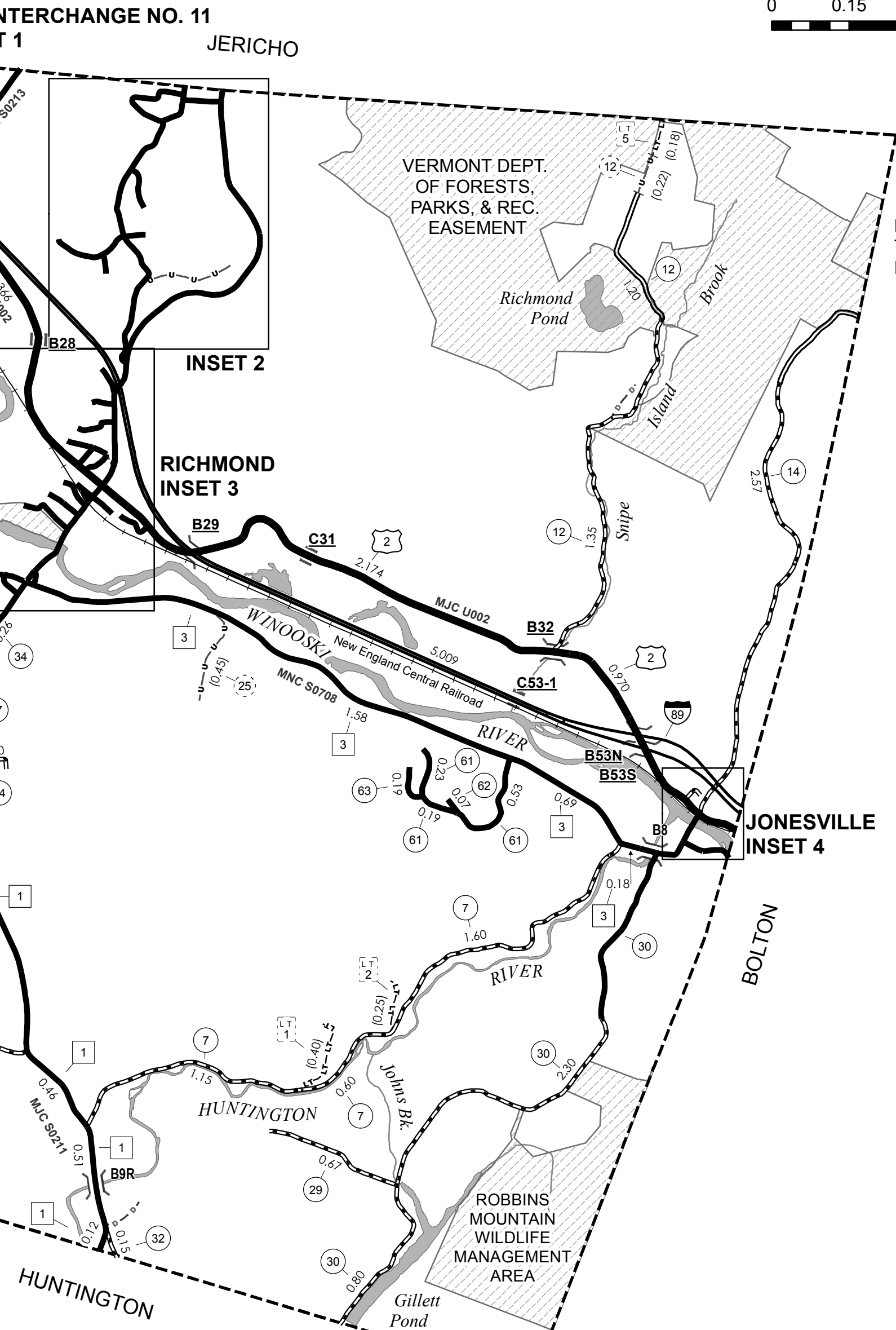
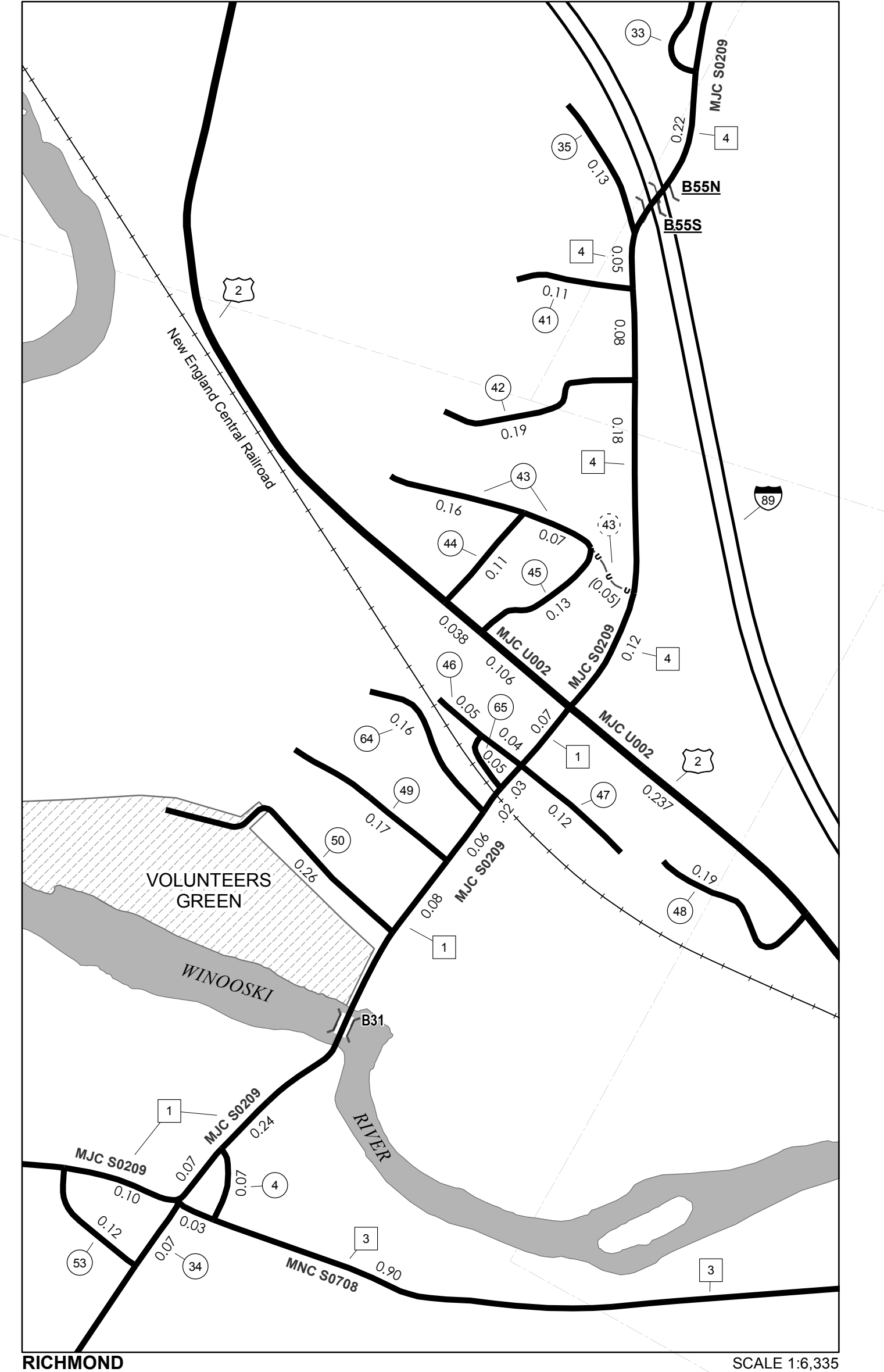
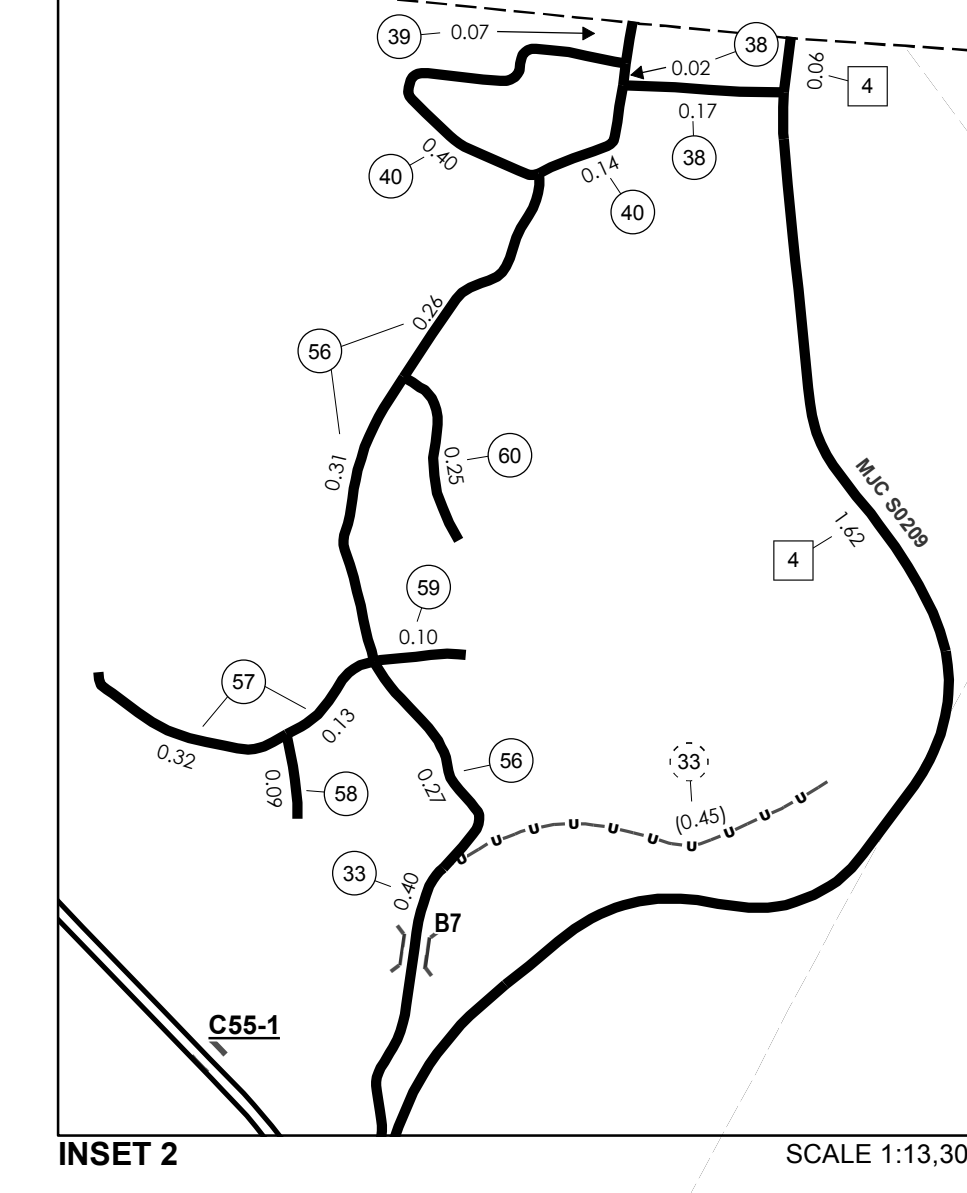
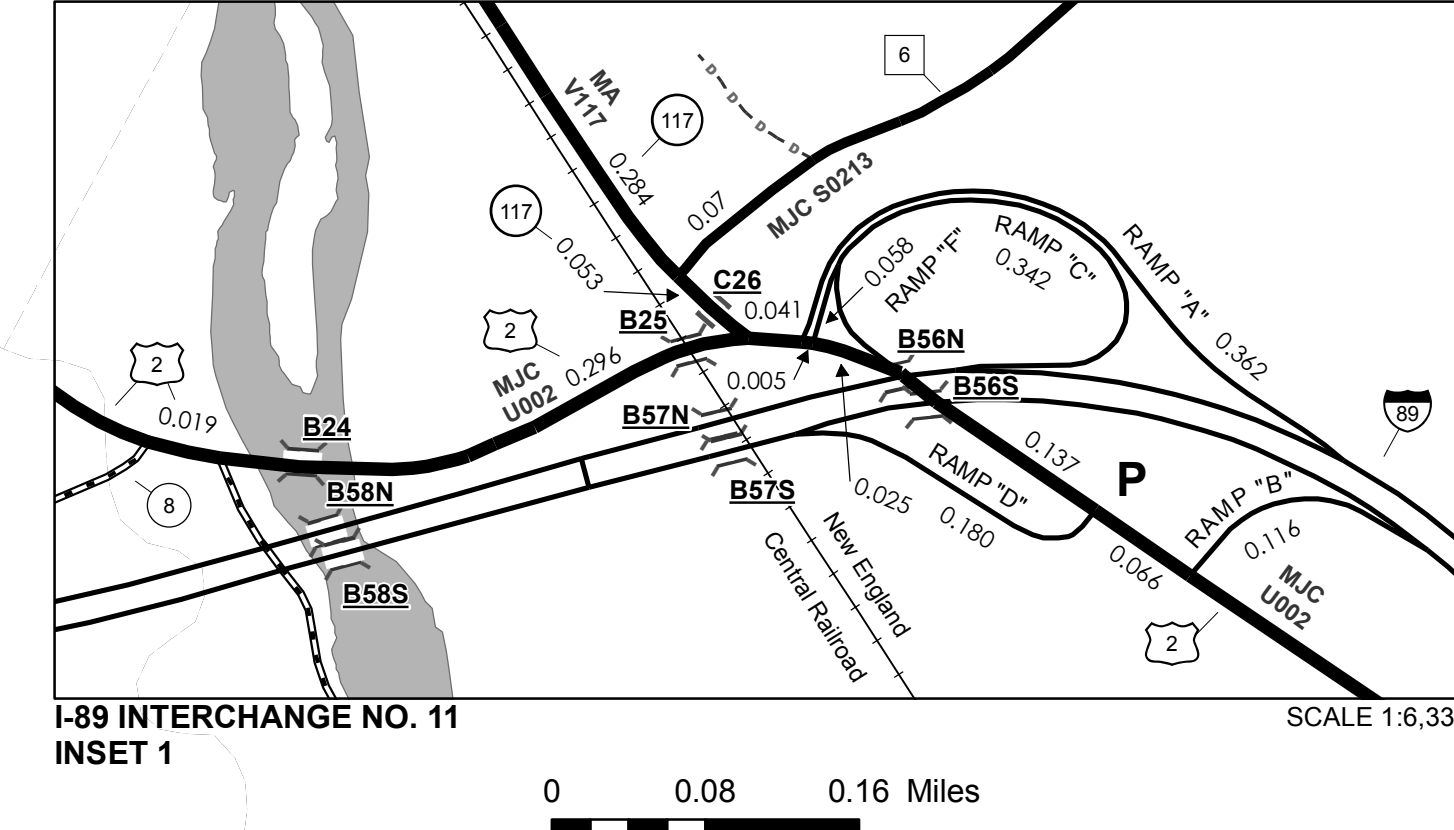
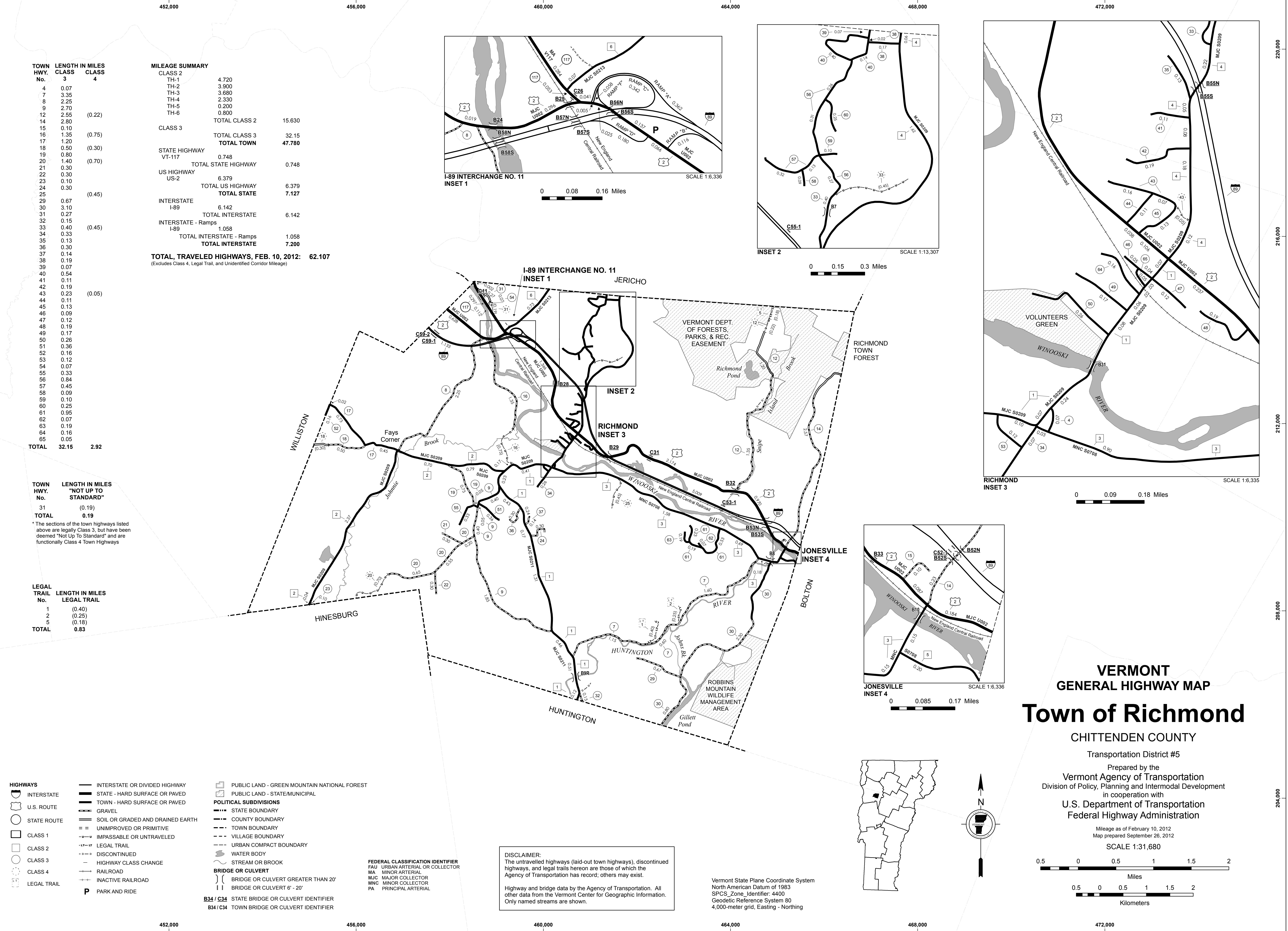

**VERMONT GENERAL HIGHWAY MAP**  
**Town of Richmond**  
CHITTENDEN COUNTY  
Transportation District #5  
Prepared by the Vermont Agency of Transportation  
Division of Policy, Planning and Intermodal Development  
in cooperation with  
U.S. Department of Transportation  
Federal Highway Administration  
Mileage as of February 10, 2012  
Map prepared September 26, 2012  
SCALE 1:31,680

0.5 0 0.5 1 1.5 2 Miles  
0.5 0 0.5 1 1.5 2 Kilometers